

STATE	STATE PROJECT REFERENCE NO.	SHEET NO.	TOTAL SHEETS
N.C.	B-5404	1	
STATE PROJ. NO.	F.A. PROJ. NO.	DESCRIPTION	
46119.1.1	BRZ-1163 (10)	P.E.	
46119.2.FD1	BRZ-1163 (10)	ROW, UTIL	
46119.3.FD1	BRZ-1163 (10)	CONST.	

STATE OF NORTH CAROLINA
DIVISION OF HIGHWAYS

JACKSON COUNTY

**LOCATION: BRIDGE NO. 136 OVER PINE CREEK
ON SR 1163 (PINE CREEK ROAD)**

TYPE OF WORK: GRADING, PAVING, DRAINAGE, AND STRUCTURE

TIP PROJECT: B-5404

CONTRACT: C203671

See Sheet 1A For Index of Sheets
See Sheet 1B For Conventional Plan Sheet Symbols
See Sheet 1C-1 For Survey Control Sheet

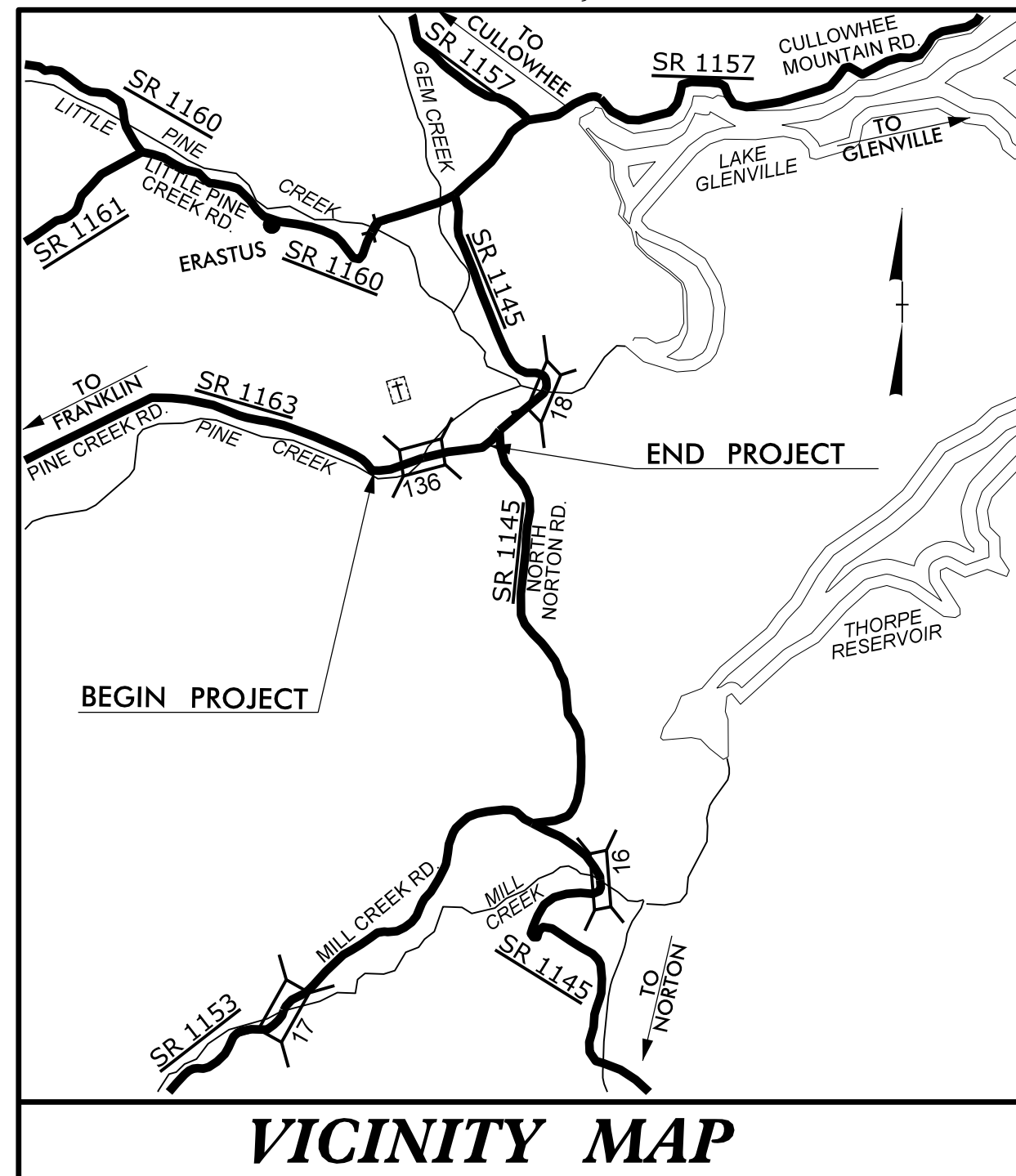

VICINITY MAP

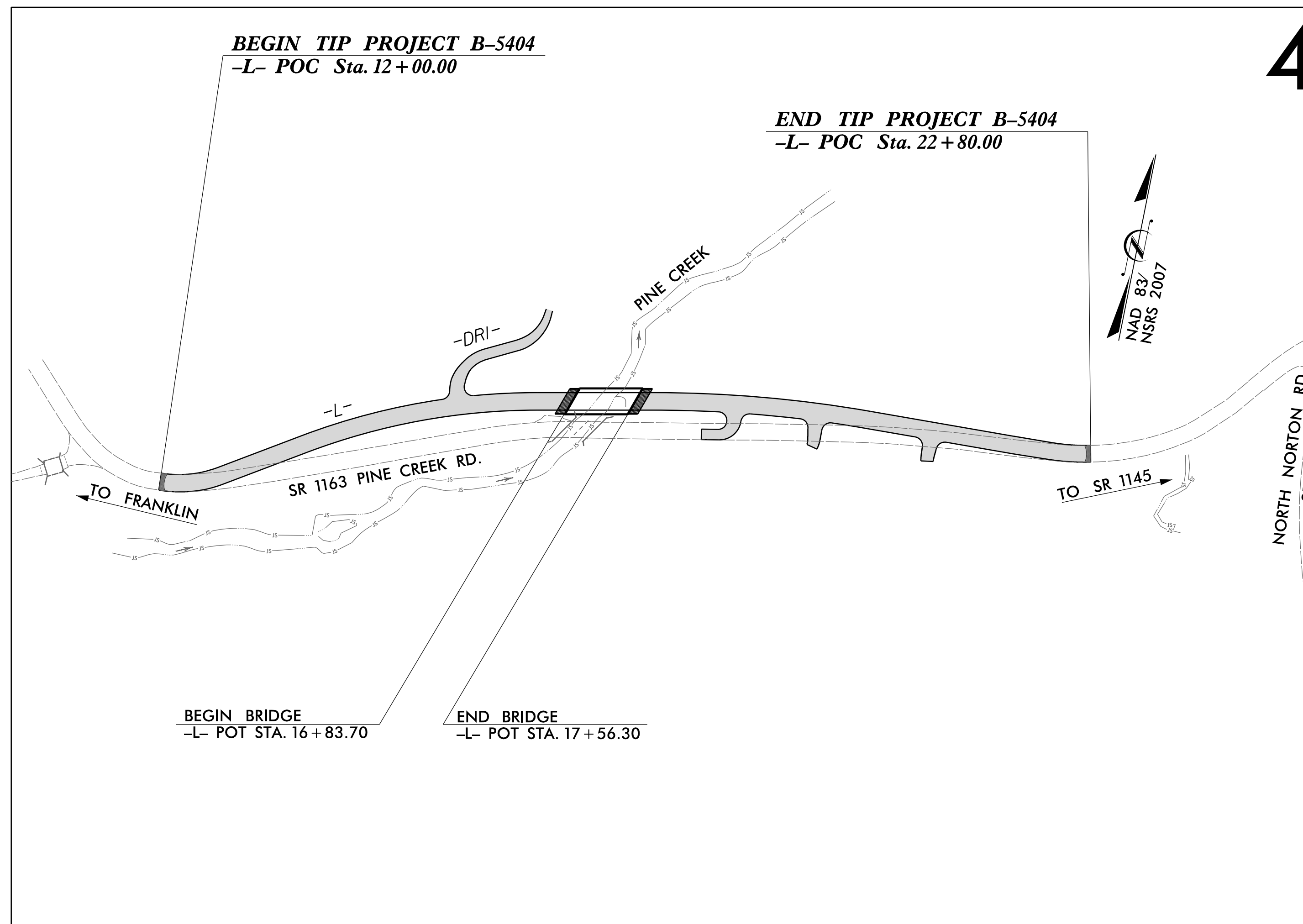

4

NCDOT CONTACT: REKHA PATEL, P.E.

GRAPHIC SCALES

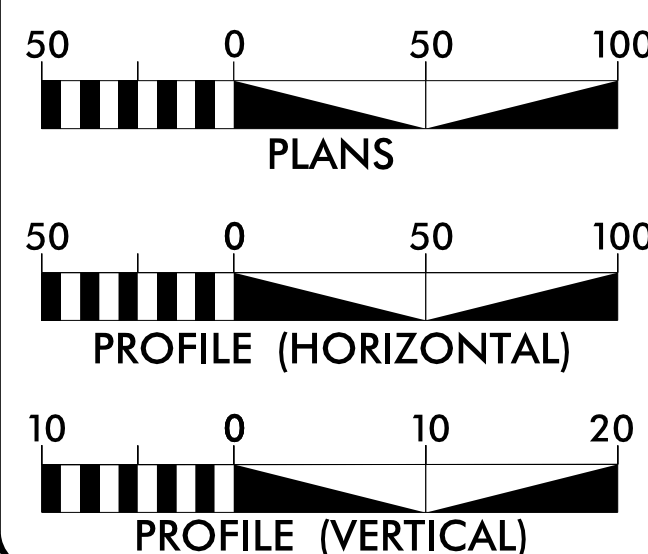

DESIGN DATA

ADT 2016 = 1,020
ADT 2036 = 1,500
K = 12 %
D = 70 %
T = 7 % *
V = 40 MPH
* TTST = 1% DUAL 6%
FUNC CLASS = RURAL LOCAL
SUB REGIONAL TIER

PROJECT LENGTH

LENGTH ROADWAY TIP PROJECT B-5404 = 0.191 MILES
LENGTH STRUCTURE TIP PROJECT B-5404 = 0.014 MILES
TOTAL LENGTH TIP PROJECT B-5404 = 0.205 MILES

PLANS PREPARED FOR NCDOT BY:

Dewberry
2610 WYCLIFF ROAD
SUITE 410
RALEIGH, NC 27607
PHONE: 919.881.9939
NC COA No. F-0929

2012 STANDARD SPECIFICATIONS

RIGHT OF WAY DATE:
FEBRUARY 20, 2015

LETTING DATE:
JANUARY 19, 2016

DENNIS J. MORY, P.E.
PROJECT ENGINEER

RICKY E. STATON
PROJECT DESIGN ENGINEER

HYDRAULICS ENGINEER

DocuSigned by:
Cameron M. Long
88861CE5M4CB4CF...
11/11/2015

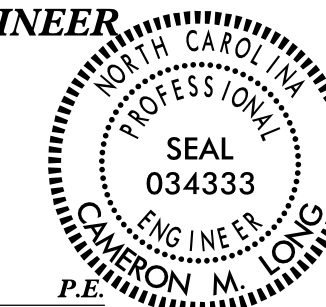

SIGNATURE:

ROADWAY DESIGN ENGINEER

DocuSigned by:
Dennis J. Mory
D5E0CF7684FC48B...
11/11/2015

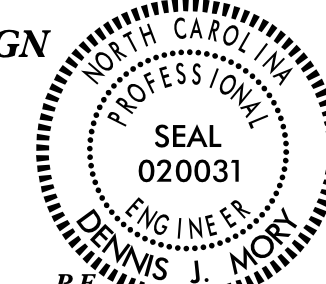

SIGNATURE:

