

POURING SEQUENCE

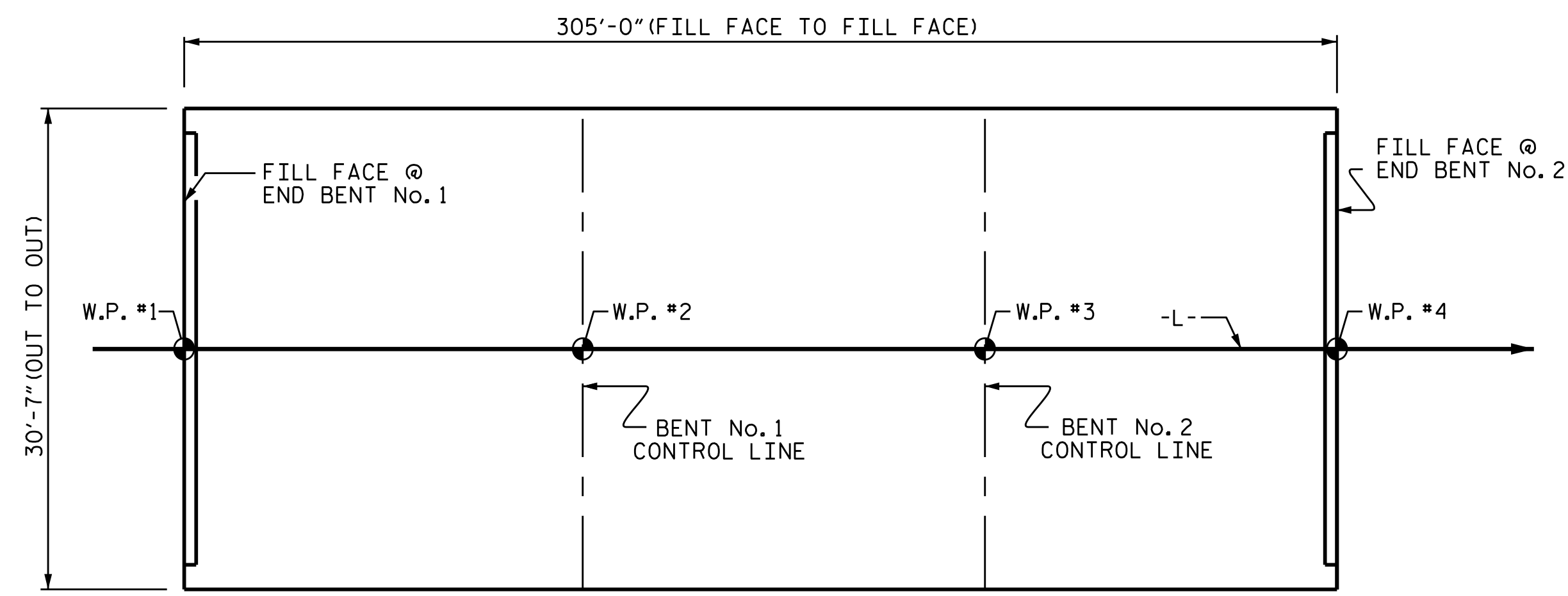

**LAYOUT FOR COMPUTING AREA
REINFORCED CONCRETE DECK SLAB
(SQ. FT. = 9,328)**

BAR TYPES		BILL OF MATERIAL				
BAR NO.	SIZE	TYPE	LENGTH	WEIGHT		
*A1	#5	STR	30'-3"	17,668		
A2	#5	STR	30'-3"	17,668		
*B1	#6	STR	20'-10"	1,565		
*B2	#6	STR	24'-10"	1,790		
*B3	#4	STR	21'-8"	362		
*B4	#6	STR	49'-3"	3,699		
*B5	#6	STR	47'-9"	3,443		
*B6	#4	STR	16'-6"	551		
*B7	#6	STR	49'-3"	3,551		
*B8	#6	STR	50'-9"	3,811		
*B9	#4	STR	26'-8"	445		
B10	#5	STR	52'-7"	10,859		
H1	#5	STR	14'-2"	1,182		
K1	#4	STR	19'-4"	517		
K2	#4	STR	2'-8"	29		
*S1	#4	1	11'-11"	398		
*S2	#4	1	9'-4"	312		
U1	#4	2	10'-0"	334		
U2	#4	2	12'-4"	99		
V2	#4	STR	5'-0"	374		
REINFORCING STEEL				LBS.	31,062	
*EPOXY COATED REINFORCING STEEL				LBS.	37,595	

ALL BAR DIMENSIONS ARE OUT TO OUT

FOR ADDITIONAL "S" BARS EMBEDDED IN DECK SLAB, SEE "1'-2" X 2'-6" CONCRETE PARAPET".

SUPERSTRUCTURE REINFORCING STEEL LENGTHS ARE BASED ON THE FOLLOWING MINIMUM SPLICE LENGTHS

BAR SIZE	SUPERSTRUCTURE EXCEPT APPROACH SLABS, PARAPET, AND BARRIER RAIL		APPROACH SLABS		PARAPET AND BARRIER RAIL
	EPOXY COATED	UNCOATED	EPOXY COATED	UNCOATED	
#4	2'-0"	1'-9"	2'-0"	1'-9"	2'-9"
#5	2'-6"	2'-2"	2'-6"	2'-2"	3'-5"
#6	3'-0"	2'-7"	3'-10"	2'-7"	4'-4"
#7	5'-3"	3'-6"			
#8	6'-10"	4'-7"			

— SUPERSTRUCTURE BILL OF MATERIAL —

	CLASS AA CONCRETE (CU. YDS.)	REINFORCING STEEL (LBS.)	EPOXY COATED REINFORCING STEEL (LBS.)
POUR 1	38.9	—	—
POUR 2	118.3	—	—
POUR 3	118.4	—	—
POUR 4	54.7	—	—
TOTALS**	330.3	31,062	37,595

**QUANTITIES FOR PARAPET ARE NOT INCLUDED

GROOVING BRIDGE FLOORS

BRIDGE DECK	7,574 SQ.FT.
APPROACH SLABS	708 SQ.FT.
TOTAL	8,282 SQ.FT.

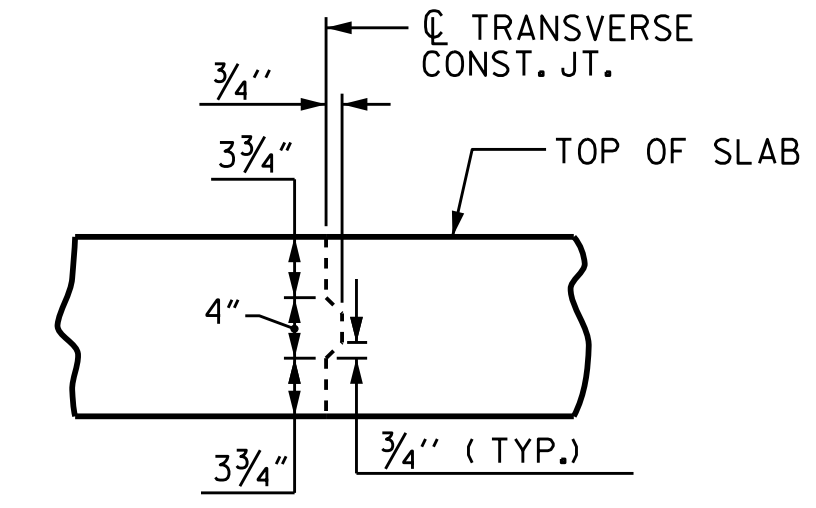

TRANSVERSE CONSTRUCTION JOINT DETAIL

REINFORCING STEEL IN SLAB NOT SHOWN. LONGITUDINAL REINFORCING STEEL SHALL BE CONTINUOUS THROUGH JOINT.



PROJECT NO. B-3868
MACON COUNTY
STATION: 18+33.50 -L-

STATE OF NORTH CAROLINA
DEPARTMENT OF TRANSPORTATION
RALEIGH
SUPERSTRUCTURE
BILL OF MATERIAL

REVISIONS				SHEET NO.	
NO.	BY:	DATE:	NO.	BY:	DATE:
1			3		
2			4		

TOTAL SHEETS: 40

DRAWN BY: D. HODGE DATE: 10/14
CHECKED BY: B.N. GRADY DATE: 6/15
DESIGN ENGINEER OF RECORD: S.T. CHAMPION DATE: 8/15