

SEE RSD 1101.02, SHEET 15 OF 15,
FOR TAPER LOCATIONS AND LENGTHS.
USE SKINNY DRUMS.

SEE RSD 1101.03, SHEET 1 OF 9,
FOR PLACEMENT OF REQUIRED
W20-3 ADVANCE WARNING SIGNS

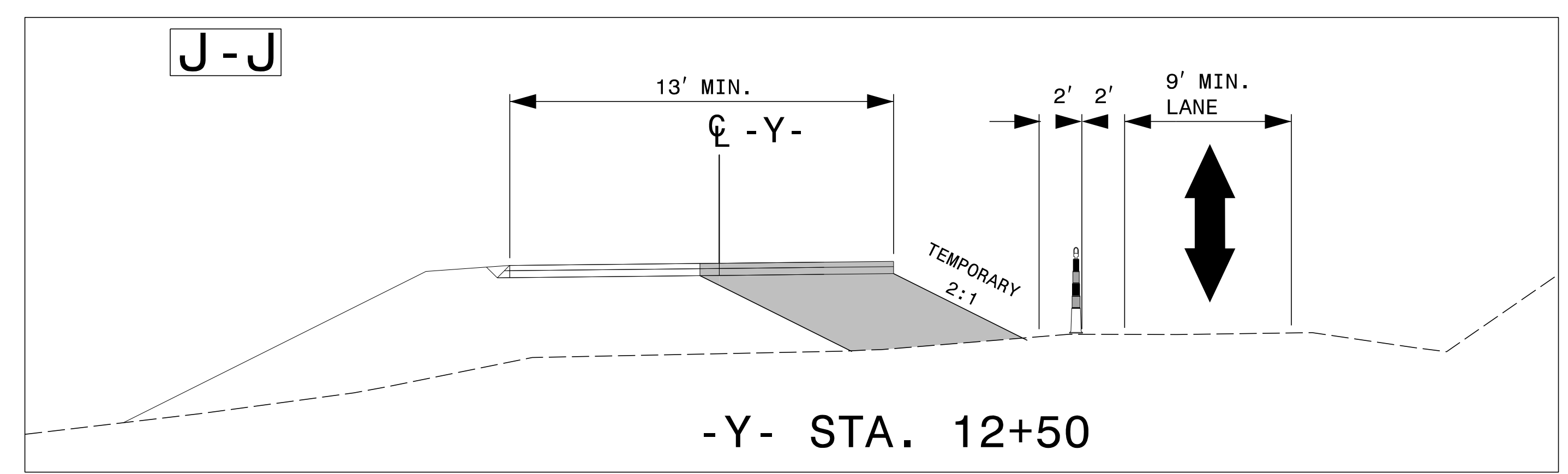
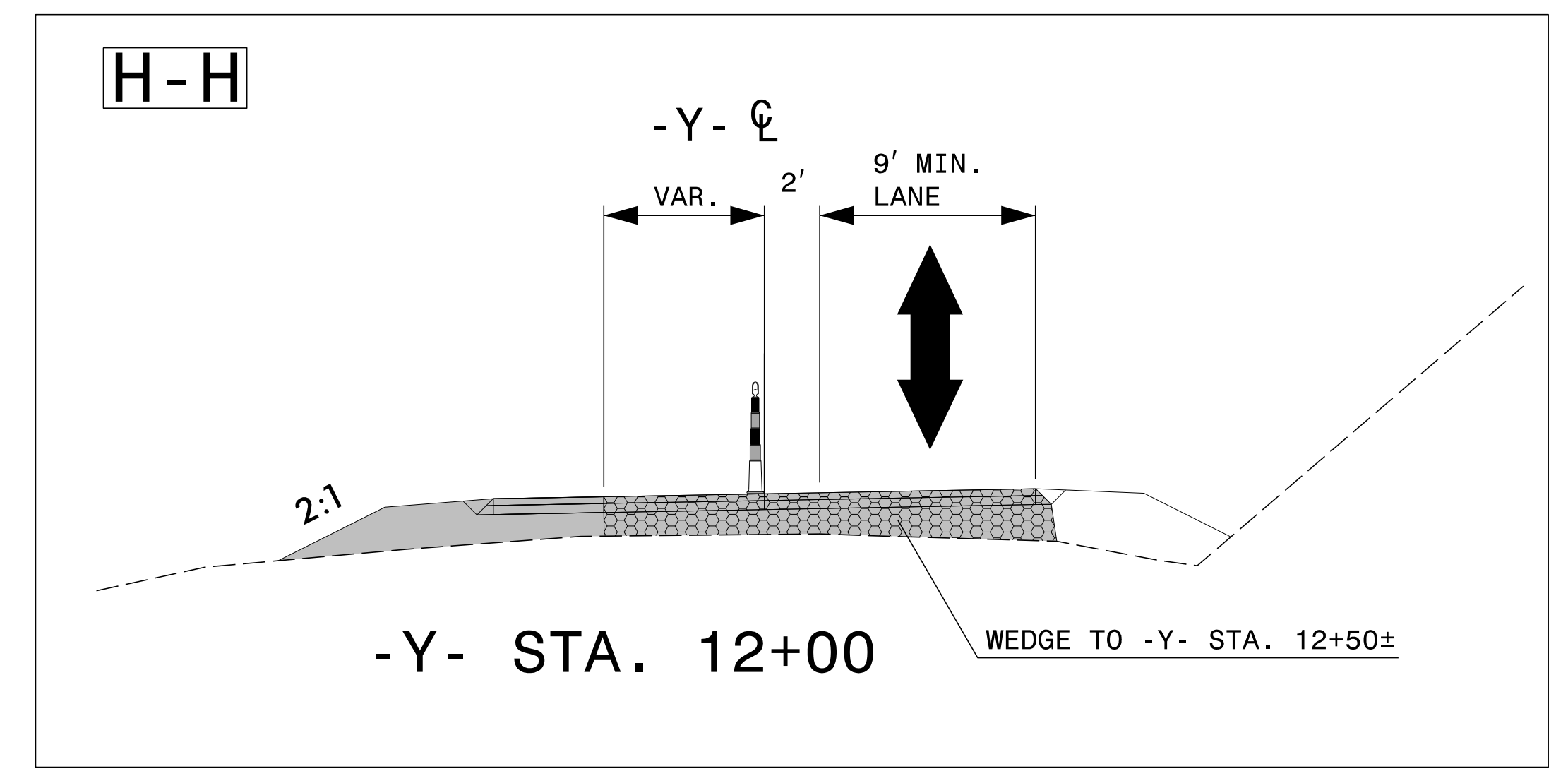

8/4/2015
 P:\TIP\Projects-B\B3868\TrafficControl\TCP\B-3868_TC_TMP_Phase III.dgn
 User:shanson

APPROVED: *J. W. Woolard, Jr.*
 DATE: 8/4/2015

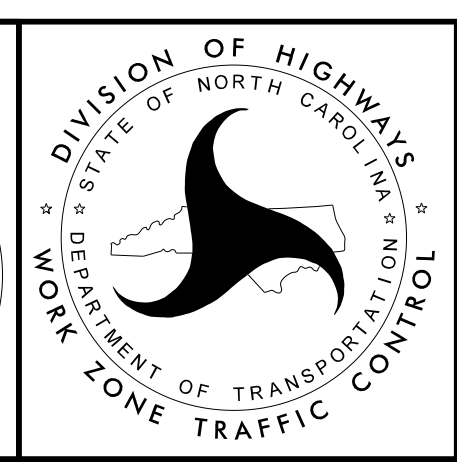
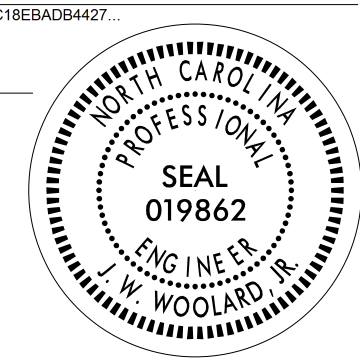

PHASE III