

PAVEMENT SCHEDULE

FINAL PAVEMENT DESIGN

6/2/09

C1	PROP. APPROX. 3" ASPHALT CONCRETE SURFACE COURSE, TYPE S9.5B, AT AN AVERAGE RATE OF 168 LBS. PER SQ. YD. IN EACH OF TWO LAYERS.	P	PRIME COAT AT THE RATE OF 0.35 GALLONS PER SQUARE YARD.
C2	PROP. VAR. DEPTH ASPHALT CONCRETE SURFACE COURSE, TYPE S9.5B, AT AN AVERAGE RATE OF 112 LBS. PER SQ. YD. PER 1" DEPTH. TO BE PLACED IN LAYERS NOT TO EXCEED 2" IN DEPTH.	R1	SHOULDER BERM GUTTER.
D1	PROP. APPROX. 4" ASPHALT CONCRETE INTERMEDIATE COURSE, TYPE I19.0B, AT AN AVERAGE RATE OF 456 LBS. PER SQ. YD.	R2	CONCRETE EXPRESSWAY GUTTER.
D2	PROP. VAR. DEPTH ASPHALT CONCRETE INTERMEDIATE COURSE, TYPE I19.0B, AT AN AVERAGE RATE OF 114 LBS. PER SQ. YD. PER 1" DEPTH, TO BE PLACED IN LAYERS NOT LESS THAN 2½" IN DEPTH OR GREATER THAN 4" IN DEPTH.	T	EARTH MATERIAL.
E1	PROP. APPROX. 4" ASPHALT CONCRETE BASE COURSE, TYPE B25.0B, AT AN AVERAGE RATE OF 456 LBS. PER SQ. YD.	U	EXISTING PAVEMENT.
E2	PROP. VAR. DEPTH ASPHALT CONCRETE BASE COURSE, TYPE B25.0B, AT AN AVERAGE RATE OF 114 LBS. PER SQ. YD. PER 1" DEPTH. TO BE PLACED IN LAYERS NOT LESS THAN 3" IN DEPTH OR GREATER THAN 5½" IN DEPTH.	W1	VARIABLE DEPTH ASPHALT PAVEMENT (SEE STANDARD WEDGING DETAIL)
J1	8" AGGREGATE BASE COURSE.	W2	VARIABLE DEPTH ASPHALT PAVEMENT (SEE STANDARD WEDGING DETAIL)

PROJECT REFERENCE NO. <i>B-3868</i>	SHEET NO. <i>2A-1</i>
ROADWAY DESIGN ENGINEER SEAL 033296 Steven D. Kendall 8/20/2015	PAVEMENT DESIGN ENGINEER SEAL 039819 LaTonya J. Heyward 8/19/2015

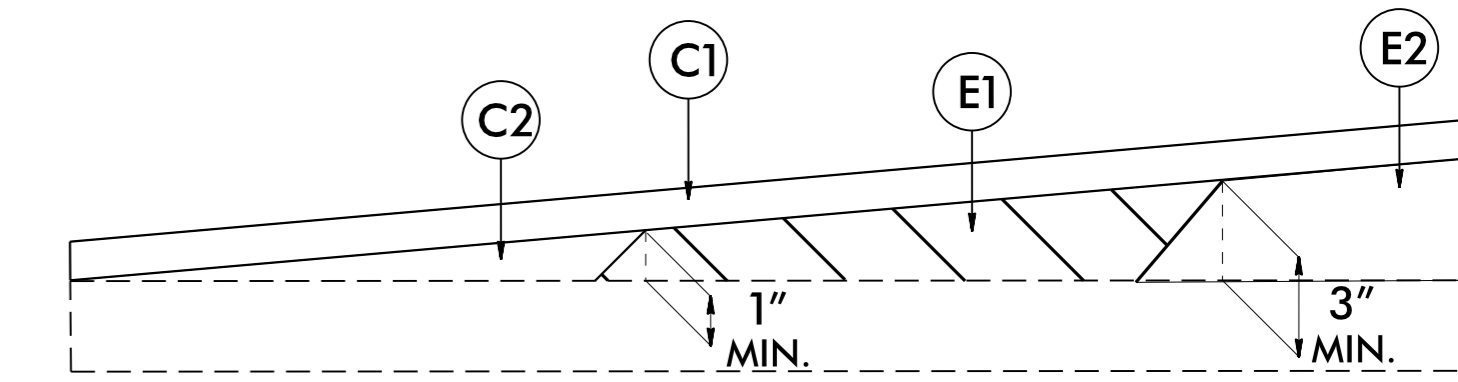

Wedging Detail (W1)

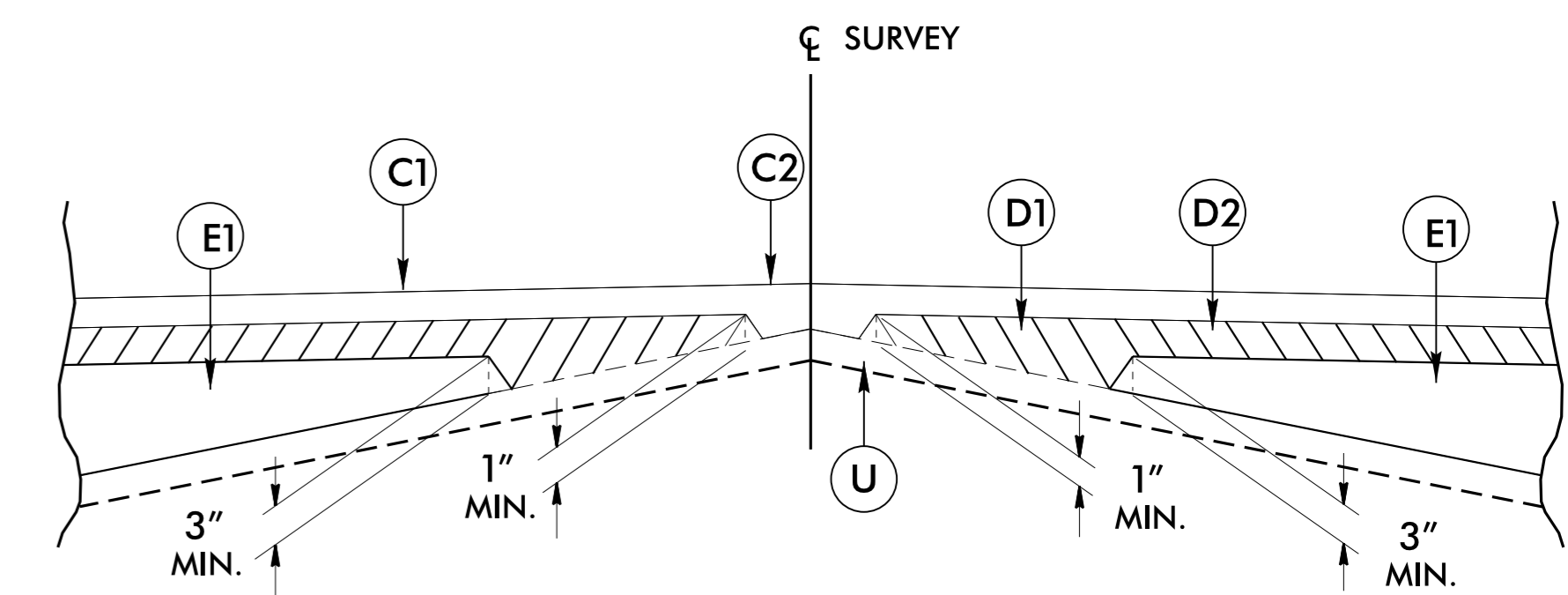

Wedging Detail (W2)

NOTE: PAVEMENT EDGE SLOPES ARE 1:1 UNLESS SHOWN OTHERWISE.

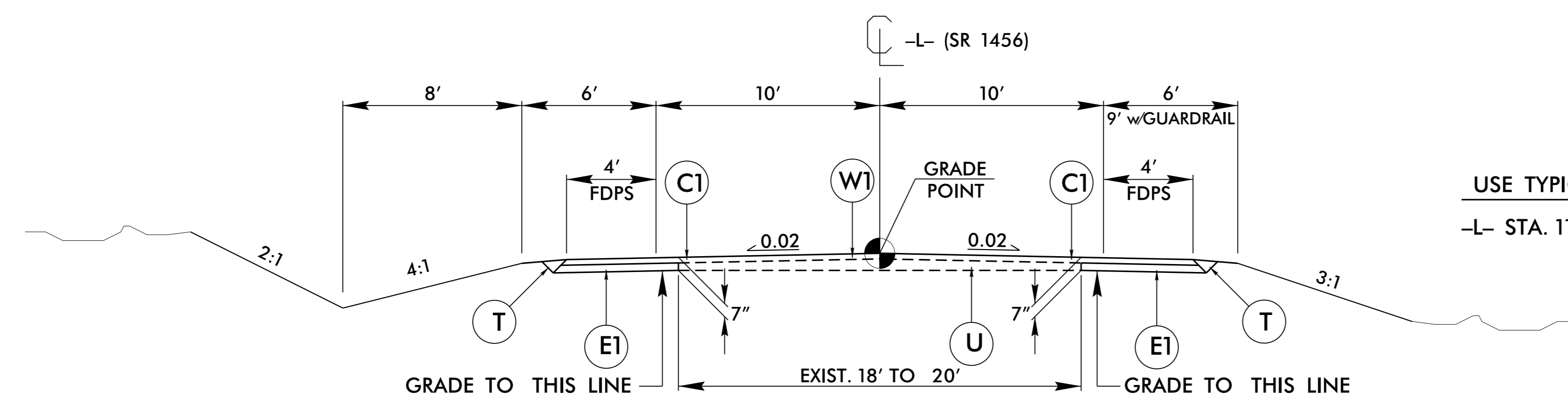

TYPICAL SECTION NO. 1

USE TYPICAL SECTION NO. 1

-L- STA. 11+00.00 TO 11+50.00

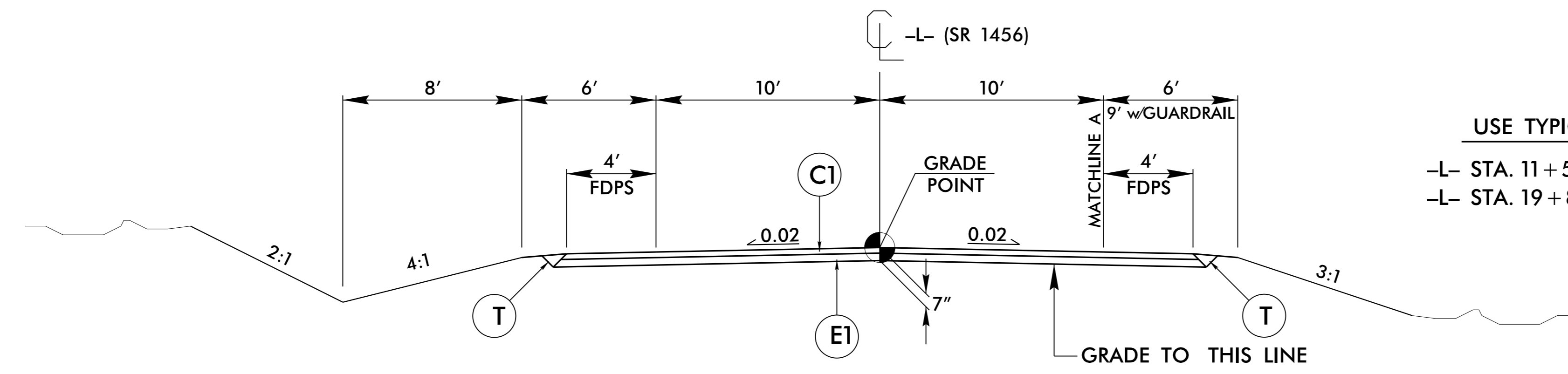

TYPICAL SECTION NO. 2

USE TYPICAL SECTION NO. 2

-L- STA. 11+50.00 TO 16+81.00 (BRIDGE)

-L- STA. 19+86.00 (BRIDGE) TO 22+35.82

INSET A

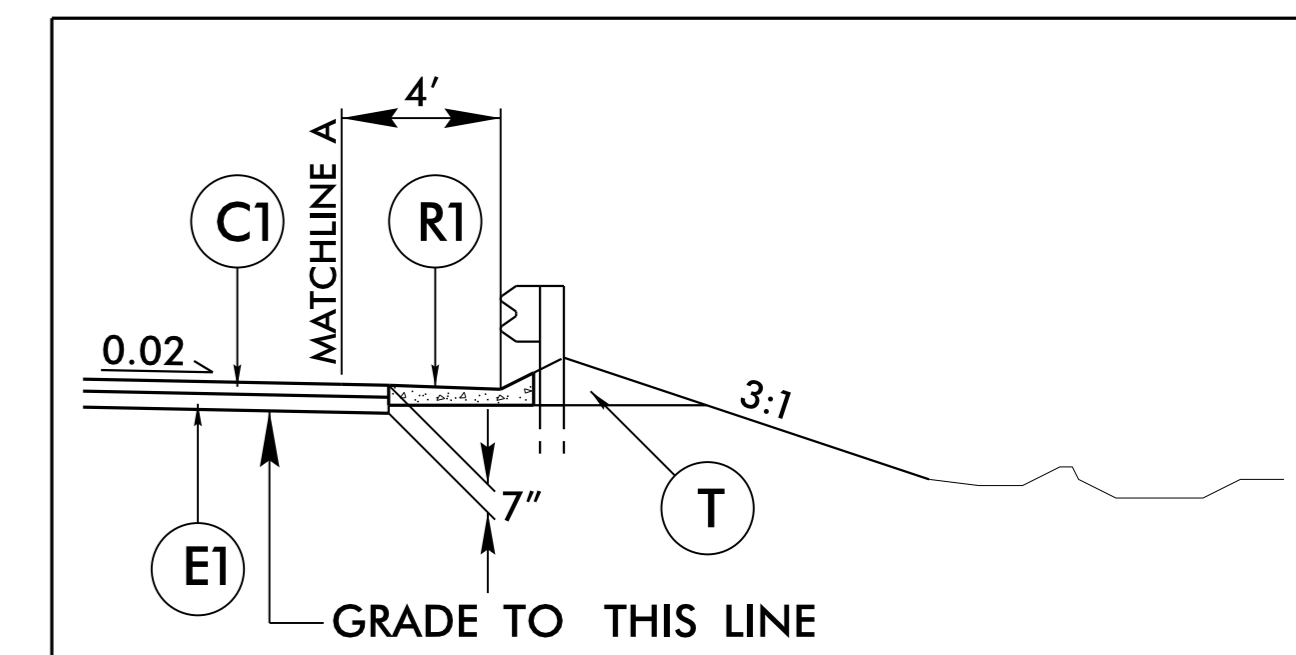

USE INSET A IN CONJUNCTION WITH TYPICAL SECTION No. 2

SEE PLANS FOR LOCATIONS

18-AUG-2015 10:02 \B-3868-Pd.dwg -tjg.dgn