

**This electronic collection of documents is provided
for the convenience of the user
and is Not a Certified Document –**

**The documents contained herein were originally issued
and sealed by the individuals whose names and license
numbers appear on each page, on the dates appearing
with their signature on that page.**

**This file or an individual page
shall not be considered a certified document.**

09.028/95
 SYSTEM\$\$\$\$
 DGN\$\$\$\$
 USER\$\$\$\$
 NAME\$\$\$\$

TIP PROJECT: W-5519

STATE OF NORTH CAROLINA
DIVISION OF HIGHWAYS

T.I.P. NO.	SHEET NO.
W-5519	UO-1

UTILITIES BY OTHERS PLANS CUMBERLAND COUNTY

LOCATION: I-95 BUSINESS /US 301 FROM NC 87 SOUTH
TO NC 59

TYPE OF WORK: UTILITIES BY OTHERS

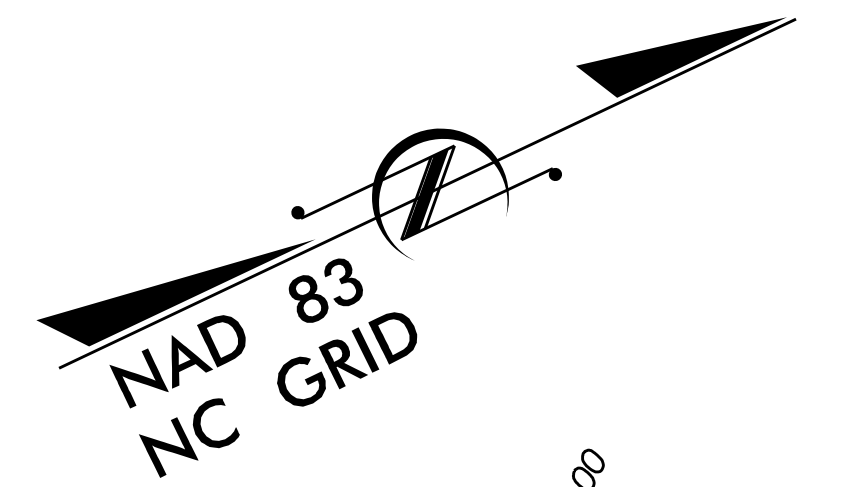
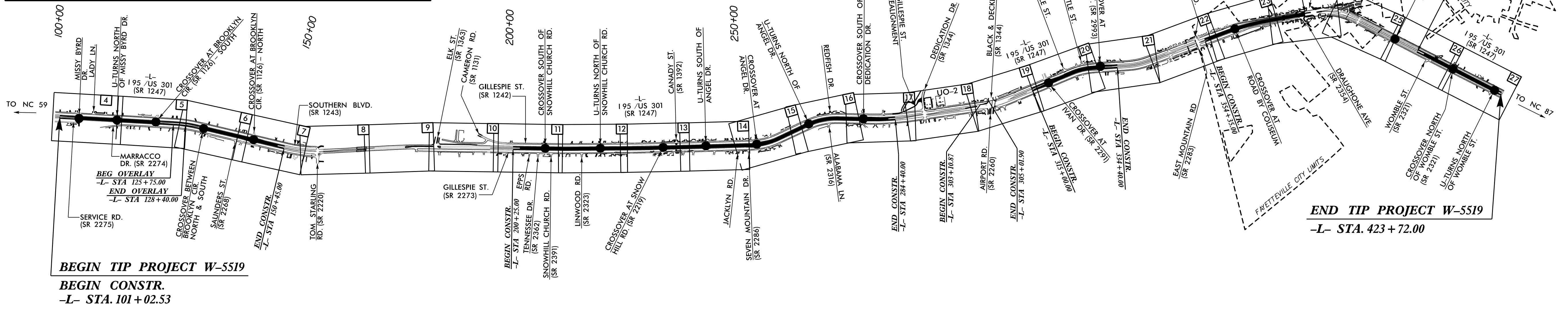
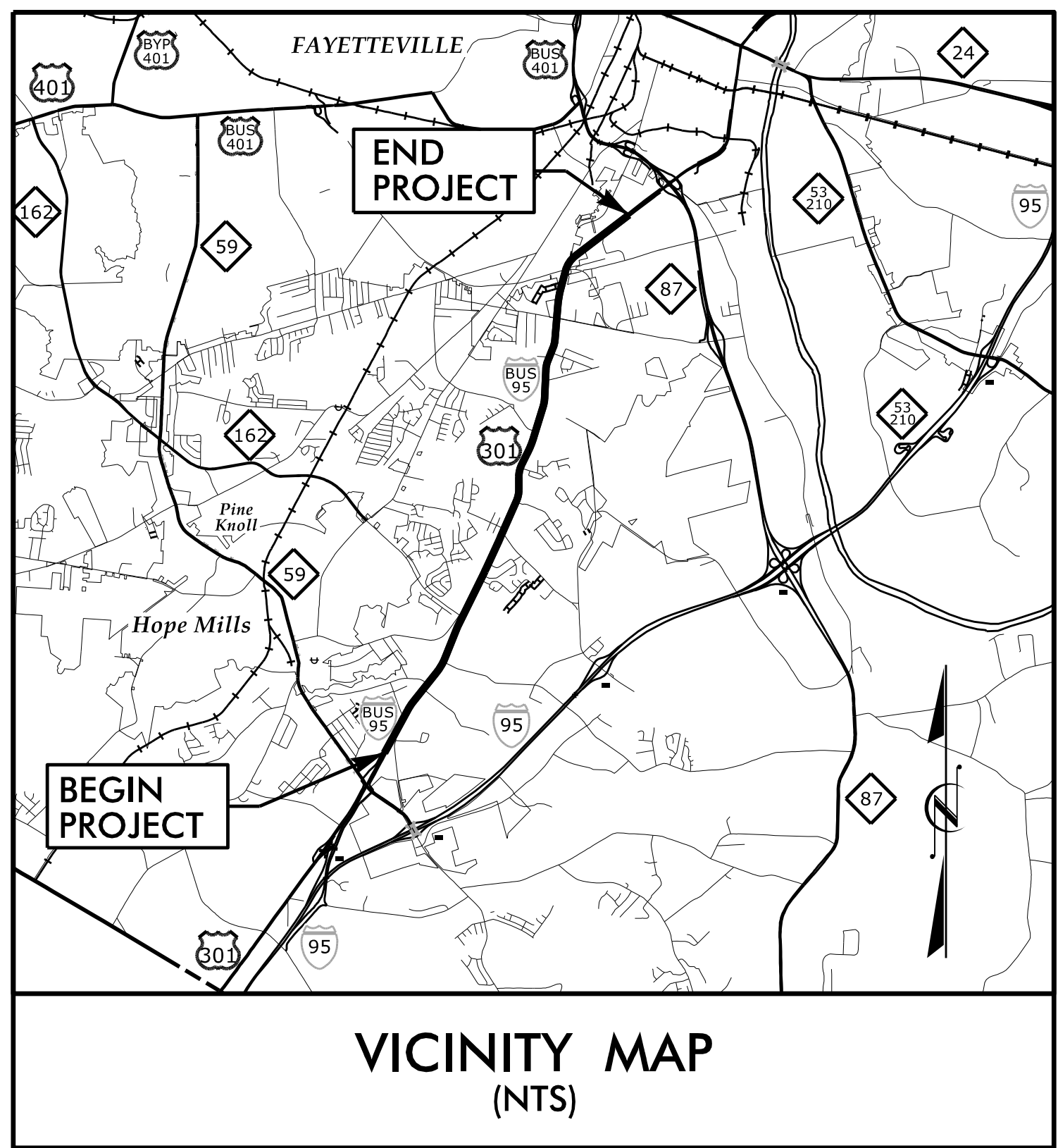

NCDOT CONTACT: SEAN MATUSZEWSKI
PROJECT ENGINEER - DIVISION DESIGN CONSTRUCTION

A PORTION OF THIS PROJECT IS WITHIN MUNICIPAL BOUNDARIES OF
THE CITY OF FAYETTEVILLE, N.C.

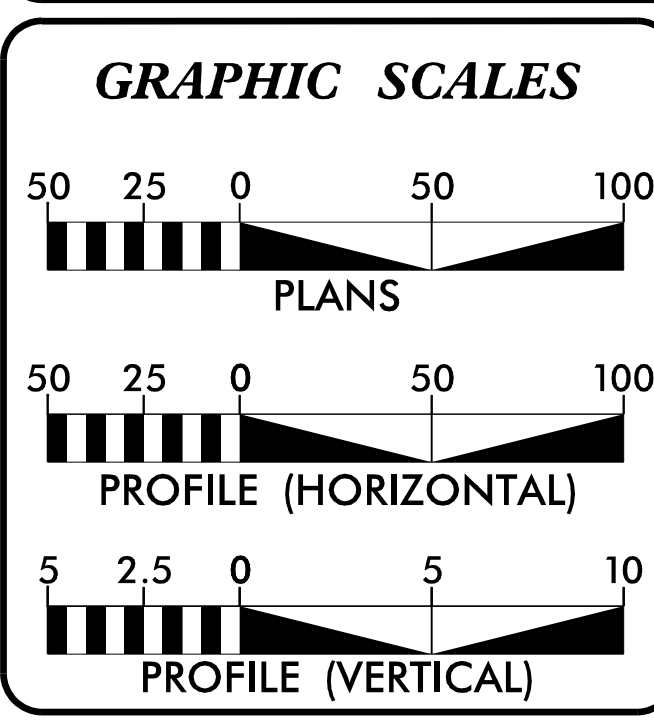

INDEX OF SHEETS	
SHEET NO.	DESCRIPTION
UO-1	TITLE SHEET
UO-2	UTILITIES BY OTHERS SHEET

UTILITY OWNERS ON PROJECT

POWER TRANSMISSION - FAYETTEVILLE PWC
 POWER DISTRIBUTION - FAYETTEVILLE PWC
 TELEPHONE - CENTURYLINK
 CATV - TIME WARNER

PREPARED IN THE OFFICE OF:

DAVIS • MARTIN • POWELL
ENGINEERS & SURVEYORS

6415 OLD PLANK RD, HIGH POINT, NC 27265
 PHONE: (336)886-4821 FAX: (336)886-4458
 WWW.DMP-INC.COM LICENSE: F-0245

Randy McNeill, P.E. UTILITIES PROJECT MANAGER
Andy Larrick, P.E. UTILITIES PROJECT ENGINEER
Ralph Lowe UTILITIES PROJECT DESIGNER

**DIVISION OF HIGHWAYS
UTILITIES UNIT
UTILITIES ENGINEERING**

1555 MAIL SERVICE CENTER
 RALEIGH, NC 27699-1555
 PHONE (919) 707-6690
 FAX (919) 250-4151

Roger Worthington, P.E. UTILITIES SECTION ENGINEER
Bo Hemphill, P.E. UTILITIES SQUAD LEADER PROJECT ENGINEER
Kelvin Martin, E.I. UTILITIES PROJECT DESIGN ENGINEER

UTILITIES BY OTHERS

NOTE:
ALL PROPOSED UTILITY WORK
SHOWN ON THIS SHEET WILL
BE DONE BY OTHERS

LEGEND

- ⊕ PROPOSED JOINT-USE UTILITY POLE
- ⊙ PROPOSED POWER POLE
- ⊖ PROPOSED TELEPHONE POLE

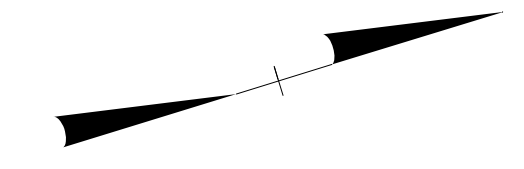
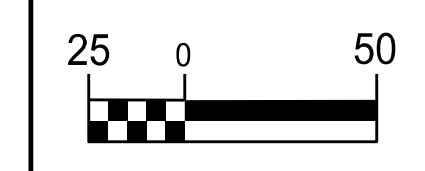

-SRI-
PI Sta 21+87.13
Δ = 54' 16" 39.4" (RT)
D = 57' 17" 44.8"
L = 94.73'
T = 51.26'
R = 100.00'

-L-
PI Sta 282+84.62
Δ = 10' 0" 11.8" (LT)
D = 0' 57" 17.7"
L = 1,049.29'
T = 525.98'
R = 6,000.00'

-Y14-
PI Sta 12+20.24
Δ = 27' 47" 58.4" (LT)
D = 10' 48" 37.9"
L = 257.15'
T = 131.16'
R = 530.00'

Crest
297+88

297+88
Crest

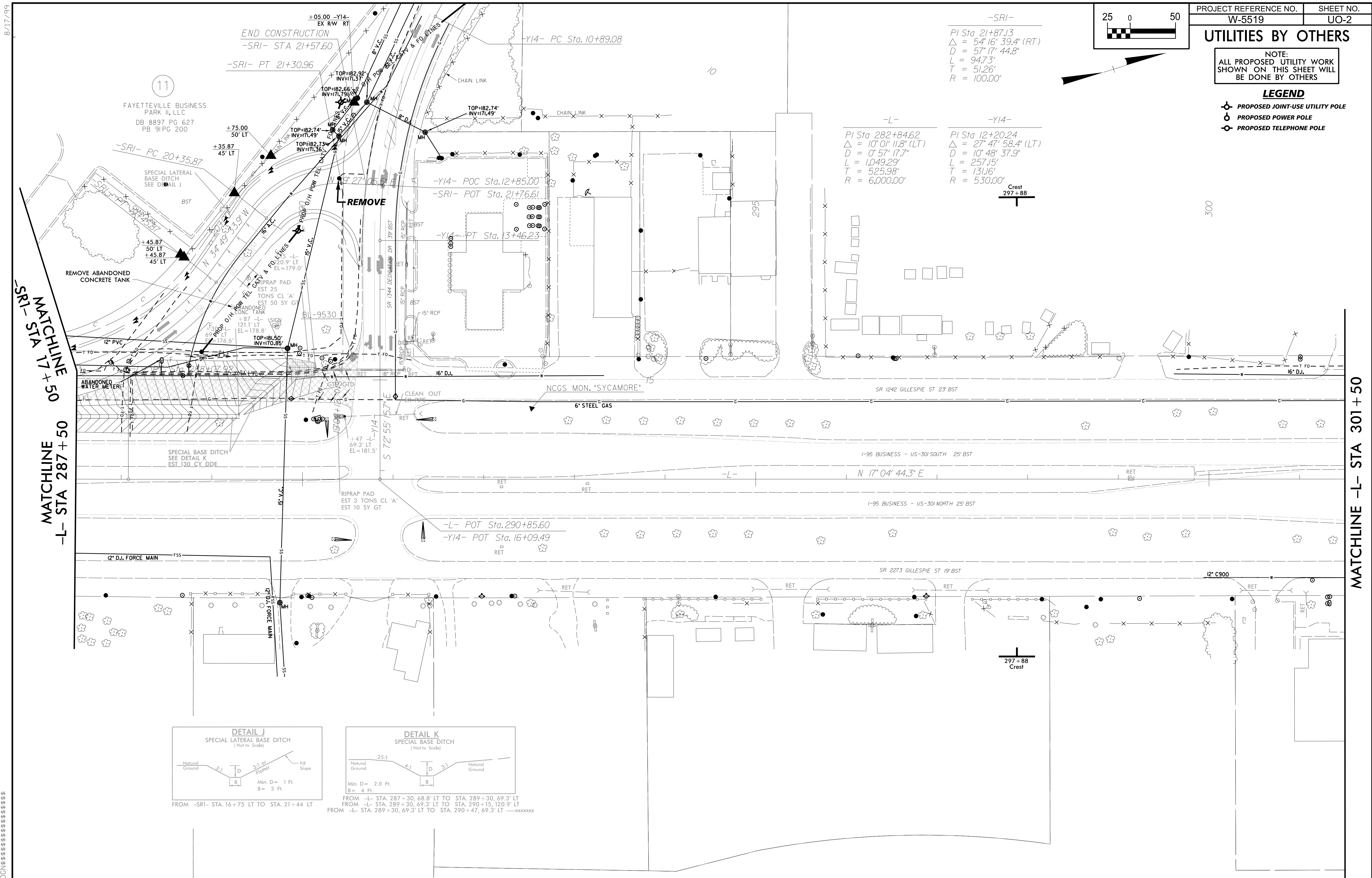

MATCHLINE STA 17+50
-SRI-
MATCHLINE STA 287+50
-L-

MATCHLINE -L- STA 301+50

