

-L-
 PI Sta 326+78.01
 $\Delta = 18' 55' 53.1''$ (RT)
 $D = 3' 49' 11.0''$
 $L = 495.62'$
 $T = 250.09'$
 $R = 1,500.00'$

NOTE:
 SILT FENCE AND COIR FIBER WATTLE BREAKS
 SHALL BE INSTALLED AS DIRECTED BY ENGINEER.

-L-
 PI Sta 338+87.49
 $\Delta = 16' 44' 09.9''$ (LT)
 $D = 3' 49' 11.0''$
 $L = 438.15'$
 $T = 220.65'$
 $R = 1,500.00'$

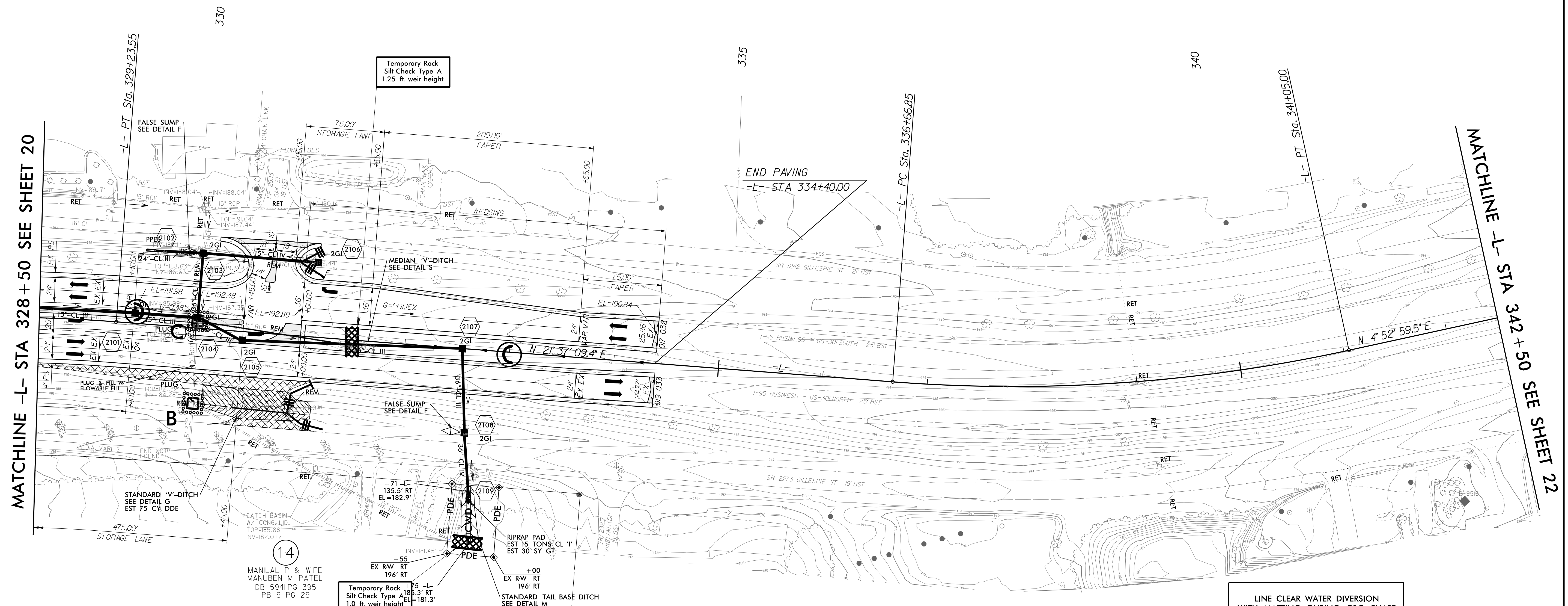
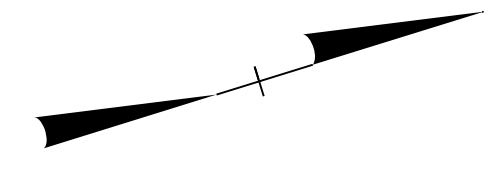

MATCHLINE -L- STA 328+50 SEE SHEET 20

MATCHLINE -L- STA 342+50 SEE SHEET 22

CLEARING AND GRUBBING
 EROSION CONTROL FOR
 CONSTRUCTION SHEET 21

NOTE:
 PLACE TEMPORARY ROCK SEDIMENT DAMS TYPE - B
 AND TEMPORARY ROCK SILT CHECKS TYPE - A AT
 DRAINAGE OUTLETS.

NOTE:
 PERIMETER EROSION CONTROL MEASURES SHALL BE
 INSTALLED DURING CLEARING AND GRUBBING PHASE.

Place Matting for Erosion Control in
 Temporary Ditches and Diversions.

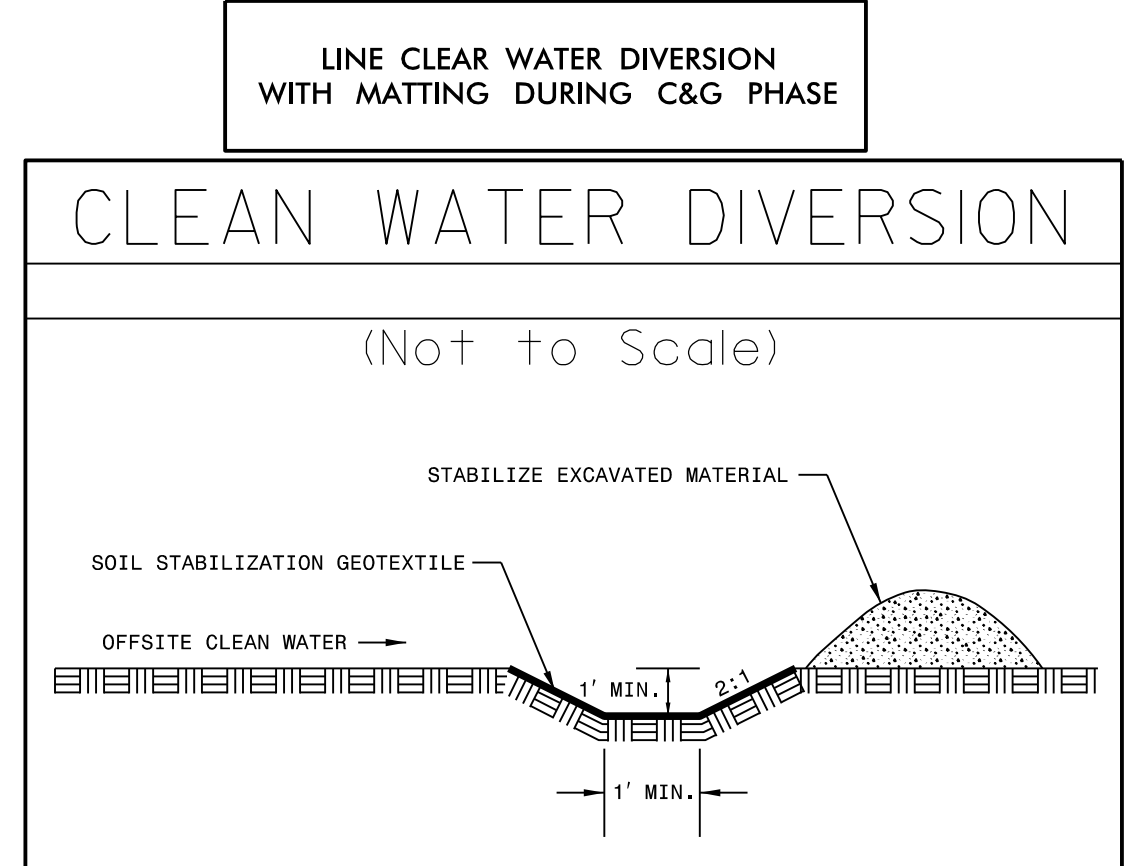
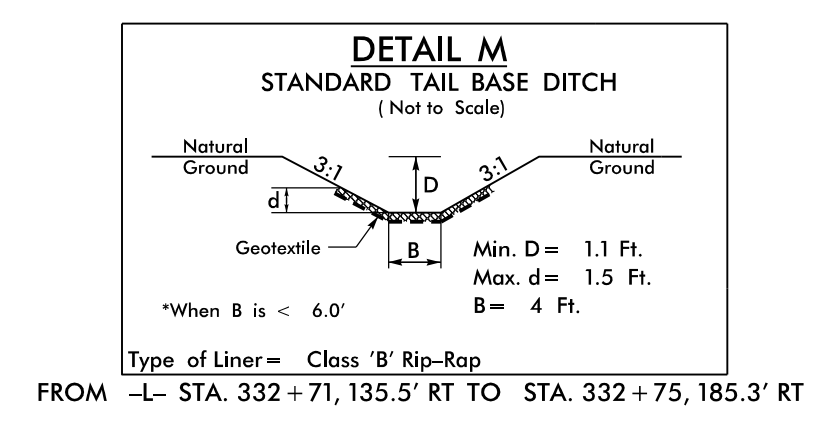
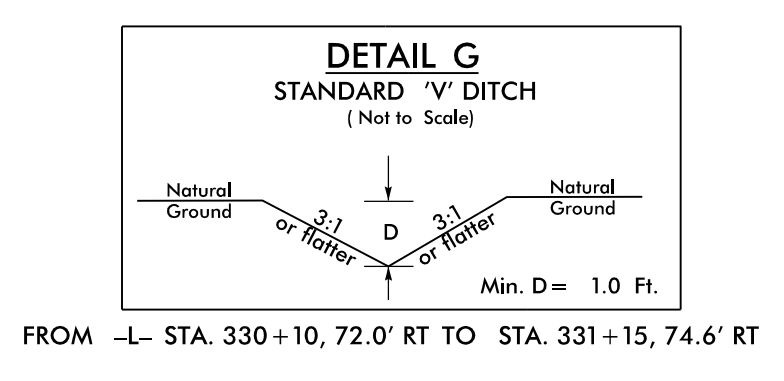
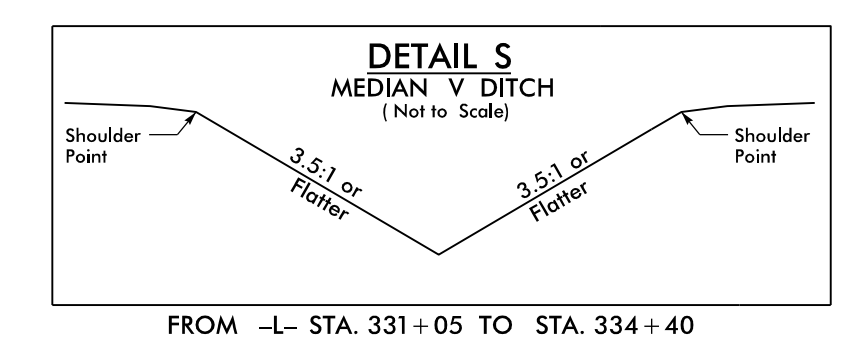
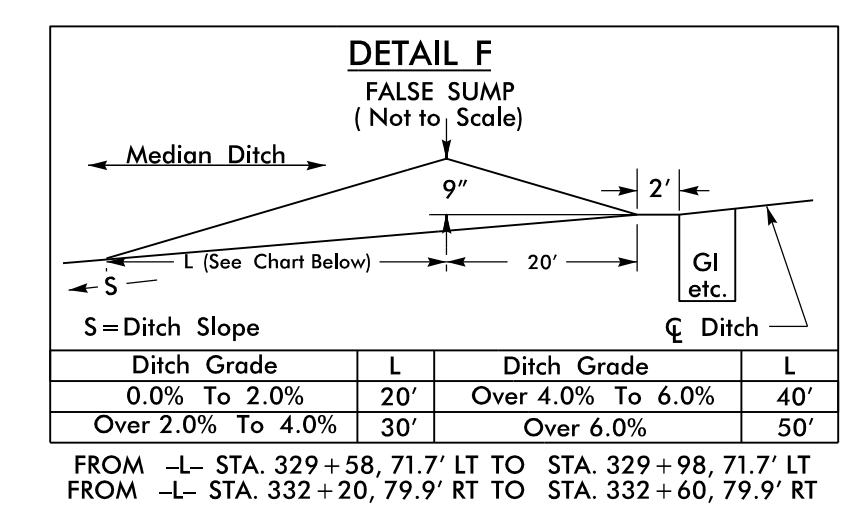

8/17/99
 9/4/2015
 R:\Roads\de W-5519_REL\PSH21_LG.dgn
 Local User