

PROJ. REFERENCE NO.	SHEET NO.
W-5519	TMP-16

**RAMEY KEMP ASSOCIATES, INC.**  
 Transportation Engineers  
 5808 Faringdon Place, Suite 100  
 Raleigh, North Carolina 27609  
 919-872-5115 Tel. 919-878-5416 Fax.  
 www.rameykemp.com  
 NC License No. C-0910

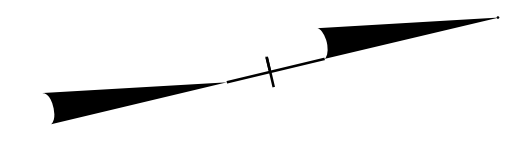

**SECTION 5 251+00 +/- TO 271+00 +/-**  
**SECTION 6 271+00 +/- TO 287+30 +/-**

SECTION NOTE: ADJACENT SECTIONS ARE NOT TO BE CONSTRUCTED AT THE SAME TIME. CONTRACTOR TO PROVIDE APPROPRIATE MERGE TAPER AND BUFFER SPACING PER NCDOT RSD 1101.02 (SHEET 3 OF 15) FOR EACH SECTION. (SEE PHASING NOTES FOR SEQUENCING.)

CONSTRUCTION

NOTE: MAINTAIN ACCESS TO NEARBY CROSSOVER WITHIN 1 MILE OF WORK AREA AT ALL TIMES.

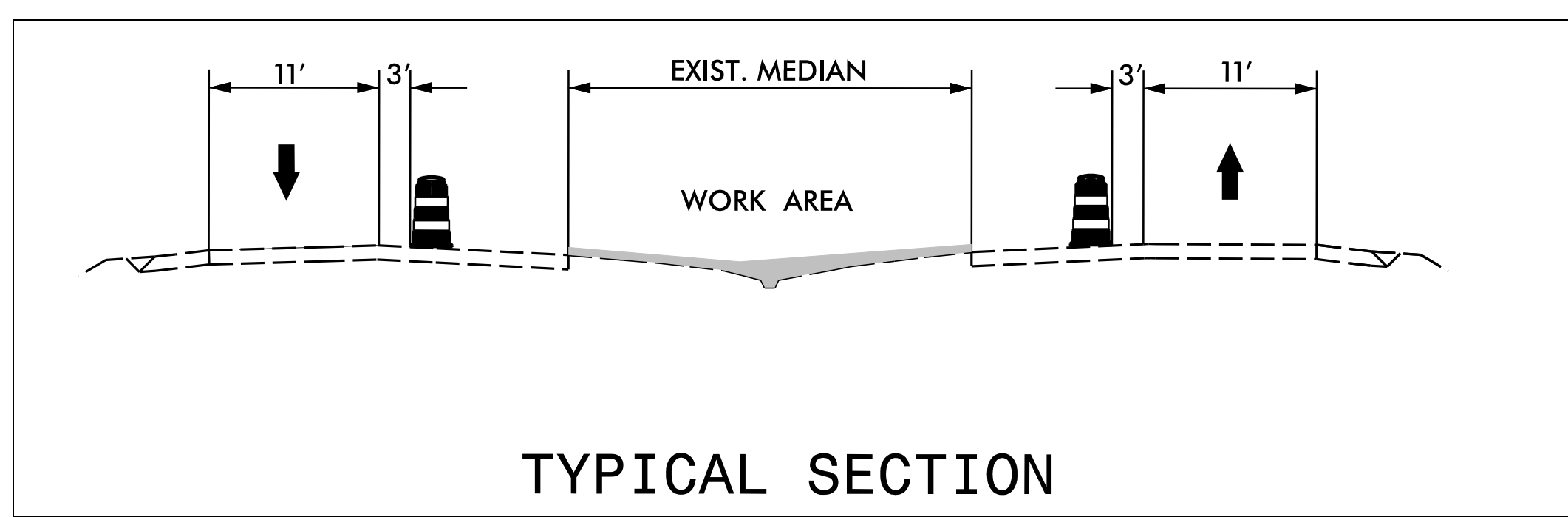
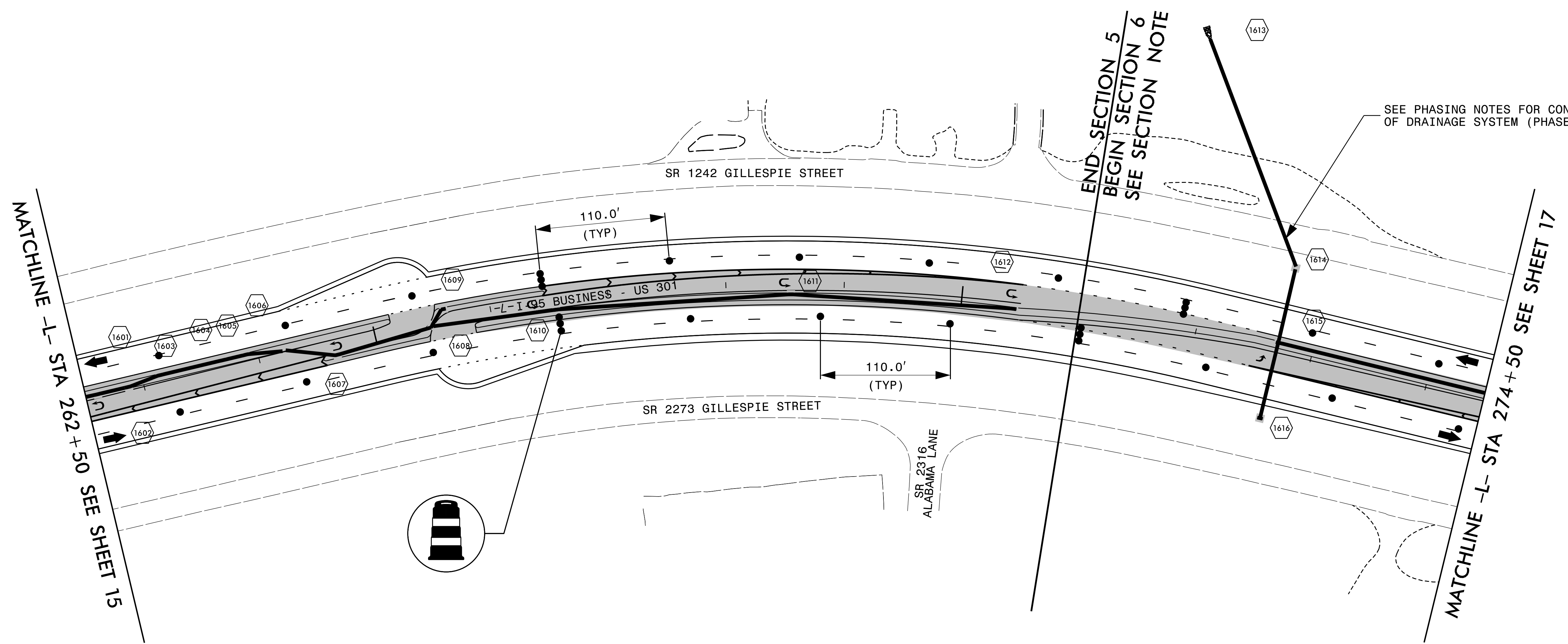

APPROVED: _____ DATE: _____	<b>PHASE II</b>		
DocuSigned by: Merrick A. Dugal 39B7F44BDD562E SEAL NORTH CAROLINA PROFESSIONAL ENGINEER SEAL 022609 ENGINEER MERRICK A. DUGAL 10/28/2015	SCALE: 1"=50'	Prepared For:	
	DATE:		
	DEVELOPED BY: DAJ		REVISIONS
	REVIEWED BY: MAD		
RKA PROJ. #: 14071	CADD FILE		