

### SINGLE PUSH BUTTON

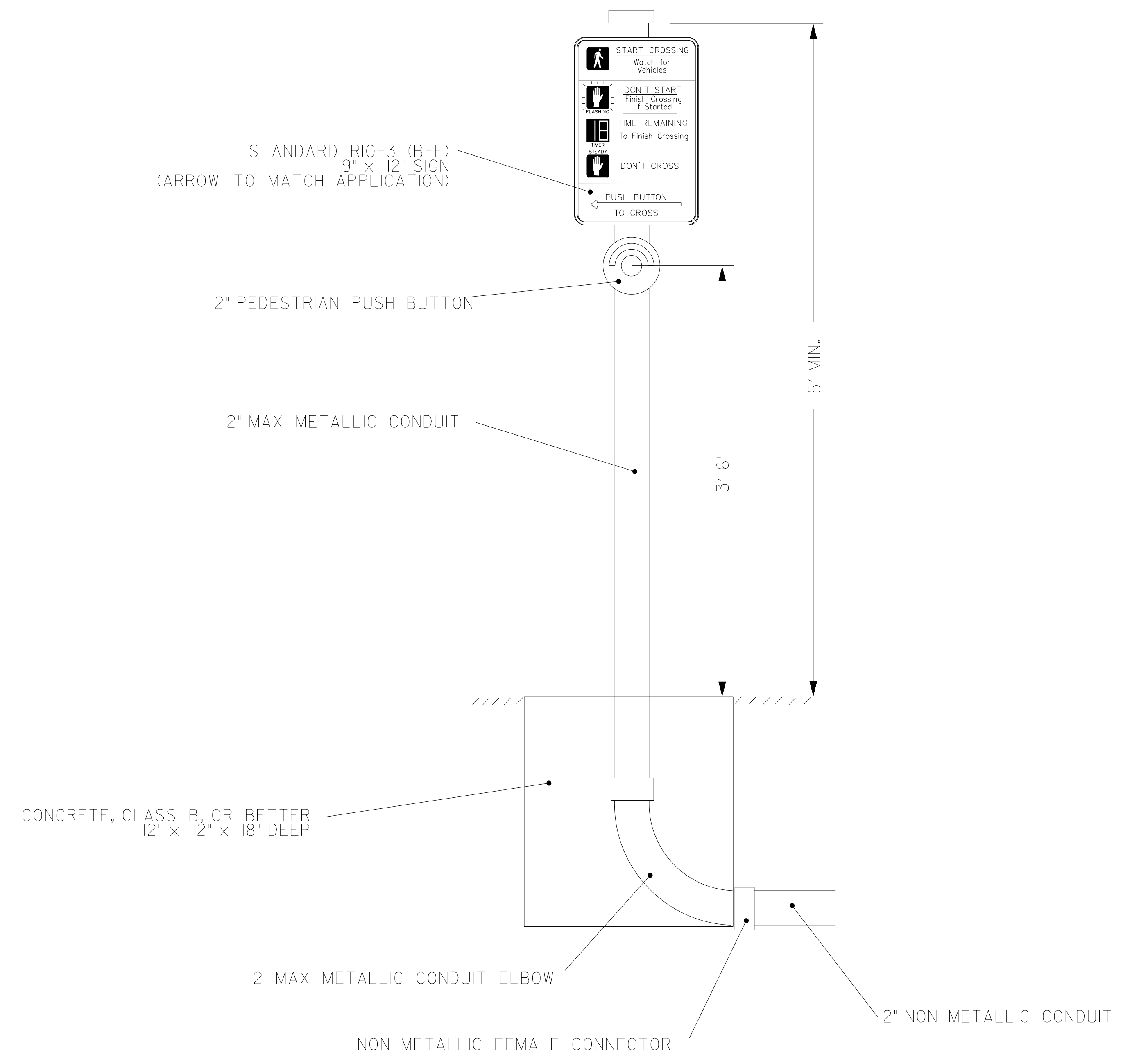

### DUAL PUSH BUTTONS

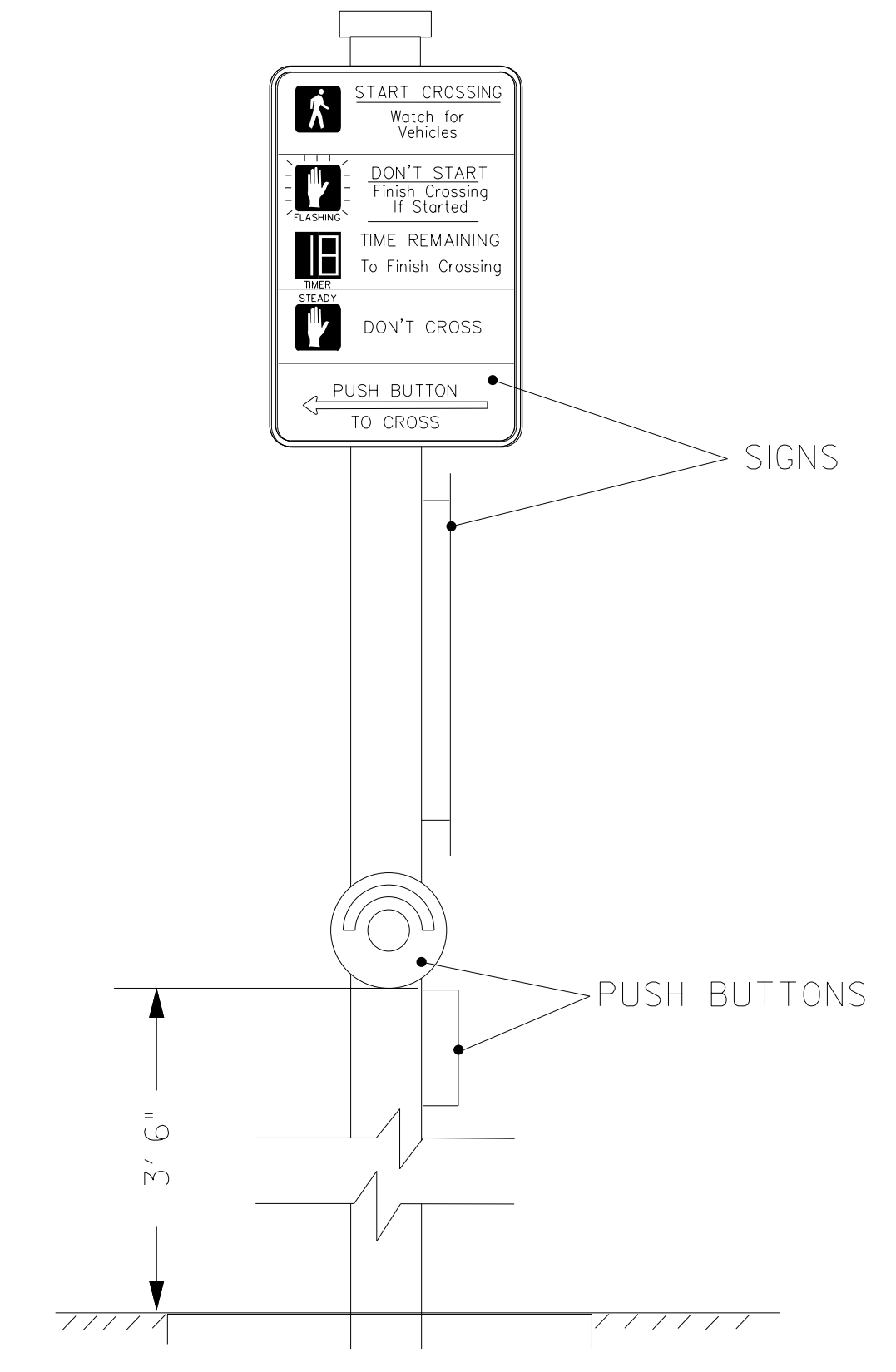

### NOTE

CONNECT PUSHBUTTON TO CONTROLLER CABINET USING LEAD-IN CABLE. BOND PUSH BUTTON HOUSING AND ALL METAL COMPONENTS TO CABINET GROUND USING CABLE GROUND.

13-JUL-2015 01:37  
 D:\Transportation\Projects\Curran\100036295\_U33388\_Kerr\_S19\_LTS\Signal\Signal\Station\Crosswalk\PedPost\SpecialDetail.dgn  
 FILED054 - AT 02520740

**ATKINS** 1616 EAST MILLBROOK ROAD, SUITE 310  
 RALEIGH, NORTH CAROLINA 27609  
 (919) 876-8888 NCBEES #F-0326

### Special Detail

	<b>Temporary Pedestrian Posts for Push Buttons</b>								
	Division 03 New Hanover County Wilmington								
	PLAN DATE: June 2014 PREPARED BY: LM Moon	REVIEWED BY: MB Toth							
SCALE: Not to Scale		<table border="1"> <thead> <tr> <th>REVISIONS</th> <th>INIT.</th> <th>DATE</th> </tr> </thead> <tbody> <tr> <td> </td> <td> </td> <td> </td> </tr> </tbody> </table>	REVISIONS	INIT.	DATE				DocuSigned by:  12/19/2014 DATE
REVISIONS	INIT.	DATE							
750 N. Greenfield Pkwy, Garner, NC 27529		SIG. INVENTORY NO. SD-01							