

-Y7A-

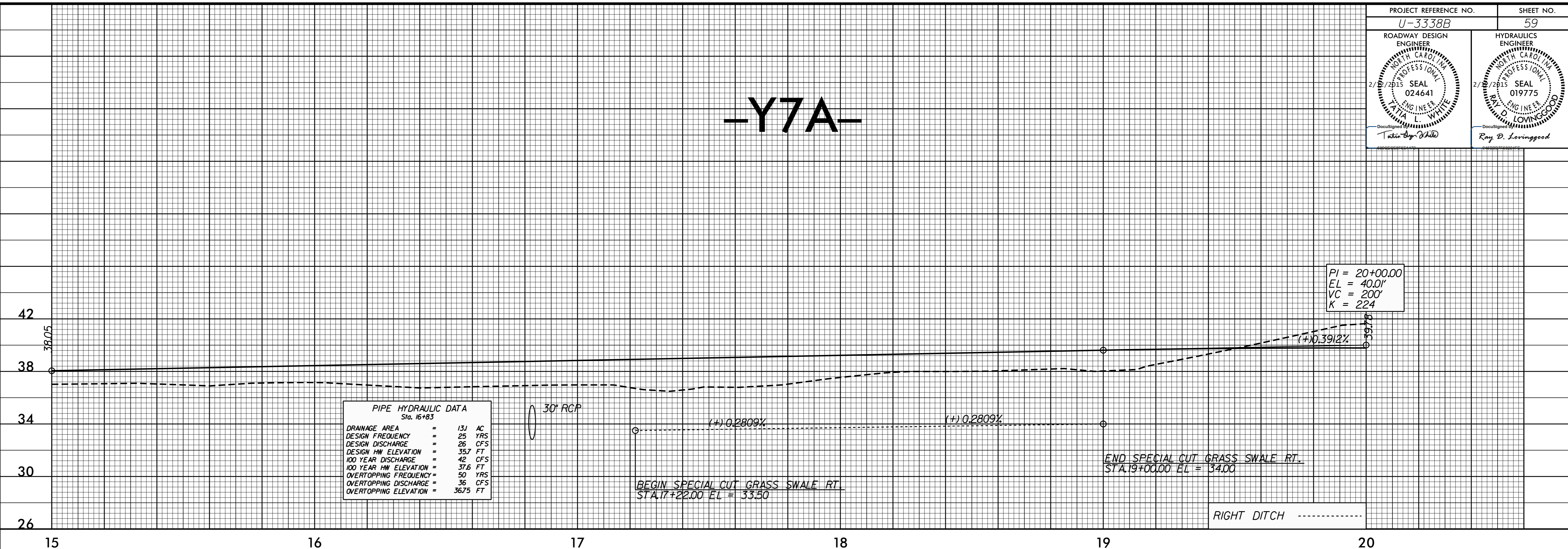

PIPE HYDRAULIC DATA	
Sta. 16+83	
DRAINAGE AREA	= 131 AC
DESIGN FREQUENCY	= 25 YRS
DESIGN DISCHARGE	= 26 CFS
DESIGN HW ELEVATION	= 35.7 FT
100 YEAR DISCHARGE	= 42 CFS
100 YEAR HW ELEVATION	= 37.6 FT
OVERTOPPING FREQUENCY	= 50 YRS
OVERTOPPING DISCHARGE	= 36 CFS
OVERTOPPING ELEVATION	= 36.75 FT

-Y7A-

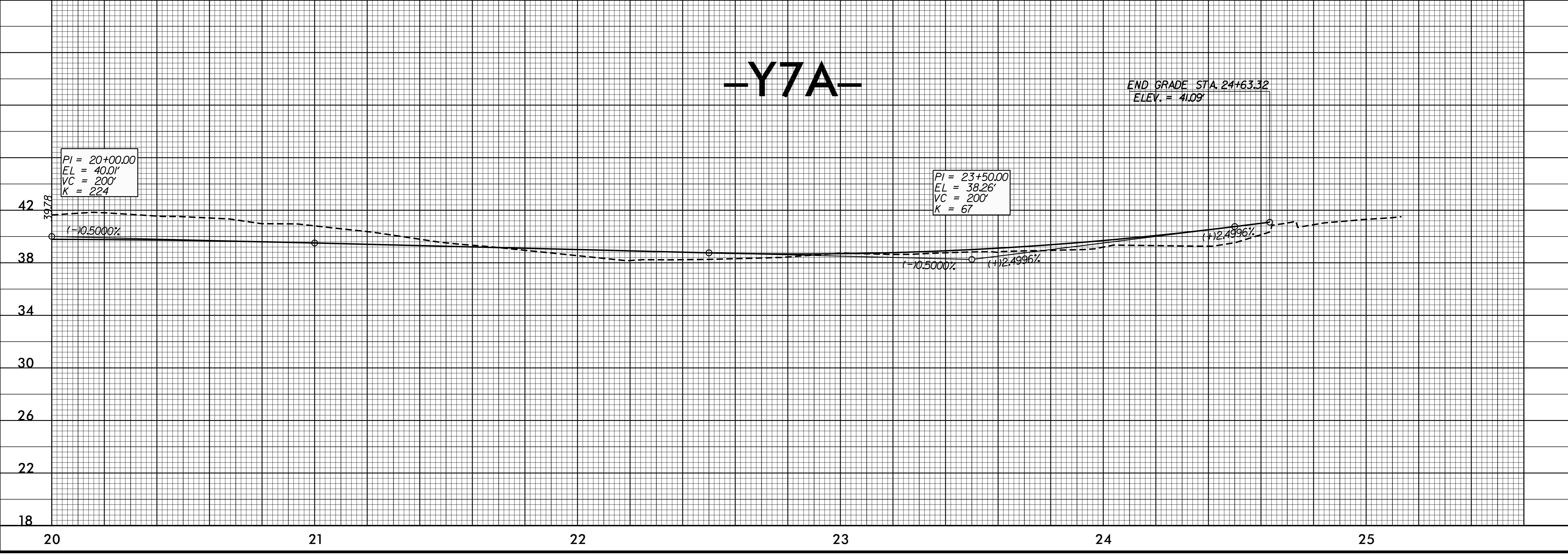

PI = 20+00.00
EL = 40.01
VC = 200'
K = 224

PI = 23+50.00
EL = 38.26
VC = 200'
K = 67

END GRADE STA. 24+63.32
ELEV. = 41.09'