

MATCHLINE -Y1- STA.16+50 SEE SHEET 21

PROJECT REFERENCE NO. U-3338B	SHEET NO. 5
RW SHEET NO.	
ROADWAY DESIGN ENGINEER PROFESSIONAL SEAL 024641	HYDRAULICS ENGINEER PROFESSIONAL SEAL 019775
<i>T. J. White</i>	<i>Ray D. Loringgood</i>

NAD 83/95

RPP HOLDINGS, LLC
 DB 5751 PG 91
 DB 1282 PG 1856
 DB 1460 PG 843
 MB 13 PG 33
 DB 5644 PG 2770
 DB 5684 PG 2877
 DB 5645 PG 2278

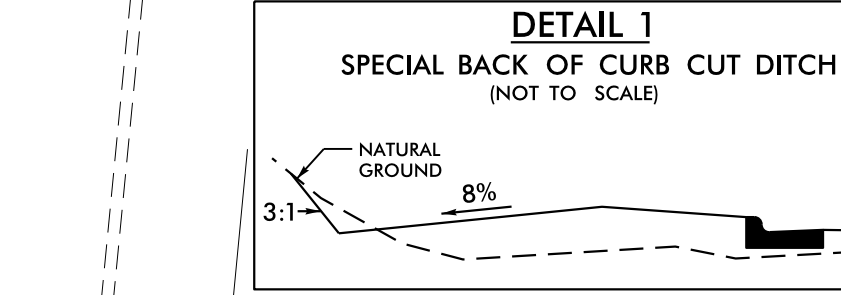
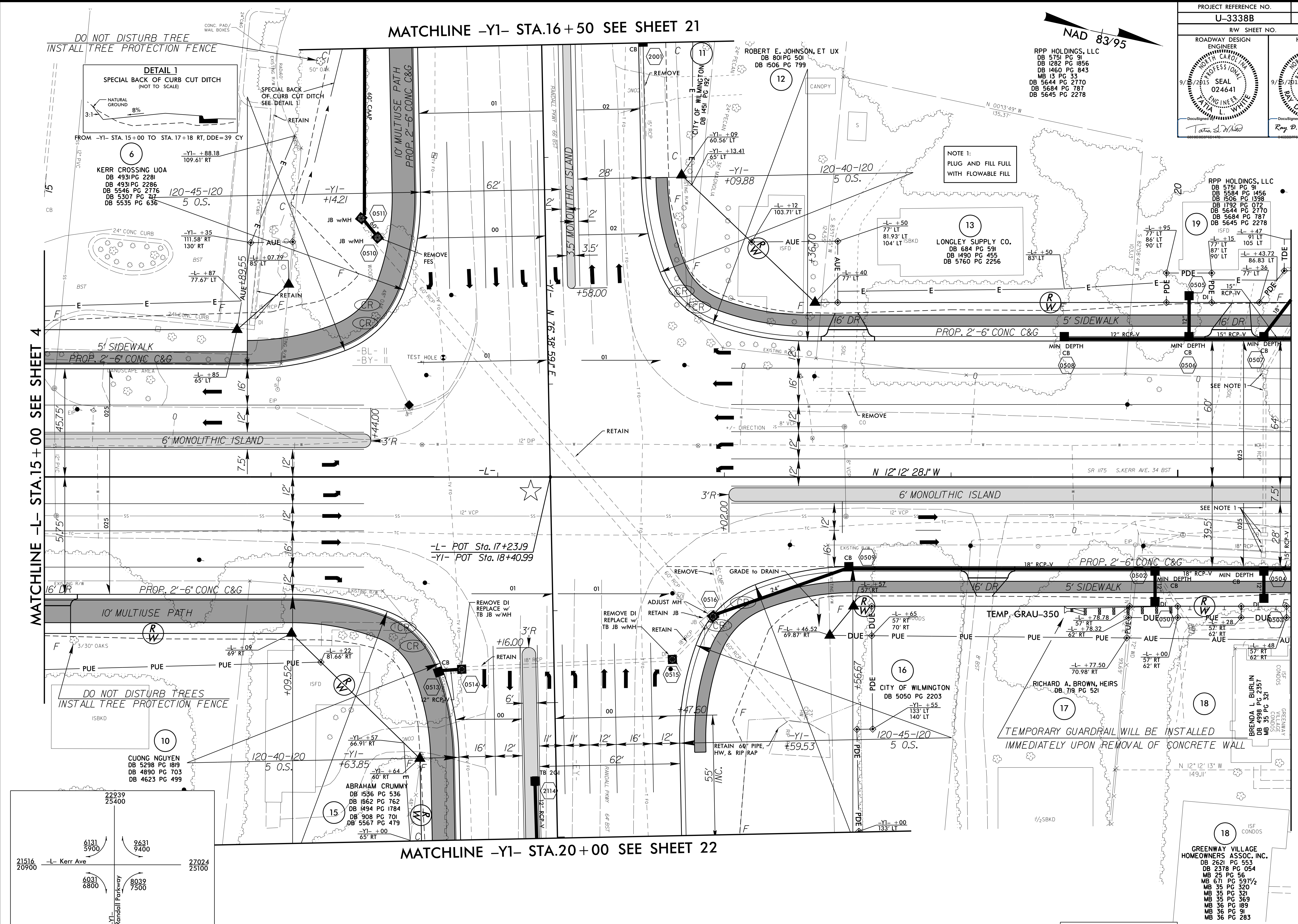

FROM -Y1- STA. 15+00 TO STA. 17+18 RT, DDE=39 CY

6
KERR CROSSING UOA
 DB 4931 PG 2281
 DB 4931 PG 2286
 DB 5546 PG 2776
 DB 5307 PG 247
 DB 5535 PG 636

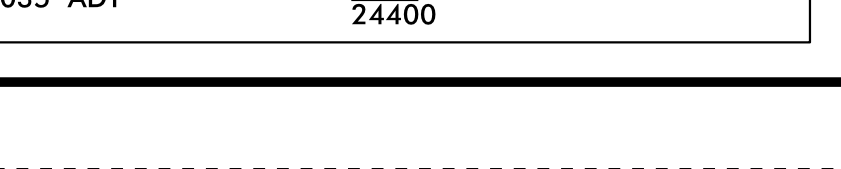
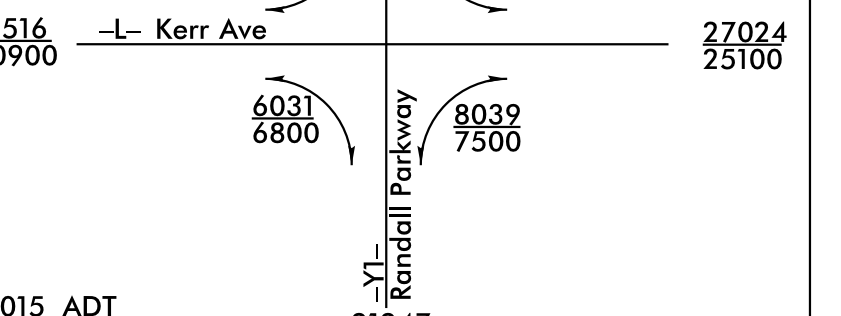
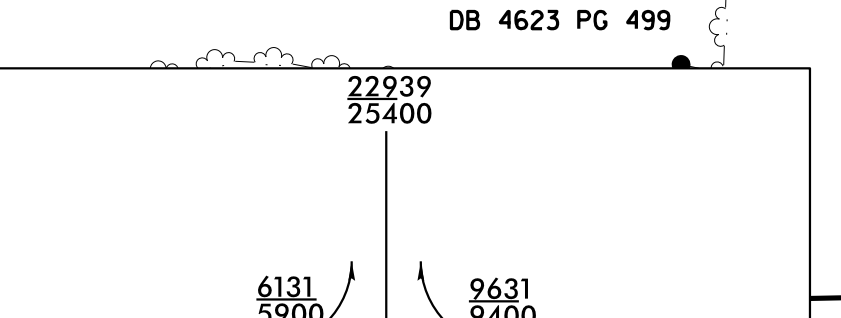
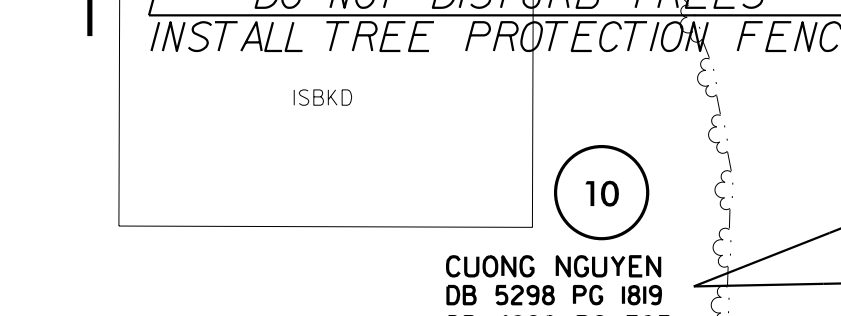
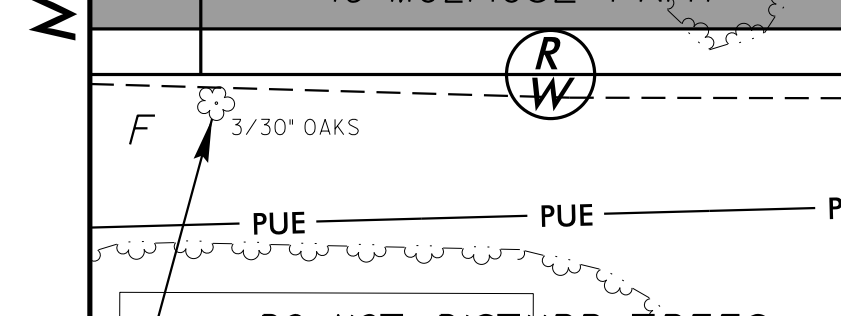
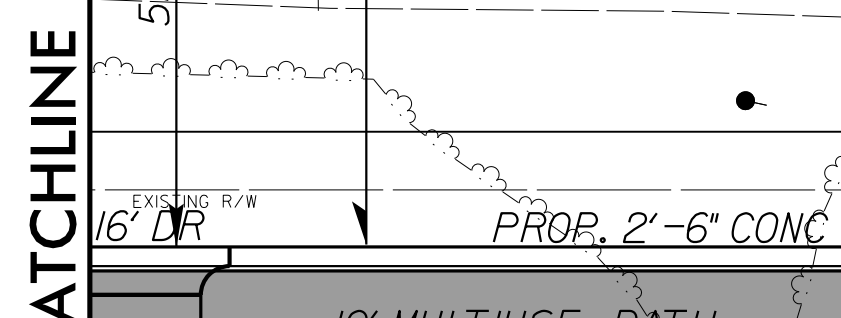
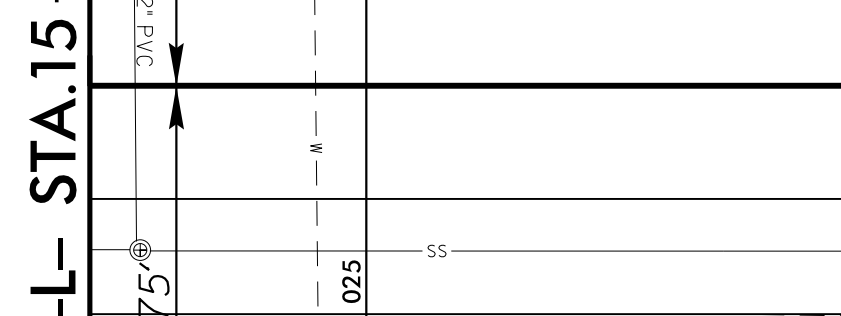
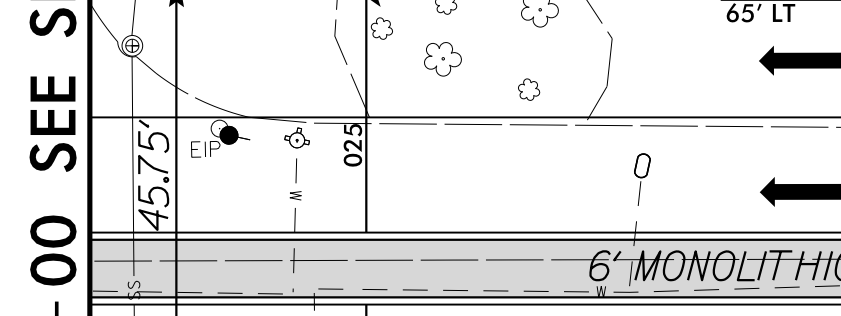
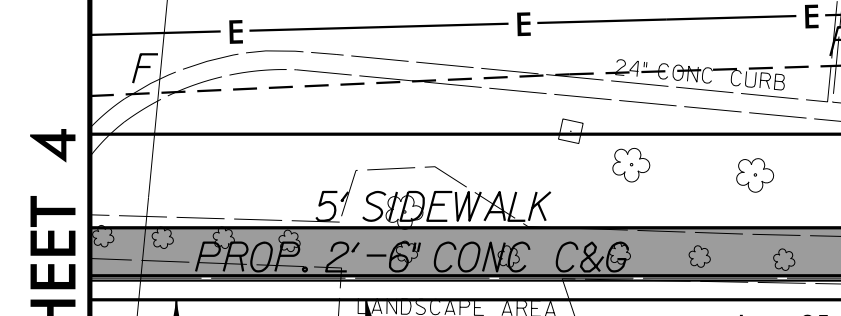
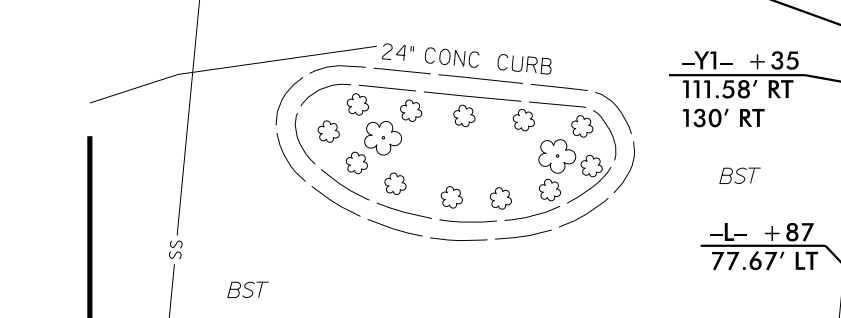

MATCHLINE -Y1- STA.20+00 SEE SHEET 22

MATCHLINE -L- STA.15+00 SEE SHEET 4

MATCHLINE -L- STA.20+50 SEE SHEET 6

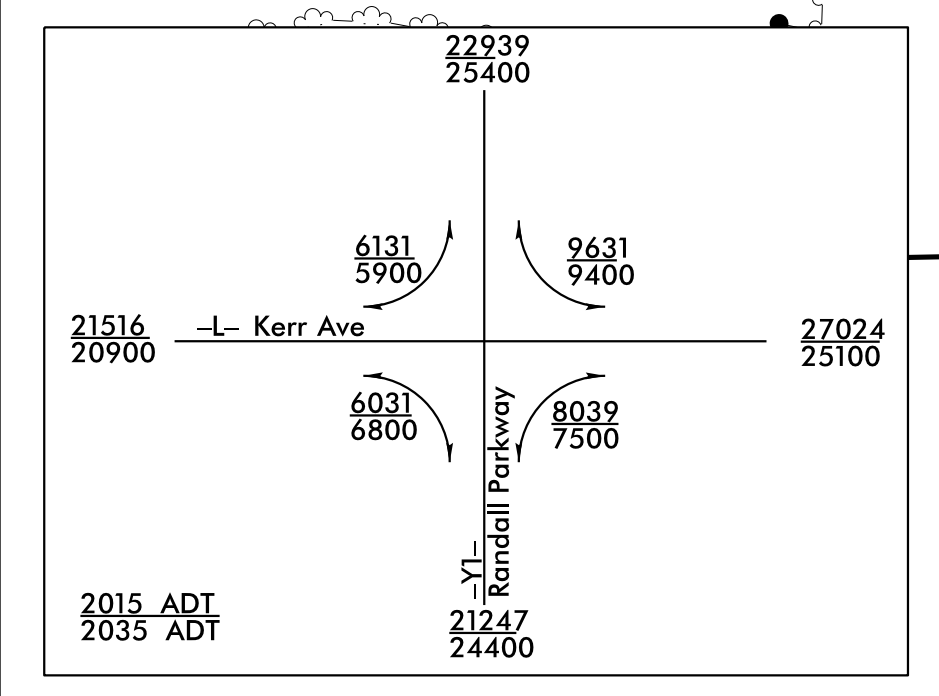

★ REVISED SIGNAL

FOR -L- PROFILE SEE SHEET 42
 FOR -Y1- PROFILE SEE SHEET 51

18
GREENWAY VILLAGE HOMEOWNERS ASSOC., INC.
 DB 2621 PG 55
 DB 2378 PG 054
 MB 25 PG 56
 MB 671 PG 597 1/2
 MB 35 PG 320
 MB 35 PG 321
 MB 35 PG 369
 MB 36 PG 189
 MB 36 PG 91
 MB 36 PG 283

TEMPORARY GUARDRAIL WILL BE INSTALLED IMMEDIATELY UPON REMOVAL OF CONCRETE WALL

TEMP. GRAU-350

RICHARD A. BROWN, HEIRS
 DB 719 PG 521

16
CITY OF WILMINGTON
 DB 5050 PG 2203

17
120-45-120
5 O.S.

18
ISFD CONDOS

19
RPP HOLDINGS, LLC
 DB 5751 PG 91
 DB 5584 PG 1456
 DB 1506 PG 1398
 DB 1792 PG 072
 DB 5644 PG 2770
 DB 5684 PG 2877
 DB 5645 PG 2278

20
RPP HOLDINGS, LLC
 DB 5751 PG 91
 DB 5584 PG 1456
 DB 1506 PG 1398
 DB 1792 PG 072
 DB 5644 PG 2770
 DB 5684 PG 2877
 DB 5645 PG 2278

21
ROBERT E. JOHNSON, ET UX
 DB 801 PG 501
 DB 1506 PG 799

22
ABRAHAM CRUMMY
 DB 1536 PG 536
 DB 1562 PG 762
 DB 1494 PG 1784
 DB 908 PG 701
 DB 5567 PG 479

23
CUONG NGUYEN
 DB 5298 PG 1819
 DB 4890 PG 703
 DB 4623 PG 499

24
KERR CROSSING UOA
 DB 4931 PG 2281
 DB 4931 PG 2286
 DB 5546 PG 2776
 DB 5307 PG 247
 DB 5535 PG 636

25
LONGLEY SUPPLY CO.
 DB 684 PG 591
 DB 1490 PG 455
 DB 5760 PG 2256

26
RPP HOLDINGS, LLC
 DB 5751 PG 91
 DB 5584 PG 1456
 DB 1506 PG 1398
 DB 1792 PG 072
 DB 5644 PG 2770
 DB 5684 PG 2877
 DB 5645 PG 2278

27
RPP HOLDINGS, LLC
 DB 5751 PG 91
 DB 5584 PG 1456
 DB 1506 PG 1398
 DB 1792 PG 072
 DB 5644 PG 2770
 DB 5684 PG 2877
 DB 5645 PG 2278

28
GREENWAY VILLAGE HOMEOWNERS ASSOC., INC.
 DB 2621 PG 55
 DB 2378 PG 054
 MB 25 PG 56
 MB 671 PG 597 1/2
 MB 35 PG 320
 MB 35 PG 321
 MB 35 PG 369
 MB 36 PG 189
 MB 36 PG 91
 MB 36 PG 283

29
RPP HOLDINGS, LLC
 DB 5751 PG 91
 DB 5584 PG 1456
 DB 1506 PG 1398
 DB 1792 PG 072
 DB 5644 PG 2770
 DB 5684 PG 2877
 DB 5645 PG 2278

30
RPP HOLDINGS, LLC
 DB 5751 PG 91
 DB 5584 PG 1456
 DB 1506 PG 1398
 DB 1792 PG 072
 DB 5644 PG 2770
 DB 5684 PG 2877
 DB 5645 PG 2278

31
ROBERT E. JOHNSON, ET UX
 DB 801 PG 501
 DB 1506 PG 799

32
ABRAHAM CRUMMY
 DB 1536 PG 536
 DB 1562 PG 762
 DB 1494 PG 1784
 DB 908 PG 701
 DB 5567 PG 479

33
CUONG NGUYEN
 DB 5298 PG 1819
 DB 4890 PG 703
 DB 4623 PG 499

34
KERR CROSSING UOA
 DB 4931 PG 2281
 DB 4931 PG 2286
 DB 5546 PG 2776
 DB 5307 PG 247
 DB 5535 PG 636

35
LONGLEY SUPPLY CO.
 DB 684 PG 591
 DB 1490 PG 455
 DB 5760 PG 2256

36
RPP HOLDINGS, LLC
 DB 5751 PG 91
 DB 5584 PG 1456
 DB 1506 PG 1398
 DB 1792 PG 072
 DB 5644 PG 2770
 DB 5684 PG 2877
 DB 5645 PG 2278

37
RPP HOLDINGS, LLC
 DB 5751 PG 91
 DB 5584 PG 1456
 DB 1506 PG 1398
 DB 1792 PG 072
 DB 5644 PG 2770
 DB 5684 PG 2877
 DB 5645 PG 2278

38
GREENWAY VILLAGE HOMEOWNERS ASSOC., INC.
 DB 2621 PG 55
 DB 2378 PG 054
 MB 25 PG 56
 MB 671 PG 597 1/2
 MB 35 PG 320
 MB 35 PG 321
 MB 35 PG 369
 MB 36 PG 189
 MB 36 PG 91
 MB 36 PG 283

39
RPP HOLDINGS, LLC
 DB 5751 PG 91
 DB 5584 PG 1456
 DB 1506 PG 1398
 DB 1792 PG 072
 DB 5644 PG 2770
 DB 5684 PG 2877
 DB 5645 PG 2278

40
RPP HOLDINGS, LLC
 DB 5751 PG 91
 DB 5584 PG 1456
 DB 1506 PG 1398
 DB 1792 PG 072
 DB 5644 PG 2770
 DB 5684 PG 2877
 DB 5645 PG 2278

41
ROBERT E. JOHNSON, ET UX
 DB 801 PG 501
 DB 1506 PG 799

42
ABRAHAM CRUMMY
 DB 1536 PG 536
 DB 1562 PG 762
 DB 1494 PG 1784
 DB 908 PG 701
 DB 5567 PG 479

43
CUONG NGUYEN
 DB 5298 PG 1819
 DB 4890 PG 703
 DB 4623 PG 499

44
KERR CROSSING UOA
 DB 4931 PG 2281
 DB 4931 PG 2286
 DB 5546 PG 2776
 DB 5307 PG 247
 DB 5535 PG 636

45
LONGLEY SUPPLY CO.
 DB 684 PG 591
 DB 1490 PG 455
 DB 5760 PG 2256

46
RPP HOLDINGS, LLC
 DB 5751 PG 91
 DB 5584 PG 1456
 DB 1506 PG 1398
 DB 1792 PG 072
 DB 5644 PG 2770
 DB 5684 PG 2877
 DB 5645 PG 2278

47
RPP HOLDINGS, LLC
 DB 5751 PG 91
 DB 5584 PG 1456
 DB 1506 PG 1398
 DB 1792 PG 072
 DB 5644 PG 2770
 DB 5684 PG 2877
 DB 5645 PG 2278

48
GREENWAY VILLAGE HOMEOWNERS ASSOC., INC.
 DB 2621 PG 55
 DB 2378 PG 054
 MB 25 PG 56
 MB 671 PG 597 1/2
 MB 35 PG 320
 MB 35 PG 321
 MB 35 PG 369
 MB 36 PG 189
 MB 36 PG 91
 MB 36 PG 283

49
RPP HOLDINGS, LLC
 DB 5751 PG 91
 DB 5584 PG 1456
 DB 1506 PG 1398
 DB 1792 PG 072
 DB 5644 PG 2770
 DB 5684 PG 2877
 DB 5645 PG 2278

50
RPP HOLDINGS, LLC
 DB 5751 PG 91
 DB 5584 PG 1456
 DB 1506 PG 1398
 DB 1792 PG 072
 DB 5644 PG 2770
 DB 5684 PG 2877
 DB 5645 PG 2278

51
ROBERT E. JOHNSON, ET UX
 DB 801 PG 501
 DB 1506 PG 799

52
ABRAHAM CRUMMY
 DB 1536 PG 536
 DB 1562 PG 762
 DB 1494 PG 1784
 DB 908 PG 701
 DB 5567 PG 479

53
CUONG NGUYEN
 DB 5298 PG 1819
 DB 4890 PG 703
 DB 4623 PG 499

54
KERR CROSSING UOA
 DB 4931 PG 2281
 DB 4931 PG 2286
 DB 5546 PG 2776
 DB 5307 PG 247
 DB 5535 PG 636

55
LONGLEY SUPPLY CO.
 DB 684 PG 591
 DB 1490 PG 455
 DB 5760 PG 2256

56
RPP HOLDINGS, LLC
 DB 5751 PG 91
 DB 5584 PG 1456
 DB 1506 PG 1398
 DB 1792 PG 072
 DB 5644 PG 2770
 DB 5684 PG 2877
 DB 5645 PG 2278

57
RPP HOLDINGS, LLC
 DB 5751 PG 91
 DB 5584 PG 1456
 DB 1506 PG 1398
 DB 1792 PG 072
 DB 5644 PG 2770
 DB 5684 PG 2877
 DB 5645 PG 2278

58
GREENWAY VILLAGE HOMEOWNERS ASSOC., INC.
 DB 2621 PG 55
 DB 2378 PG 054
 MB 25 PG 56
 MB 671 PG 597 1/2
 MB 35 PG 320
 MB 35 PG 321
 MB 35 PG 369
 MB 36 PG 189
 MB 36 PG 91
 MB 36 PG 283

59
RPP HOLDINGS, LLC
 DB 5751 PG 91
 DB 5584 PG 1456
 DB 1506 PG 1398
 DB 1792 PG 072
 DB 5644 PG 2770
 DB 5684 PG 2877
 DB 5645 PG 2278

60
RPP HOLDINGS, LLC
 DB 5751 PG 91
 DB 5584 PG 1456
 DB 1506 PG 1398
 DB 1792 PG 072
 DB 5644 PG 2770
 DB 5684 PG 2877
 DB 5645 PG 2278

61
ROBERT E. JOHNSON, ET UX
 DB 801 PG 501
 DB 1506 PG 799

62
ABRAHAM CRUMMY
 DB 1536 PG 536
 DB 1562 PG 762
 DB 1494 PG 1784
 DB 908 PG 701
 DB 5567 PG 479

63
CUONG NGUYEN
 DB 5298 PG 1819
 DB 4890 PG 703
 DB 4623 PG 499

64
KERR CROSSING UOA
 DB 4931 PG 2281
 DB 4931 PG 2286
 DB 5546 PG 2776
 DB 5307 PG 247
 DB 5535 PG 636

65
LONGLEY SUPPLY CO.
 DB 684 PG 591
 DB 1490 PG 455
 DB 5760 PG 2256

66
RPP HOLDINGS, LLC
 DB 5751 PG 91
 DB 5584 PG 1456
 DB 1506 PG 1398
 DB 1792 PG 072
 DB 5644 PG 2770
 DB 5684 PG 2877
 DB 5645 PG 2278

67
RPP HOLDINGS, LLC
 DB 5751 PG 91
 DB 5584 PG 1456
 DB 1506 PG 1398
 DB 1792 PG 072
 DB 5644 PG 2770
 DB 5684 PG 2877
 DB 5645 PG 2278

68
GREENWAY VILLAGE HOMEOWNERS ASSOC., INC.
 DB 2621 PG 55
 DB 2378 PG 054
 MB 25 PG 56
 MB 671 PG 597 1/2
 MB 35 PG 320
 MB 35 PG 321
 MB 35 PG 369
 MB 36 PG 189
 MB 36 PG 91
 MB 36 PG 283

69
RPP HOLDINGS, LLC
 DB 5751 PG 91
 DB 5584 PG 1456
 DB 1506 PG 1398
 DB 1792 PG 072
 DB 5644 PG 2770
 DB 5684 PG 2877
 DB 5645 PG 2278

70
RPP HOLDINGS, LLC
 DB 5751 PG 91
 DB 5584 PG 1456
 DB 1506 PG 1398
 DB 1792 PG 072
 DB 5644 PG 2770
 DB 5684 PG 2877
 DB 5645 PG 2278

71
ROBERT E. JOHNSON, ET UX
 DB 801 PG 501
 DB 1506 PG 799

72
ABRAHAM CRUMMY
 DB 1536 PG 536
 DB 1562 PG 762
 DB 1494 PG 1784
 DB 908 PG 701
 DB 5567 PG 479

73
CUONG NGUYEN
 DB 5298 PG 1819
 DB 4890 PG 703
 DB 4623 PG 499

74
KERR CROSSING UOA
 DB 4931 PG 2281
 DB 4931 PG 2286
 DB 5546 PG 2776
 DB 5307 PG 247
 DB 5535 PG 636

75
LONGLEY SUPPLY CO.
 DB 684 PG 591
 DB 1490 PG 455
 DB 5760 PG 2256

76
RPP HOLDINGS, LLC
 DB 5751 PG 91
 DB 5584 PG 1456
 DB 1506 PG 1398
 DB 1792 PG 072
 DB 5644 PG 2770
 DB 5684 PG 2877
 DB 5645 PG 2278

77
RPP HOLDINGS, LLC
 DB 5751 PG 91
 DB 5584 PG 1456
 DB 1506 PG 1398
 DB 1792 PG 072
 DB 5644 PG 2770
 DB 5684 PG 2877
 DB 5645 PG 2278

78
GREENWAY VILLAGE HOMEOWNERS ASSOC., INC.
 DB 2621 PG 55
 DB 2378 PG 054
 MB 25 PG 56
 MB 671 PG 597 1/2
 MB 35 PG 320
 MB 35 PG 321
 MB 35 PG 369
 MB 36 PG 189
 MB 36 PG 91
 MB 36 PG 283

79
RPP HOLDINGS, LLC
 DB 5751 PG 91
 DB 5584 PG 1456
 DB 1506 PG 1398
 DB 1792 PG 072
 DB 5644 PG 2770
 DB 5684 PG 2877
 DB 5645 PG 2278

80
RPP HOLDINGS, LLC
 DB 5751 PG 91
 DB 5584 PG 1456
 DB 1506 PG 1398
 DB 1792 PG 072
 DB 5644 PG 2770
 DB 5684 PG 2877
 DB 5645 PG 2278

81
ROBERT E. JOHNSON, ET UX
 DB 801 PG 501
 DB 1506 PG 799

82
ABRAHAM CRUMMY
 DB 1536 PG 536
 DB 1562 PG 762
 DB 1494 PG 1784
 DB 908 PG 701
 DB 5567 PG 479

83
CUONG NGUYEN
 DB 5298 PG 1819
 DB 4890 PG 703
 DB 4623 PG 499

84
KERR CROSSING UOA
 DB 4931 PG 2281
 DB 4931 PG 2286
 DB 5546 PG 2776
 DB 5307 PG 247
 DB 5535 PG 636

85
LONGLEY SUPPLY CO.
 DB 684 PG 591
 DB 1490 PG 455
 DB 5760 PG 2256

86
RPP HOLDINGS, LLC
 DB 5751 PG 91
 DB 5584 PG 1456
 DB 1506 PG 1398
 DB 1792 PG 072
 DB 5644 PG 2770
 DB 5684 PG 2877
 DB 5645 PG 2278

87
RPP HOLDINGS, LLC
 DB 5751 PG 91
 DB 5584 PG 1456
 DB 1506 PG 1398
 DB 1792 PG 072
 DB 5644 PG 2770
 DB 5684 PG 2877
 DB 5645 PG 2278

88
GREENWAY VILLAGE HOMEOWNERS ASSOC., INC.
 DB 2621 PG 55
 DB 2378 PG 054
 MB 25 PG 56
 MB 671 PG 597 1/2
 MB 35 PG 320
 MB 35 PG 321
 MB 35 PG 369
 MB 36 PG 189
 MB 36 PG 91
 MB 36 PG 283

89
RPP HOLDINGS, LLC
 DB 5751 PG 91
 DB 5584 PG 1456
 DB 1506 PG 1398
 DB 1792 PG 072
 DB 5644 PG 2770
 DB 5684 PG 2877
 DB 5645 PG 2278