

FOR ALL JUNCTION BOXES WHERE THE FIBER OPTIC CABLE WILL BE REMOVED, REMOVE THE JUNCTION BOX AND BACKFILL WITH SUITABLE MATERIAL.

LEGEND

- YAGI ANTENNA (DOUBLE) FOR REPEATER OPERATION
- YAGI ANTENNA (SINGLE)
- OMNI ANTENNA
- EXISTING CONTROLLER AND CABINET
- EXISTING MASTER CONTROLLER AND CABINET
- SIGNAL INVENTORY NUMBER
- NEW METAL POLE W/MAST ARM
- EXISTING WOOD POLE
- NEW METAL POLE
- SIGNAL POLE
- EXISTING METAL POLE
- NEW OVERSIZED JUNCTION BOX
- EXISTING OVERSIZED JUNCTION BOX
- EXISTING CONDUIT
- EXISTING COMMUNICATIONS CABLE

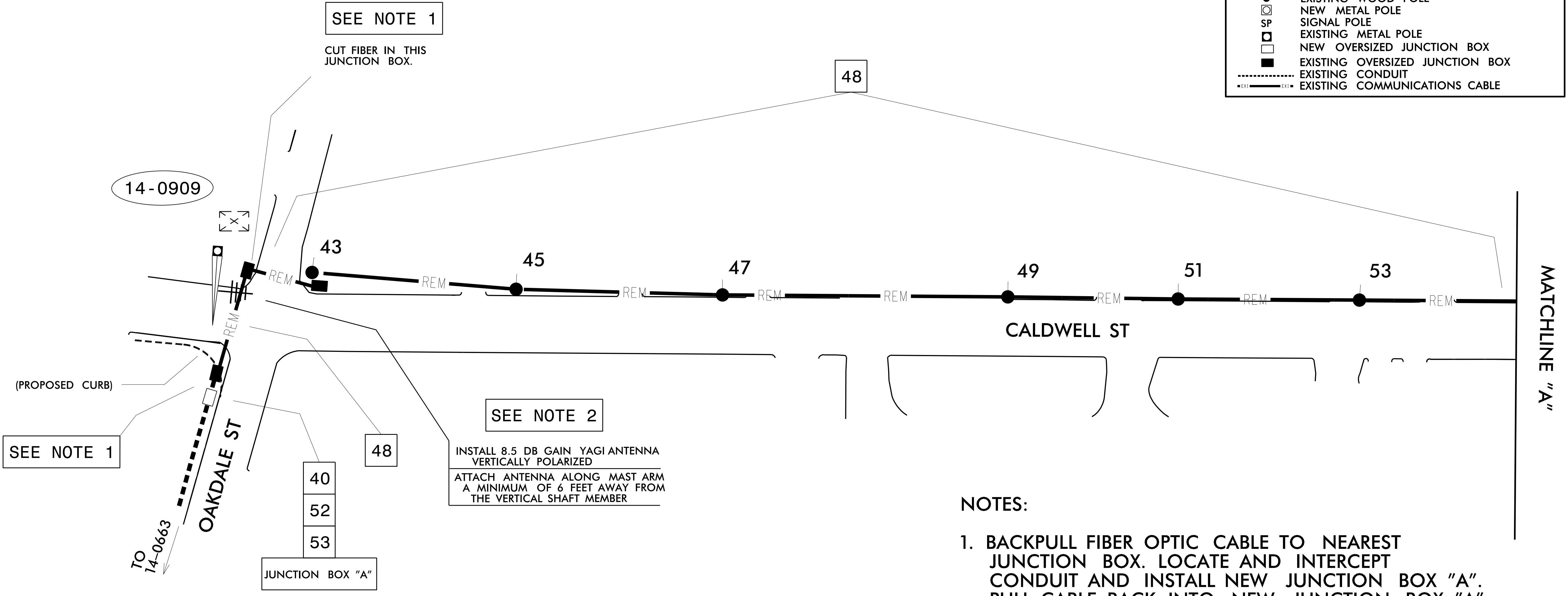

NOTES:

1. BACKPULL FIBER OPTIC CABLE TO NEAREST JUNCTION BOX. LOCATE AND INTERCEPT CONDUIT AND INSTALL NEW JUNCTION BOX "A". PULL CABLE BACK INTO NEW JUNCTION BOX "A" AND STORE. CAP AND SEAL END OF FIBER WITH HEAT SHRINK TUBING WHILE STORED.
2. MOVE ANTENNA TO NEW MAST ARM WHEN NEW SIGNAL CABINET IS OPERATIONAL.

NOTES FOR WIRELESS COMMUNICATIONS:

1. INSTALL COAXIAL CABLE:
 - A. ON WOOD POLES, REQUIRING A NEW RIGID GALVANIZED STEEL RISER, INSTALL A 2" RISER WITH WEATHERHEAD AND ROUTE THE COAXIAL CABLE TO THE ANTENNA.
 - B. ON METAL POLES WITH MAST ARMS, RUN COAXIAL CABLE UP THROUGH THE POLE AND OUT THE MAST ARM; FIELD DRILL A 1/2" HOLE UP THROUGH THE BOTTOM OF MAST ARM FOR INSTALLATION OF THE COAXIAL CABLE TO THE ANTENNA.
 - C. ON METAL STRAIN POLES, RUN COAXIAL CABLE UP THROUGH THE POLE AND OUT THE WEATHERHEAD AND ROUTE THE COAXIAL CABLE TO THE ANTENNA.
 - D. BETWEEN THE POINT OF EXITING THE RISER, METAL POLE OR MAST ARM AND THE ANTENNA, SECURE THE COAXIAL CABLE TO THE STRUCTURE USING 3/4" STAINLESS STEEL STRAPS EVERY 12".
2. IF AN EXISTING 2" SPARE RIGID GALVANIZED STEEL RISER IS AVAILABLE, INSTALL THE COAXIAL CABLE IN THE SPARE RISER.
3. INSTALL WIRELESS ANTENNA ON POLE WITH RF WARNING SIGN.
(NOTE: RF WARNING SIGN NOT REQUIRED WHEN ANTENNA IS INSTALLED ON AN NCDOT-OWNED POLE.)
4. MAINTAIN PROPER CLEARANCE FROM ALL UTILITIES PER THE NATIONAL ELECTRICAL SAFETY CODE.
5. INSTALL WIRELESS SERIAL RADIO MODEM WITH EXTERIOR DISCONNECT SWITCH LOCATED ON CABINET.
(NOTE: RF ANTENNA DISCONNECT SWITCH AND DECAL ARE NOT REQUIRED WHEN THE ANTENNA IS INSTALLED ON AN NCDOT-OWNED POLE.)
6. REFERENCE "WIRELESS RADIO ANTENNA TYPICAL DETAILS."

TMP - I

<p>750 N. Greenfield Pkwy., Garner, NC 27529</p>	<p>WIRELESS COMMUNICATIONS PLAN</p>		
	<p>DIVISION 14 TRANSYLVANIA CO. DocuSigned by: BREVARD</p> <p>PLAN DATE: JANUARY 2015 REVIEWED BY: Neal Avery</p> <p>PREPARED BY: B. A. STOUCHKO REVIEWED BY: 09F5D94CBED3445</p>		
<p>SCALE 0 30</p>	<p>REVISIONS</p>		<p>INIT. DATE</p>
<p>CADD Filename:</p>			<p>DocuSigned by: Gregory A. Fuller 1/26/2015</p>