

This area has been determined to contain properties with documented historic significance. If it is necessary to deviate from these plans in this area, alert the Engineer to contact Project Development and Environmental Analysis Branch - Historic Architecture Group of the North Carolina Department of Transportation for an effects determination before proceeding.

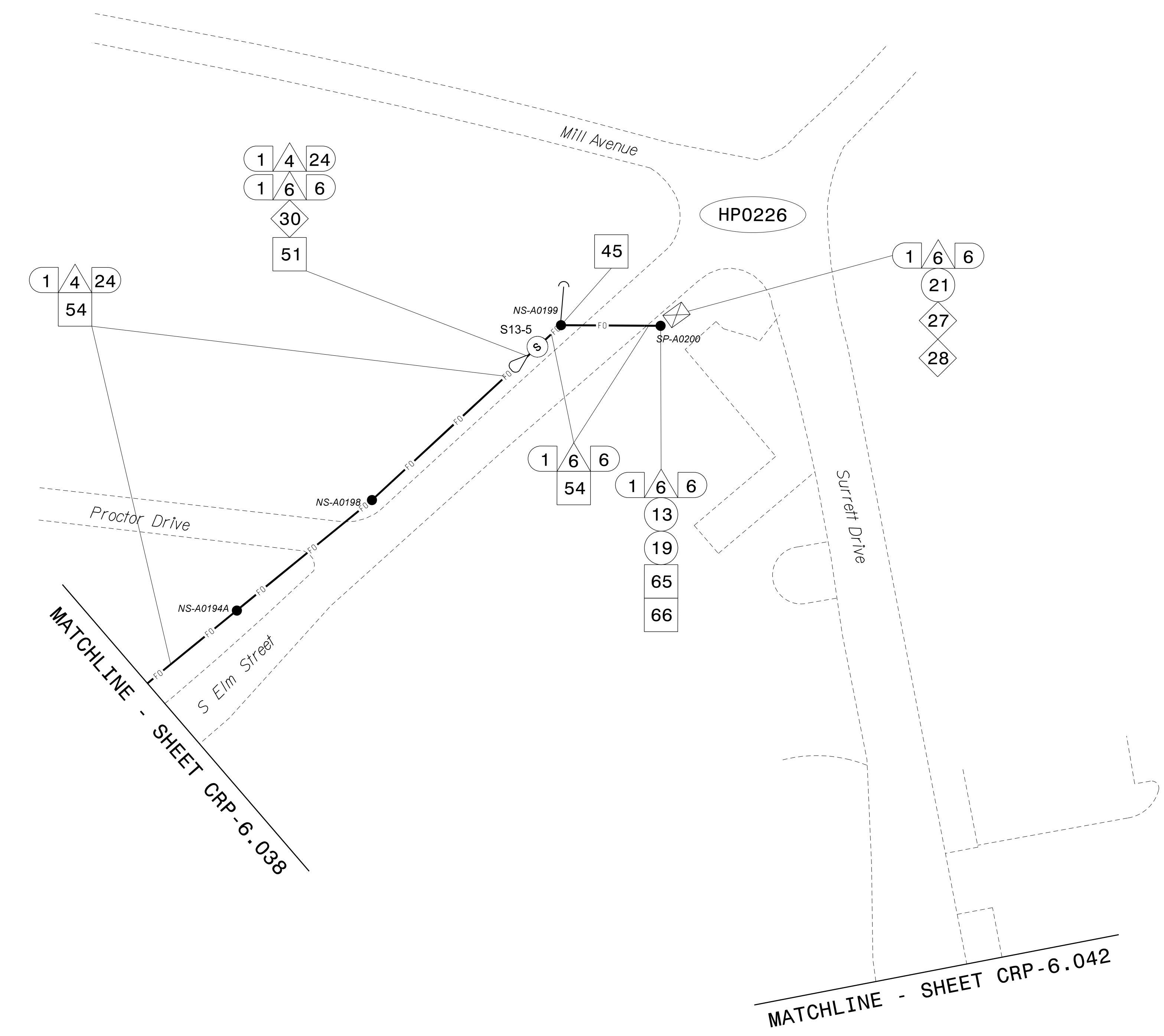

- NOTES:
1. UNLESS OTHERWISE NOTED:
- OVERLASH NEW FIBER OPTIC CABLE TO EXISTING COMMUNICATIONS CABLE.
- ATTACH NEW MESSENGER CABLE 40" BELOW POWER.
- ATTACH ON FRONT SIDE (FS) OF POLE.
2. SEAL ALL CONDUIT ENDS WITH DUCT AND CONDUIT SEALER, AT ALL JUNCTION BOX / CABINET ENTRANCES.

Table with 7 columns and 12 rows of callout numbers and descriptions for cable and conduit installation tasks, such as 'INSTALL COMPOSITE CCTV CABLE', 'INSTALL HEAT SHRINK TUBING RETROFIT KIT', 'INSTALL NEW RISER INTO POLE MOUNTED CABINET', etc.

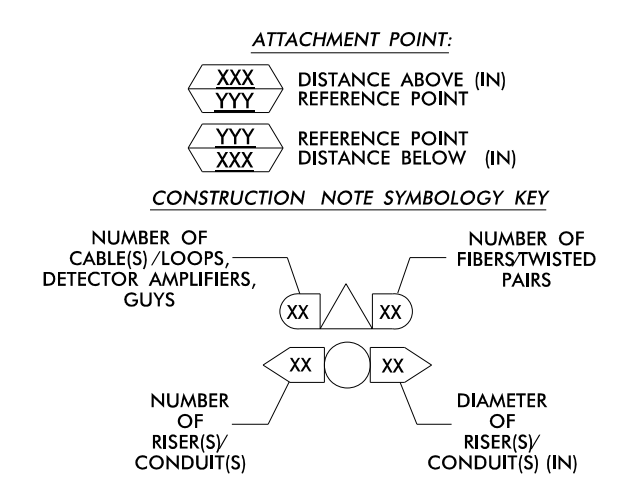

ATKINS 1616 EAST MILLBROOK ROAD, SUITE 310 RALEIGH, NORTH CAROLINA 27609 (919) 876-6888 NCBEEES #F-0326

Project information block including 'High Point Signal System Cable Routing Plans', 'Division 7 Guilford County High Point', 'Prepared by: NM CHAPMAN', 'Reviewed by: MB Toth', 'Date: June 2015', and a professional seal for Melissa B. Toth, Engineer.

05-JUN-2015 10:50 D:\projects\atkins\proj\crp-6\crp-6-039.dgn AT DUS290140 WLE2054