

Sketch of Pavement in Relation to Bridge

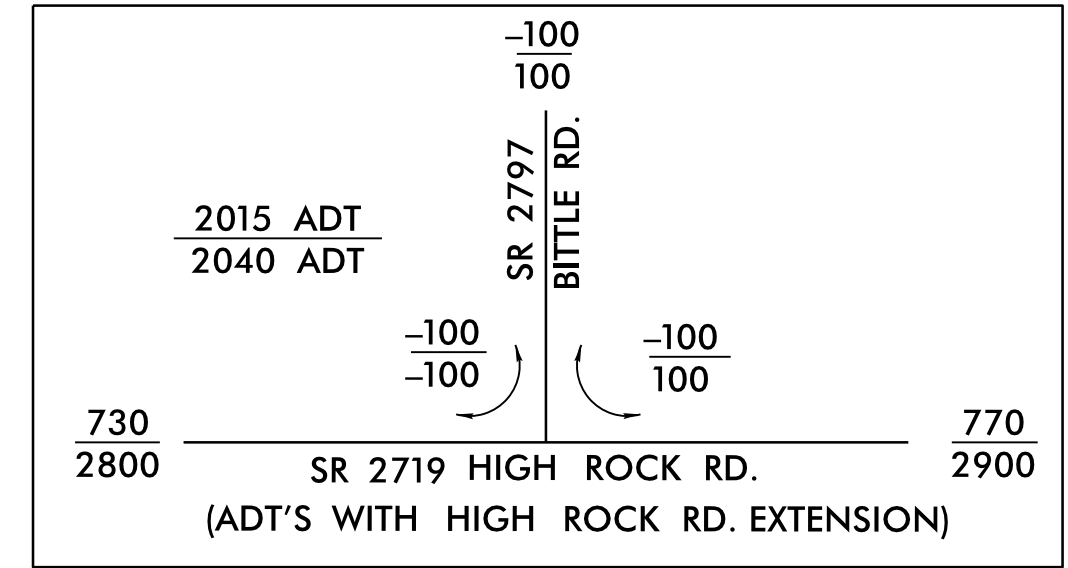

NAD 83/NSRS 2007

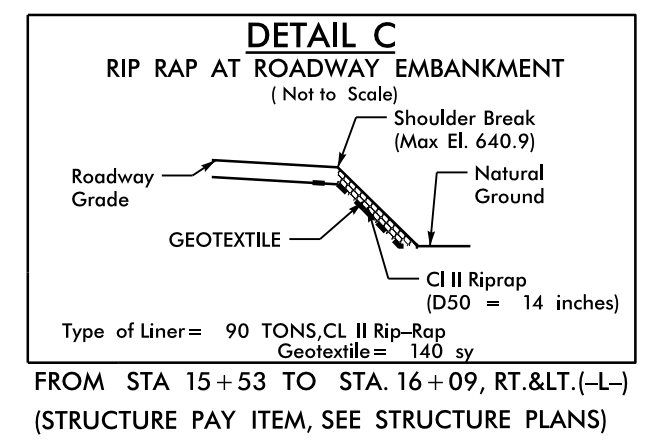
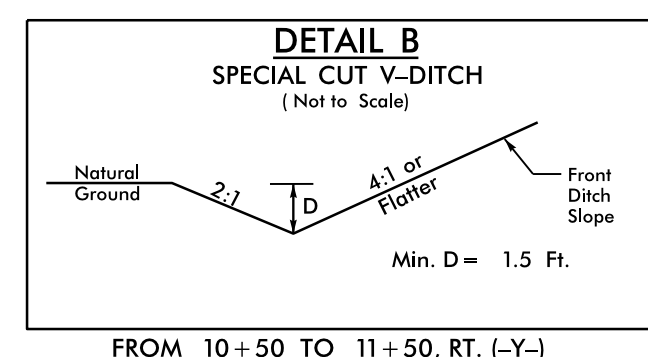
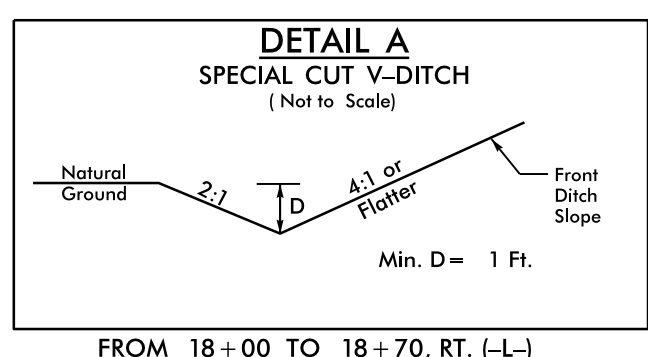
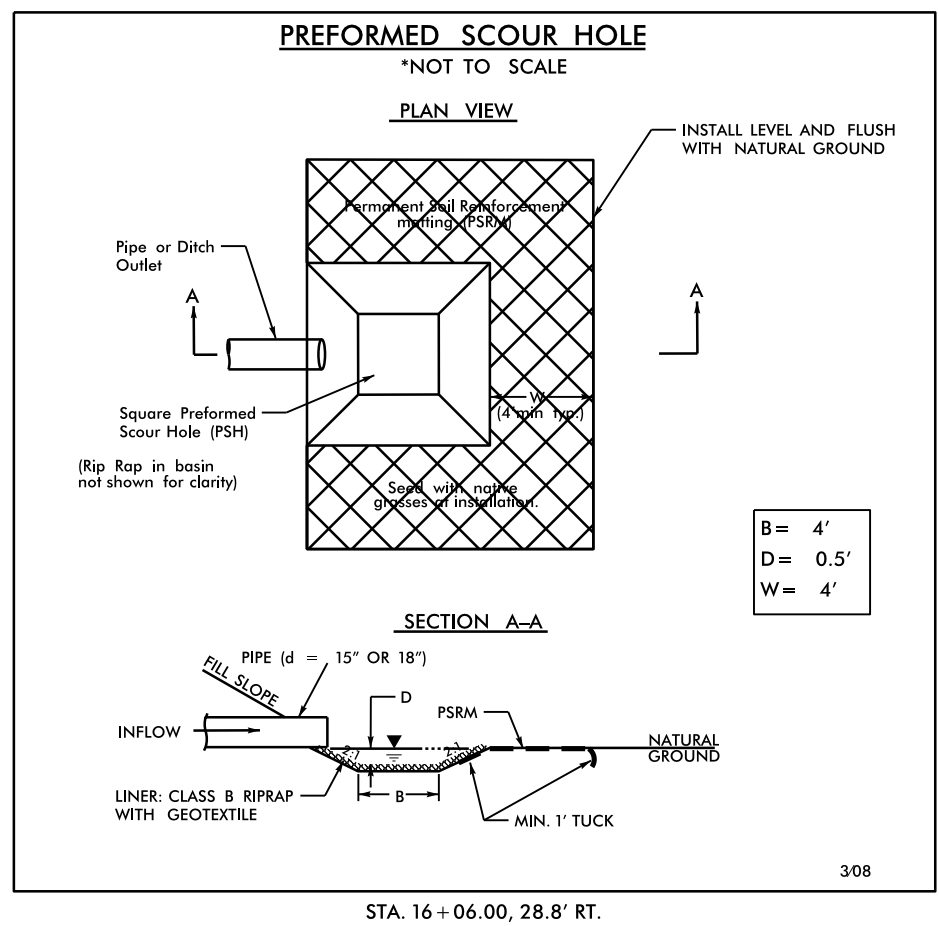

-L-	-Y-
PI Sta 10+29.20	PI Sta 15+84.52
$\Delta = 3^{\circ}02'26.7''$ (RT)	$\Delta = 3^{\circ}52'31.0''$ (RT)
$D = 5^{\circ}12'31.3''$	$D = 0^{\circ}57'17.7''$
$L = 58.38'$	$L = 405.82'$
$T = 29.20'$	$T = 202.99'$
$R = 1,000.00'$	$R = 6,000.00'$
$SE = 0.02$	$SE = 0.04$
$RO = 48'$	$RO = 64'$

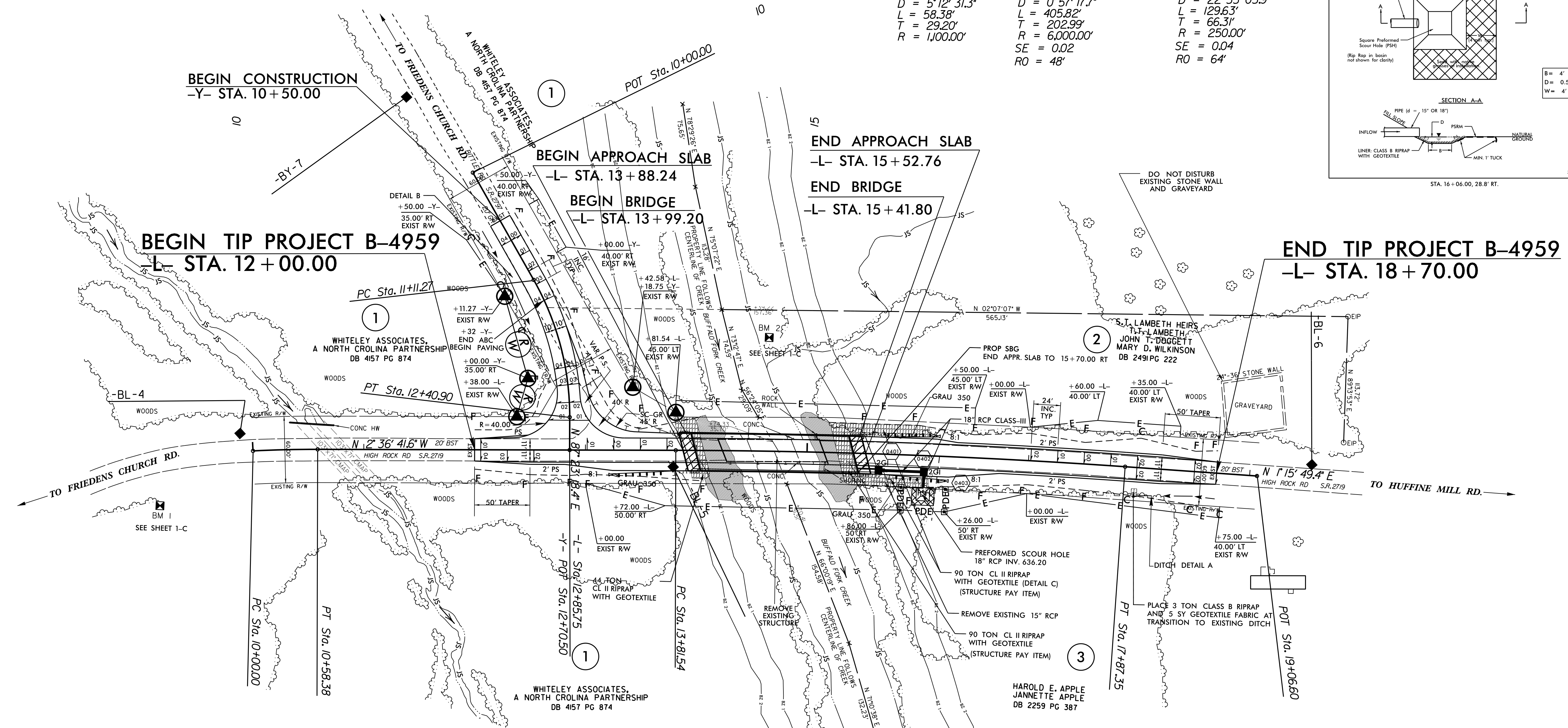

SEE SHEET NO. 5 FOR -L- & -Y- PROFILE
SEE SHEET S-1 THRU S-25 FOR STRUCTURE PLANS.

REVISIONS

8/17/99

20-AUG-2015 08:10 R:\4959_Rdly-psh.dgn
3:58:50 PM