

09/08/99

See Sheet 1-A For Index of Sheets  
See Sheet 1-B For Conventional Symbols

STATE OF NORTH CAROLINA  
DIVISION OF HIGHWAYS

**GUILFORD COUNTY**

LOCATION: BRIDGE NO. 193 OVER BUFFALO CREEK ON  
SR 2719 (HIGH ROCK ROAD)

TYPE OF WORK: GRADING, DRAINAGE, PAVING, AND STRUCTURE

STATE	STATE PROJECT REFERENCE NO.	SHEET NO.	TOTAL SHEETS
N.C.	B-4959	1	
STATE PROJ. NO.	F.A. PROJ. NO.	DESCRIPTION	
40151.1.1	BRZ-2719(1)	PE	
40151.2.FDI	BRZ-2719(1)	RW & UTIL.	
40151.3.2	BRZ-2719(1)	CONST.	

**TIP PROJECT: B-4959**

**CONTRACT: C203625**

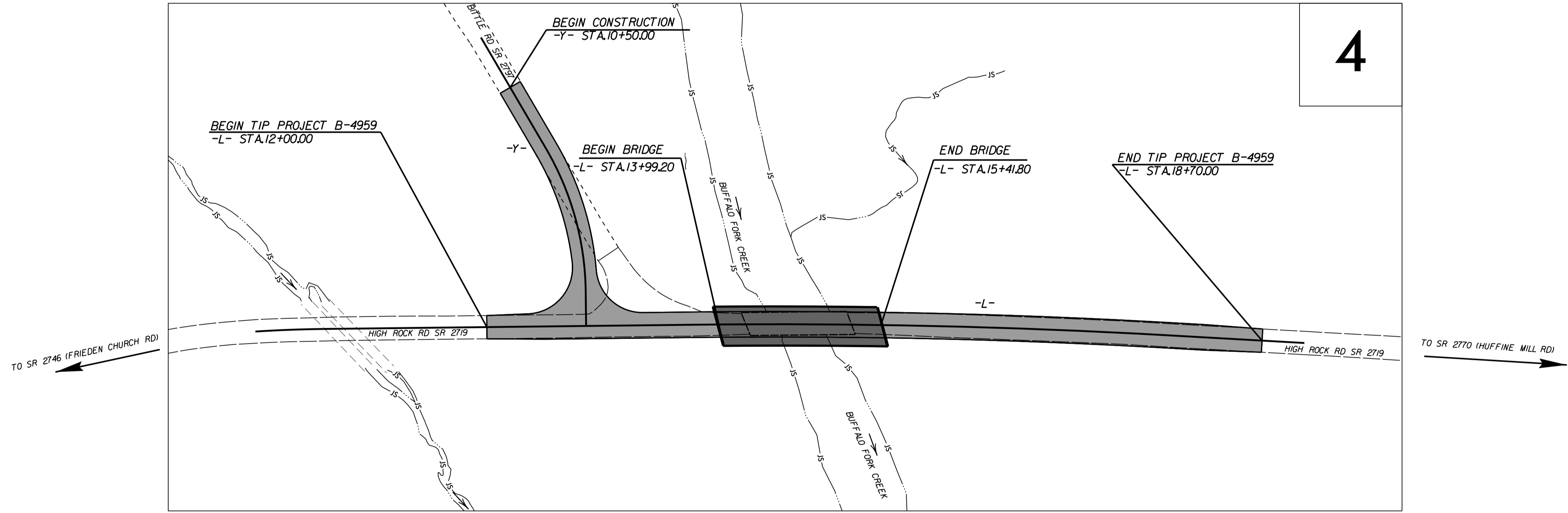
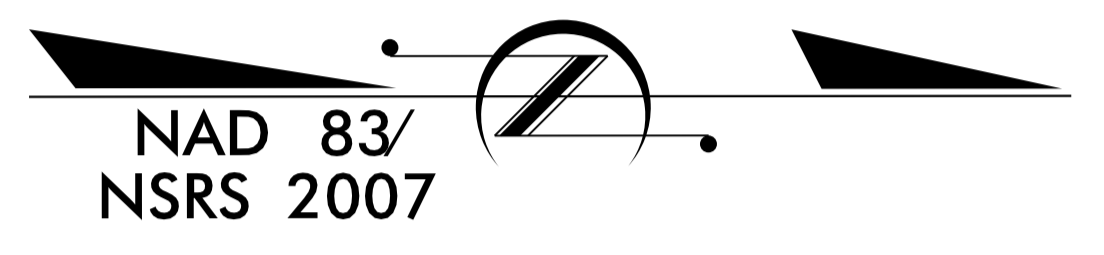
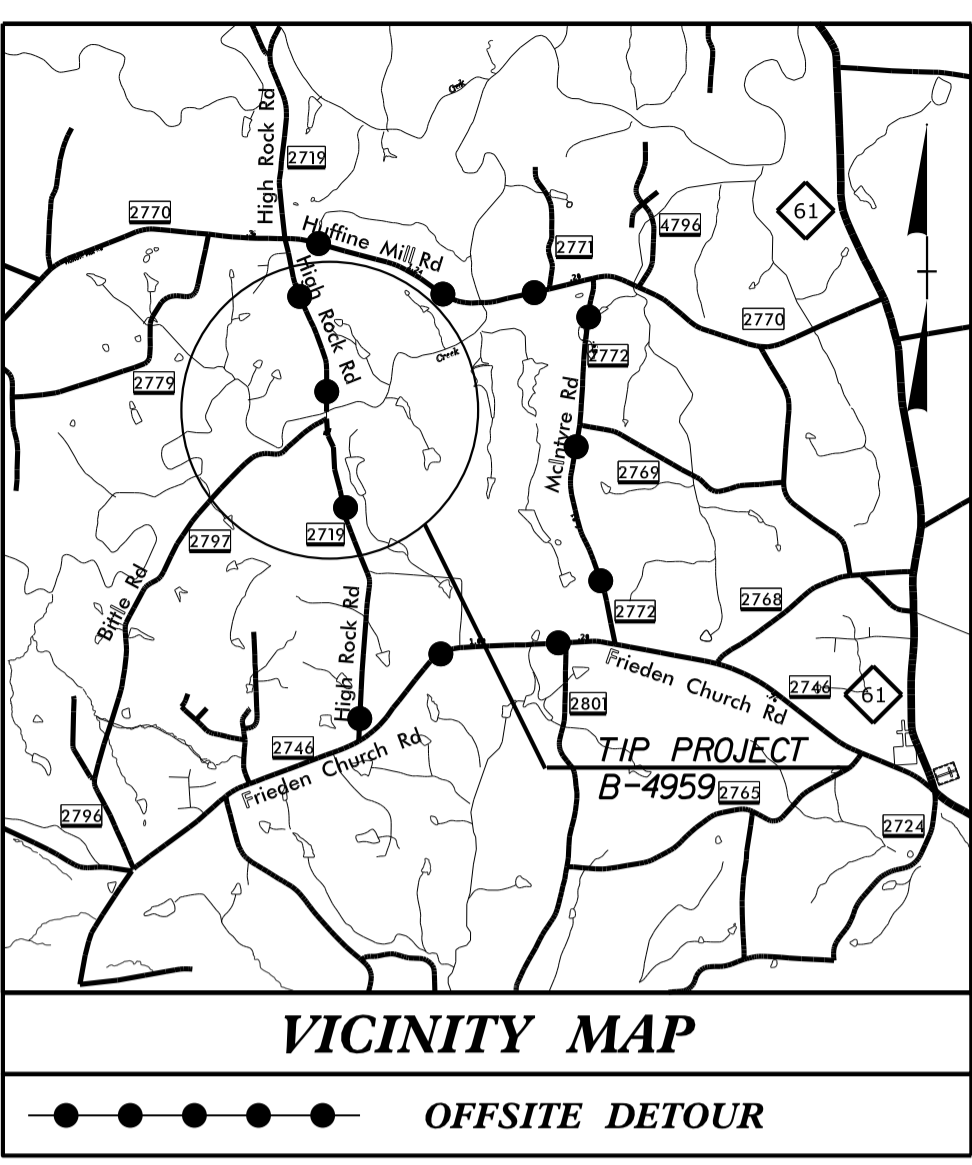

4

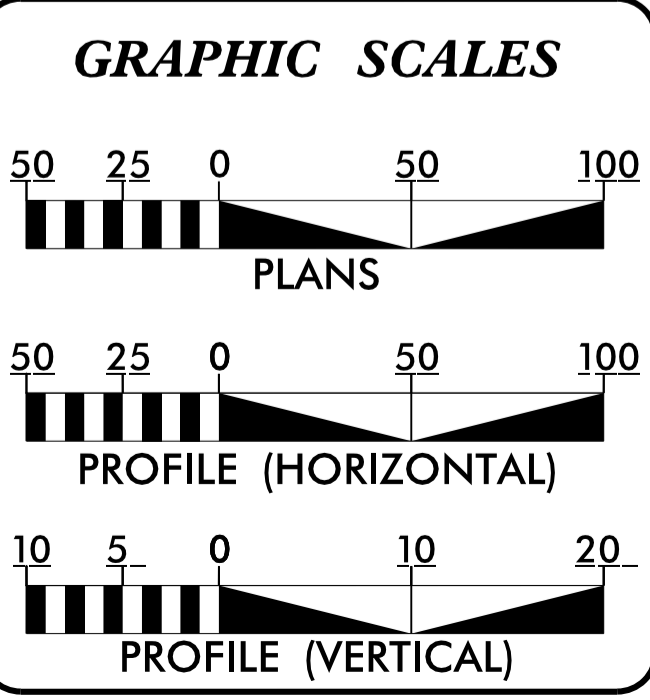

**DESIGN DATA**

ADT 2015 = 770 VPD  
ADT 2040 = 2900 VPD

K = 11 %  
D = 55 %  
T = 14 % \*  
V = 55 MPH

\* TTST = 1% DUAL 13%

FUNC CLASS = RURAL LOCAL  
SUB REGIONAL TIER

**PROJECT LENGTH**

LENGTH ROADWAY TIP PROJECT B-4959 = 0.100 MILES

LENGTH STRUCTURE TIP PROJECT B-4959 = 0.027 MILES

TOTAL LENGTH OF TIP PROJECT B-4959 = 0.127 MILES

Prepared In the Office of:  
**DIVISION OF HIGHWAYS**  
1000 Birch Ridge Dr., Raleigh NC, 27610

2012 STANDARD SPECIFICATIONS	RIGHT OF WAY DATE:	JAMES A. SPEER, PE PROJECT ENGINEER
	OCTOBER 16, 2014	
	LETTING DATE:	ALLISON K. WHITE PROJECT DESIGN ENGINEER
	OCTOBER 20, 2015	

**HYDRAULICS ENGINEER**

DocuSigned by:  
Richard Hiner  
7/22/2015  
SIGNATURE: P.E.

**ROADWAY DESIGN ENGINEER**

DocuSigned by:  
James Speer  
7/23/2015  
SIGNATURE: P.E.

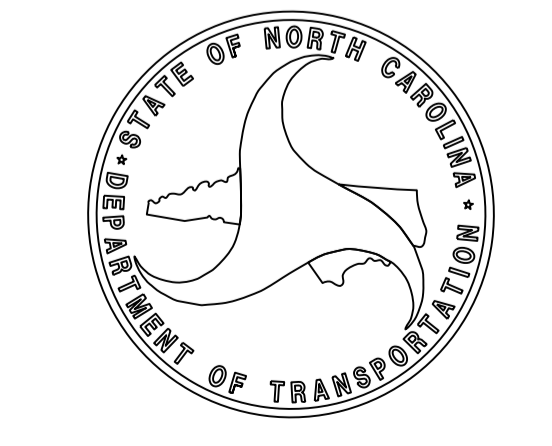

21-JUL-2015 10:56  
R:\Roadway\Proj\B4959\_Rdy\_tsh.dgn  
\$\$\$\$\$USERNAME\$\$\$\$\$