

BILL OF MATERIAL FOR END BENT 2					
BAR	NO.	SIZE	TYPE	LENGTH	WEIGHT
*K3	6	#4	STR	10"	3
*K4	6	#4	STR	2'-9"	11
* EPOXY COATED REINFORCING STEEL (FOR ONE END BENT)					14 LBS.
** CLASS AA CONCRETE BREAKDOWN (FOR ONE END BENT)					0.7 C.Y.
POUR #1 WINGS					

** CLASS AA CONCRETE SHALL BE CONSIDERED INCIDENTAL TO COST OF CONCRETE SHEET PILE WALLS.

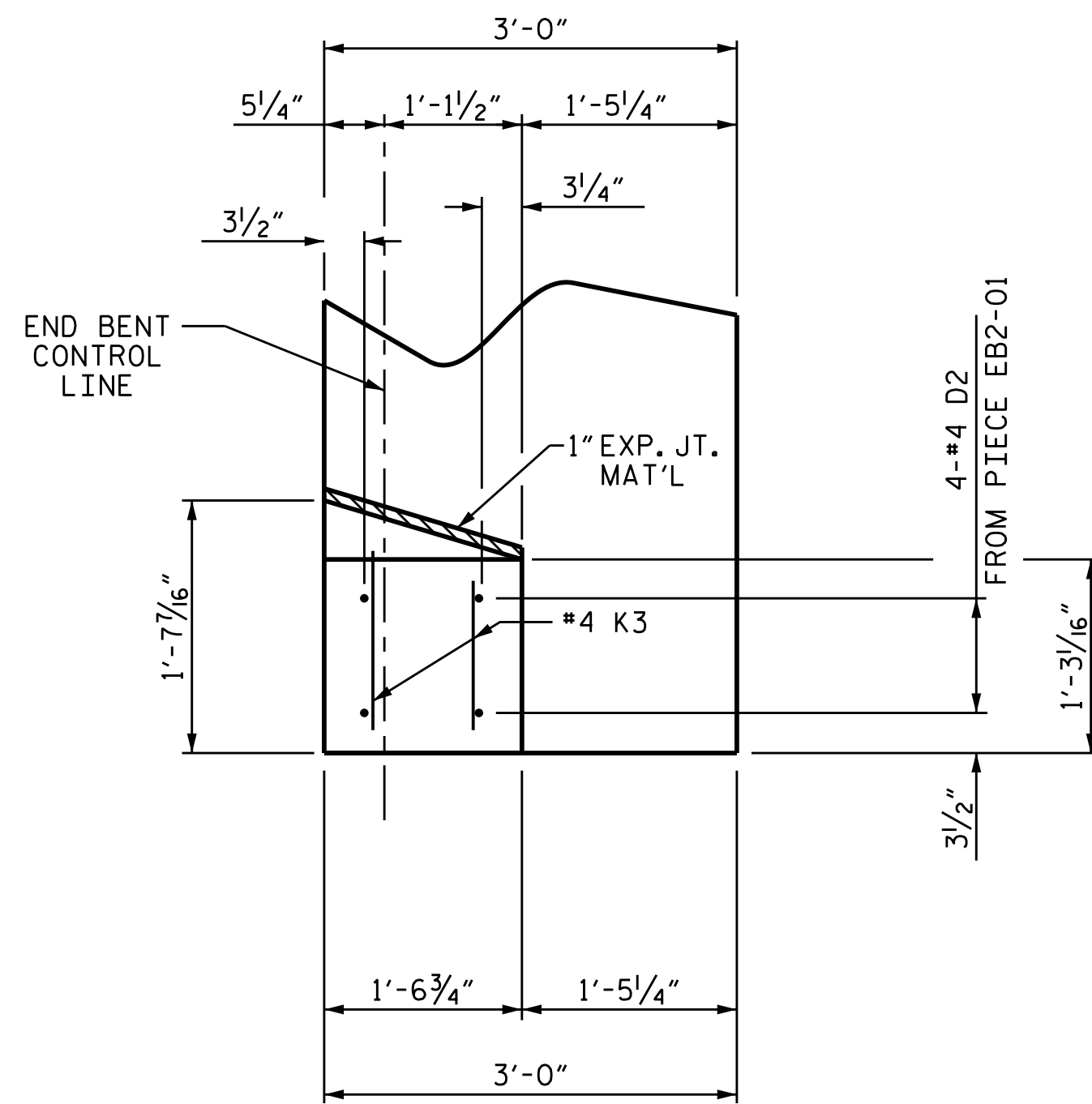

PLAN OF WING (W3)

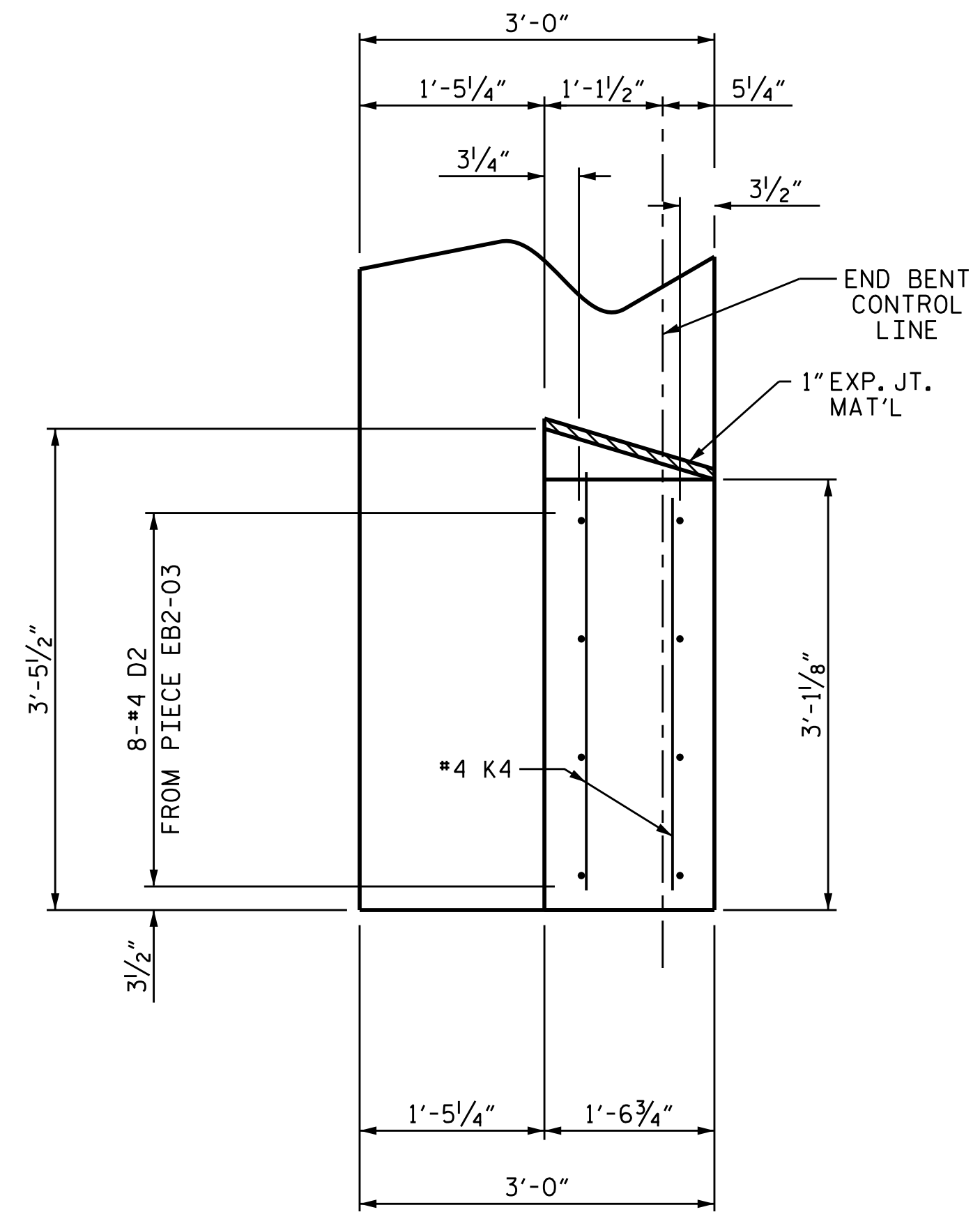

PLAN OF WING (W4)

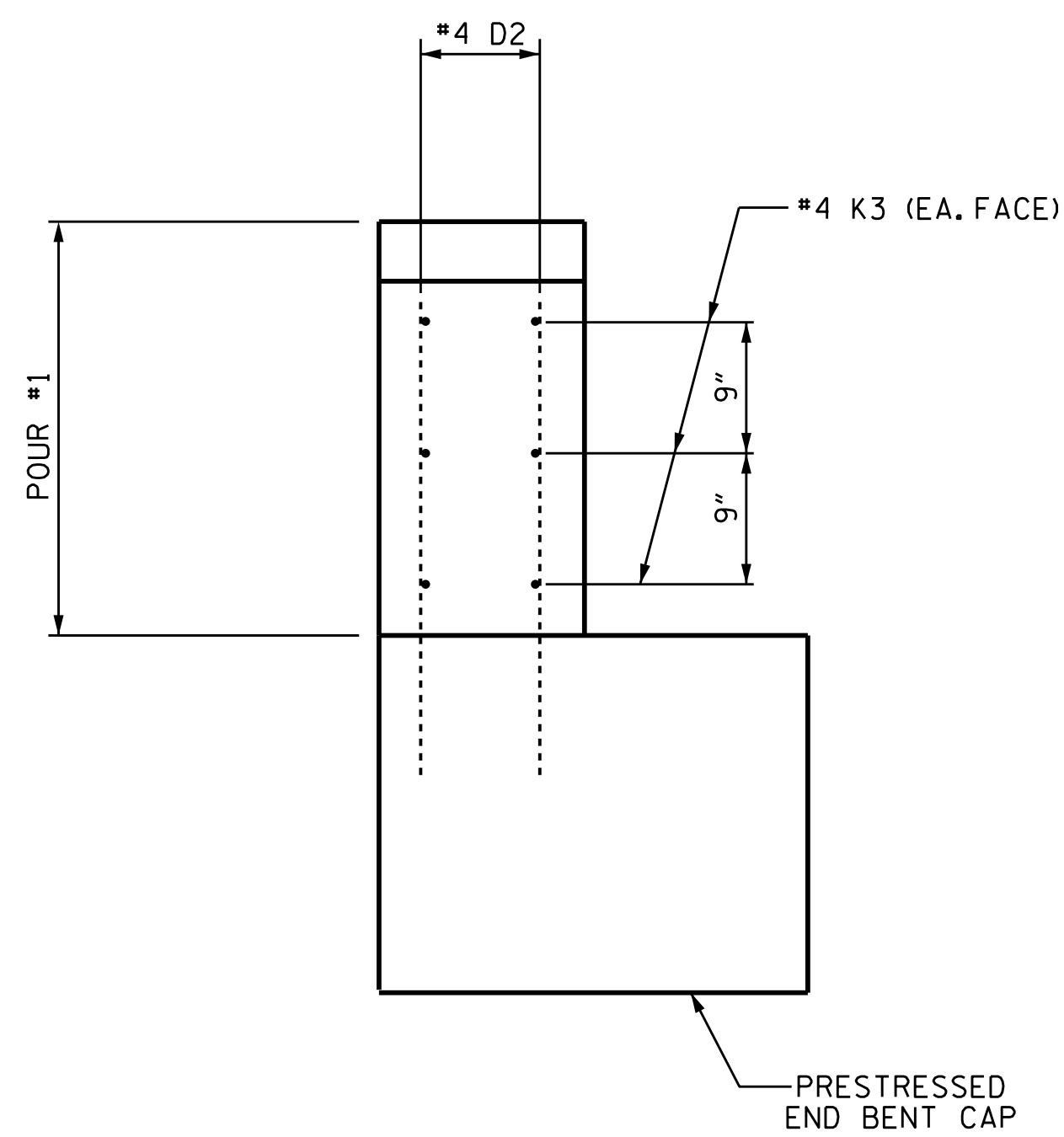

ELEVATION OF WING (W3)

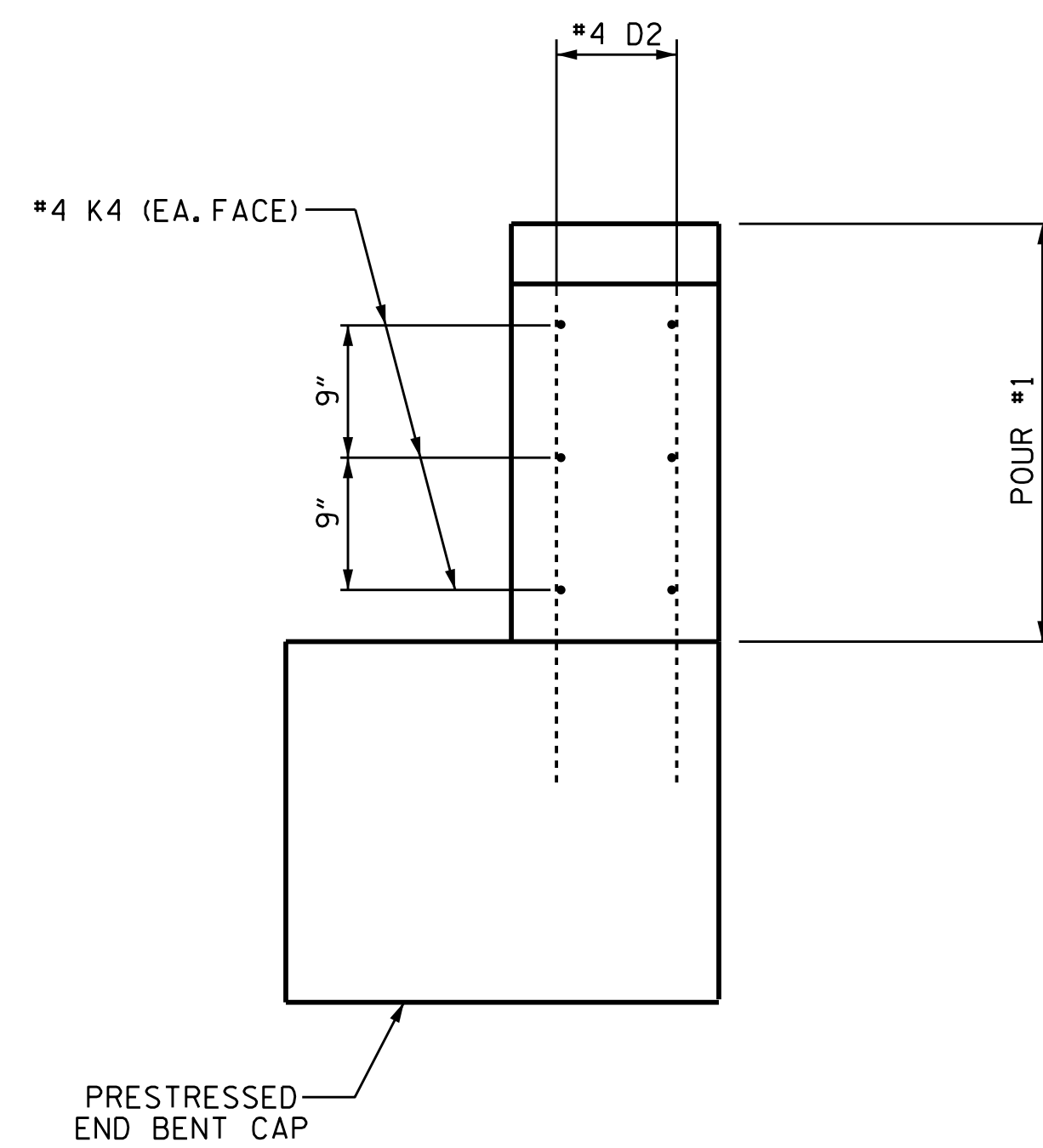

ELEVATION OF WING (W4)

WING DETAILS

PROJECT NO. B-2500AB
DARE COUNTY
 STATION: 3170+75.00 -L-

SHEET 6 OF 6



STATE OF NORTH CAROLINA
 DEPARTMENT OF TRANSPORTATION
 RALEIGH

SUBSTRUCTURE
 END BENT 2
 WING DETAILS

ASSEMBLED BY : M.A. ALLEN	DATE : 6/15
CHECKED BY : T.M. GARRISON	DATE : 6/15
DRAWN BY : MAA 4/13	
CHECKED BY : BCH 4/13	

DocuSigned by:
 Todd M. Garrison
 8/3/2015

REVISIONS						SHEET NO.
NO.	BY:	DATE:	NO.	BY:	DATE:	S-41
1			3			TOTAL SHEETS
2			4			44