

HORIZ. CURVE DATA -L-	
PI = 3169+98.96	
Δ = 29°-51'-54.0" (RT)	
D = 1°-44'-10.4"	
L = 1,720.10'	
T = 880.07'	
R = 3,300.00'	
PI = 3183+79.35	
Δ = 6°-58'-03.6" (LT)	
D = 2°-01'-02.8"	
L = 345.37'	
T = 172.90'	
R = 2,840.00'	

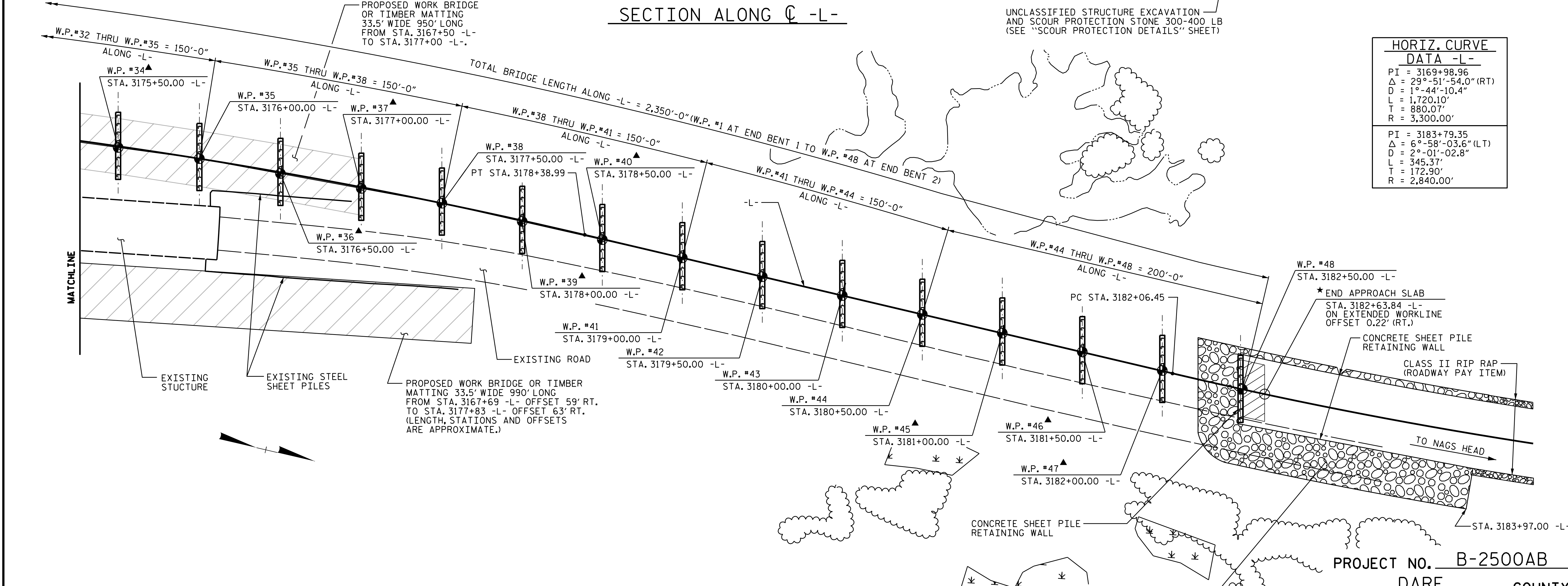

▲ THESE WORK POINTS ARE NOT LOCATED ON THE -L-. THEY ARE LOCATED ON THE WORKLINES, SEE "FOUNDATION LAYOUT" AND "LONG CHORD LAYOUT" SHEETS.

★ END APPROACH SLAB IS LOCATED ON THE EXTENDED WORKLINE (WORKLINE 15). SEE "LONG CHORD LAYOUT" AND "BRIDGE APPROACH SLAB" SHEETS.

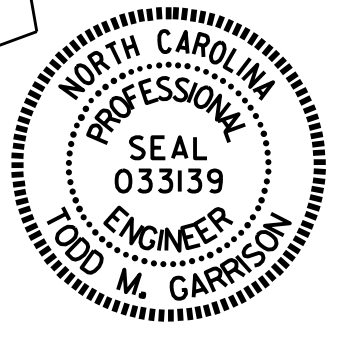

PROJECT NO. B-2500AB
DARE COUNTY
STATION: 3170+75.00 -L-

SHEET 3 OF 8

REVISIONS						SHEET NO.
NO.	BY:	DATE:	NO.	BY:	DATE:	S-3
1			3			TOTAL SHEETS
2			4			44

DRAWN BY : M.A. ALLEN DATE : 6/15
CHECKED BY : E.K. POPE, P.E. DATE : 6/15
DESIGN ENGINEER OF RECORD: E.K. POPE, P.E. DATE : 6/15