

8/17/99

PROJECT REFERENCE NO. B-2500AB	SHEET NO. EC-10/CONST.6
RW SHEET NO.	
ROADWAY DESIGN ENGINEER	HYDRAULICS ENGINEER

$PI\ Sta\ 3169+98.96$   
 $\Delta = 29^{\circ} 51' 54.0" (RT)$   
 $D = 1' 44" 10.4"$   
 $L = 1,720.10'$   
 $T = 880.07'$   
 $R = 3,300.00'$   
 $SE = .04$

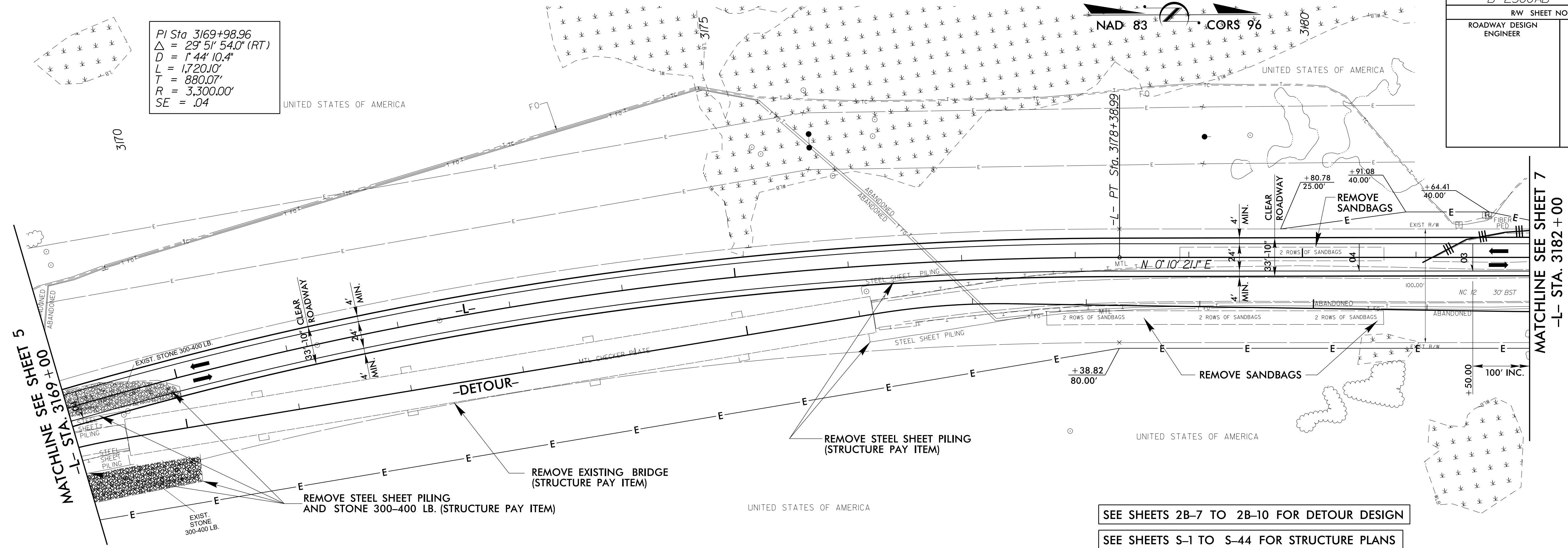

SEE SHEETS 2B-7 TO 2B-10 FOR DETOUR DESIGN  
 SEE SHEETS S-1 TO S-44 FOR STRUCTURE PLANS  
 SEE SHEET 2B-1 FOR ROADWAY & BRIDGE RELATIONSHIP

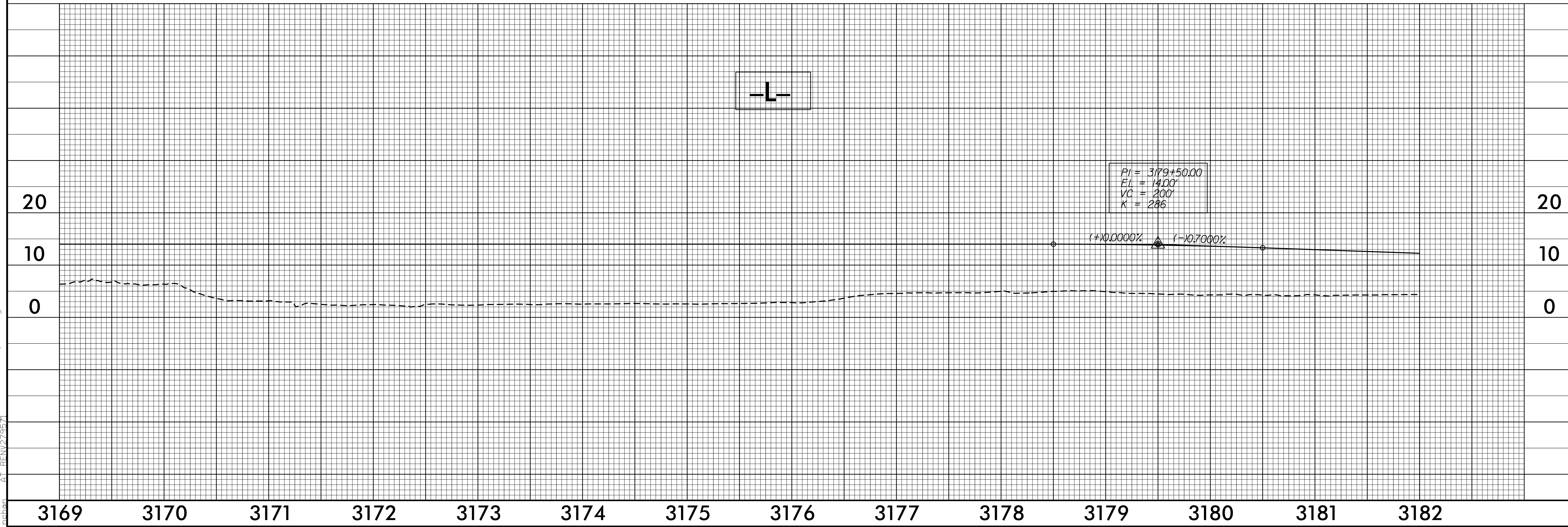

3-AUG-2015 15:53  
 C:\enviro\p\ec\B2500AB.ec.psh06.dgn  
 P:\21717\21717.dwg