

CULVERT SILL DETAILS

** DOWELS MAY BE PUSHED INTO GREEN CONCRETE AFTER SLAB HAS BEEN FLOAT FINISHED.

BAR	SIZE	SPLICE LENGTH
"C"	#4	1'-11"
B1	#4	1'-9"

STAGE I						STAGE II					
BAR	NO.	SIZE	TYPE	LENGTH	WEIGHT	BAR	NO.	SIZE	TYPE	LENGTH	WEIGHT
A1	349	#5	1	6'-5"	2336	A1	842	#5	1	6'-5"	5635
A2	349	#5	1	6'-2"	2245	A2	842	#5	1	6'-2"	5416
A100	173	#6	STR	9'-2"	2382	A100	421	#6	STR	9'-2"	5796
A101	1	#6	STR	8'-3"	12						
A102	1	#6	STR	6'-1"	9	A200	421	#6	STR	9'-2"	5796
A103	1	#6	STR	3'-11"	6						
A200	173	#6	STR	9'-2"	2382	B1	492	#4	STR	9'-11"	3259
A201	1	#6	STR	8'-3"	12	B2	842	#5	STR	7'-6"	6587
A202	1	#6	STR	6'-1"	9	C2	441	#4	STR	29'-0"	8543
A203	1	#6	STR	3'-11"	6						
B1	201	#4	STR	9'-11"	1331	D1	56	#6	STR	1'-10"	154
B2	349	#5	STR	7'-6"	2730	E1	16	#5	STR	4'-8"	78
						E2	32	#5	STR	3'-8"	122
C1	196	#4	STR	27'-1"	3546	F1	53	#4	STR	4'-4"	153
D1	28	#6	STR	1'-10"	77	G2	2	#4	STR	9'-2"	12
F1	22	#4	STR	4'-4"	64						
G1	2	#4	STR	9'-6"	13						
REINFORCING STEEL 17160 LBS.						REINFORCING STEEL 41551 LBS.					

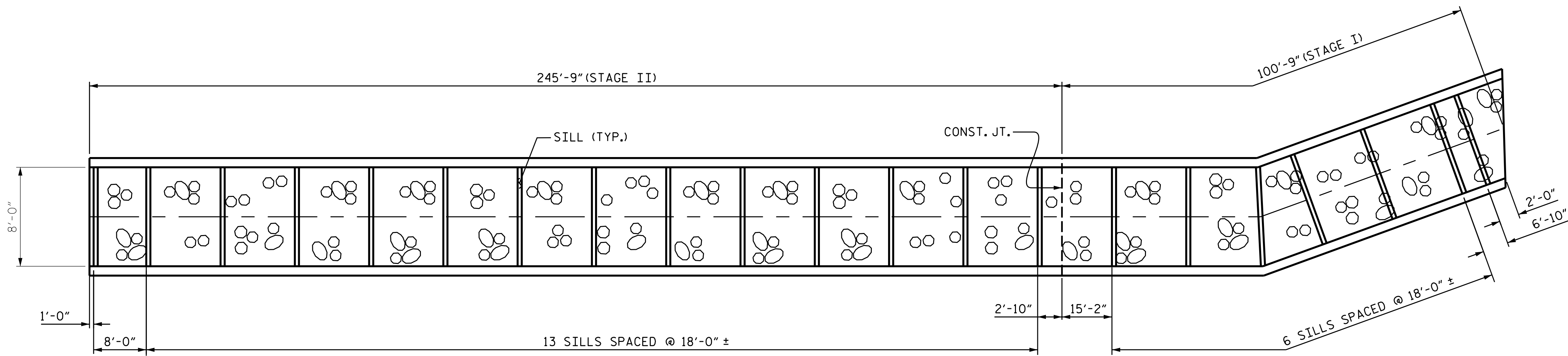

PLAN SHOWING 1'-0" SILL SPACING ARRANGEMENT

MATERIAL EXCAVATED FROM THE STREAM BED SHALL BE STOCKPILED FOR USE IN THE PROPOSED CULVERT. BED MATERIAL SHALL BE SUBJECT TO APPROVAL BY THE ENGINEER. BED MATERIAL SHALL BE SUPPLEMENTED BY CLASS B RIP RAP AS NECESSARY.

THE ENTIRE COST OF WORK REQUIRED TO PLACE EXCAVATED MATERIAL OR SUPPLEMENTAL MATERIAL AS SHOWN ON THE PLANS SHALL BE INCLUDED IN THE CONTRACT LUMP SUM PRICE BID FOR CULVERT EXCAVATION.

THE ENTIRE COST OF WORK REQUIRED TO CONSTRUCT THE SILLS AS SHOWN SHALL BE INCLUDED IN THE VARIOUS PAY ITEMS.

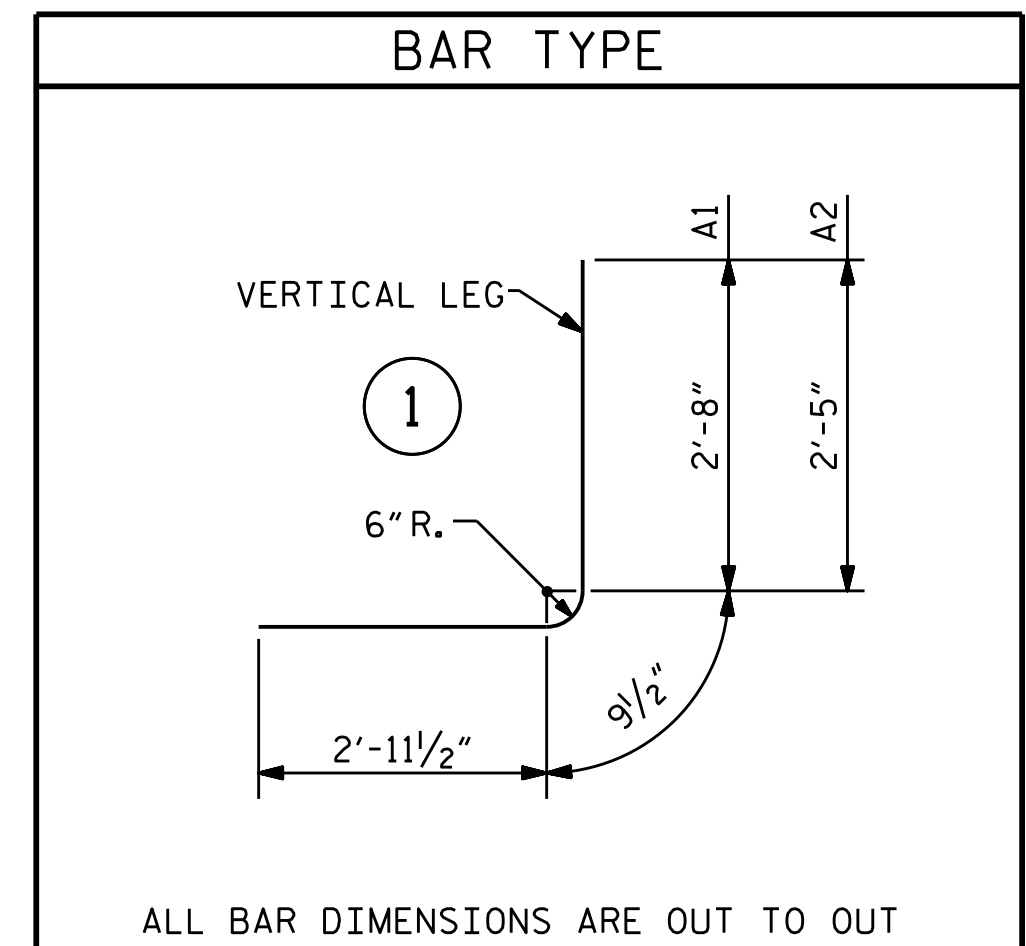

PROJECT NO. R-2603
WILKES COUNTY
 STATION: 59+43.00 -L-

SHEET 7 OF 10

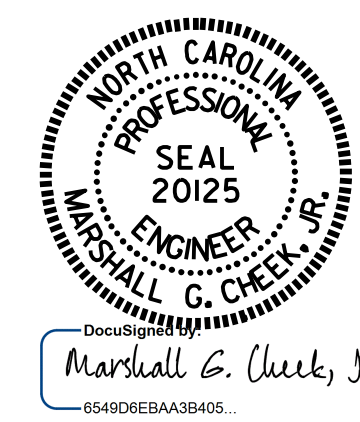

STATE OF NORTH CAROLINA
 DEPARTMENT OF TRANSPORTATION
 RALEIGH

SINGLE
 8 FT. X 8 FT.
 CONCRETE BOX CULVERT

DRAWN BY : H. T. BARBOUR DATE : 6-13
 CHECKED BY : S. B. WILLIAMS DATE : 12-14

REVISIONS						SHEET NO.
NO.	BY:	DATE:	NO.	BY:	DATE:	C-7
1			3			TOTAL SHEETS
2			4			10

STR. #3