

TIP NO. R-2603	SHEET NO. PMP-16
APPROVED: <i>Ron King</i> 13E7A7B9AA4448	
DATE: 5/29/2015	
SEAL	

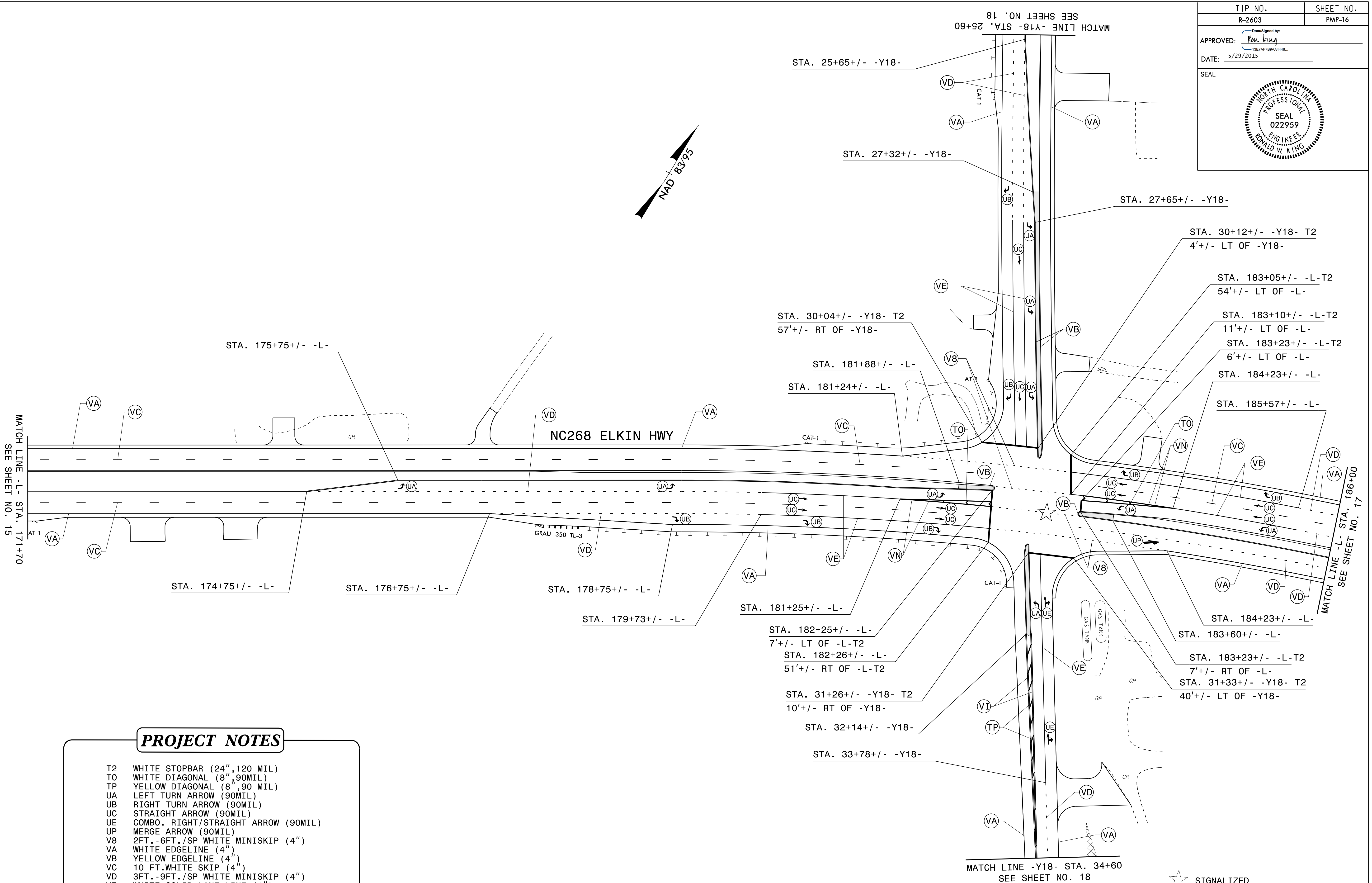
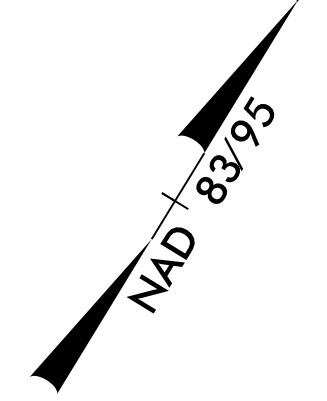

PROJECT NOTES

- T2 WHITE STOPBAR (24", 120 MIL)
- TO WHITE DIAGONAL (8", 90MIL)
- TP YELLOW DIAGONAL (8", 90 MIL)
- UA LEFT TURN ARROW (90MIL)
- UB RIGHT TURN ARROW (90MIL)
- UC STRAIGHT ARROW (90MIL)
- UE COMBO. RIGHT/STRAIGHT ARROW (90MIL)
- UP MERGE ARROW (90MIL)
- V8 2FT.-6FT./SP WHITE MINISKIP (4")
- VA WHITE EDGELINE (4")
- VB YELLOW EDGELINE (4")
- VC 10 FT.WHITE SKIP (4")
- VD 3FT.-9FT./SP WHITE MINISKIP (4")
- VE WHITE SOLID LANE LINE (4")
- VI YELLOW DOUBLE CENTER (4")
- VN WHITE GORELINE (8")

**NC 268
PAVEMENT MARKING DETAIL**

28-MAY-2015 13:43
 P:\TIP\Projects\R-2603\CADD\PM\PAR-2603-Sgn_PMP-16.dgn
 jgmer-tinez AT 12:27:40