

NOTE: SEE STD.DWG. 846.01 FOR
2'-6" CURB AND GUTTER
INFORMATION.

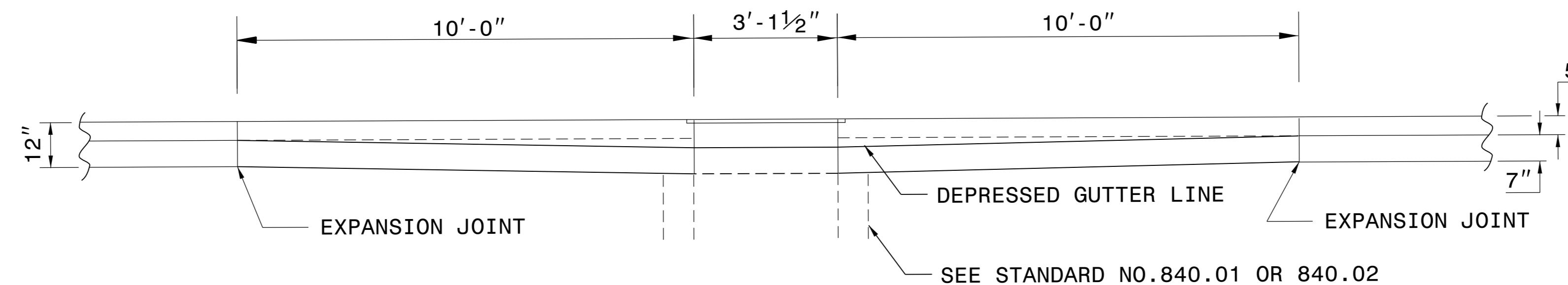
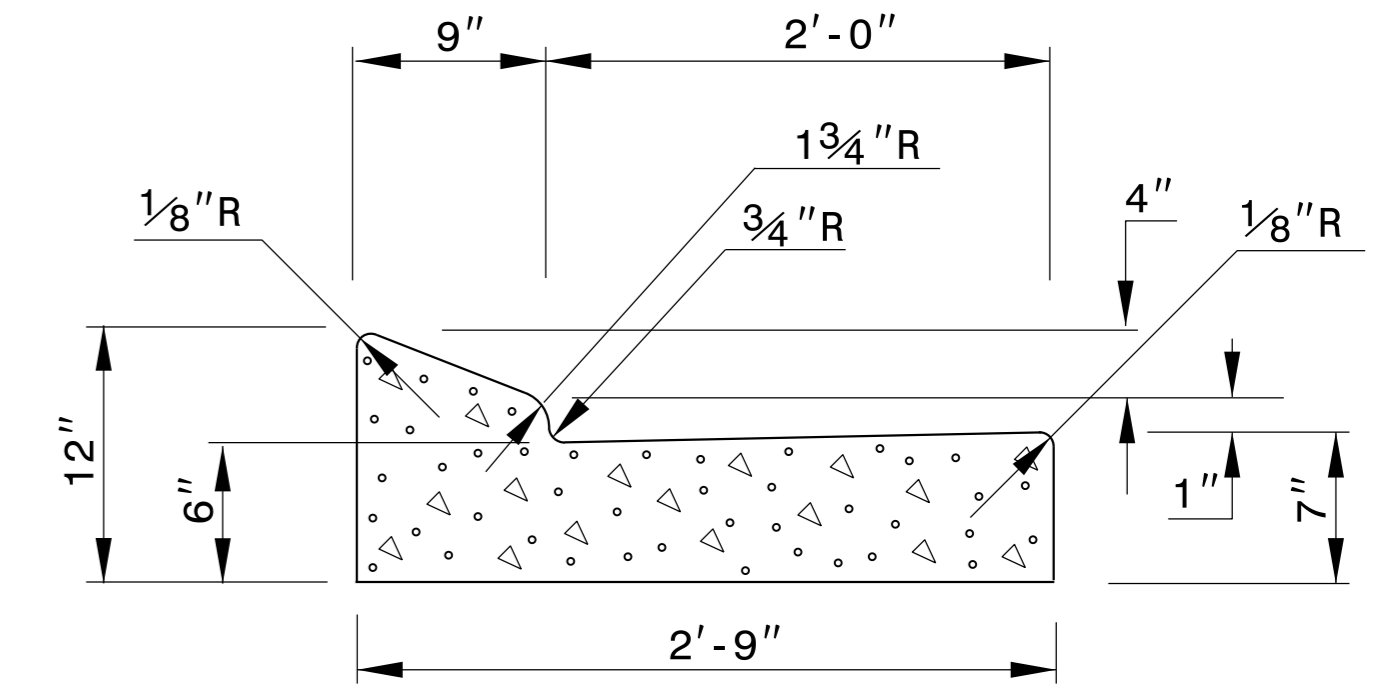
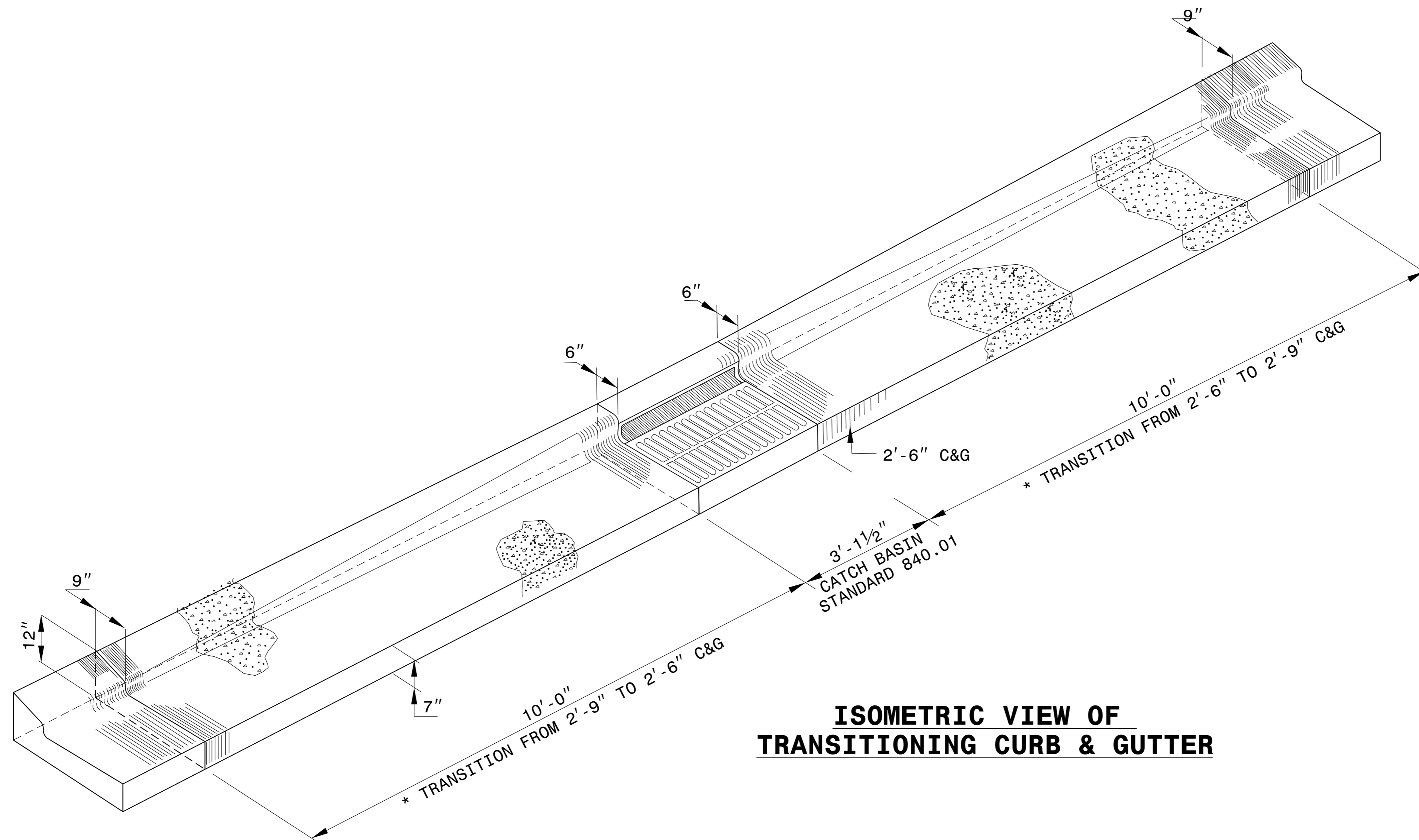

* MAINTAIN THE EDGE OF PAVEMENT. TRANSITION THE CURB ALONG THE BACK OF THE CURB.

8/11/2015

Professional Engineer Seal: JOEL S. HOWERTON, SEAL 022966, ENGINEER, NORTH CAROLINA.

DocuSigned by: Joel Howerton

CONTRACT STANDARDS
AND DEVELOPMENT UNIT
Office 919-707-6950 FAX 919-250-4119

**DETAIL OF 2'-9"
TO 2'-6" CURB & GUTTER
TRANSITION SECTION**

ORIGINAL BY:	DATE:
MODIFIED BY: tspell	DATE: July 14, 2009
CHECKED BY:	DATE:
FILE SPEC.: s:eric/usr/details/stand/cgtranst.dgn	

C:\P\2015\08\20150811\20150811.DWG
 USER: JHOWERTON
 TIME: 10:00 AM
 DATE: 8/11/2015