

**TIP PROJECT: W-5516**

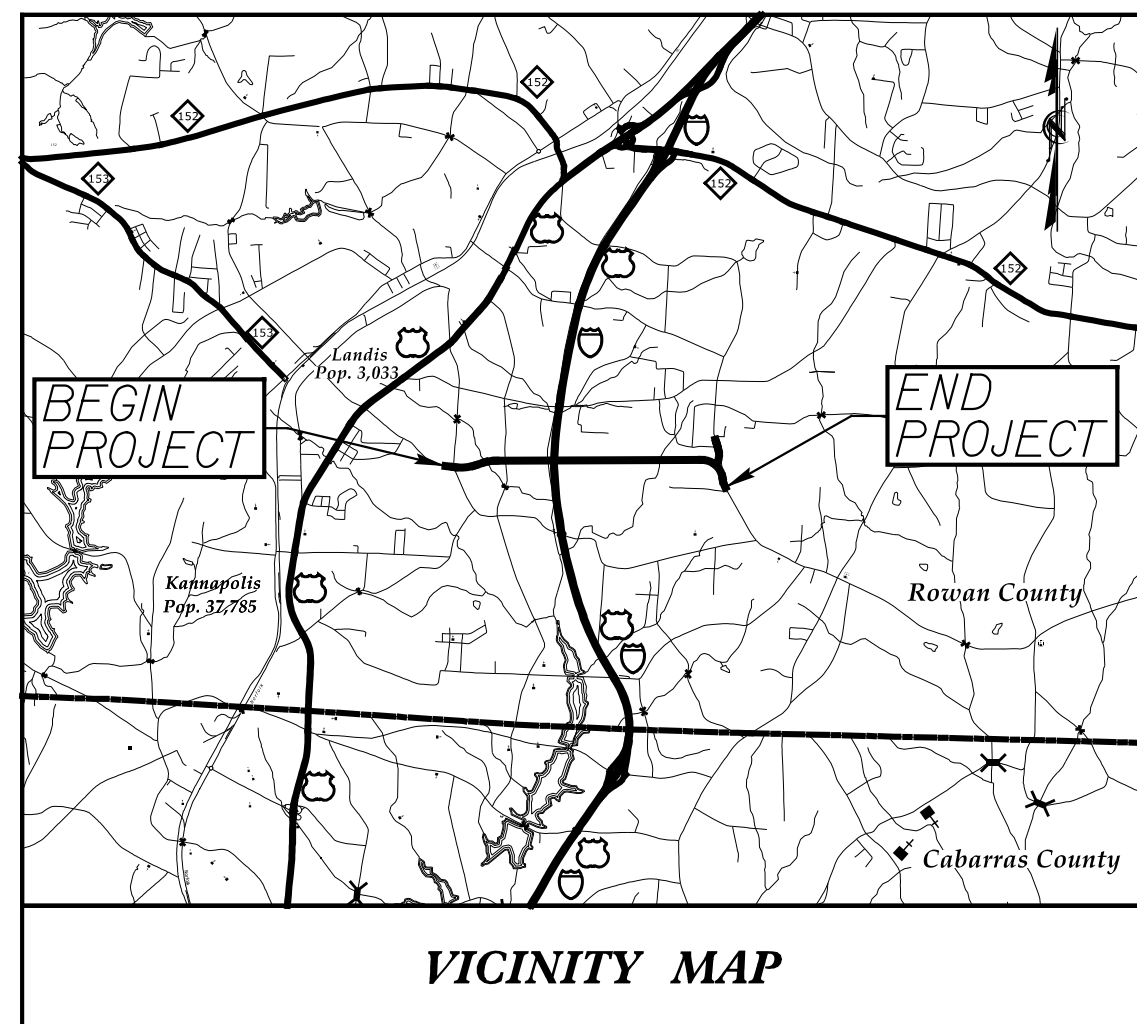

STATE OF NORTH CAROLINA  
DIVISION OF HIGHWAYS

---

PLAN FOR PROPOSED  
HIGHWAY EROSION CONTROL

---

**ROWAN COUNTY**

**LOCATION: OLD BEATTY FORD ROAD FROM WEST  
OF BOSTIAN ROAD INTERSECTION TO  
LENTZ ROAD**

**TYPE OF WORK: GRADING, PAVING, DRAINAGE, TRAFFIC  
CONTROL, SIGNING, PAVEMENT MARKINGS  
AND STRUCTURES**

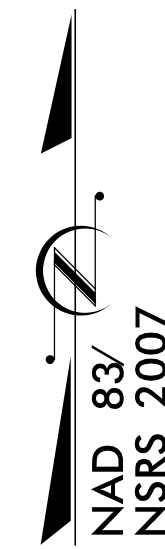
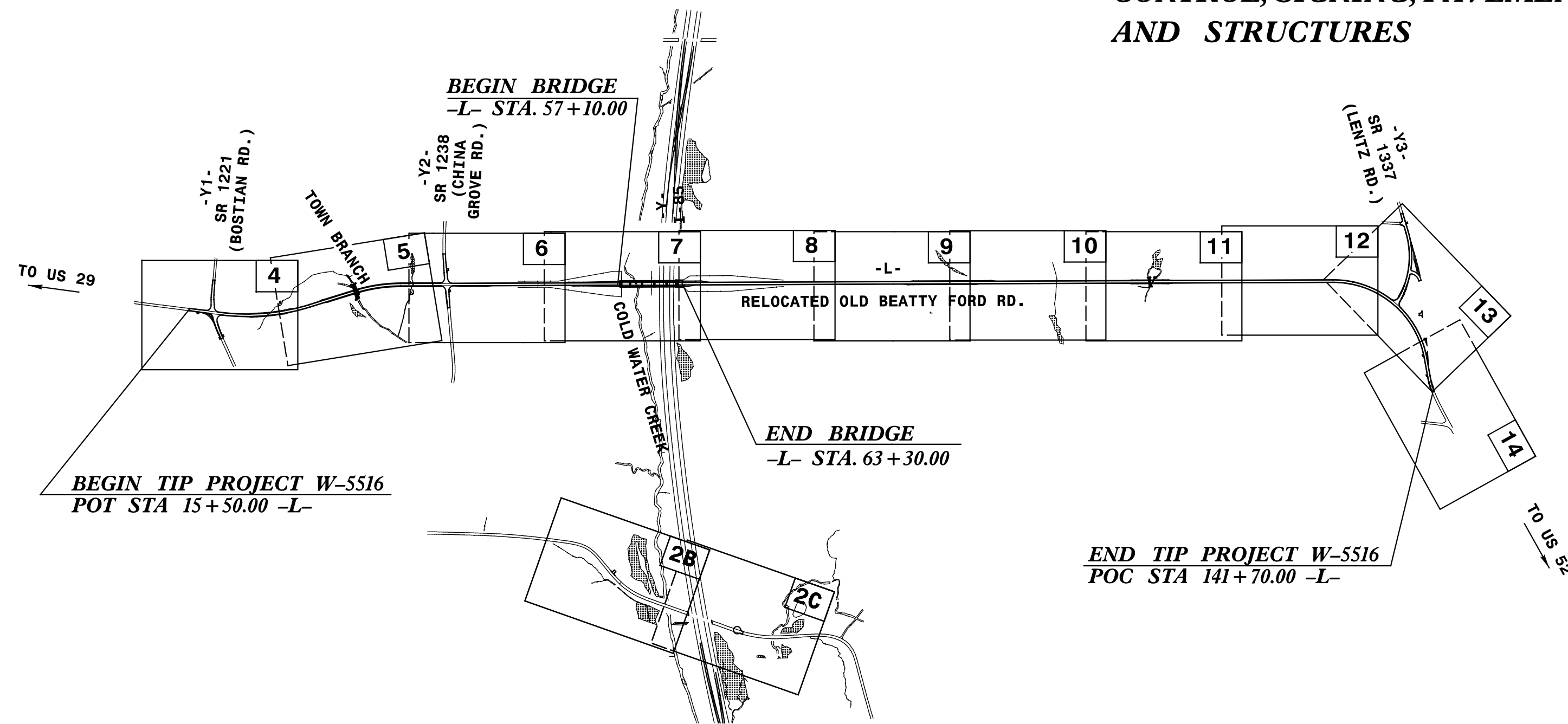

STATE	STATE PROJECT REFERENCE NO.	SHEET NO.	TOTAL SHEETS
N.C.	W-5516	EC-1	
STATE PROJ. NO.	F.A. PROJ. NO.	DESCRIPTION	
44105.1.FD	HSIP-1221(18)	PE	

**EROSION AND SEDIMENT CONTROL MEASURES**

Std. #	Description	Symbol
1630.03	Temporary Silt Ditch	---
1630.05	Temporary Diversion	--- TD ---
1605.01	Temporary Silt Fence	
1606.01	Special Sediment Control Fence	--- Z ---
1622.01	Temporary Berms and Slope Drains	--- B ---
1630.02	Silt Basin Type B	▨
1633.01	Temporary Rock Silt Check Type-A	▨
	Temporary Rock Silt Check Type-A with Matting and Polyacrylamide (PAM)	▨
1633.02	Temporary Rock Silt Check Type-B	▨
	Wattle / Coir Fiber Wattle	▨
	Wattle / Coir Fiber Wattle with Polyacrylamide (PAM)	▨
1634.01	Temporary Rock Sediment Dam Type-A	▨
1634.02	Temporary Rock Sediment Dam Type-B	▨
1635.01	Rock Pipe Inlet Sediment Trap Type-A	▨
1635.02	Rock Pipe Inlet Sediment Trap Type-B	▨
1630.04	Stilling Basin	▨
1630.06	Special Stilling Basin	▨
	Rock Inlet Sediment Trap:	
1632.01	Type A	A
1632.02	Type B	B
1632.03	Type C	C
	Skimmer Basin	▨
	Tiered Skimmer Basin	▨
	Infiltration Basin	▨

**THIS PROJECT CONTAINS  
EROSION CONTROL PLANS  
FOR CLEARING AND  
GRUBBING PHASE OF  
CONSTRUCTION.**

**THIS PROJECT HAS  
BEEN DESIGNED TO  
SENSITIVE WATERSHED  
STANDARDS.**

**HIGH QUALITY WATER(S) EXIST  
ON THIS PROJECT**

*High Quality Water Zone(s) Exist  
From Sta. 135+00 -L- @ Sta. 11+15 -Y3-  
to Sta. 141+70 -L- @ Sta. 16+75 -Y3-  
Refer To E. C. Special Provisions  
for Special Considerations.*

ALEXANDER SNIDER, P.E.  
ROADSIDE ENVIRONMENTAL ENGINEER  
3064  
LEVEL III CERTIFICATION NUMBER

STACEY H. BAILEY, P.E.  
ROADSIDE ENVIRONMENTAL PROJECT ENGINEER  
3074  
LEVEL III CERTIFICATION NUMBER

**GRAPHIC SCALE**

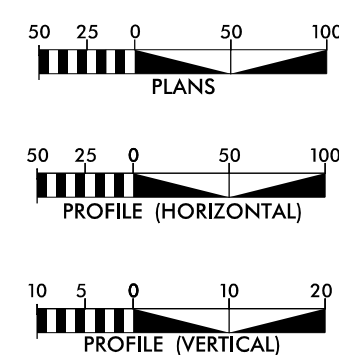

ROADSIDE ENVIRONMENTAL UNIT  
DIVISION OF HIGHWAYS  
STATE OF NORTH CAROLINA

LEVEL III CERTIFIED BY:  
STACEY H. BAILEY, PE  
CERTIFICATION NUMBER: 3074  
ISSUED: MAY 26, 2015

**THESE EROSION AND SEDIMENT CONTROL PLANS COMPLY  
WITH THE REGULATIONS SET FORTH BY THE  
NCG-010000 GENERAL CONSTRUCTION PERMIT EFFECTIVE AUGUST 3, 2011  
ISSUED BY THE NORTH CAROLINA DEPARTMENT OF ENVIRONMENT AND  
NATURAL RESOURCES DIVISION OF WATER QUALITY.**

Prepared In the Office of:

**ICA ENGINEERING**

5121 KINGDOM WAY  
SUITE 100  
RALEIGH, NC 27607  
919-851-6066  
NC LIC. NO. F-0258

**2012 STANDARD SPECIFICATIONS**

**Roadway Standard Drawings**

The following roadway english standards as appear in "Roadway Standard Drawings"- Roadway Design Unit - N. C. Department of Transportation - Raleigh, N. C., dated January 2012 and the latest revision thereto are applicable to this project and by reference hereby are considered a part of these plans.

1604.01 Railroad Erosion Control Detail	1632.01 Rock Inlet Sediment Trap Type A
1605.01 Temporary Silt Fence	1632.02 Rock Inlet Sediment Trap Type B
1606.01 Special Sediment Control Fence	1632.03 Rock Inlet Sediment Trap Type C
1607.01 Gravel Construction Entrance	1633.01 Temporary Rock Silt Check Type A
1622.01 Temporary Berms and Slope Drains	1633.02 Temporary Rock Silt Check Type B
1630.01 Riser Basin	1634.01 Temporary Rock Sediment Dam Type A
1630.02 Silt Basin Type B	1634.02 Temporary Rock Sediment Dam Type B
1630.03 Temporary Silt Ditch	1635.01 Rock Pipe Inlet Sediment Trap Type A
1630.04 Stilling Basin	1635.02 Rock Pipe Inlet Sediment Trap Type B
1630.05 Temporary Diversion	1640.01 Coir Fiber Baffle
1630.06 Special Stilling Basin	1645.01 Temporary Stream Crossing
1631.01 Matting Installation	