

09/08/09

See Sheet 1A For Index of Sheets
See Sheet 1B For Conventional Symbols

STATE OF NORTH CAROLINA
DIVISION OF HIGHWAYS

ROWAN COUNTY

LOCATION: SR 1210 (OLD BEATTY FORD ROAD) FROM WEST OF SR 1221 (BOSTIAN ROAD) INTERSECTION TO SR 1337 (LENTZ ROAD)
TYPE OF WORK: GRADING, DRAINAGE, PAVING, STRUCTURES, & CULVERTS.

STATE	STATE PROJECT REFERENCE NO.	SHEET NO.	TOTAL SHEETS
N.C.	W-5516	1	
STATE PROJ. NO.	F.A. PROJ. NO.	DESCRIPTION	
44105.1.FD1	HSIP-1221(18)	PE	
44105.2.FD1	HSIP-1221(18)	R/W	
44105.3.FD1	HSIP-1221(18)	CONST	

TIP PROJECT: W-5516

CONTRACT: C203652

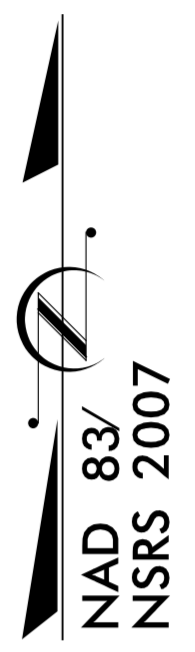
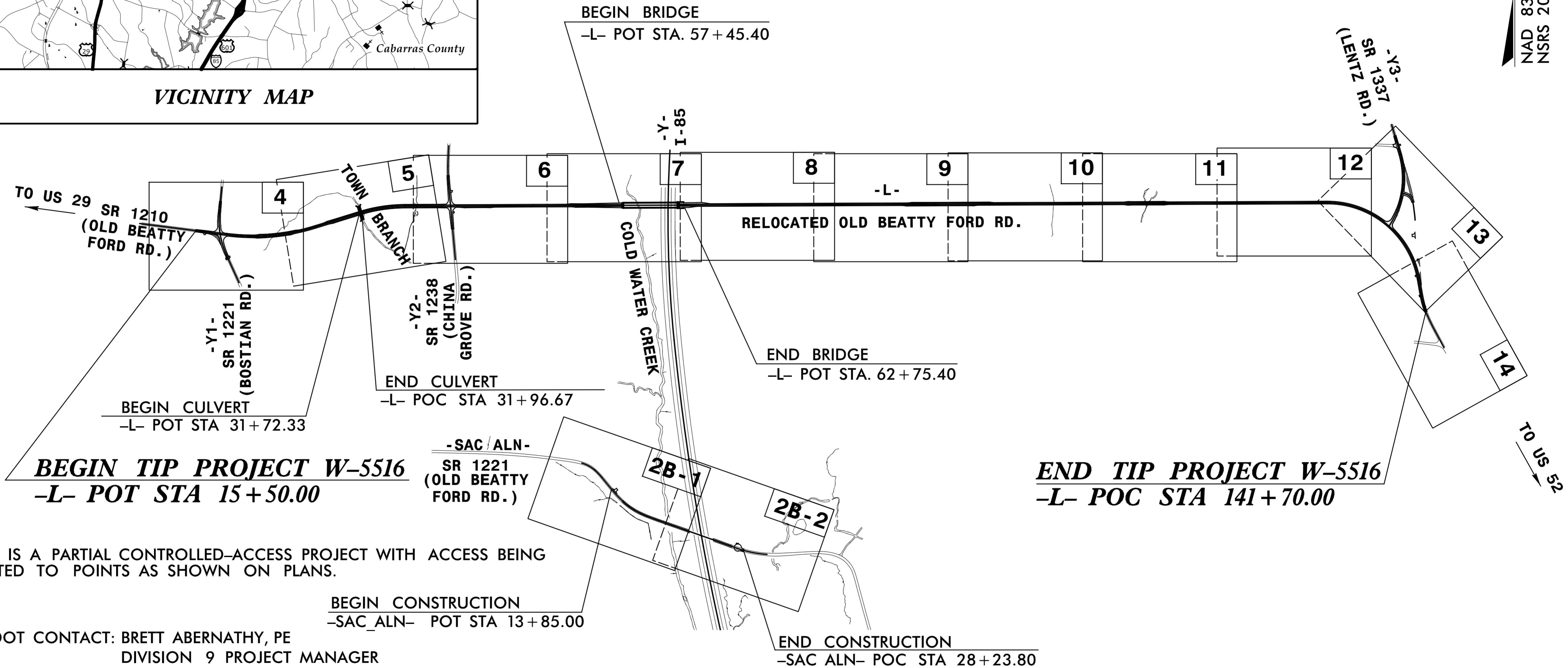
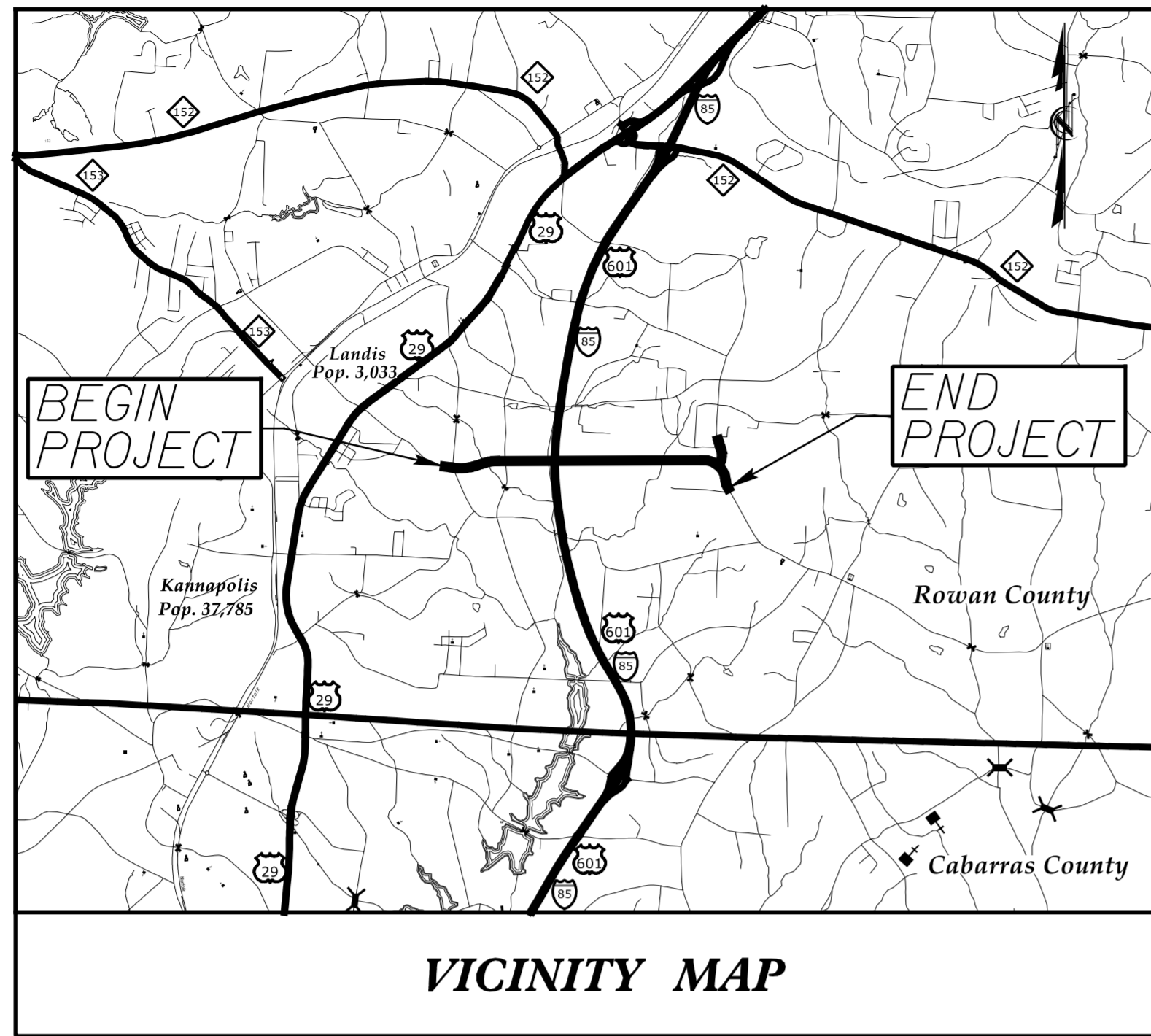

THIS IS A PARTIAL CONTROLLED-ACCESS PROJECT WITH ACCESS BEING LIMITED TO POINTS AS SHOWN ON PLANS.

NCDOT CONTACT: BRETT ABERNATHY, PE
DIVISION 9 PROJECT MANAGER

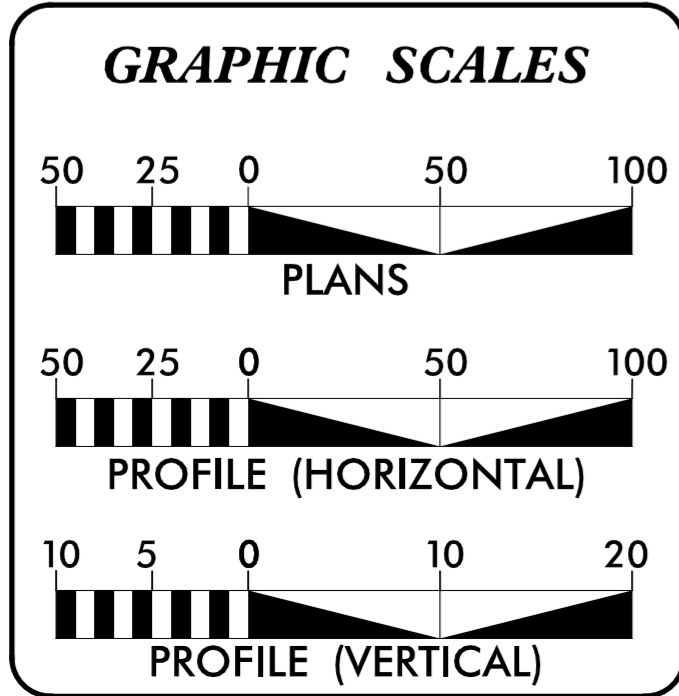

DESIGN DATA

ADT (2015) =	2000
ADT (2035) =	3300
DHV =	10 %
D =	65 %
T =	8 % *
V =	50 MPH
* TTST =	3% DUAL = 5%
FUNC CLASS =	COLLECTOR REGIONAL TIER

PROJECT LENGTH

LENGTH ROADWAY TIP PROJECT W-5516 =	2.290 MI
LENGTH STRUCTURE TIP PROJECT W-5516 =	0.100 MI
TOTAL LENGTH TIP PROJECT W-5516 =	2.390 MI

Prepared for the North Carolina Department of Transportation in the office of:

ICA Engineering
5121 Kingdom Way, Suite 100, Raleigh, NC 27607

2012 STANDARD SPECIFICATIONS

RIGHT OF WAY DATE: SEPTEMBER 16, 2014

LETTING DATE: SEPTEMBER 15, 2015

DAVID C. WALLER, PE
PROJECT ENGINEER

HENRY BARE
PROJECT DESIGN ENGINEER

HYDRAULICS ENGINEER

DocuSigned by: *Trent Corvair* 7/6/2015 P.E.

ROADWAY DESIGN ENGINEER

DocuSigned by: *David C. Waller* 7/6/2015 P.E.

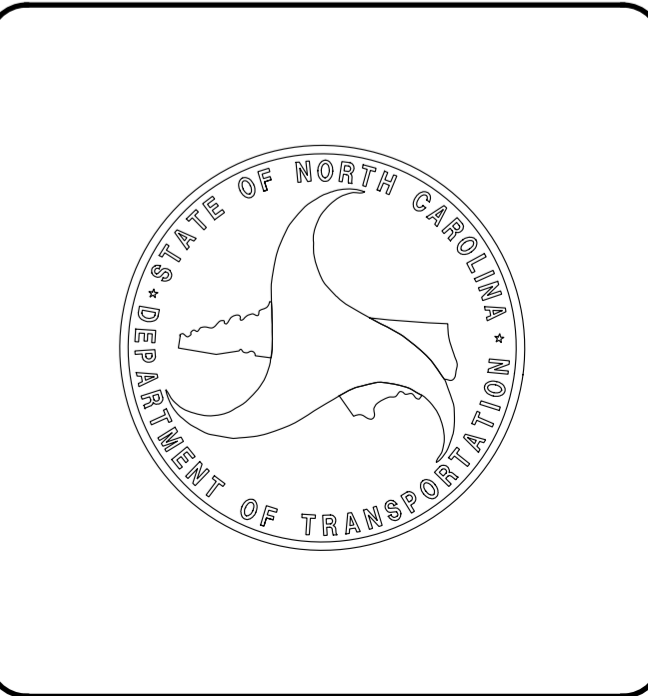

7/6/2015 R:\Roadway\Proj\w5516_rdy_tsh.dgn ICA ENGINEERING, INC.