

PROJECT REFERENCE NO. W-5103A	SHEET NO. EC-28
RW SHEET NO.	
ROADWAY DESIGN ENGINEER	HYDRAULICS ENGINEER

NAD 83 NSRS 2007

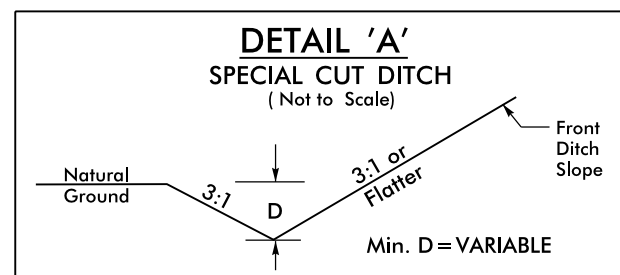

FROM STA. 92+00 CL TO STA. 94+50 CL -LI-
FROM STA. 97+50 CL TO STA. 102+00 CL -LI-

NOTE: TEMPORARY SILT FENCE SHALL BE INSTALLED A MINIMUM OF 3 FEET FROM TOE OF FILL EXCEPT NEAR WETLANDS AND JURISDICTIONAL AREAS.

-LI- STA. 94+09.86
BEGIN TRANSITIONAL MILLING (4" TO 1.5")

-LI- STA. 95+09.86
END TRANSITIONAL MILLING (4" TO 1.5")

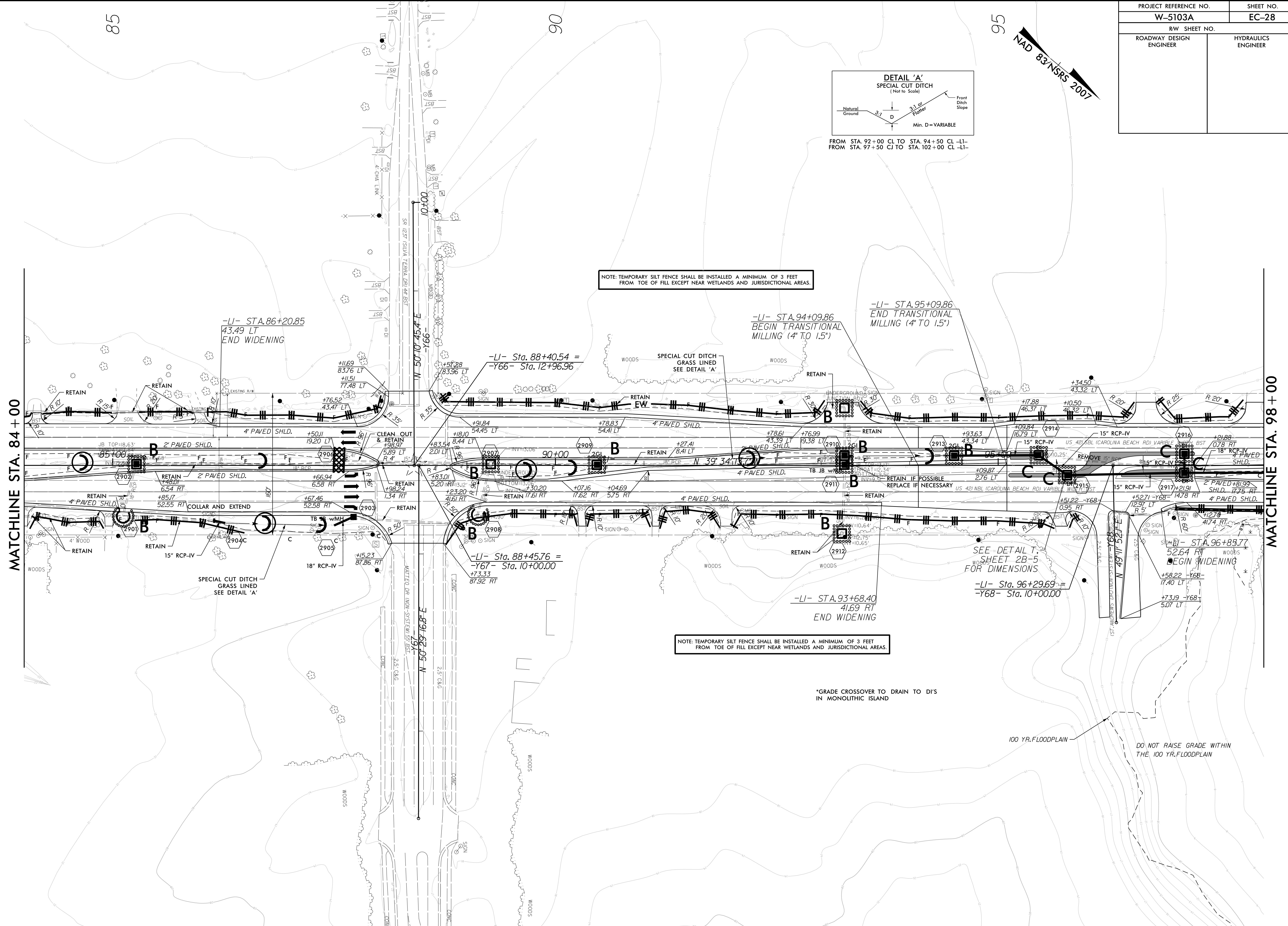

NOTE: TEMPORARY SILT FENCE SHALL BE INSTALLED A MINIMUM OF 3 FEET FROM TOE OF FILL EXCEPT NEAR WETLANDS AND JURISDICTIONAL AREAS.

*GRADE CROSSOVER TO DRAIN TO DI'S IN MONOLITHIC ISLAND

100 YR. FLOODPLAIN

DO NOT RAISE GRADE WITHIN THE 100 YR. FLOODPLAIN

MATCHLINE STA. 84 + 00

MATCHLINE STA. 98 + 00

REVISIONS

8/17/99

02 JUL 2016 13:44 NEW HANDOVER W-5103.41867.1.1.1 US 421 Median Crossover Relet (use this file)\ROADWAY\ProJ\PLAN SHEETS\EROSION CONTROL\W5103.D03_EC_28_PSH_29.dgn
\$\$\$\$\$SUSSTERNAL\$\$\$\$\$