

PROJECT REFERENCE NO.	SHEET NO.
W-5103A	EC-25
RW SHEET NO.	
ROADWAY DESIGN ENGINEER	HYDRAULICS ENGINEER

8/17/99

REVISIONS

C:\JULY\_2015\_1340\_NEW\_HANDOVER\W-5103\_41867\_1.1.1\_US\_421\_Median\_Crossover\_Relet\_(use\_this\_file)\ROADWAY\ProJ\PLAN\_SHEETS\_EROSION\_CONTROL\W5103.D03\_EC\_25\_PSH\_26.dgn

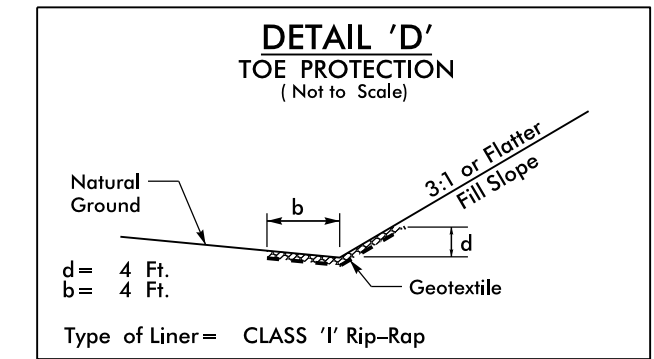
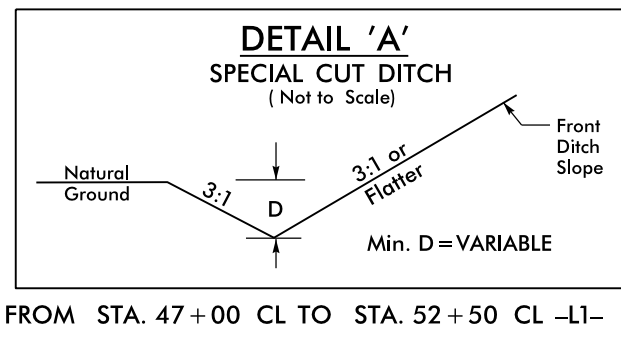
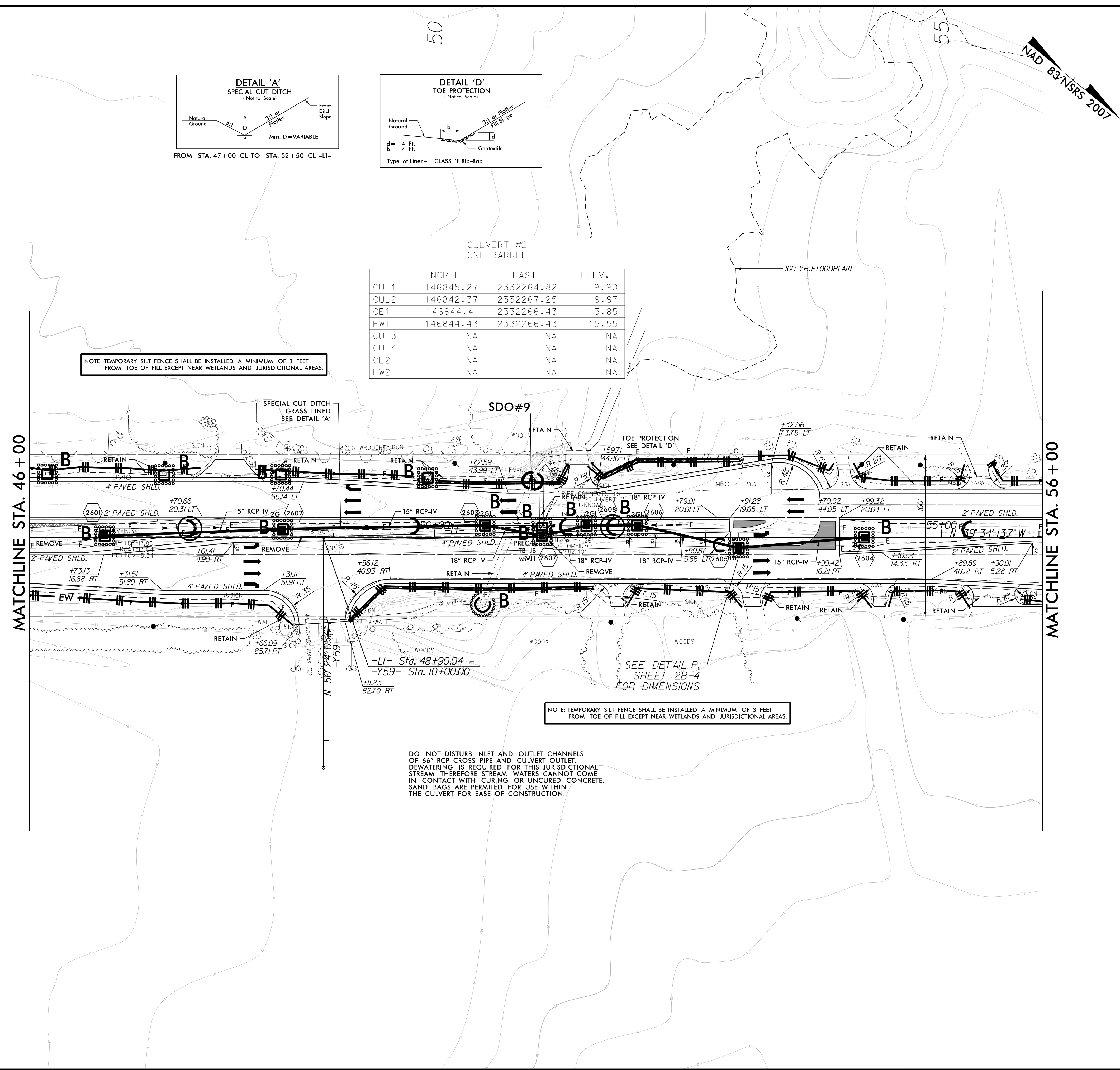

CULVERT #2  
ONE BARREL

	NORTH	EAST	ELEV.
CUL 1	146845.27	2332264.82	9.90
CUL 2	146842.37	2332267.25	9.97
CE 1	146844.41	2332266.43	13.85
HW 1	146844.43	2332266.43	15.55
CUL 3	NA	NA	NA
CUL 4	NA	NA	NA
CE 2	NA	NA	NA
HW 2	NA	NA	NA

NOTE: TEMPORARY SILT FENCE SHALL BE INSTALLED A MINIMUM OF 3 FEET FROM TOE OF FILL EXCEPT NEAR WETLANDS AND JURISDICTIONAL AREAS.

NOTE: TEMPORARY SILT FENCE SHALL BE INSTALLED A MINIMUM OF 3 FEET FROM TOE OF FILL EXCEPT NEAR WETLANDS AND JURISDICTIONAL AREAS.

DO NOT DISTURB INLET AND OUTLET CHANNELS OF 66" RCP CROSS PIPE AND CULVERT OUTLET. DEWATERING IS REQUIRED FOR THIS JURISDICTIONAL STREAM. THEREFORE STREAM WATERS CANNOT COME IN CONTACT WITH CURING OR UNCURED CONCRETE. SAND BAGS ARE PERMITTED FOR USE WITHIN THE CULVERT FOR EASE OF CONSTRUCTION.

MATCHLINE STA. 46+00

MATCHLINE STA. 56+00

NAD 83 NSRS 2007