

8/17/99

C:\JULY_2005_1329_NEW_HANDOVER\W-5103_41867_1.1.1_US_421 Meddon Crossover Relet (use this file)\ROADWAY\Pro\PLAN SHEETS_EROSION CONTROL\W5103.D03_EC.13_PSH_14.dgn
\$\$\$\$\$SUSTAINABLE\$\$\$\$\$

PROJECT REFERENCE NO. W-5103A	SHEET NO. EC-13
RW SHEET NO.	
ROADWAY DESIGN ENGINEER	HYDRAULICS ENGINEER

NAD 83/NSRS 2007

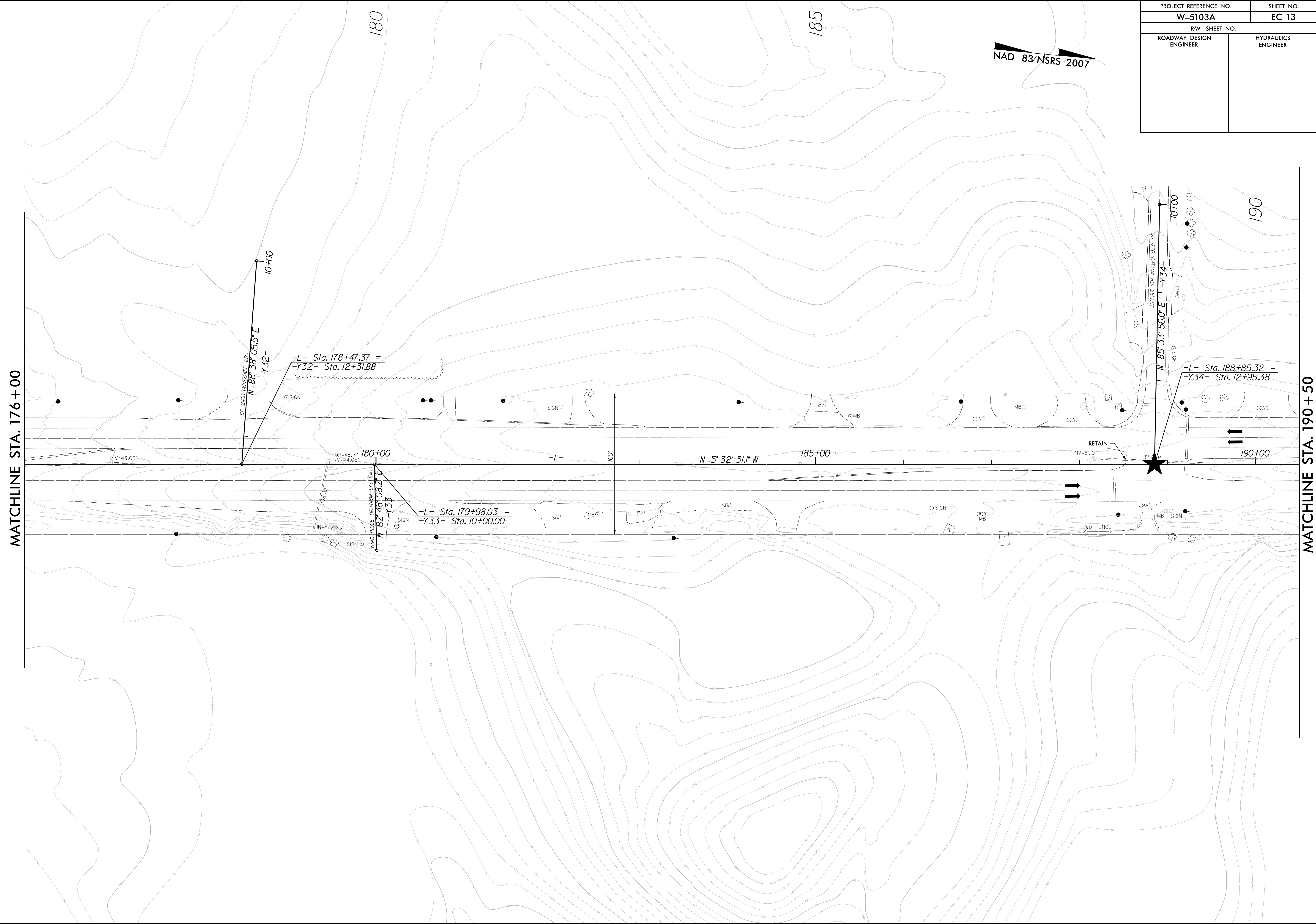

MATCHLINE STA. 176+00

MATCHLINE STA. 190+50

SR 2400 WINDGATE DR.
N 88° 38' 05.5" E
-Y32-

-L- Sta. 178+47.37 =
-Y32- Sta. 12+31.88

WIND RIDGE DRAINAGE SYSTEM
N 82° 48' 08.2" E
-Y33-

-L- Sta. 179+98.03 =
-Y33- Sta. 10+00.00

N 85° 33' 56.0" E
-Y34-

-L- Sta. 188+85.32 =
-Y34- Sta. 12+95.38

N 5° 32' 31" W

INV=43.03'

TOP=48.14'
INV=44.65'

RETAIN
INV=51.10'

10+00

190

18+00

190+00

180

185

