

PROJECT REFERENCE NO. <b>W-5103A</b>	SHEET NO. <b>EC-11</b>
RW SHEET NO.	
ROADWAY DESIGN ENGINEER	HYDRAULICS ENGINEER

NAD 83/NSRS 2007

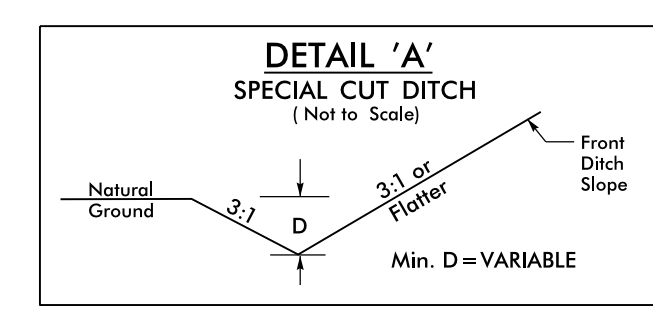

FROM STA. 138+50 CL TO STA. 143+50 CL -L-  
FROM STA. 143+70 CL TO STA. 149+00 CL -L-

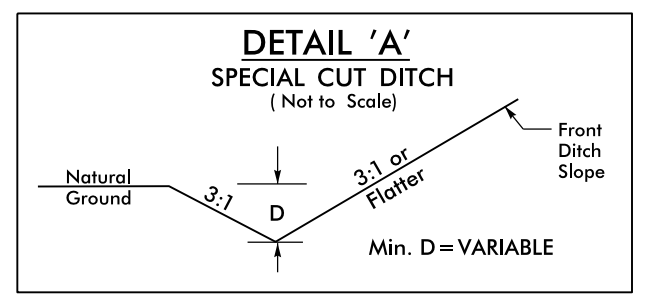

FROM STA. 152+00 CL TO STA. 156+50 CL -L-

REVISIONS  
 02 JUL 2015 1345 NEW HANDOVER W-5103-41867-1.1.1 US 421 Median Crossover Relet (use this file) \ROADWAY\PROJ\PLAN SHEETS-EROSION CONTROL\W5103.D03-EC-11\_PSH-12.dgn  
 8/17/99

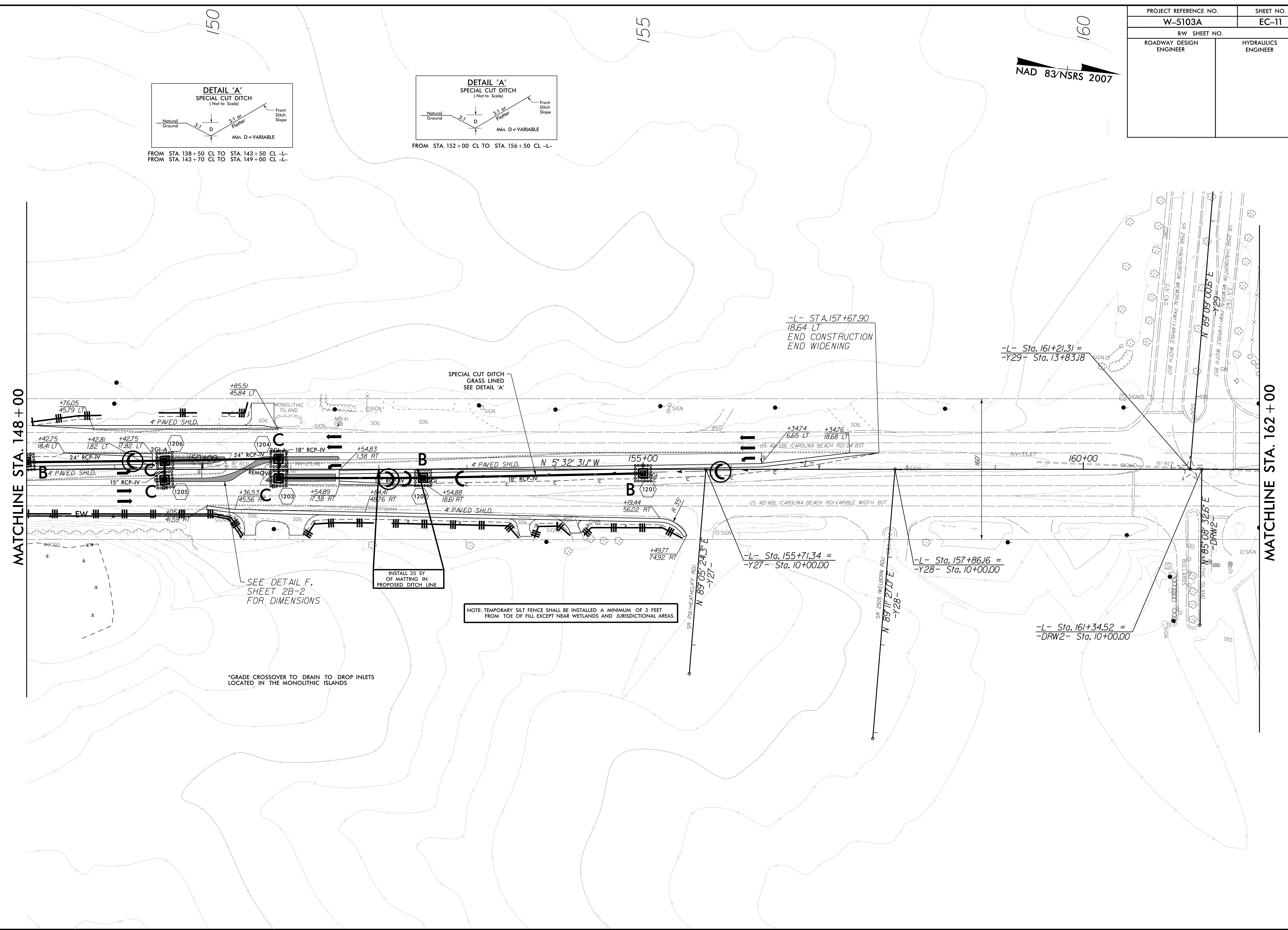

MATCHLINE STA. 148+00

MATCHLINE STA. 162+00

SEE DETAIL F, SHEET 2B-2 FOR DIMENSIONS

INSTALL 35 SY OF MATTING IN PROPOSED DITCH LINE

NOTE: TEMPORARY SILT FENCE SHALL BE INSTALLED A MINIMUM OF 3 FEET FROM TOE OF FILL EXCEPT NEAR WETLANDS AND JURISDICTIONAL AREAS.

\*GRADE CROSSOVER TO DRAIN TO DROP INLETS LOCATED IN THE MONOLITHIC ISLANDS

-L- STA. 157+67.90  
18.64 LT  
END CONSTRUCTION  
END WIDENING

-L- Sta. 161+21.31 =  
-Y29- Sta. 13+83.18

-L- Sta. 155+71.34 =  
-Y27- Sta. 10+00.00

-L- Sta. 157+86.16 =  
-Y28- Sta. 10+00.00

-L- Sta. 161+34.52 =  
-DRW2- Sta. 10+00.00