

FROM STA. 47+00 CL TO STA. 52+50 CL -LI-

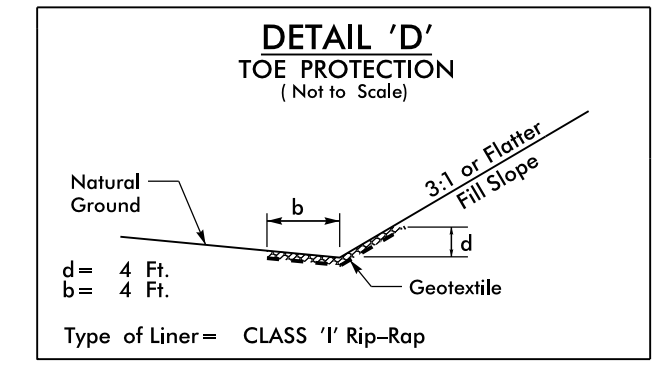

CULVERT #2
ONE BARREL

	NORTH	EAST	ELEV.
CUL 1	146845.27	2332264.87	9.90
CUL 2	146842.37	2332267.25	9.97
CE 1	146844.41	2332266.43	13.85
HW 1	146844.43	2332266.43	15.55
CUL 3	NA	NA	NA
CUL 4	NA	NA	NA
CE 2	NA	NA	NA
HW 2	NA	NA	NA

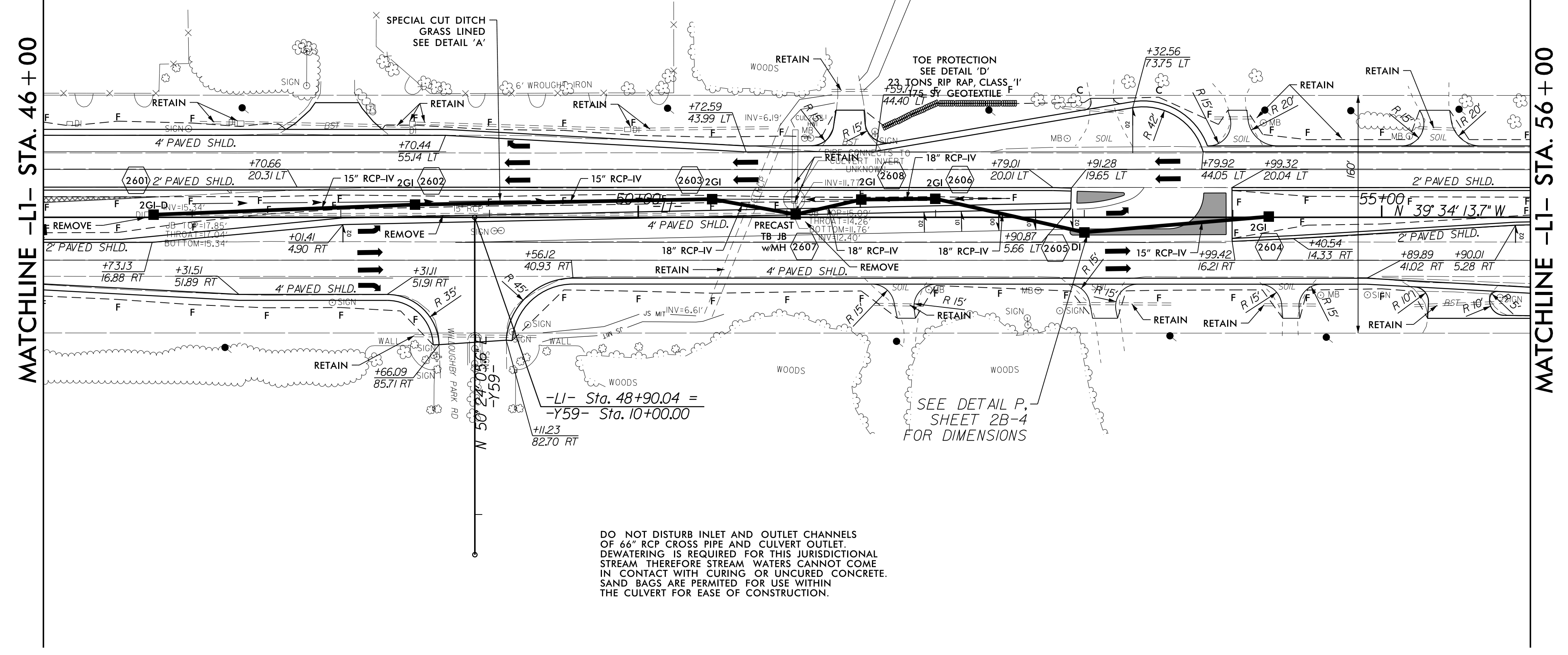

DO NOT DISTURB INLET AND OUTLET CHANNELS OF 66" RCP CROSS PIPE AND CULVERT OUTLET. DEWATERING IS REQUIRED FOR THIS JURISDICTIONAL STREAM. THEREFORE STREAM WATERS CANNOT COME IN CONTACT WITH CURING OR UNCURED CONCRETE. SAND BAGS ARE PERMITTED FOR USE WITHIN THE CULVERT FOR EASE OF CONSTRUCTION.

REVISIONS

8/17/99

I:\AUGUST 2015\1511\NEW HANDOVER\W-5103A-41867-1.1.1\US 421 Median Crosscover Relet (use this file)\ROADWAY\Proj\Plan_Sheets\W5103A-D03_Rdy_PSH_26.dgn
 \$\$\$\$\$\$SUSPENSE\$\$\$\$\$\$