

PROJECT REFERENCE NO. W-5103A	SHEET NO. 23
RW SHEET NO.	
ROADWAY DESIGN ENGINEER	HYDRAULICS ENGINEER
8/24/2015 1:20 PM PT	8/24/2015 5:52 PM ET

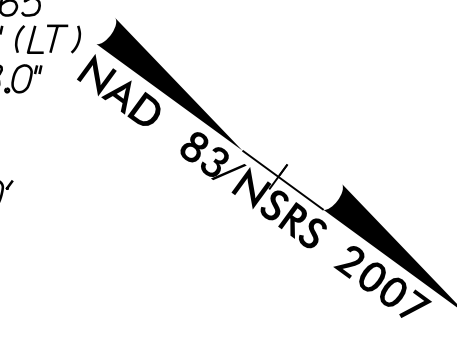

-RPIC- CURVE 1
 PI Sta 15+84.80
 $\Delta = 45^\circ 20' 31.9"$ (LT)
 $D = 4^\circ 05' 33.2"$
 $L = 1,107.92'$
 $T = 584.80'$
 $R = 1,400.00'$

-Y5I- CURVE 1
 PI Sta 11+88.26
 $\Delta = 74^\circ 22' 04.4"$ (RT)
 $D = 114^\circ 35' 29.6"$
 $L = 64.90'$
 $T = 37.93'$
 $R = 50.00'$

-LI- CURVE 2
 PI Sta 20+89.65
 $\Delta = 4^\circ 31' 11.0"$ (LT)
 $D = 2^\circ 29' 28.0"$
 $L = 181.43'$
 $T = 90.76'$
 $R = 2,300.00'$

-RPIA- CURVE 1
 PI Sta 11+47.87
 $\Delta = 41^\circ 36' 21.5"$ (RT)
 $D = 28^\circ 38' 52.4"$
 $L = 145.23'$
 $T = 75.98'$
 $R = 200.00'$

-LI- CURVE 1
 PI Sta 12+93.25
 $\Delta = 26^\circ 46' 06.6"$ (RT)
 $D = 6^\circ 52' 41.7"$
 $L = 389.18'$
 $T = 198.21'$
 $R = 833.00'$

-RPIB- CURVE 1
 PI Sta 13+42.47
 $\Delta = 132^\circ 41' 37.9"$ (RT)
 $D = 38^\circ 11' 49.9"$
 $L = 347.39'$
 $T = 342.47'$
 $R = 150.00'$

-L- STA. 301+86.30
 END CONSTRUCTION
 END 4' MILL & FILL

MATCHLINE -L- STA. 292+00

MATCHLINE -LI- STA. 20+50

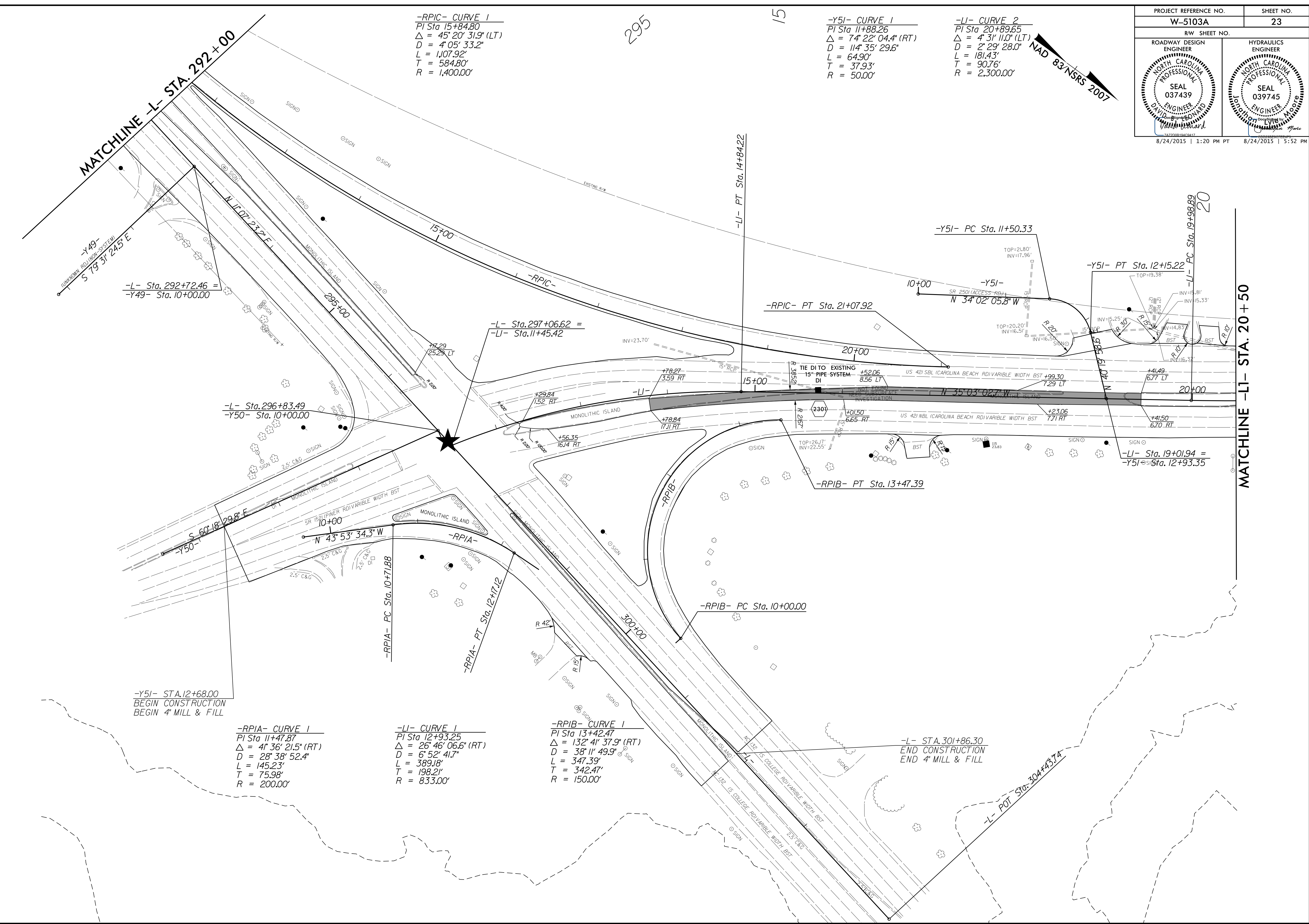

REVISIONS

8/17/19
 C:\Users\jdo\OneDrive\Documents\Projects\W-5103A\Drawings\W-5103A-D03-Rdwy_PSH_L23.dgn
 13 AUG 2015 10:01 AM
 NEW HANDOVER W-5103A-41867-1.1.1.S 421 Median Crossover Relet (use this file)\ROADWAY\Proj\Plan_Sheets\W5103A-D03-Rdwy_PSH_L23.dgn
 \$\$\$\$SUSTAINABLE\$\$\$\$