

TIP NO.	SHEET NO.
R-2915A	SIGN-10
APPROVED: <i>Joseph Kopschke</i> SC06EAEF80A54FA...	
DATE: 5/27/2015	
SEAL	

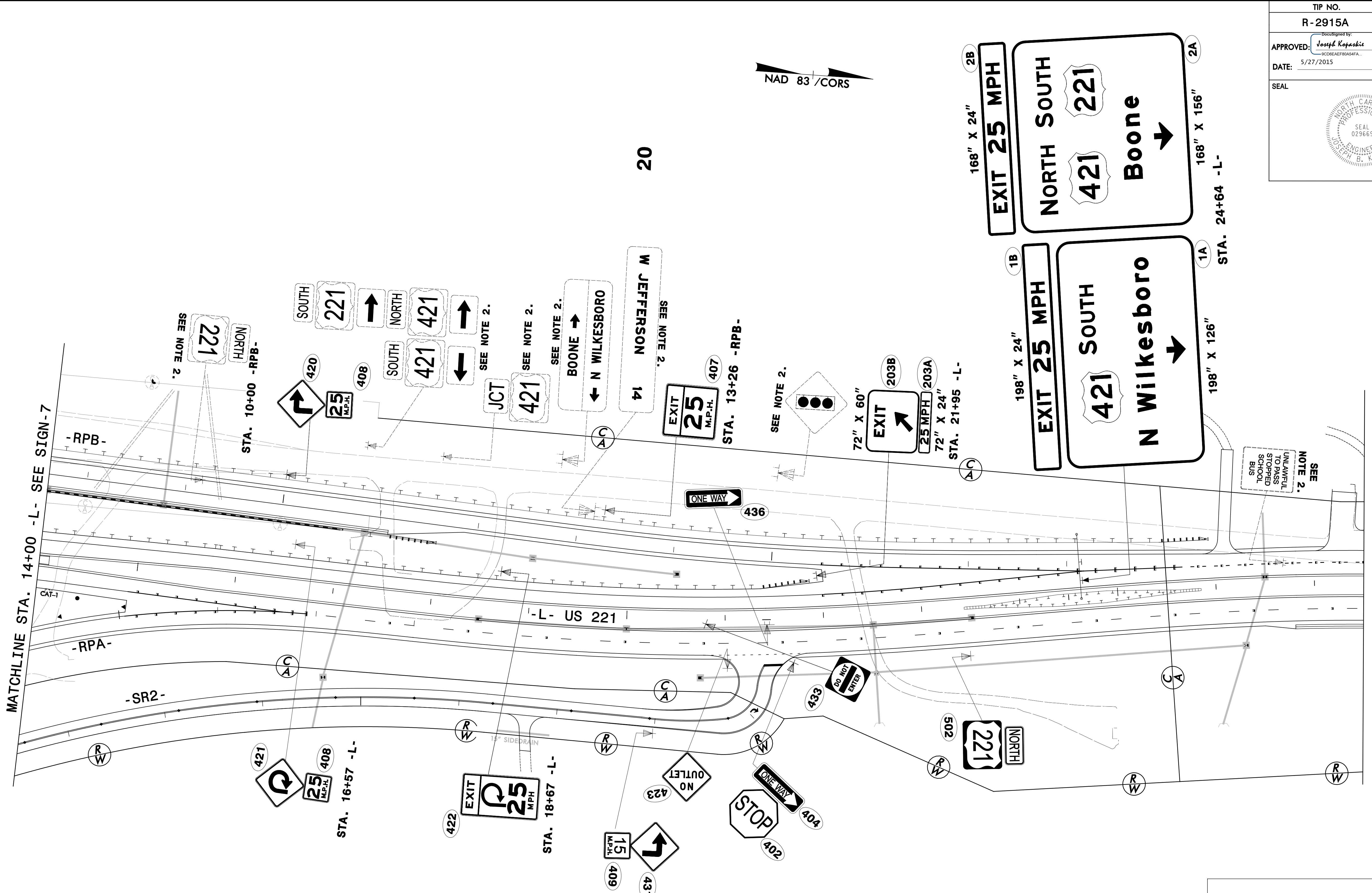

NOTES

- 2. DISPOSAL OF SIGN SYSTEM, U-CHANNEL

SEPI
ENGINEERING & CONSTRUCTION

1025 Wade Avenue
Raleigh, NC 27605
Tel: 919-789-9977
Fax: 919-789-9591
License: C-2197

**EXISTING & PROPOSED
SIGN DETAIL**

MATCHLINE STA. 14+00 -L- SEE SIGN-7

MATCHLINE STA. 27+50 -L- SEE SIGN-11

SEE NOTE 2.
UNLAWFUL TO PASS STOPPED SCHOOL BUS