

RS&H
IMPROVING YOUR WORLD
© 2012 REYNOLDS, SMITH AND HILLS, INC.
RS&H Architects-Engineers-Planners, Inc.
1520 South Boulevard, Suite 200
Charlotte, NC 28203
Phone: 704-752-0610
NC License No. F-0493 www.rsandh.com

V&M
Wong & Minton
Consulting Engineers
Asheville, North Carolina
828-253-2796
Copyright © 2008, Wagon & Minton, Inc. All Rights Reserved.

-DR3- HORIZONTAL CURVE DATA			-L- HORIZONTAL CURVE DATA		
PI Sta 11+80.57 Δ = 71° 06' 39.1" (LT) D = 81' 51" 04.0" L = 86.88' T = 50.03' R = 70.00'	PI Sta 10+40.17 Δ = 67° 36' 23.1" (RT) D = 95' 29' 34.7" L = 70.80' T = 40.17' R = 60.00'	PIs Sta 115+39.52 Θs = 6' 58' 44.0" Ls = 324.00' LT = 216.17' ST = 108.15'	PI Sta 119+92.99 Δ = 29° 08' 05.7" (LT) D = 4' 18' 28.6" L = 676.31' T = 345.63' R = 1,330.00' SE = 06 RO = 324	PIs Sta 124+3 Θs = 6' 58' 4" Ls = 324.00' LT = 216.17' ST = 108.15'	PIs Sta 128+63.83 Θs = 6' 58' 44.0" Ls = 324.00' LT = 216.17' ST = 108.15'
		PIs Sta 132+00.82 Δ = 19° 33' 07.8" (RT) D = 4' 18' 28.6" L = 453.86' T = 229.16' R = 1,330.00' SE = 06 RO = 324		PIs Sta 135+3 Θs = 6' 58' 4" Ls = 324.00' LT = 216.17' ST = 108.15'	

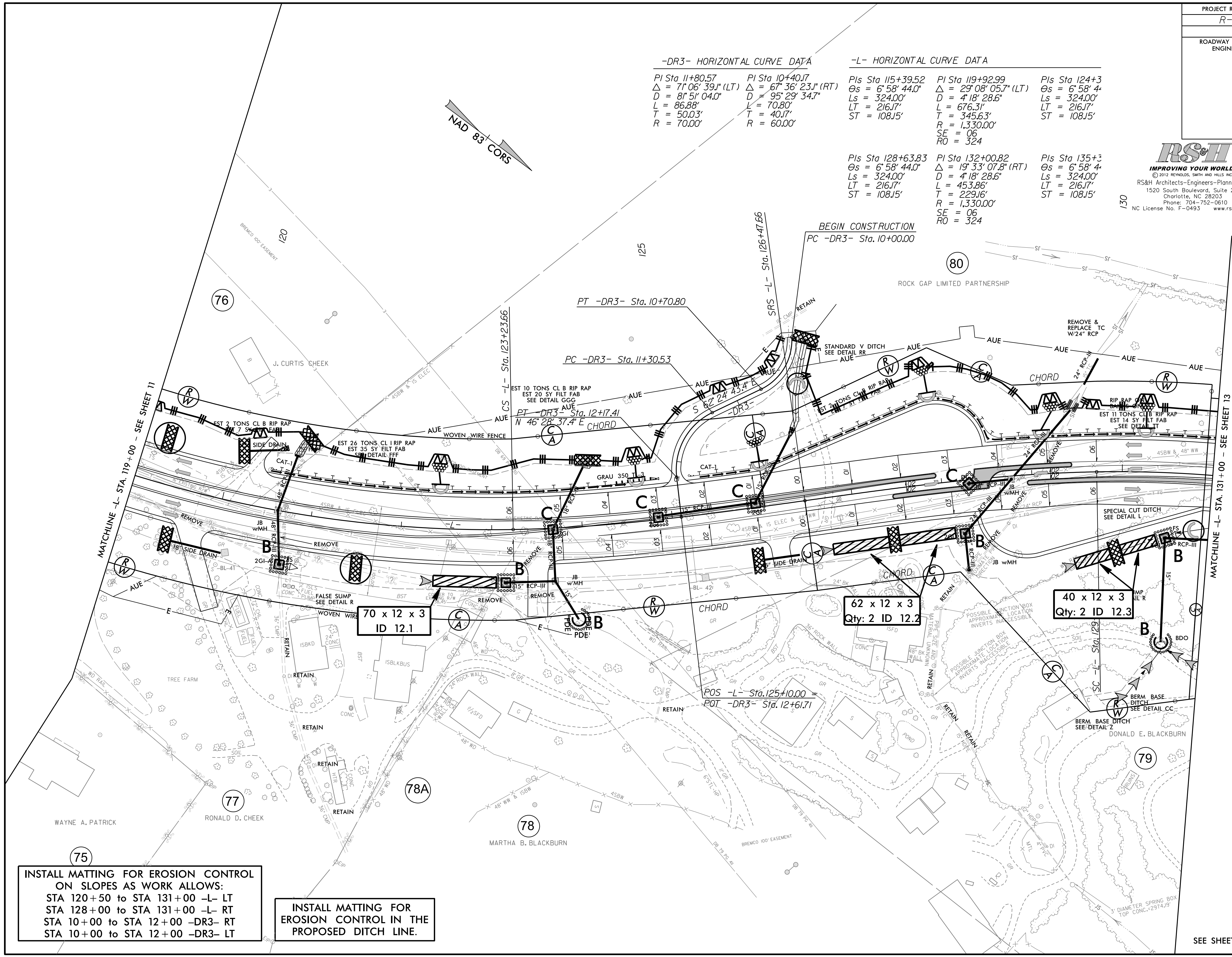
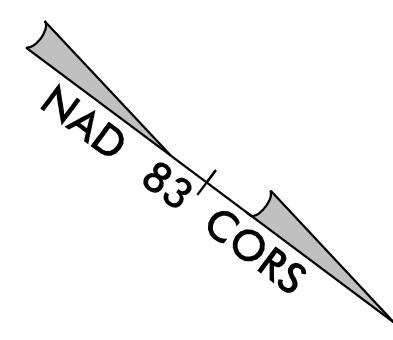

INSTALL MATTING FOR EROSION CONTROL ON SLOPES AS WORK ALLOWS:
 STA 120+50 to STA 131+00 -L- LT
 STA 128+00 to STA 131+00 -L- RT
 STA 10+00 to STA 12+00 -DR3- RT
 STA 10+00 to STA 12+00 -DR3- LT

INSTALL MATTING FOR EROSION CONTROL IN THE PROPOSED DITCH LINE.

SEE SHEET 28 FOR -L- PROFILE

\$DATE\$

\$FILE\$