

10206	US 221	-L-	12024
17376			20188
	175	1994	
	395	3206	
	SR 1003	-Y9-	
YR 2015	130		
YR 2035	200		

NAD 83 CORS

-Y8- HORIZONTAL CURVE DATA

PI Sta 11+73.32
 $\Delta = 37^{\circ} 21' 26.0''$ (LT)
 $D = 28^{\circ} 38' 52.4''$
 $L = 130.40'$
 $T = 67.61'$
 $R = 200.00'$

-Y9- HORIZONTAL CURVE DATA

PI Sta 11+60.32
 $\Delta = 36^{\circ} 35' 02.5''$ (LT)
 $D = 11^{\circ} 48' 48.8''$
 $L = 309.68'$
 $T = 160.32'$
 $R = 485.00'$
 $SE = 06$
 $RO = 124.08$

-L- HORIZONTAL CURVE DATA

PIs Sta 156+89.04	PI Sta 158+99.56	PIs Sta 161+09.99
$\Theta_s = 6^{\circ} 58' 44.0''$	$\Delta = 8^{\circ} 49' 46.3''$ (LT)	$\Theta_s = 6^{\circ} 58' 44.0''$
$L_s = 324.00'$	$D = 4^{\circ} 18' 28.6''$	$L_s = 324.00'$
$LT = 216.17'$	$L = 204.96'$	$LT = 216.17'$
$ST = 108.15'$	$T = 102.68'$	$ST = 108.15'$
	$R = 1,330.00'$	
	$SE = 06$	
	$RO = 204.95$	

CLEARING AND GRUBBING
 EROSION CONTROL FOR
 CONSTRUCTION SHEET 15

PROJECT REFERENCE NO.	SHEET NO.
R-2915A	EC-15/CONST15
RW SHEET NO.	
ROADWAY DESIGN ENGINEER	HYDRAULICS ENGINEER

RS&H
 IMPROVING YOUR WORLD
 © 2012 REYNOLDS, SMITH AND HILLS, INC.
 RS&H Architects-Engineers-Planners, Inc.
 1520 South Boulevard, Suite 200
 Charlotte, NC 28203
 Phone: 704-792-0610
 NC License No. E-0493 www.rsandh.com

V&M
 Consulting Engineers
 Asheville, North Carolina
 828-253-2796
 Copyright © 2006, Vaughn & Minton, Inc.
 All Rights Reserved.

END PROJECT R-2915A -L- STA. 160+01.83
BEGIN PROJECT R-2915B -L- STA. 158+31.70

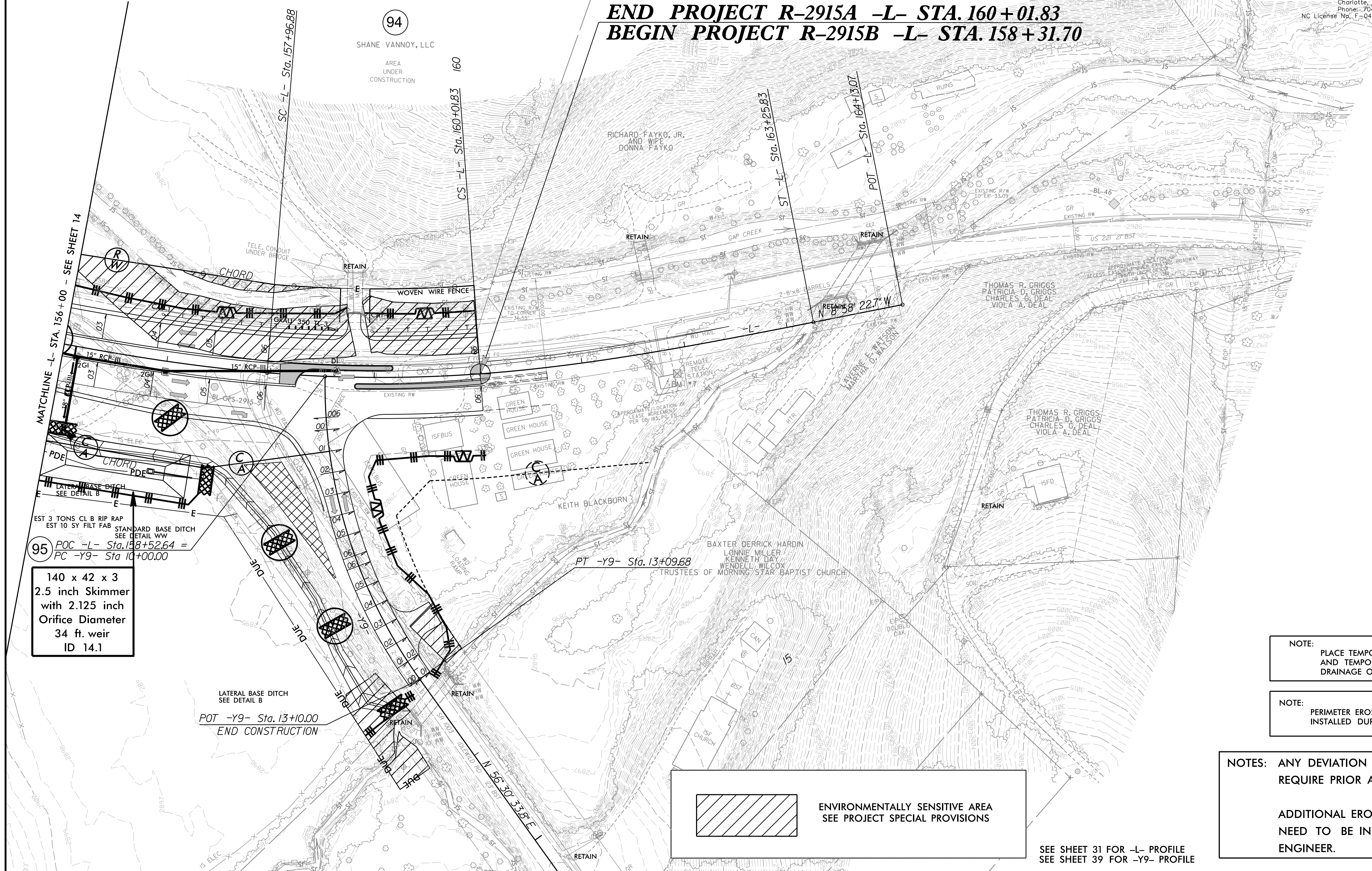

95 POC -L- Sta. 158+52.64 =
 PC -Y9- Sta 10+00.00

140 x 42 x 3
 2.5 inch Skimmer
 with 2.125 inch
 Orifice Diameter
 34 ft. weir
 ID 14.1

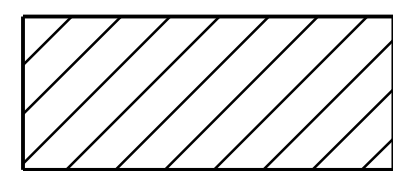
 ENVIRONMENTALLY SENSITIVE AREA
 SEE PROJECT SPECIAL PROVISIONS

SEE SHEET 31 FOR -L- PROFILE
 SEE SHEET 39 FOR -Y9- PROFILE

NOTE: PLACE TEMPORARY ROCK SEDIMENT DAMS TYPE - B AND TEMPORARY ROCK SILT CHECKS TYPE - A AT DRAINAGE OUTLETS.

NOTE: PERIMETER EROSION CONTROL MEASURES SHALL BE INSTALLED DURING CLEARING AND GRUBBING PHASE.

NOTES: ANY DEVIATION FROM OPTIONS GIVEN WILL REQUIRE PRIOR APPROVAL BY ENGINEER.

ADDITIONAL EROSION CONTROL DEVICES MAY NEED TO BE INSTALLED AS DIRECTED BY THE ENGINEER.