

|   |  |
|---|--|
| PROJECT REFERENCE NO.<br><b>R-2915A</b>   | SHEET NO.<br><b>38</b>   |
| ROADWAY DESIGN ENGINEER<br><b>Rachel M. Schuler</b><br>Professional Seal 26960<br>7/23/2015 | HYDRAULICS ENGINEER<br><b>Will W. Weather</b><br>Professional Seal 036188<br>7/23/2015 |

**RS&H**  
IMPROVING YOUR WORLD  
© 2012 REYNOLDS, SMITH AND HILLS, INC.  
RS&H Architects-Engineers-Planners, Inc.  
1520 South Boulevard, Suite 200  
Charlotte, NC 28203  
Phone: 704-752-0610  
NC License No. F-0493 www.rsandh.com

**V&M**  
Vaughan & Melton  
Consulting Engineers  
Asheville, NC  
North Carolina  
988-977-9455  
704-357-0488  
770-421-1929  
Copyright © 2006, Vaughn & Melton, Inc. All Rights Reserved.

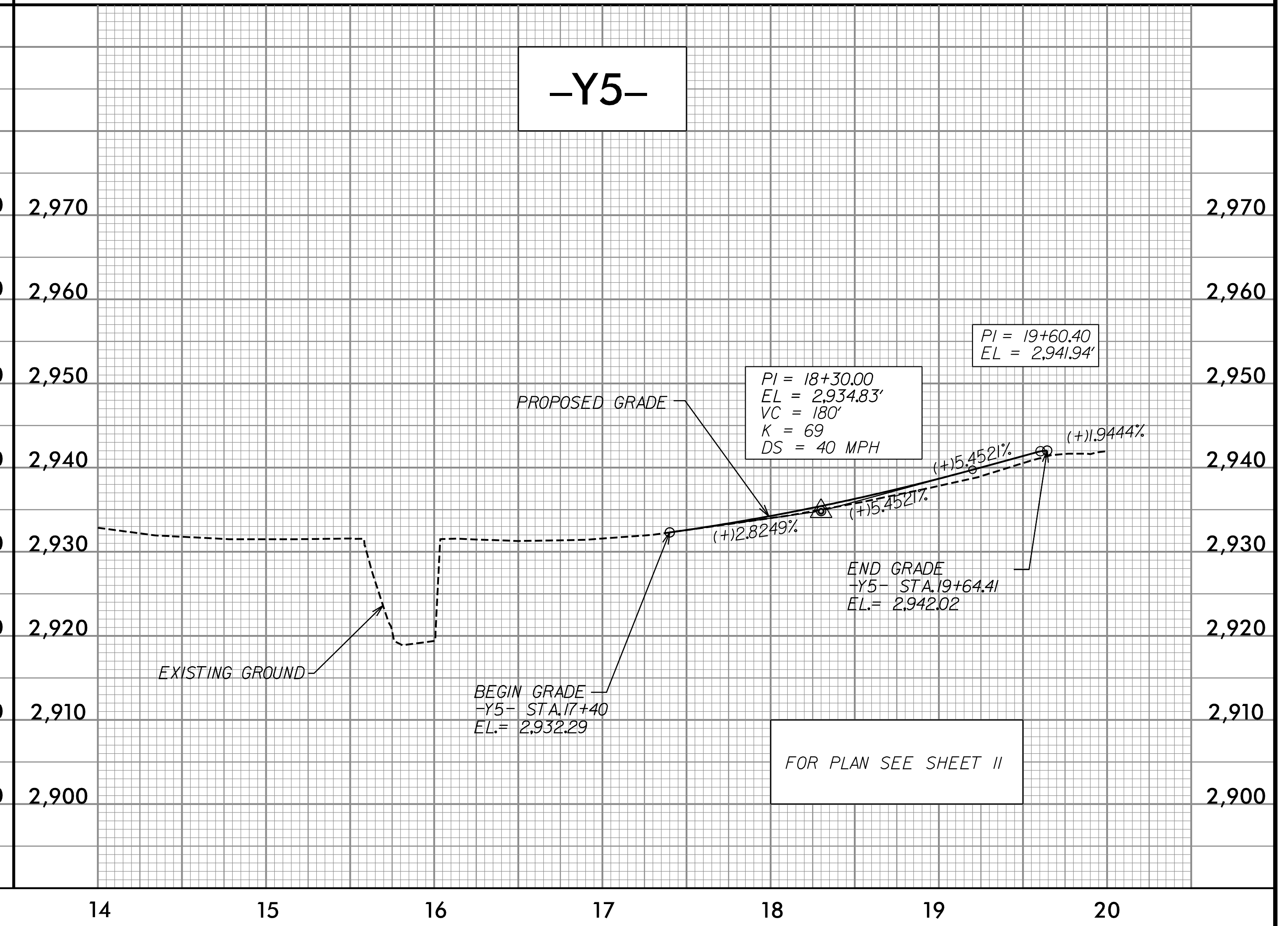
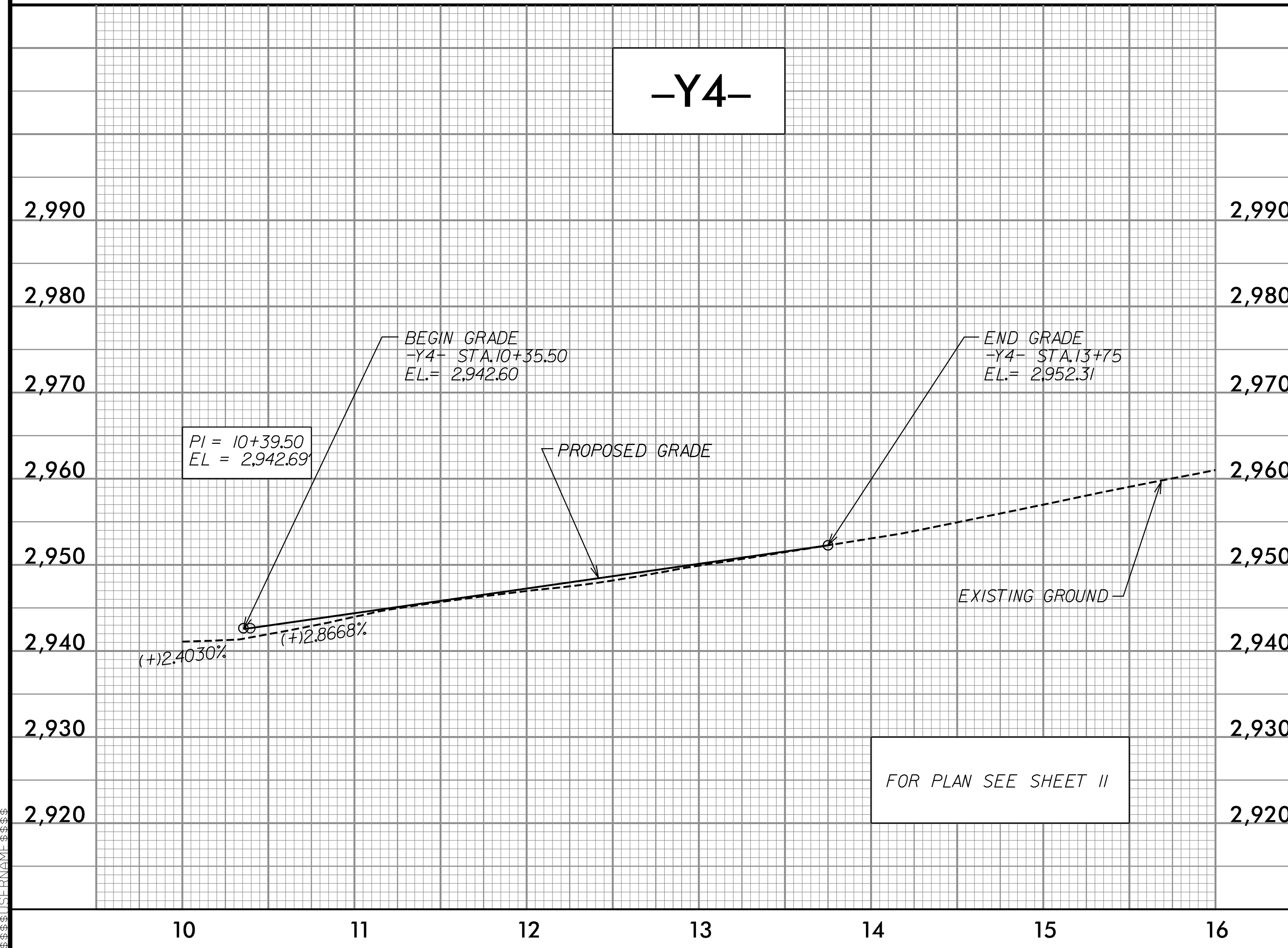
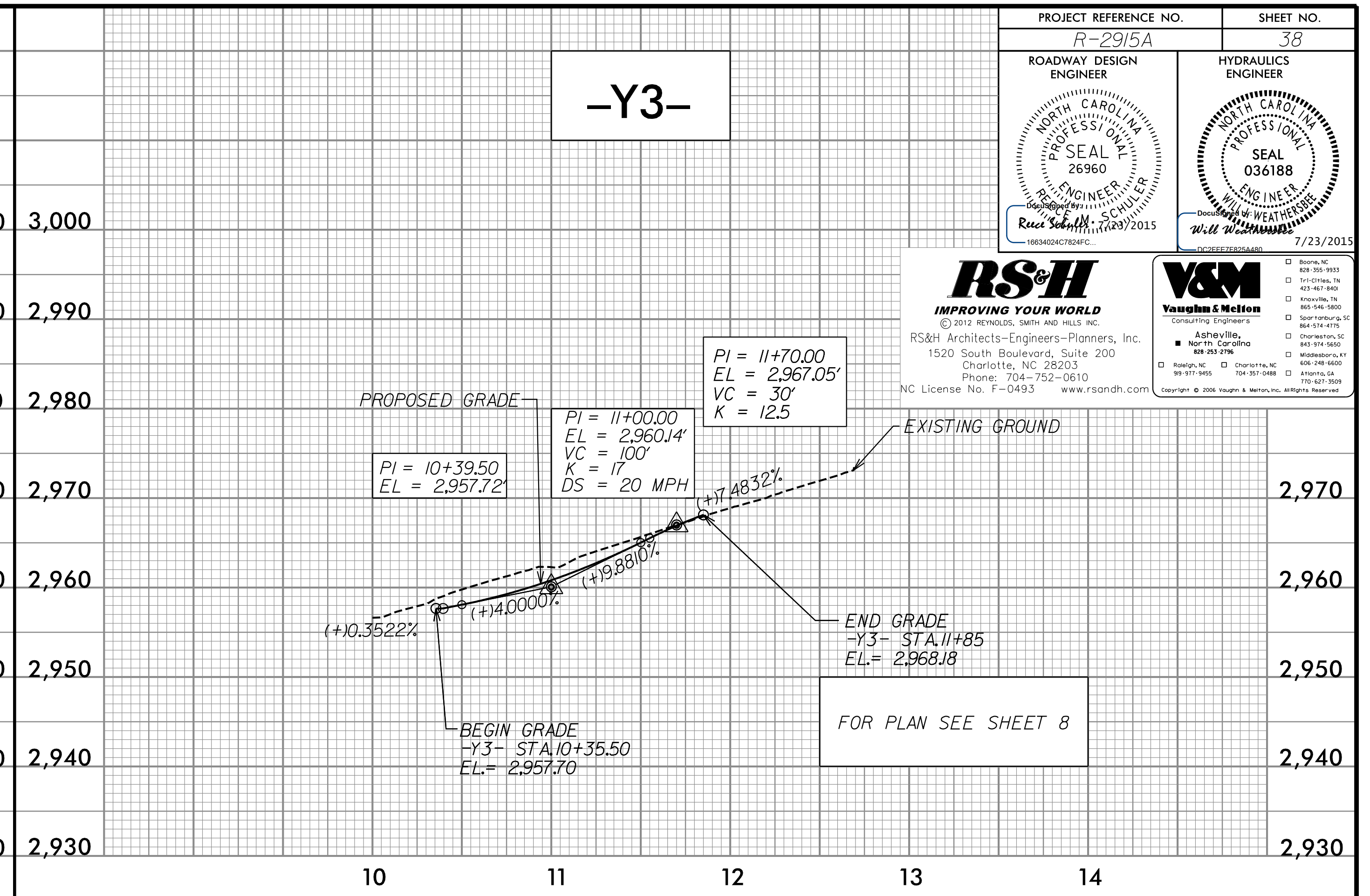
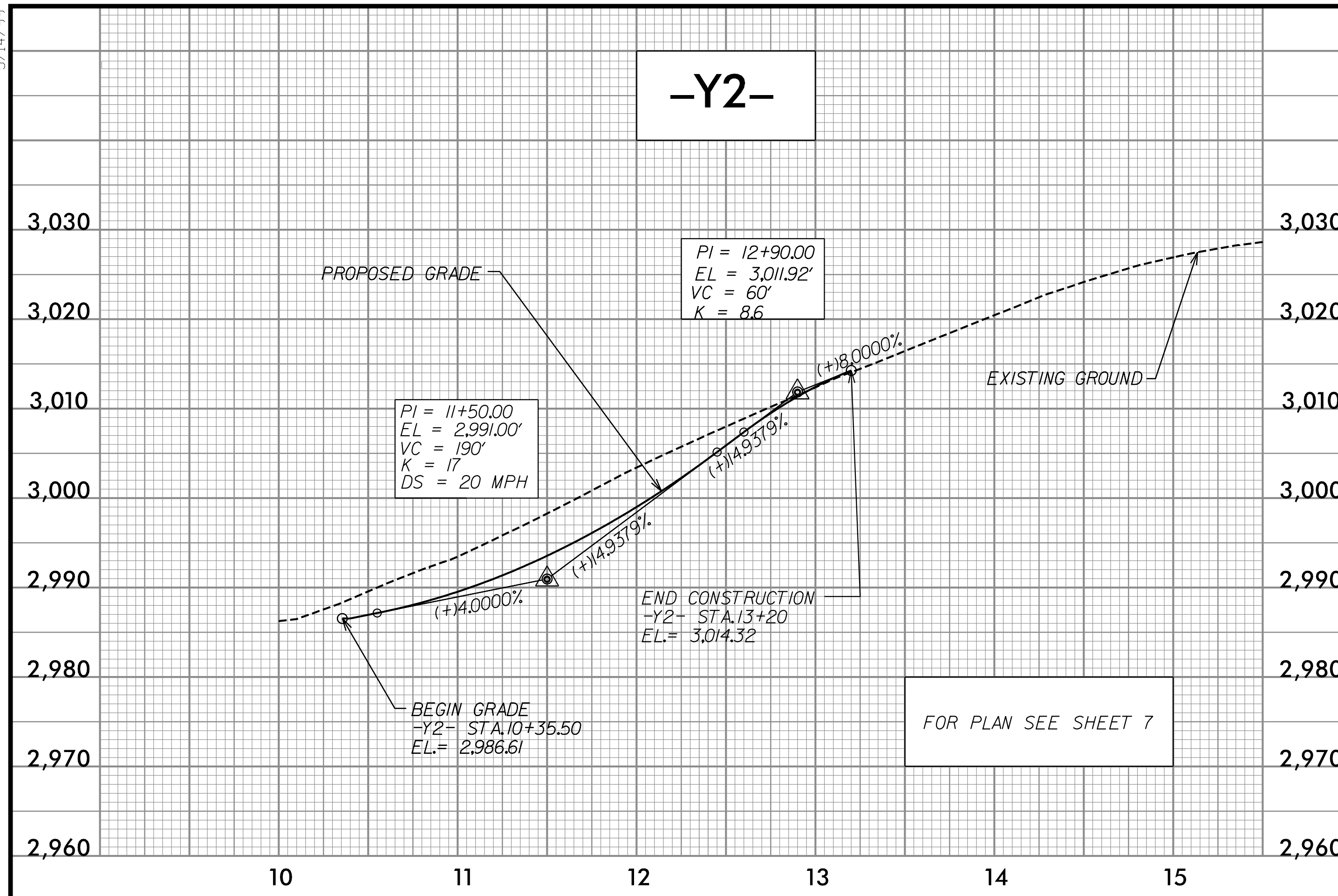

5/14/1999

10 11 12 13 14 15 16 17 18 19 20  
 2,920 2,930 2,940 2,950 2,960 2,970 2,980 2,990 3,000 3,010 3,020 3,030