

PROJECT REFERENCE NO. R-2915A	SHEET NO. 12
RW SHEET NO.	
ROADWAY DESIGN ENGINEER	HYDRAULICS ENGINEER

**RS&H**  
**IMPROVING YOUR WORLD**  
 © 2012 REMAINS. SMITH AND HULLS INC.  
 RS&H Architects-Engineers-Planners, Inc.  
 1520 South Boulevard, Suite 200  
 Charlotte, NC 28203  
 Phone: 704-752-0610  
 NC License No. F-0493 www.rsandh.com

**V&M**  
 Vaughan & Melton  
 Consulting Engineers  
 Asheville, NC  
 Phone: 828-253-2796

-DR3- HORIZONTAL CURVE DATA		-L- HORIZONTAL CURVE DATA		
PI Sta 11+80.57	PI Sta 10+40.17	PIs Sta 115+39.52	PI Sta 119+92.99	PIs Sta 124+31.81
$\Delta = 71^{\circ}06'39.1"$ (LT)	$\Delta = 67^{\circ}36'23.1"$ (RT)	$\Delta = 6^{\circ}58'44.0"$	$\Delta = 29^{\circ}08'05.7"$ (LT)	$\Delta = 6^{\circ}58'44.0"$
D = 81'51'04.0"	D = 95'29'34.7"	Ls = 324.00'	D = 4'18'28.6"	Ls = 324.00'
L = 86.88'	L = 70.80'	LT = 216.17'	L = 676.31'	LT = 216.17'
T = 50.03'	T = 40.17'	ST = 108.15'	T = 345.63'	ST = 108.15'
R = 70.00'	R = 60.00'		R = 1,330.00'	
			SE = 06	
			RO = 324	

REVISIONS

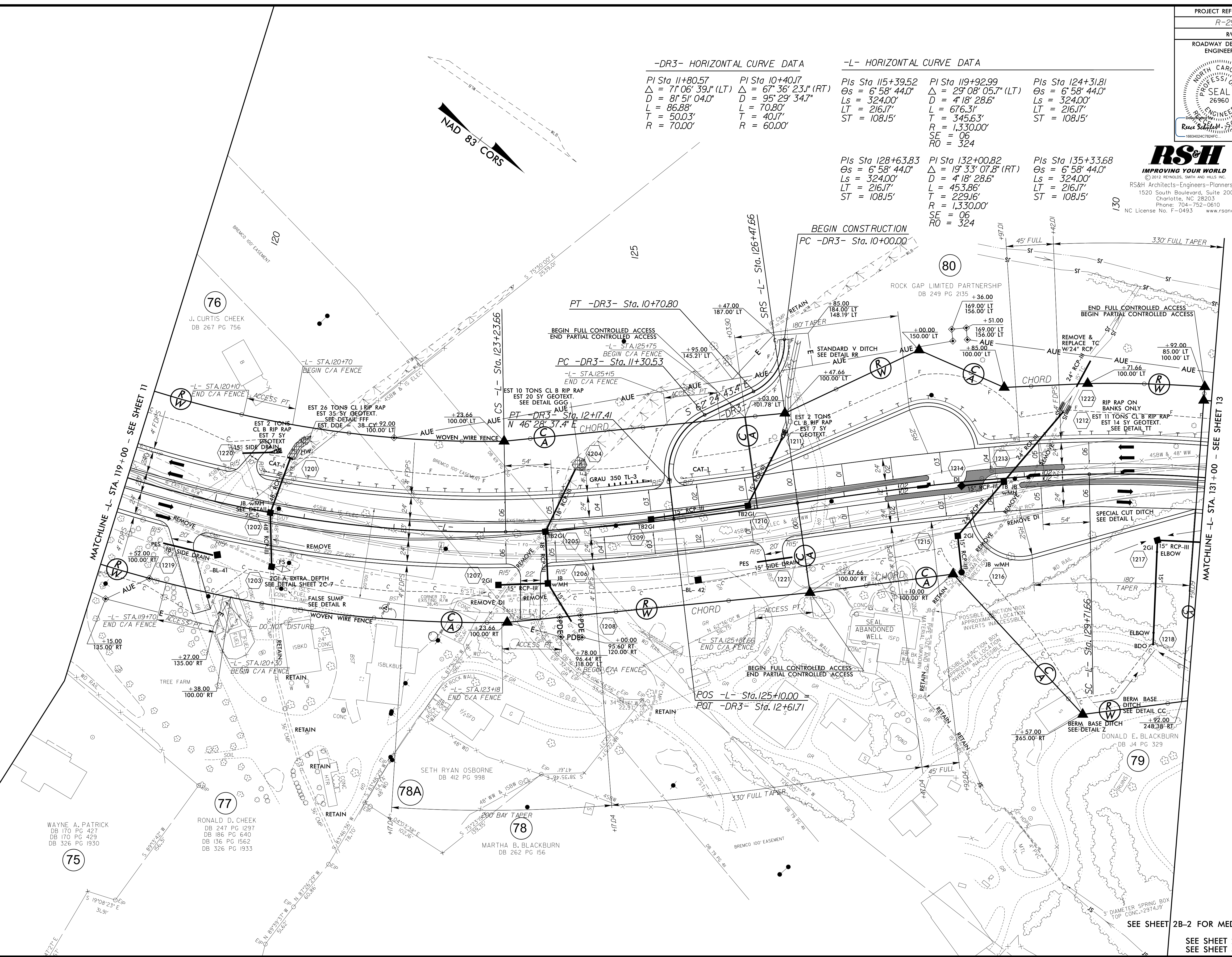

\$FILE\$  
\$DATE\$

SEE SHEET 28 FOR -L- PROFILE  
SEE SHEET 43 FOR -DR3- PROFILE