

BM #9 : RR SPIKE IN ROOT OF 24" FORKED CHERRY TREE, N 932968, E 1262584, 130' LEFT, -L- STA. 215+49.00, EL. 2871.28

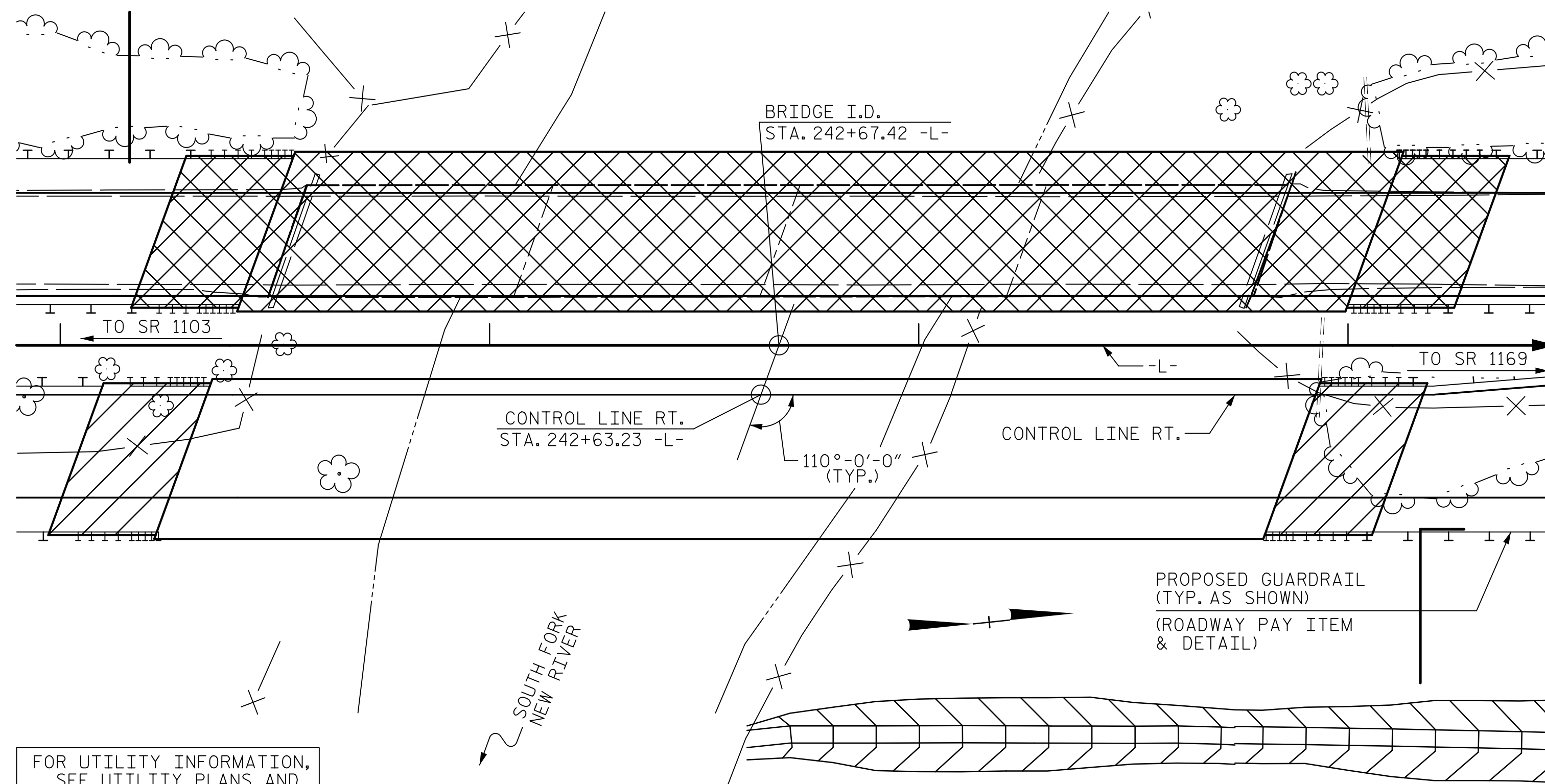

LOCATION SKETCH

HYDRAULIC DATA

DESIGN DISCHARGE	= 16,000 C.F.S.
FREQUENCY OF DESIGN FLOOD	= 50 YRS.
DESIGN HIGH WATER ELEVATION	= 2862.2
DRAINAGE AREA	= 130 SQ. MI.
BASE DISCHARGE (Q100)	= 19,000 C.F.S.
BASE HIGH WATER ELEVATION	= 2863.0

OVERTOPPING FLOOD DATA

OVERTOPPING DISCHARGE	= 24,000+ C.F.S.
FREQUENCY OF OVERTOPPING FLOOD	= 500+ YRS.
OVERTOPPING FLOOD ELEVATION	= 2869.2

NOTES:

ASSUMED LIVE LOAD = HL-93 OR ALTERNATE LOADING.
 THIS BRIDGE HAS BEEN DESIGNED IN ACCORDANCE WITH THE AASHTO LRFD BRIDGE DESIGN SPECIFICATIONS.
 THIS BRIDGE IS LOCATED IN SEISMIC ZONE 1.
 FOR OTHER DESIGN DATA AND GENERAL NOTES, SEE SHEET SN.
 FOR SUBMITTAL OF WORKING DRAWINGS, SEE SPECIAL PROVISIONS.
 FOR FALSEWORK AND FORMWORK, SEE SPECIAL PROVISIONS.
 FOR CRANE SAFETY, SEE SPECIAL PROVISIONS.
 FOR GROUT FOR STRUCTURES, SEE SPECIAL PROVISIONS.
 THE CONTRACTOR SHALL PROVIDE INDEPENDENT ASSURANCE SAMPLES OF REINFORCING STEEL AS FOLLOWS: FOR PROJECTS REQUIRING UP TO 400 TONS OF REINFORCING STEEL, ONE 30 INCH SAMPLE OF EACH SIZE BAR USED, AND FOR PROJECTS REQUIRING OVER 400 TONS OF REINFORCING STEEL, TWO 30 INCH SAMPLES OF EACH SIZE BAR USED. THE BARS FROM WHICH THE SAMPLES ARE TAKEN MUST THEN BE SPLICED WITH REPLACEMENT BARS OF THE SIZE AND LENGTH OF THE SAMPLE, PLUS A MINIMUM LAP SPLICE OF THIRTY BAR DIAMETERS. PAYMENT FOR THE SAMPLES OF REINFORCING STEEL SHALL BE CONSIDERED INCIDENTAL TO VARIOUS PAY ITEMS.

REMOVABLE FORMS MAY BE USED IN LIEU OF METAL STAY-IN-PLACE FORMS IN ACCORDANCE WITH ARTICLE 420-3 OF THE STANDARD SPECIFICATIONS.

AT THE CONTRACTOR'S OPTION, AND UPON REMOVAL OF THE CAUSEWAY, THE CLASS II RIP RAP MAY BE PLACED AS RIP RAP SLOPE PROTECTION. SEE SPECIAL PROVISIONS FOR CONSTRUCTION MAINTENANCE AND REMOVAL OF TEMPORARY ACCESS AT STATION 242+67.42 -L-.

NEEDLE BEAMS WILL NOT BE ALLOWED UNLESS OTHERWISE CALLED FOR ON THE PLANS OR APPROVED BY THE ENGINEER.

THE CLASS AA CONCRETE IN THE BRIDGE DECK SHALL CONTAIN FLY ASH OR GROUND GRANULATED BLAST FURNACE SLAG AT THE SUBSTITUTION RATE SPECIFIED IN ARTICLE 1024-1 AND IN ACCORDANCE WITH ARTICLES 1024-5 AND 1024-5 OF THE STANDARD SPECIFICATIONS. NO PAYMENT WILL BE MADE FOR THIS SUBSTITUTION AS IT IS CONSIDERED INCIDENTAL TO THE COST OF THE REINFORCED CONCRETE DECK SLAB.

THIS STRUCTURE HAS BEEN DESIGNED IN ACCORDANCE WITH "HEC 18 - EVALUATING SCOUR AT BRIDGES".

FOR EROSION CONTROL MEASURES, SEE EROSION CONTROL PLANS.

TOTAL BILL OF MATERIAL

	CONSTRUCTION, MAINTENANCE & REMOVAL OF TEMPORARY ACCESS	4'-0" Ø DRILLED PIERS IN SOIL	4'-0" Ø DRILLED PIERS NOT IN SOIL	PERMANENT STEEL CASING FOR 4'-0" Ø DRILLED PIERS	4'-6" Ø DRILLED PIERS IN SOIL	4'-6" Ø DRILLED PIERS NOT IN SOIL	PERMANENT STEEL CASING FOR 4'-6" Ø DRILLED PIERS	CSL TESTING	REINFORCED CONCRETE DECK SLAB
	LUMP SUM	LIN. FT.	LIN. FT.	LIN. FT.	LIN. FT.	LIN. FT.	LIN. FT.	EACH	SQ. FT.
SUPERSTRUCTURE									9619
END BENT NO. 1									
BENT NO. 1		20.0	32.0	10.0					
BENT NO. 2					24.8	39.0	14.0		
END BENT NO. 2									
TOTAL	LUMP SUM	20.0	32.0	10.0	24.8	39.0	14.0	1	9619

TOTAL BILL OF MATERIAL

	GROOVING BRIDGE FLOORS	CLASS A CONCRETE	BRIDGE APPROACH SLABS	REINFORCING STEEL	SPIRAL COLUMN REINFORCING STEEL	54" PRESTRESSED CONCRETE GIRDERS	HP 12 X 53 STEEL PILES	CONCRETE BARRIER RAIL	RIP RAP CLASS II (2'-0" THICK)	GEOTEXTILE FOR DRAINAGE	ELASTOMERIC BEARINGS
	SQ. FT.	CU. YDS.	LUMP SUM	LBS.	LBS.	NO. LIN. FT.	NO. LIN. FT.	LIN. FT.	TONS	SQ. YDS.	LUMP SUM
SUPERSTRUCTURE	9555		LUMP SUM			12 1023		516.5			LUMP SUM
END BENT NO. 1		31.6		4346			6 165		77	85	
BENT NO. 1		35.1		9530	2127						
BENT NO. 2		42.6		10203	2811						
END BENT NO. 2		32.5		4522			8 280		195	215	
TOTAL	9555	141.8	LUMP SUM	28601	4938	12 1023	14 445	516.5	272	300	LUMP SUM

PROJECT NO. R-2915B
ASHE COUNTY
 STATION: 242+67.42 -L-

SHEET 3 OF 3

STATE OF NORTH CAROLINA
 DEPARTMENT OF TRANSPORTATION
 RALEIGH
GENERAL DRAWING
 BRIDGE OVER SOUTH FORK NEW RIVER ON US 221 BETWEEN SR 1103 AND SR 1169 NBL

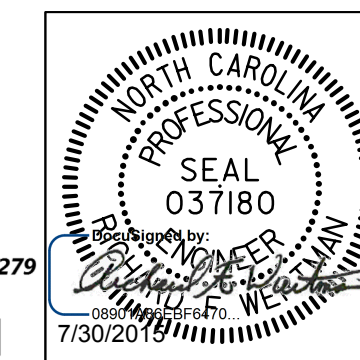

PLANS PREPARED BY:
Gannett Fleming
 Excellence Delivered As Promised
 1121 Situs Court
 Suite 170
 Raleigh, NC 27606-4279
 (919) 859-4880
 NC Lic. No. F-0270

REVISIONS						SHEET NO.
NO.	BY:	DATE:	NO.	BY:	DATE:	SHEET NO.
1			3			TOTAL SHEETS
2			4			35

DRAWN BY : T.J. KIRSCHBAUM DATE : 5/4/14
 CHECKED BY : R.F. WERTMAN DATE : 8/19/14
 DESIGN ENGINEER OF RECORD : R.F. WERTMAN DATE : 10/30/14