

PLAN OF BOX BEAM

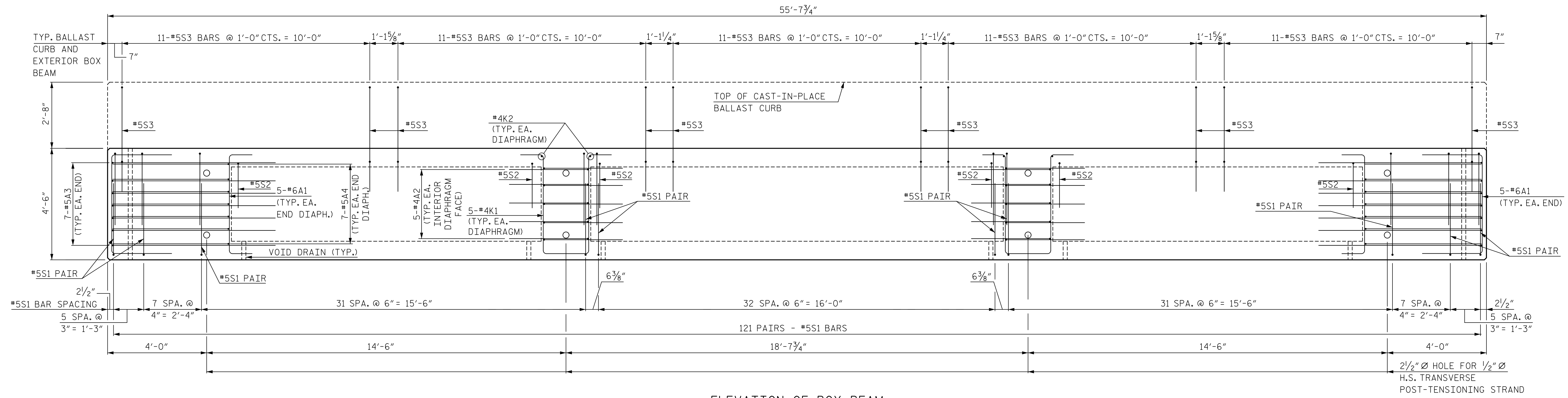

ELEVATION OF BOX BEAM

(EXTERIOR SECTION SHOWN, INTERIOR SECTION SIMILAR EXCEPT OMIT BALLAST CURB)

DESIGN LOADS

LIVE LOAD	= E80
LL DISTRIBUTION	= 44.4%
IMPACT	= 30.6%
DEAD LOAD/BOX	= 2.7 KLF

GIRDER PROPERTIES

AREA	= 1,386 IN ²
SECTION MODULUS	= 18,625 IN ³
NO. OF STRANDS	= 66
ECC. AT C.L. SPAN (FROM BOT.)	= 12.74 IN
ULTIMATE MOMENT PROVIDED	= 7,313 F+K

NOTES:

FOR DIAPHRAGM GEOMETRY AND REINFORCING DETAILS, SEE "DIAPHRAGM DETAILS" SHEET.

FOR GROUTED RECESS DETAILS FOR EXTERIOR BOX BEAM, SEE "DIAPHRAGM DETAILS" SHEET.

FOR BOX BEAM BILL OF MATERIAL AND REINFORCING SCHEDULE, SEE "4'-0\"/>

PROJECT NO. P-4900A
ROBESON COUNTY
 STATION: POS 22+07.07 -L-
 MILE POST: 0.23

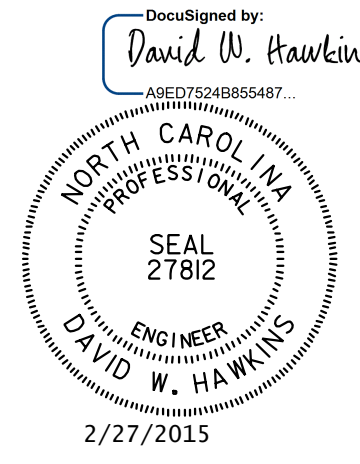
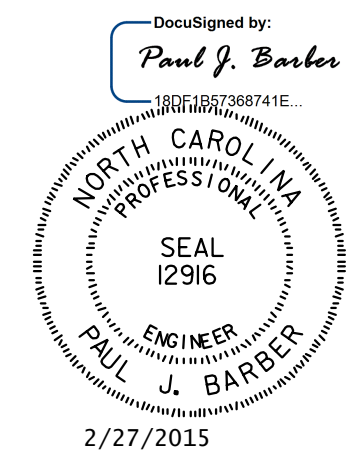

STATE OF NORTH CAROLINA
 DEPARTMENT OF TRANSPORTATION
 RALEIGH
SUPERSTRUCTURE
 4'-0" x 4'-6" BOX BEAM
 PLAN AND ELEVATION

HNTB		HNTB NORTH CAROLINA, P.C. License No. C-1554 343 E. Six Forks Rd., Suite 200, Raleigh, N.C. 27609		REVISIONS		SHEET NO.
DRAWN BY	J. BAYNE	DATE	8/14	NO.	BY:	DATE:
CHECKED BY	P. BARBER	DATE	9/14	1		
DWG. NO. 6				2		
						TOTAL SHEETS
						54