

STATE	STATE PROJECT REFERENCE NO.	SHEET NO.	TOTAL SHEETS
N.C.	P-4900A	UC-01	14

STATE OF NORTH CAROLINA
NCDOT RAIL DIVISION

ROBESON COUNTY

**LOCATION: RAIL GRADE SEPARATION OVER SR 1563 (UNION CHAPEL RD)
& GRADE CROSSING RELOCATION ON SR 1571 (JONES RD).**

TYPE OF WORK: UTILITIES CONSTRUCTION

TIP PROJECT: P-4900A

CONTRACT: C203632

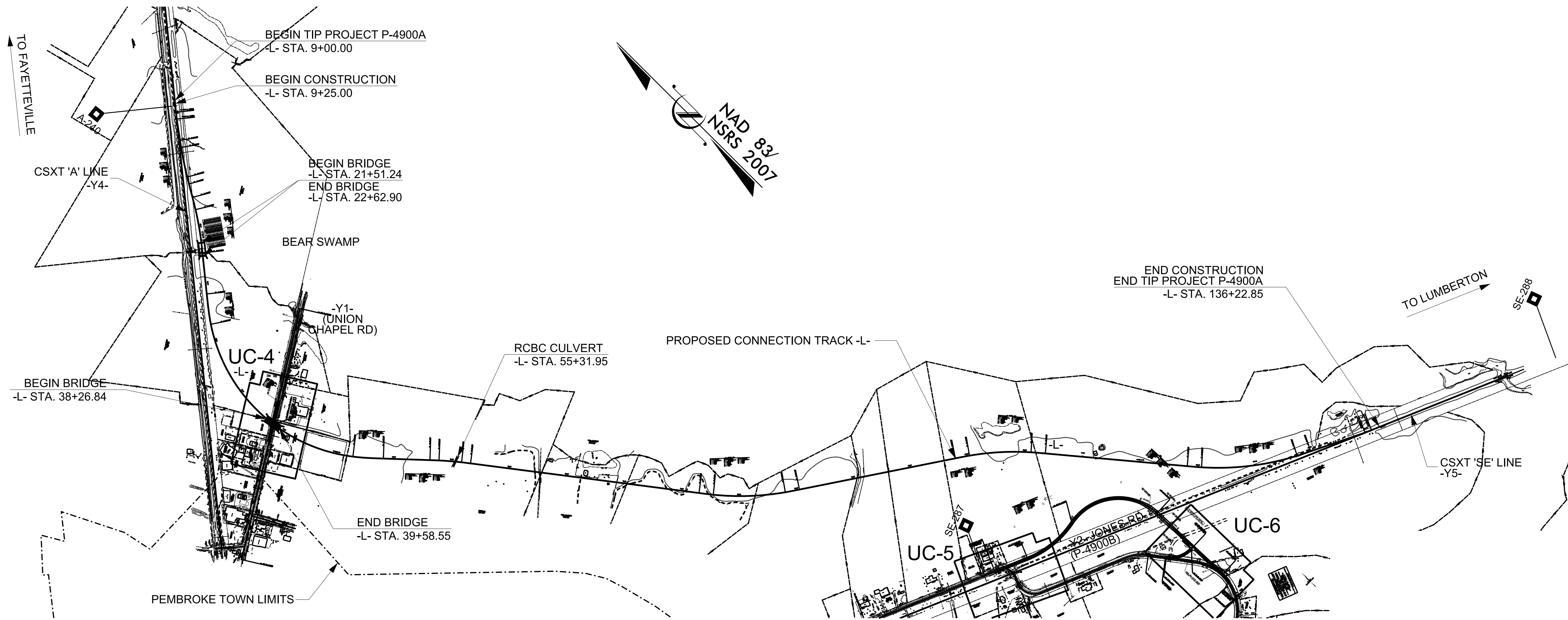
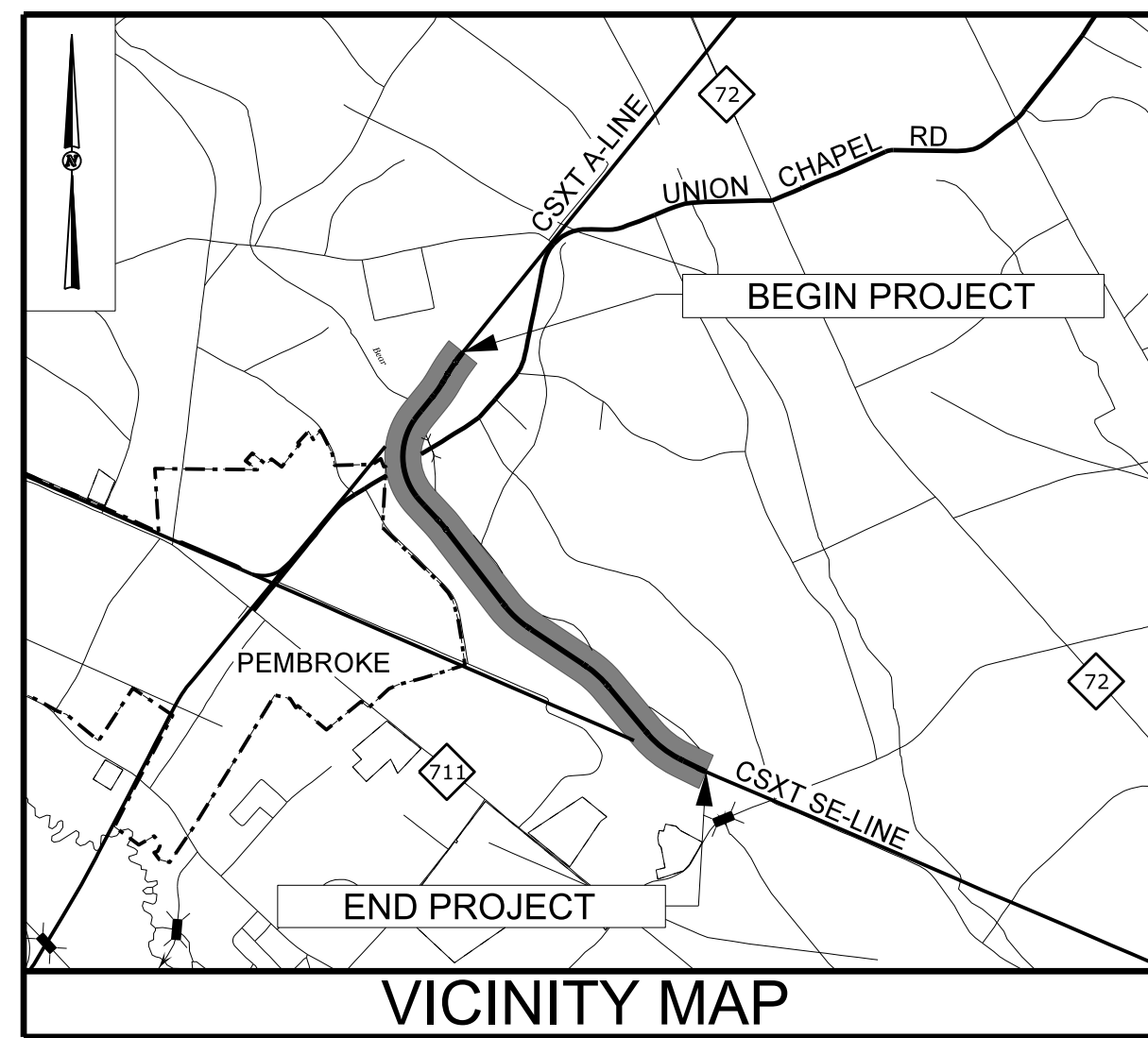

GRAPHIC SCALES

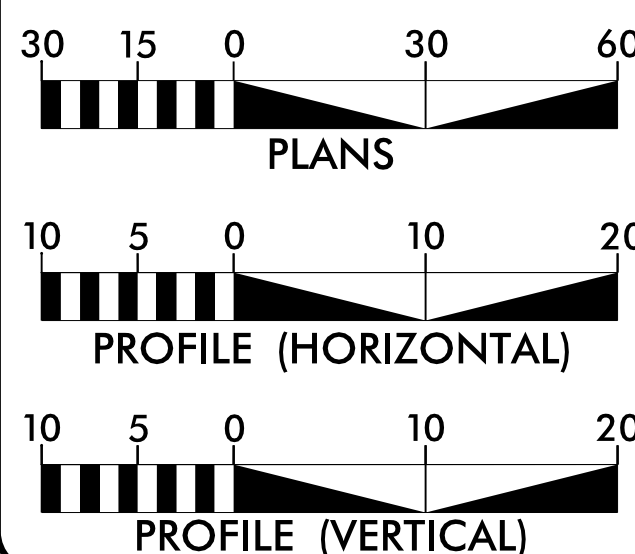

INDEX OF SHEETS

SHEET NO.	DESCRIPTION
UC-1	TITLE SHEET
UC-2	SYMBOLGY SHEET
UC-3	GENERAL NOTES SHEET
UC-3A TO UC-3D	DETAIL SHEETS
UC-4 TO UC-6	PLAN SHEETS
UC-7 TO UC-10	PROFILE SHEETS

UTILITY OWNERS ON THIS PROJECT:

- WATER - ROBESON COUNTY
TOWN OF PEMBERKE
- SEWER - TOWN OF PEMBERKE

UTILITY DESIGN ENGINEER



DocuSigned by:
Kevin Zdob 1/21/2015

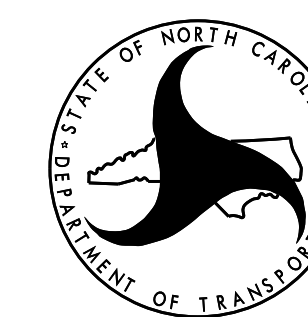

NORTH CAROLINA DEPARTMENT OF TRANSPORTATION

RAIL DIVISION

UTILITY DESIGN BY:
M A Engineering Consultants, Inc.
598 East Chatham Street Suite 137 Cary, NC 27511
Phone: 919.297.0220

Prepared for:
ENGINEERING & SAFETY BRANCH
MAIL: 1556 MAIL SERVICE CENTER RALEIGH, NC 27699-1556
DELIVERY: 860 CAPITAL BOULEVARD RALEIGH, NC 27603
PHONE: (919) 715-8803
FAX: (919) 715-8804