

BENCHMARK: #9 LAG BOLT IN UTILITY POLE (-L- STA 66+03.82, 181.72' RT, ELEV = 58.77')

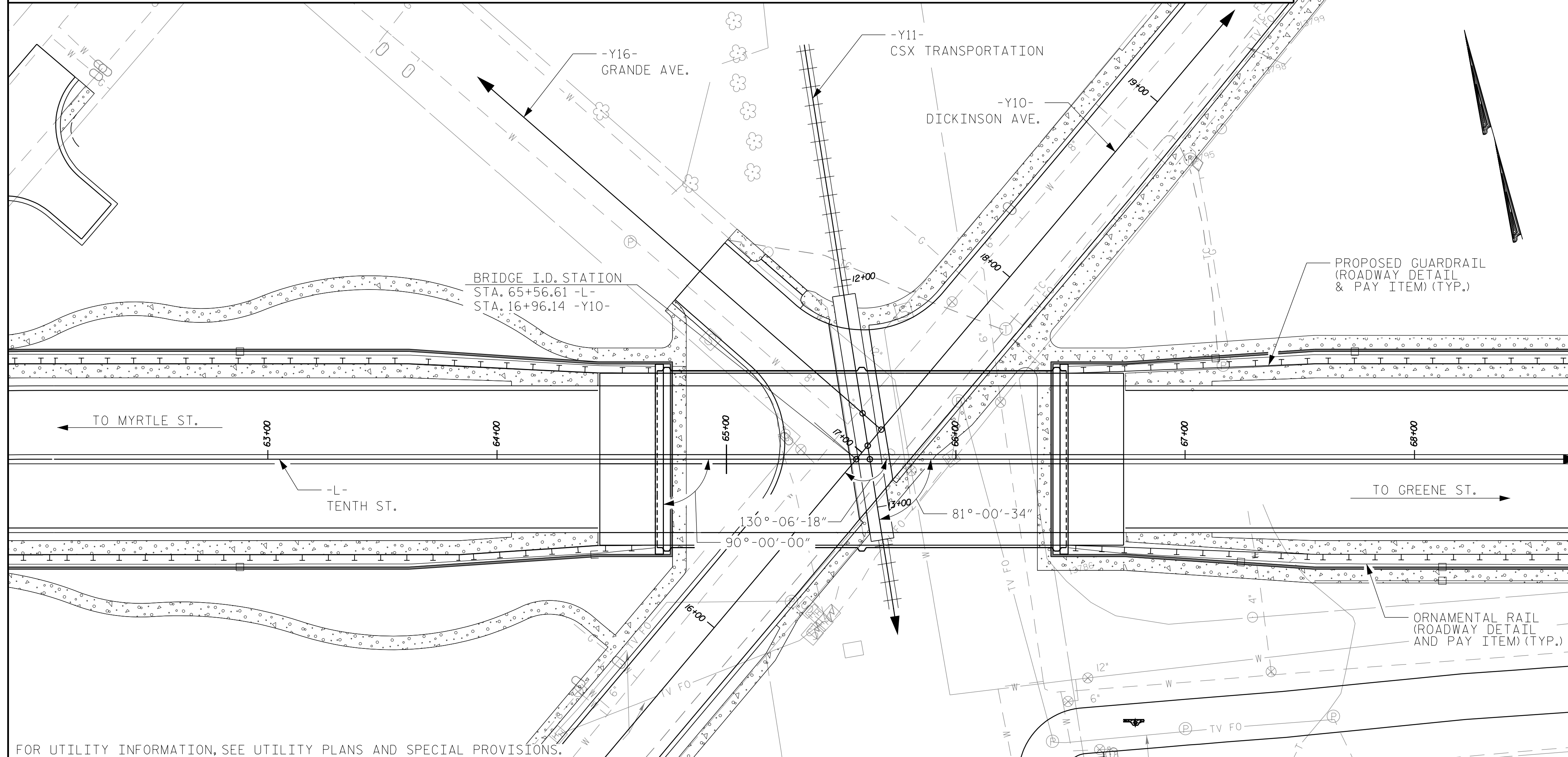

LOCATION SKETCH

NOTES

- ASSUMED LIVE LOAD = HL-93 OR ALTERNATE LOADING.
- THIS BRIDGE HAS BEEN DESIGNED IN ACCORDANCE WITH THE AASHTO LRFD BRIDGE DESIGN SPECIFICATIONS.
- THIS BRIDGE IS LOCATED IN SEISMIC ZONE 1.
- FOR OTHER DESIGN DATA AND GENERAL NOTES, SEE SHEET SN.
- FOR SUBMITTAL OF WORKING DRAWINGS, SEE SPECIAL PROVISIONS.
- FOR FALSEWORK AND FORMWORK, SEE SPECIAL PROVISIONS.
- FOR CRANE SAFETY, SEE SPECIAL PROVISIONS.
- FOR GROUT FOR STRUCTURES, SEE SPECIAL PROVISIONS.
- THE CONTRACTOR SHALL PROVIDE INDEPENDENT ASSURANCE SAMPLES OF REINFORCING STEEL AS FOLLOWS: FOR PROJECTS REQUIRING UP TO 400 TONS OF REINFORCING STEEL, ONE 30 INCH SAMPLE OF EACH SIZE BAR USED, AND FOR PROJECTS REQUIRING OVER 400 TONS OF REINFORCING STEEL, TWO 30 INCH SAMPLES OF EACH SIZE BAR USED. THE BARS FROM WHICH THE SAMPLES ARE TAKEN MUST THEN BE SPLICED WITH REPLACEMENT BARS OF THE SIZE AND LENGTH OF THE SAMPLE, PLUS A MINIMUM LAP SPLICE OF THIRTY BAR DIAMETERS. PAYMENT FOR THE SAMPLES OF REINFORCING STEEL SHALL BE CONSIDERED INCIDENTAL TO VARIOUS PAY ITEMS.
- FOR MAINTENANCE AND PROTECTION OF TRAFFIC BENEATH PROPOSED STRUCTURE, SEE SPECIAL PROVISIONS.
- REMOVABLE FORMS MAY BE USED IN LIEU OF METAL STAY-IN-PLACE FORMS IN ACCORDANCE WITH ARTICLE 420-3 OF THE STANDARD SPECIFICATIONS.
- THE RAILROAD TRACK TOP OF RAIL ELEVATIONS SHOWN ON THE PLANS ARE FROM THE BEST INFORMATION AVAILABLE. PRIOR TO BEGINNING BRIDGE CONSTRUCTION, VERIFY THE TOP OF RAIL ELEVATIONS AND REPORT ANY VARIATIONS TO THE ENGINEER. ANY PLAN REVISIONS NECESSARY TO ACHIEVE THE MINIMUM VERTICAL CLEARANCE WILL BE PROVIDED BY THE DEPARTMENT.
- NEEDLE BEAMS WILL NOT BE ALLOWED UNLESS OTHERWISE CALLED FOR ON THE PLANS OR APPROVED BY THE ENGINEER.
- ALL STRUCTURAL STEEL SHALL BE AASHTO M270 GRADE 50 AND PAINTED IN ACCORDANCE WITH SYSTEM 1 OF ARTICLE 442-8 OF THE STANDARD SPECIFICATIONS, EXCEPT THE TOPCOAT SHALL BE BLACK, FEDERAL # FS17038.
- FOR EROSION CONTROL MEASURES, SEE EROSION CONTROL PLANS.
- FOR ORNAMENTAL FENCE DETAILS, SEE "ORNAMENTAL FENCE DETAILS" SHEET AND SPECIAL PROVISIONS.
- FOR PLACING OF LOAD ON STRUCTURE MEMBERS, SEE SPECIAL PROVISIONS.

TOTAL BILL OF MATERIAL

	REINFORCED CONCRETE DECK SLAB	GROOVING BRIDGE FLOORS	CLASS A CONCRETE	BRIDGE APPROACH SLABS	REINFORCING STEEL	STRUCTURAL STEEL (APPROX.)	PDA TESTING	PP 18x0.50 GALVANIZED STEEL PILES	PIPE PILE PLATES	PILE REDRIVES	VERTICAL CONCRETE BARRIER RAIL	4" SLOPE PROTECTION	ELASTOMERIC BEARINGS	ORNAMENTAL FENCE	ELECTRICAL CONDUIT SYSTEM @ STA. 65+56.61 -L-	APPLICATION OF BRIDGE COATING	
	SQ. FT.	SQ. FT.	C. Y.	LUMP SUM	LBS.	LBS.	EACH	NO.	LIN. FT.	EACH	EACH	LIN. FT.	SQ. YDS.	LUMP SUM	LIN. FT	LUMP SUM	LUMP SUM
SUPERSTRUCTURE	13,932	12,330				661,800					356.7			356.7			
END BENT 1			36.2		5,889		1	14	1,470	14	14		27				
END BENT 2			36.2		5,889		1	14	1,330	14	14		27				
TOTAL	13,932	12,330	72.4	LUMP SUM	11,778	661,800	2	28	2,800	28	28	356.7	54	LUMP SUM	356.7	LUMP SUM	LUMP SUM

NOTE: LIGHT POLES WILL BE PROVIDED BY THE CITY OF GREENVILLE.

PROJECT NO. U-3315
PITT COUNTY
 STATION: 65+56.61 -L-
16+96.14 -Y10-
 SHEET 3 OF 3



DocuSigned by:
Cecil Narron
C198A3D845024DD

Kimley»Horn

333 Fayetteville Street, Suite 600
 Raleigh, NC 27601-1772
 Phone (919) 835-1494

NC LICENSE # F-0102

This document, together with the concepts and designs presented herein, is an integral part of the contract for the project. It is to be used for the project and not for any other purpose. Any use of this document without written authorization and approval by Kimley-Horn and Associates, Inc. shall be without liability to Kimley-Horn and Associates, Inc.
 Copyright Kimley-Horn and Associates, Inc. 2014

STATE OF NORTH CAROLINA
 DEPARTMENT OF TRANSPORTATION
 RALEIGH
 GENERAL DRAWING
 BRIDGE OVER DICKENSON
 AVE. (SR 1531) AND
 CSX TRANSPORTATION
 ON TENTH ST. CONNECTOR

REVISIONS

NO.	BY:	DATE:	NO.	BY:	DATE:
1			3		
2			4		

SHEET NO.
S-3
TOTAL SHEETS
33

DRAWN BY: J. I. KIMBLE DATE: 5/15
 CHECKED BY: J. C. WILSON DATE: 5/15
 DESIGN ENGINEER OF RECORD: C.L. NARRON DATE: 5/15