

PROJECT REFERENCE NO. U-3315	SHEET NO. PMP-5
APPROVED: <i>Jason Pace</i>	DATE: 11/5/2014
SEAL	

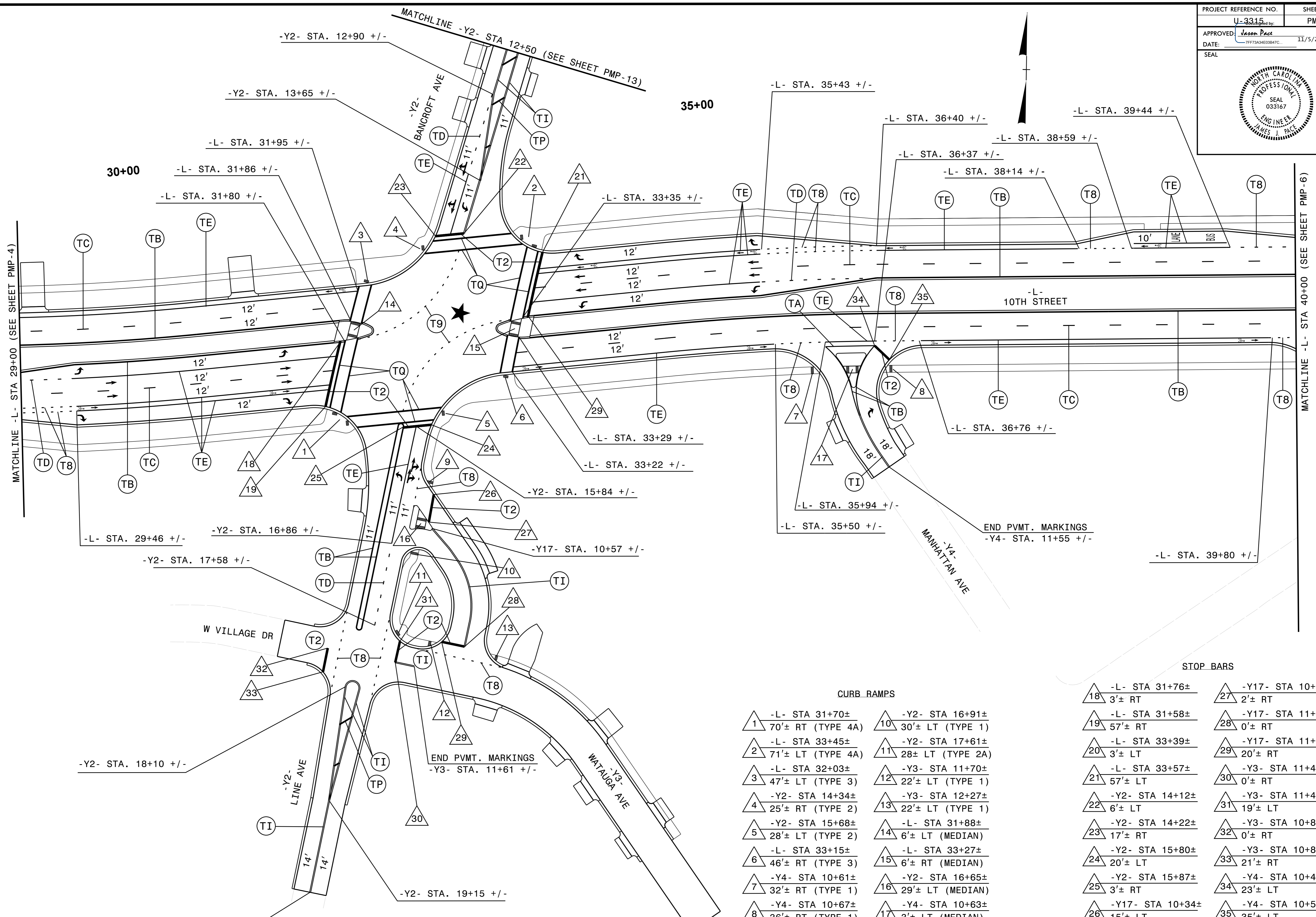

K:\RAL_Roadway\01036775 (U-3315)\Traffic\Signing\CADD\Signing Layout\Plans\Proposed\U3315_sgn_pmp05.dgn 11/5/2014

NOTES:
 1. SEE PMP-3 FOR SYMBOL AND PAVEMENT MARKING LEGEND
 2. ALL BIKE LANES MEASURE 4' UNLESS OTHERWISE NOTED.

END PVMT. MARKINGS
 -Y2- STA. 19+95 +/-

CURB RAMPS

1 -L- STA 31+70± 70'± RT (TYPE 4A)	10 -Y2- STA 16+91± 30'± LT (TYPE 1)
2 -L- STA 33+45± 71'± LT (TYPE 4A)	11 -Y2- STA 17+61± 28'± LT (TYPE 2A)
3 -L- STA 32+03± 47'± LT (TYPE 3)	12 -Y3- STA 11+70± 22'± LT (TYPE 1)
4 -Y2- STA 14+34± 25'± RT (TYPE 2)	13 -Y3- STA 12+27± 22'± LT (TYPE 1)
5 -Y2- STA 15+68± 28'± LT (TYPE 2)	14 -L- STA 31+88± 6'± LT (MEDIAN)
6 -L- STA 33+15± 46'± RT (TYPE 3)	15 -L- STA 33+27± 6'± RT (MEDIAN)
7 -Y4- STA 10+61± 32'± RT (TYPE 1)	16 -Y2- STA 16+65± 29'± LT (MEDIAN)
8 -Y4- STA 10+67± 36'± RT (TYPE 1)	17 -Y4- STA 10+63± 3'± LT (MEDIAN)
9 -Y2- STA 16+29± 30'± LT (TYPE 1)	

STOP BARS

18 -L- STA 31+76± 3'± RT	27 -Y17- STA 10+51± 2'± RT
19 -L- STA 31+58± 57'± RT	28 -Y17- STA 11+69± 0'± RT
20 -L- STA 33+39± 3'± LT	29 -Y17- STA 11+69± 20'± RT
21 -L- STA 33+57± 57'± LT	30 -Y3- STA 11+44± 0'± RT
22 -Y2- STA 14+12± 6'± LT	31 -Y3- STA 11+45± 19'± LT
23 -Y2- STA 14+22± 17'± RT	32 -Y3- STA 10+85± 0'± RT
24 -Y2- STA 15+80± 20'± LT	33 -Y3- STA 10+85± 21'± RT
25 -Y2- STA 15+87± 3'± RT	34 -Y4- STA 10+43± 23'± LT
26 -Y17- STA 10+34± 15'± LT	35 -Y4- STA 10+57± 35'± LT

PAVEMENT MARKING DETAIL
 -L- STA. 29+00 TO STA 40+00