

DETOUR ROUTE FOR FARMVILLE BLVD CLOSURE

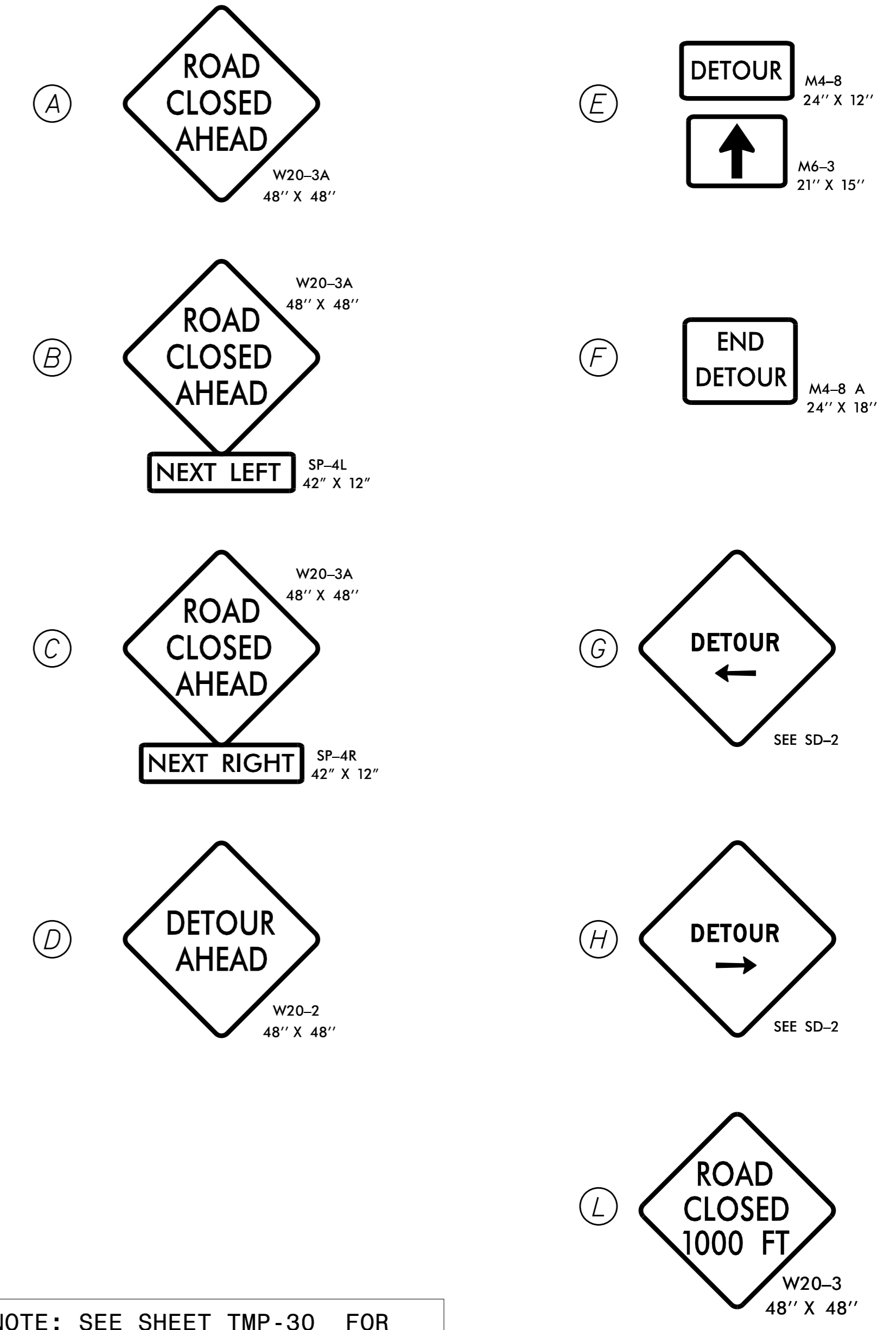

NOTE: SEE SHEET TMP-30 FOR ASSOCIATED 10TH STREET DETOUR

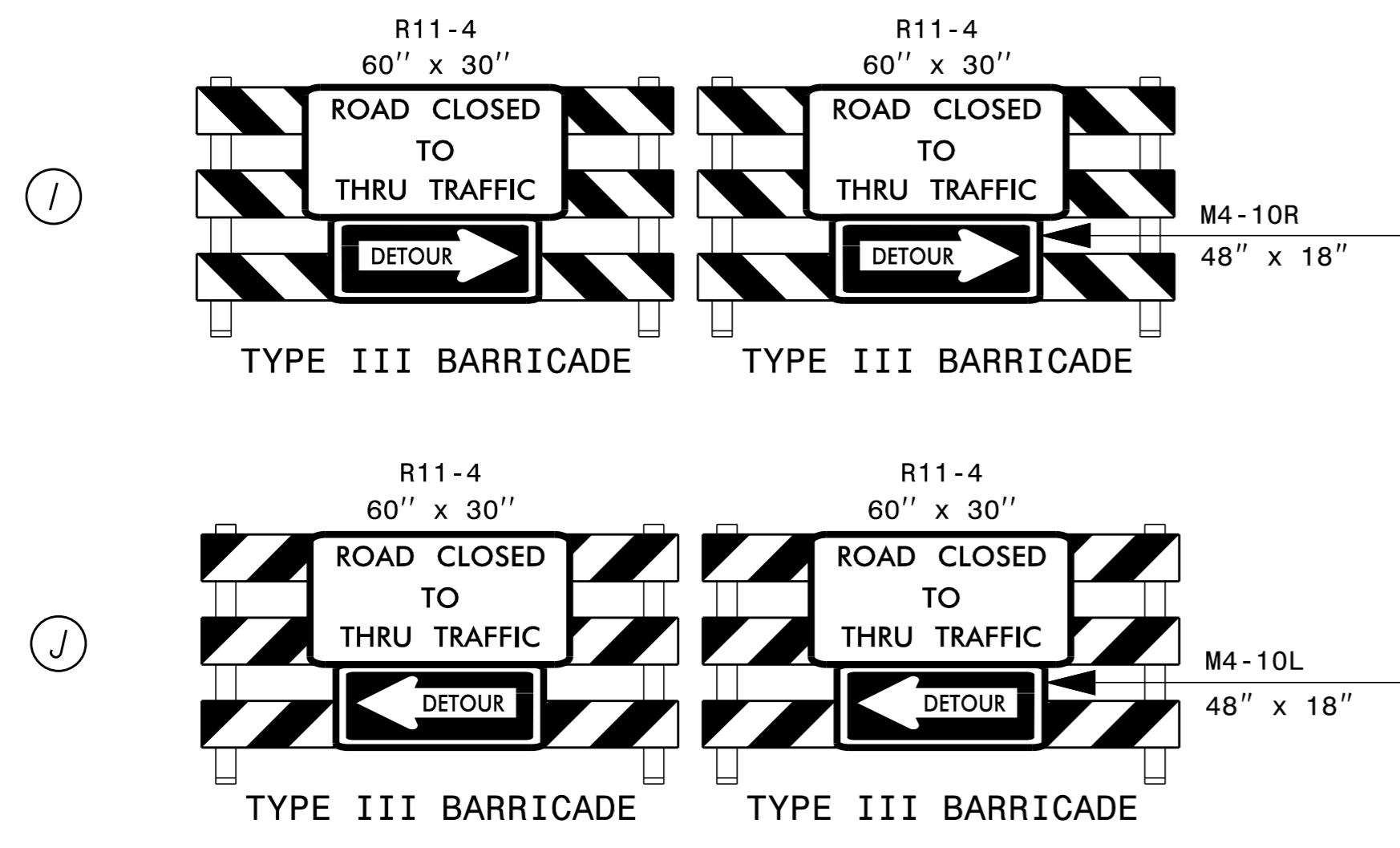

L		M	
DISPLAY MESSAGE 2 DAYS PRIOR TO CLOSURE		DISPLAY MESSAGE DURING CLOSURE	
MESSAGE NO. 1	MESSAGE NO. 2	MESSAGE NO. 1	MESSAGE NO. 2
ROAD WILL BE CLOSED	FRI - SUN NIGHTS 9PM - 6AM	ROAD CLOSED AHEAD	FOLLOW DETOUR ROUTE
CHANGEABLE MESSAGE SIGN		CHANGEABLE MESSAGE SIGN	

PLACE CMS 1/2 MILE IN ADVANCE OF CLOSURE

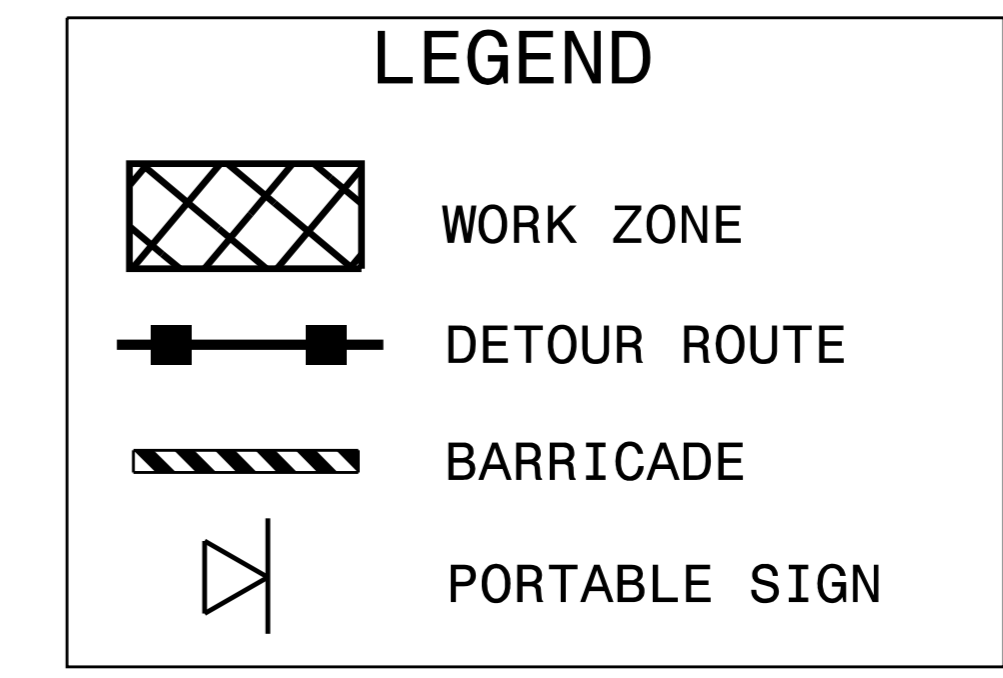
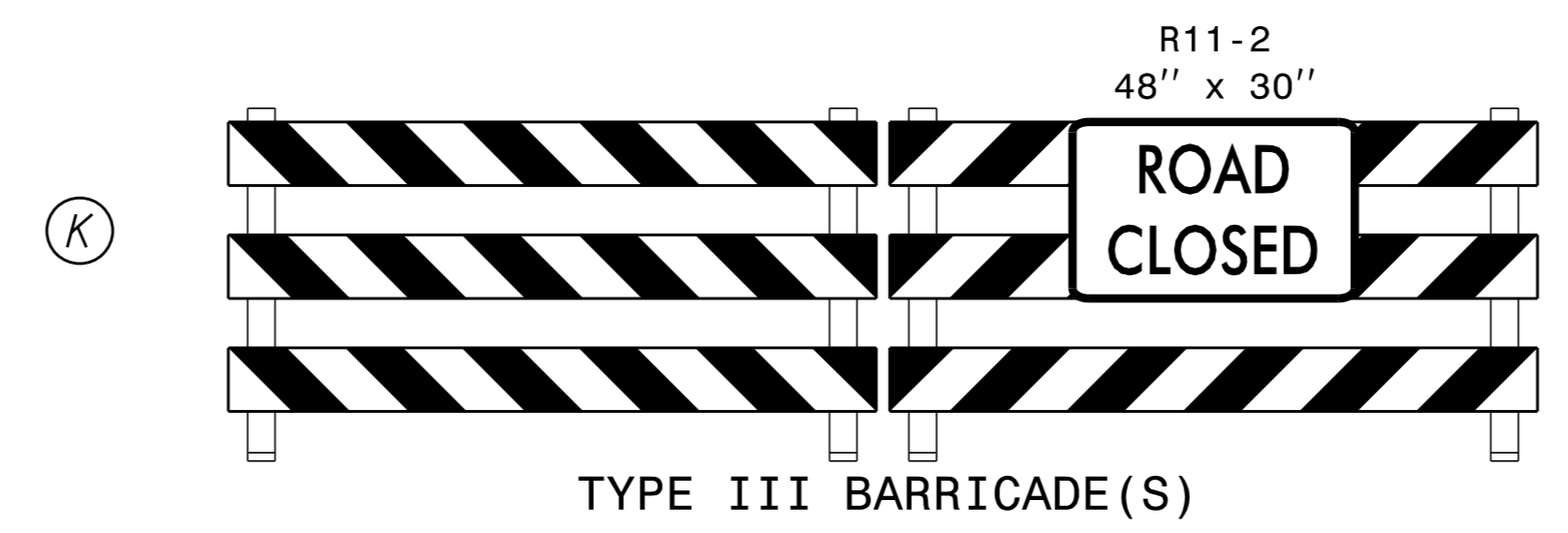

Kimley»Horn

APPROVED: Jason Pace DATE: 12/31/2014

TRAFFIC CONTROL DETOUR SHEET

K:\RAL_Roadway\01036175_U-3315\NT\TrafficControl\CP\Sheets\U3315_TMP_psh39.dgn 11/4/2014