

DETOUR ROUTE FOR DICKINSON AVENUE AND GRANDE AVENUE CLOSURE

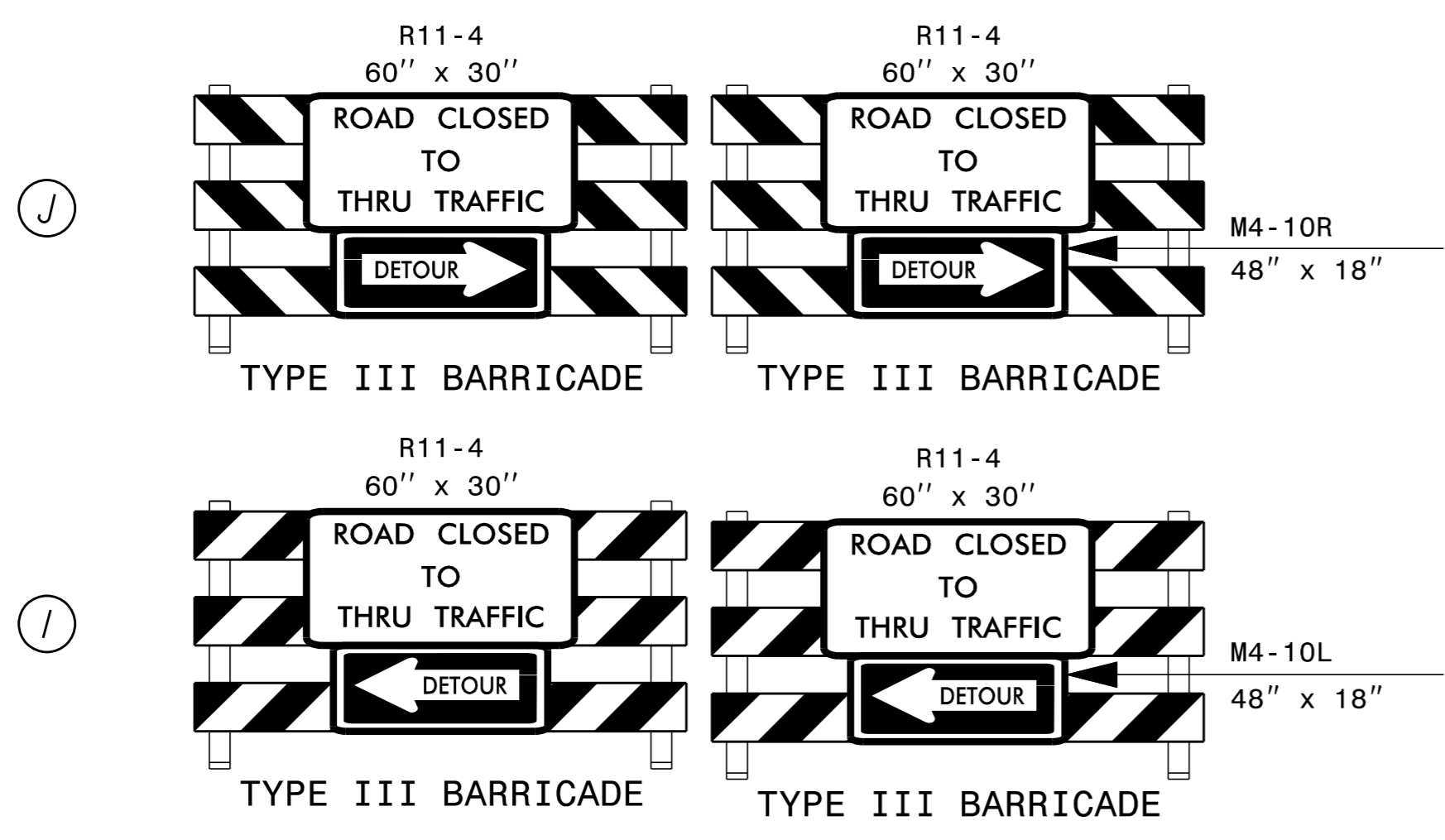

NOTE: SEE SHEET TMP-30 FOR ASSOCIATED 10TH STREET DETOUR

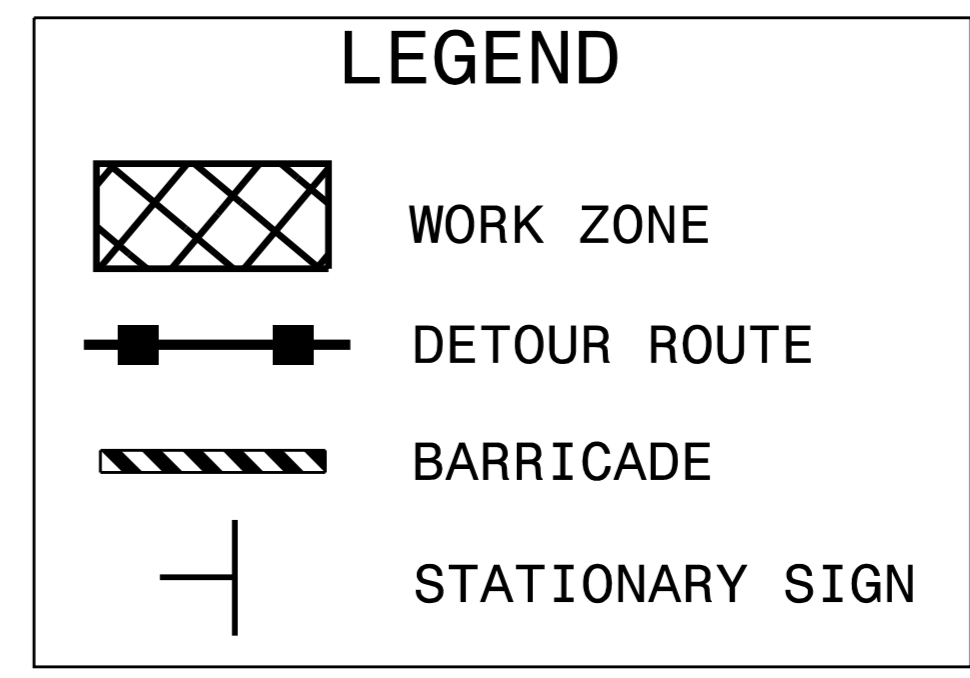
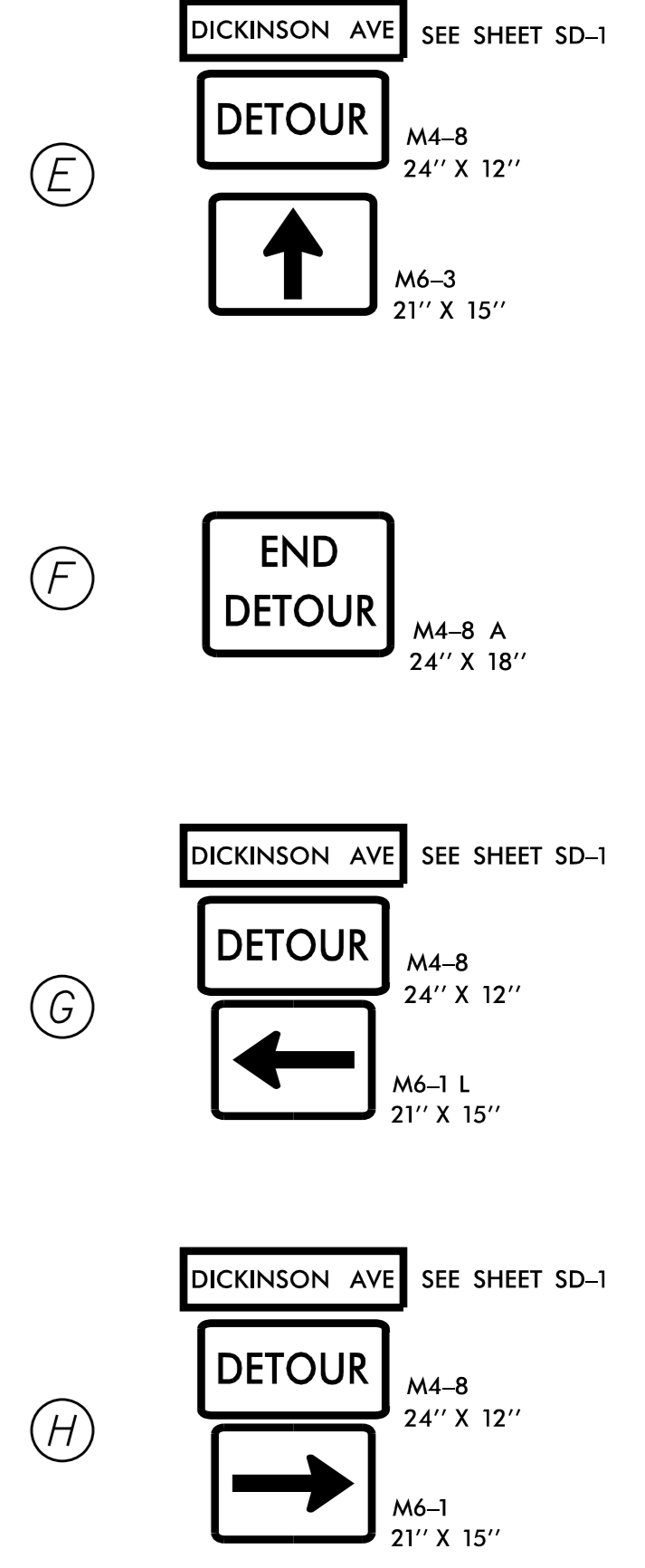
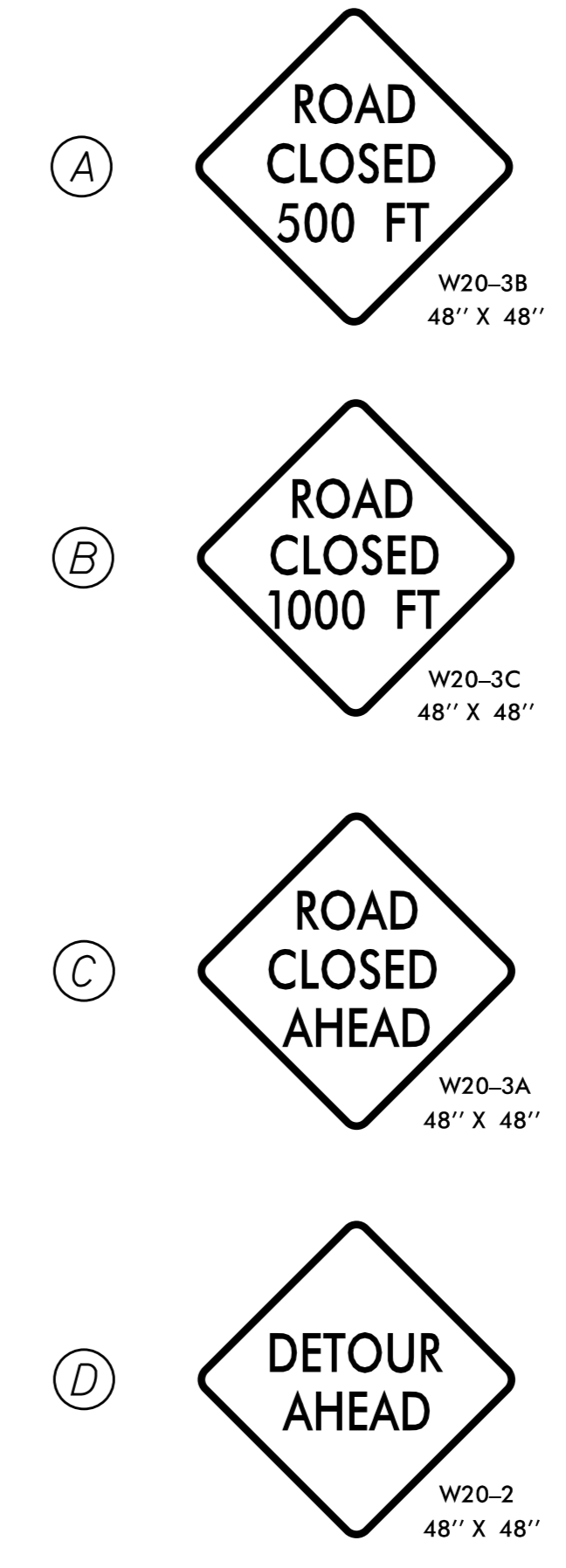
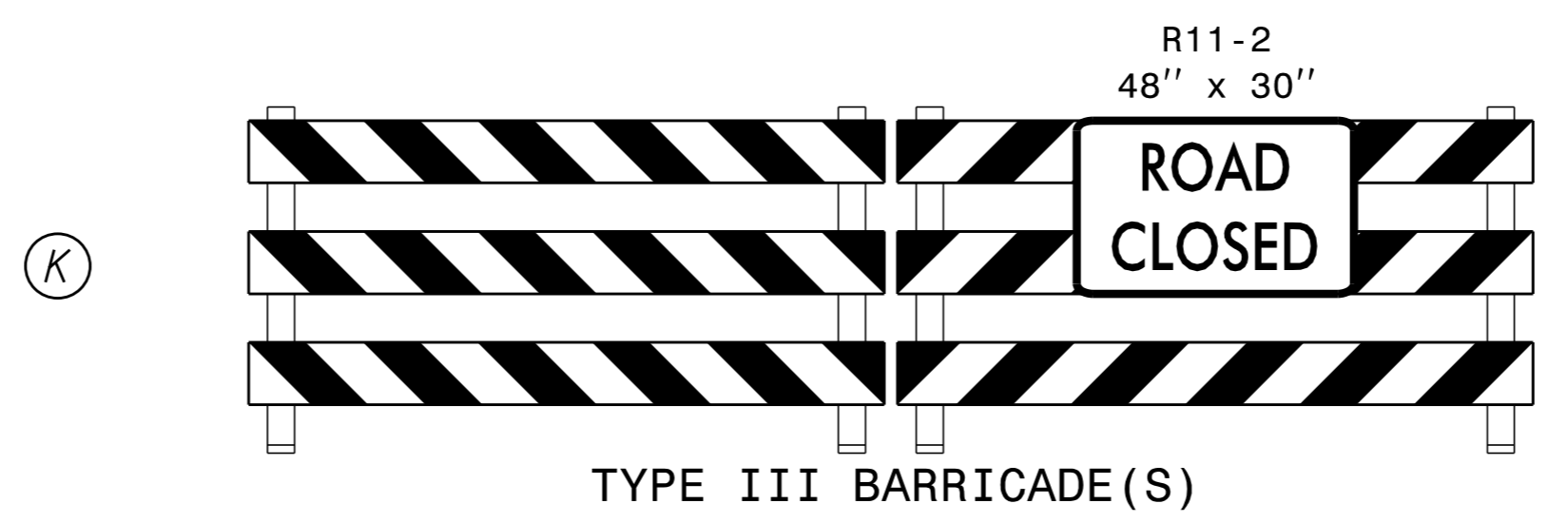

K:\RAL_Roadway\01036175 (U-3315)NT\TrafficControl\CP\Sheets\U3315_TMP_psh31.dgn 11/4/2014

APPROVED: Jason Pace DATE: 11/3/2014
NORTH CAROLINA PROFESSIONAL SEAL 033167 ENGINEER JAMES J. PACE

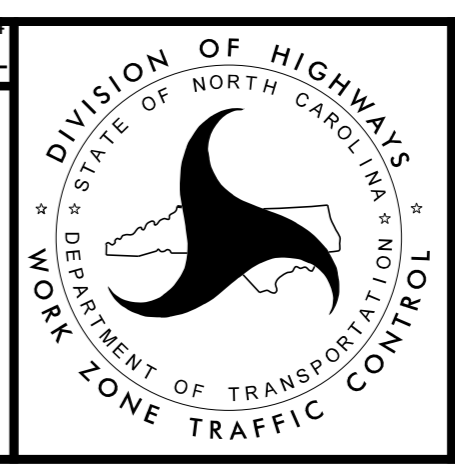

Kimley»Horn

TRAFFIC CONTROL DETOUR SHEET