

### DETOUR ROUTE FOR 10TH STREET CLOSURE

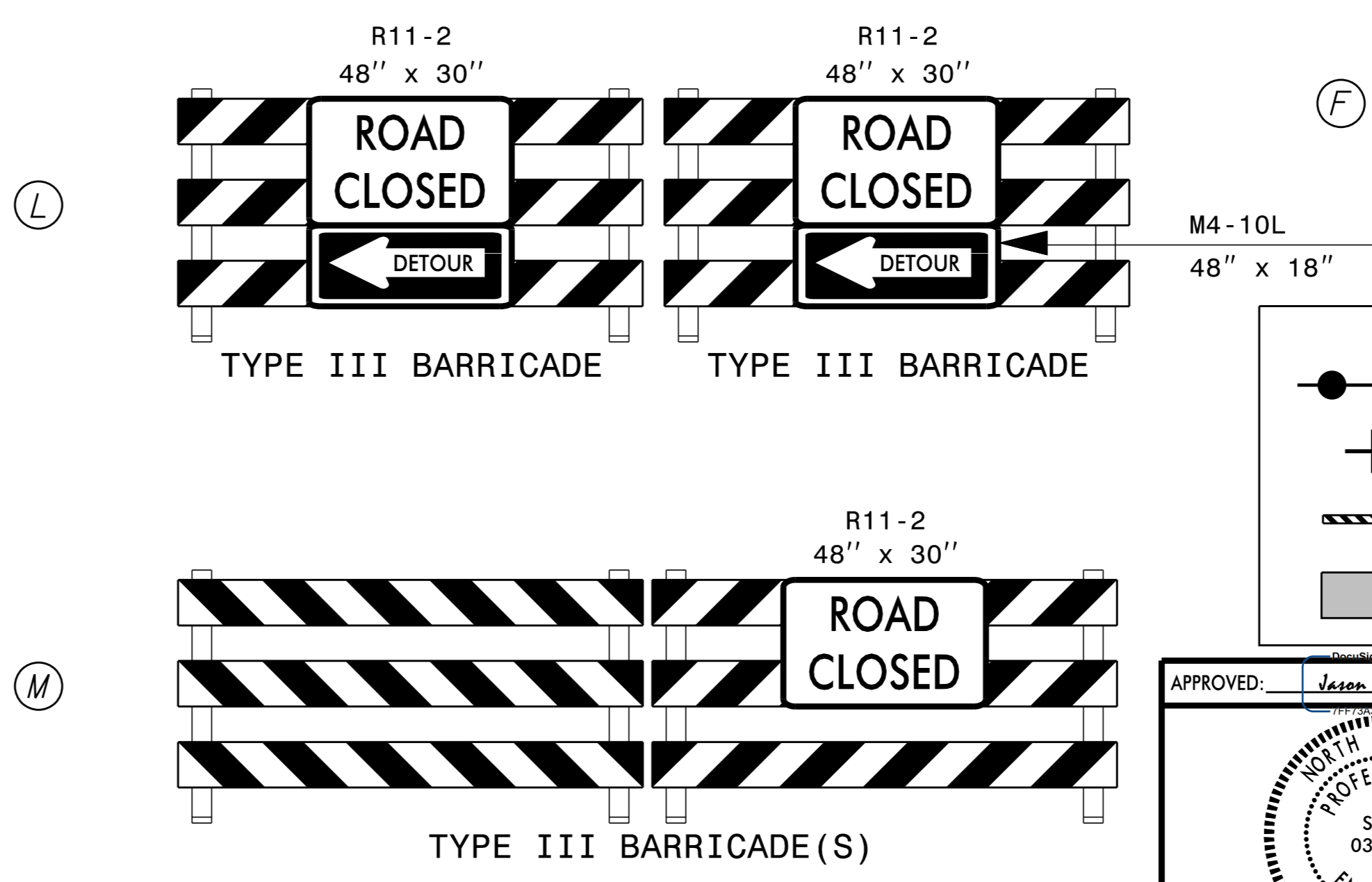
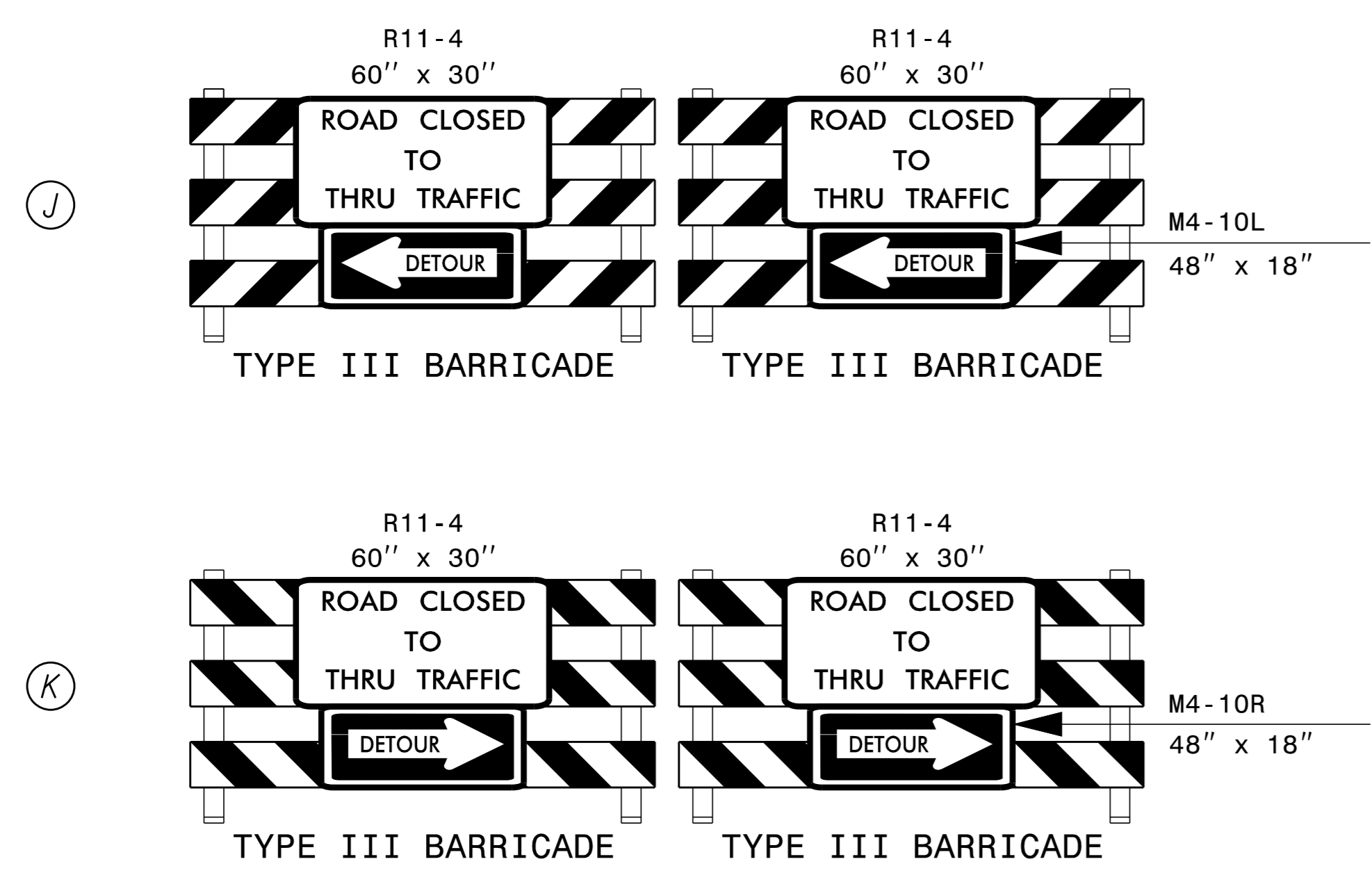
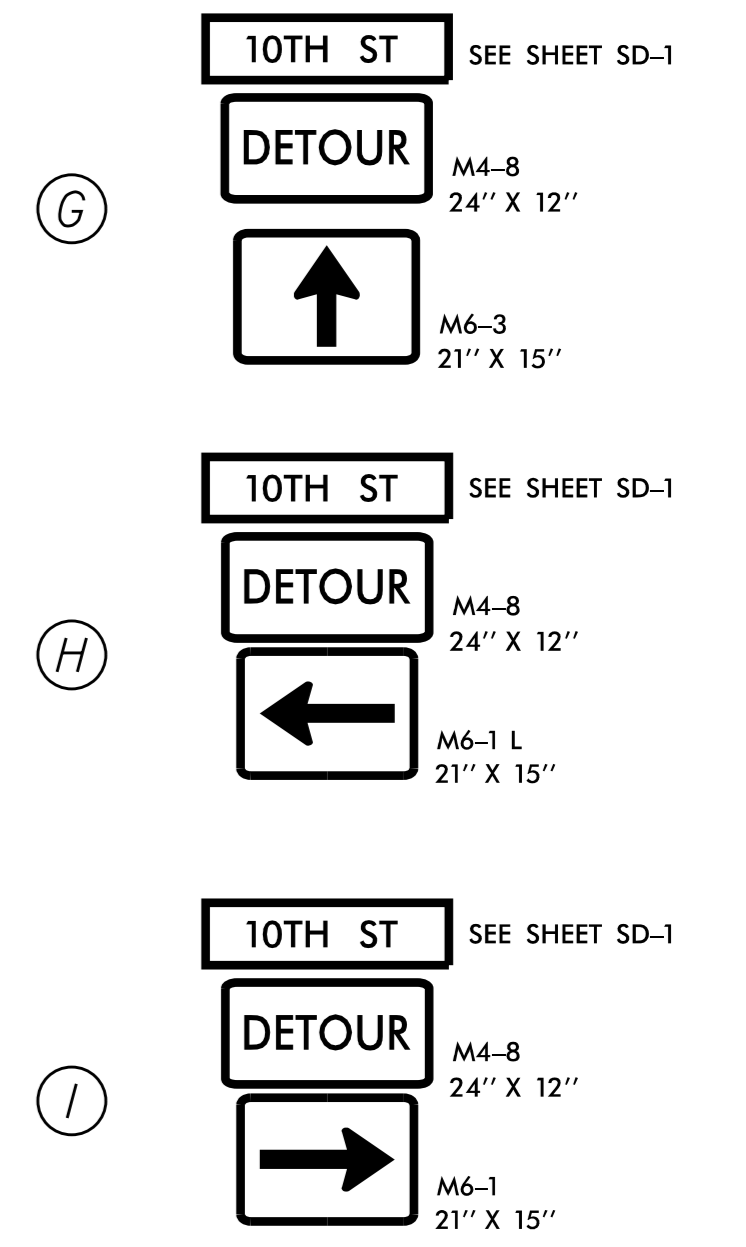
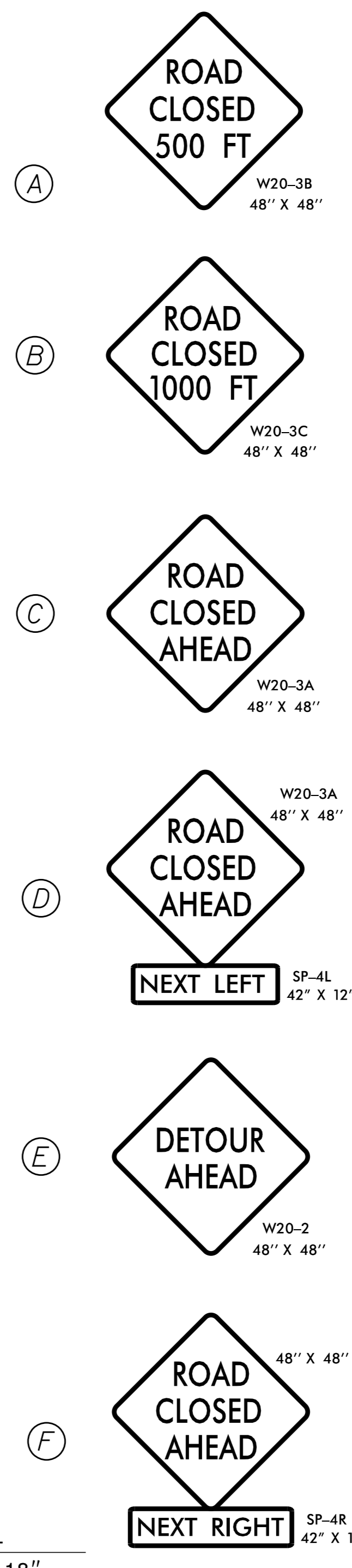

**LEGEND**

- DETOUR ROUTE
- + STATIONARY SIGN
- ▨ BARRICADE
- WORK ZONE

APPROVED: Jason Pace DATE: 2/17/2014

DIVISION OF HIGHWAYS  
STATE OF NORTH CAROLINA  
DEPARTMENT OF TRANSPORTATION  
WORK ZONE TRAFFIC CONTROL

# Kimley»Horn

## TRAFFIC CONTROL DETOUR SHEET

K:\RAL\_Roadway\01036175\_U-3315\NT\TrafficControl\CP\Sheets\U3315\_TMP\_psh30.dgn 11/4/2014