

REFER TO SHEET TMP-30 FOR TENTH ST DETOUR ROUTE
REFER TO SHEET TMP-44 FOR PEDESTRIAN DETOUR ROUTES

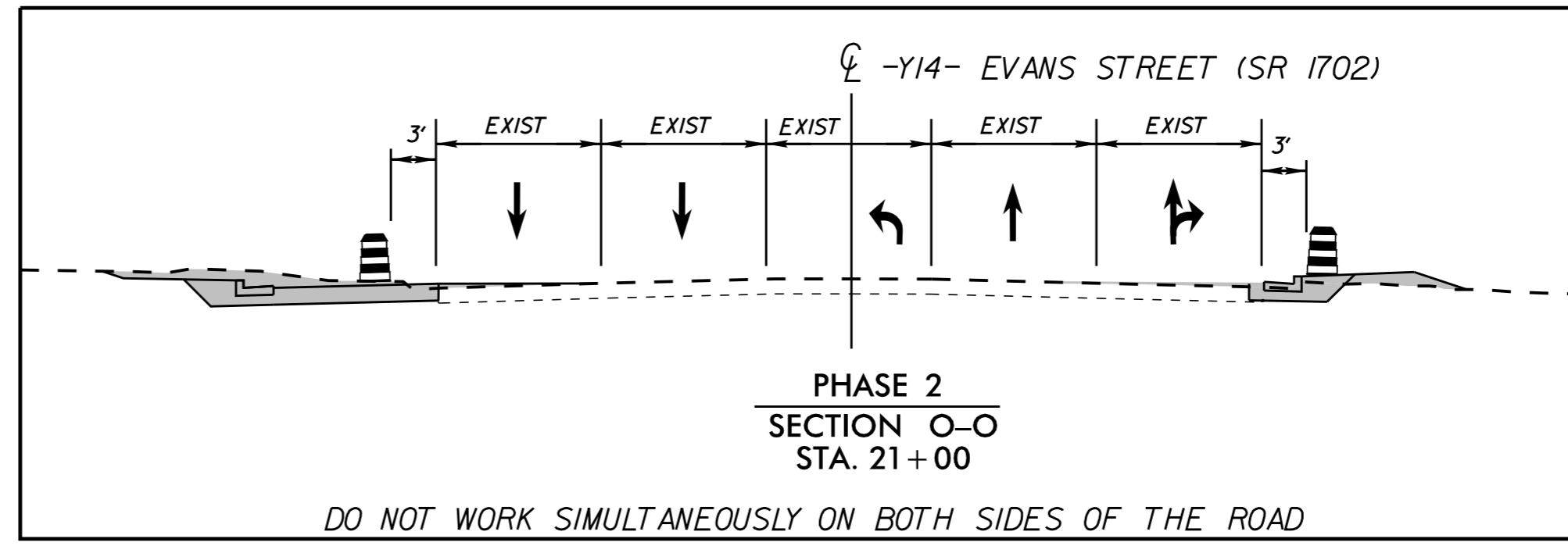
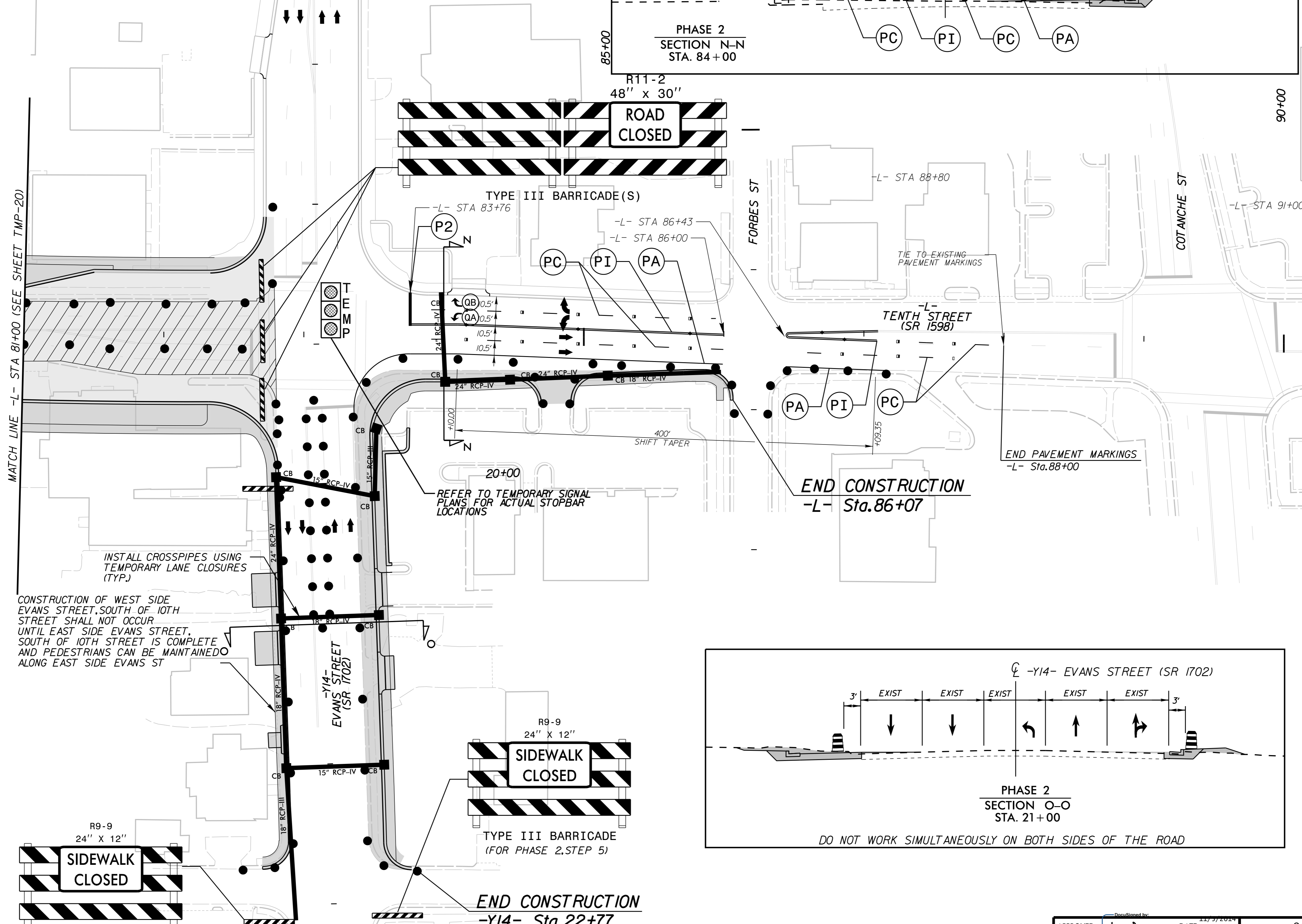
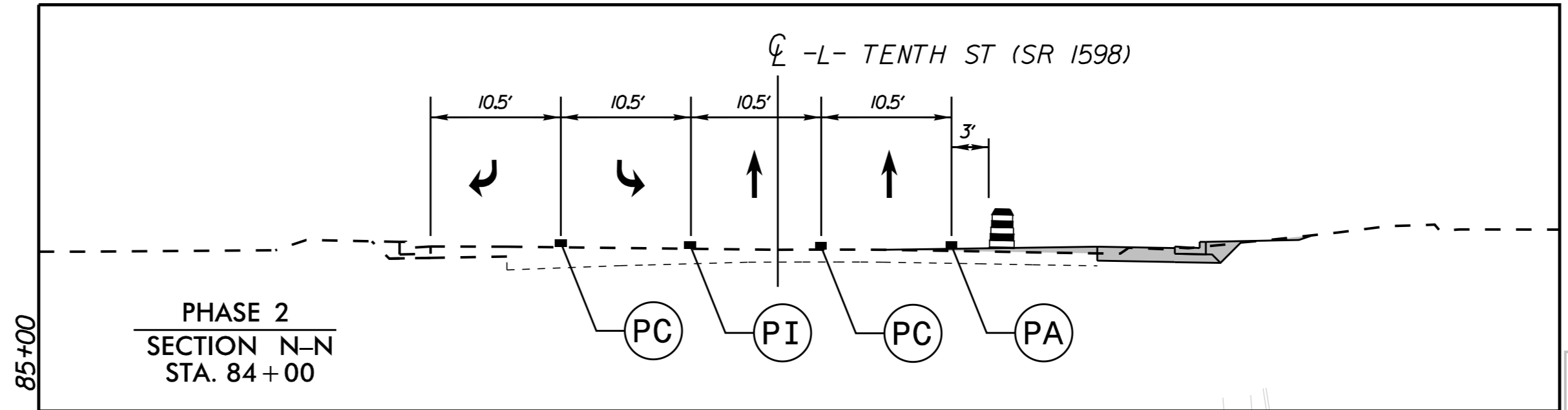

INSTALL CROSSPIPES USING TEMPORARY LANE CLOSURES (TYP.)

CONSTRUCTION OF WEST SIDE EVANS STREET, SOUTH OF 10TH STREET SHALL NOT OCCUR UNTIL EAST SIDE EVANS STREET, SOUTH OF 10TH STREET IS COMPLETE AND PEDESTRIANS CAN BE MAINTAINED ALONG EAST SIDE EVANS ST

REFER TO TEMPORARY SIGNAL PLANS FOR ACTUAL STOPBAR LOCATIONS

END CONSTRUCTION -L- Sta. 86+07

END CONSTRUCTION -Y14- Sta. 22+77

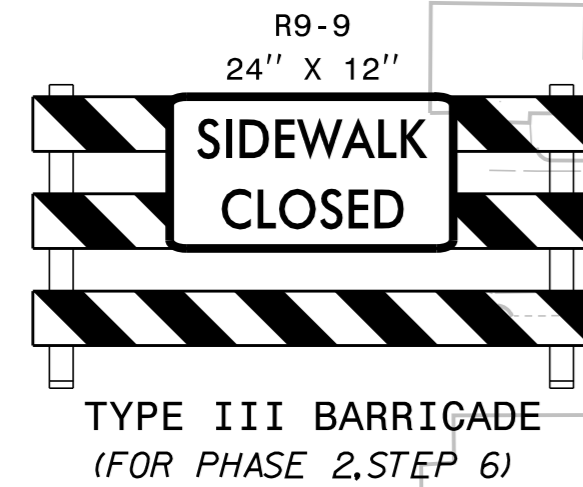

- WORK AREA
- PAVEMENT REMOVAL
- WEDGING

APPROVED: *Jason Pace* DATE: 11/17/2014

NORTH CAROLINA PROFESSIONAL SEAL 033167 ENGINEER JAMES J. PACE

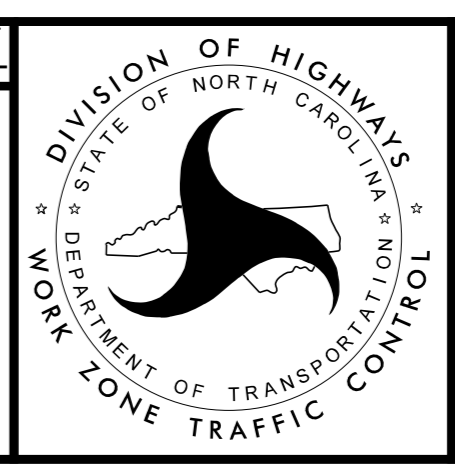

Kimley»Horn

TRAFFIC CONTROL PHASE 2

K:\RAL_Roadway\01036175 (U-3315)\TrafficControl\CP\Sheet\3315_TMP_pst12.dgn 11/4/2014

NAD 83 N/SRS 2007