

Interim Action Completion Report Stadium Cleaners

DSCA ID No. 74-0008
205 East Tenth Street
Greenville, Pitt County

North Carolina Dry-Cleaning Solvent Cleanup Act Program

H&H Job No. DS0-71D
August 29, 2013



SMARTER ENVIRONMENTAL SOLUTIONS

#C-1269 Engineering
#-245 Geology

**Interim Action Completion Report
Stadium Cleaners
Greenville, Pitt County
H&H Job No. DS0-71D**

Table of Contents

<u>Section</u>	<u>Page No.</u>
1.0 Introduction and Background	1
2.0 Interim Action Activities.....	3
2.1 Soil Excavation	3
2.2 Excavation Confirmation Sampling	4
2.2.1 Sampling Procedures.....	5
2.2.2 Sampling Results.....	5
2.3 Excavation Soil Management and Off-Site Disposal.....	6
2.4 Excavation Backfilling and Site Restoration.....	6
3.0 Summary	7

List of Tables

Table 1	Analytical Data for Concrete
Table 2	Analytical Data for Confirmation Soil Samples
Table 3	Analytical Data for Waste Characterization Soil Samples

List of Figures

Figure 1	Site Location Map
Figure 2A	Pre-Excavation Surface Soil (0-3 ft bgs) PCE Concentration Map
Figure 2B	Pre-Excavation Subsurface Soil (0-3 ft bgs) PCE Concentration Map
Figure 3	Excavation Confirmation Sample Location Map

List of Appendices

- Appendix A GSI Model Documentation
- Appendix B Laboratory Analytical Data Reports
- Appendix C Non-Hazardous Waste Disposal Manifests and Weight Tickets
- Appendix D Photographs

1.0 Introduction and Background

On behalf of the North Carolina Department of Environment and Natural Resources (DENR) Dry-Cleaning Solvent Cleanup Act (DSCA) Program, Hart & Hickman, PC (H&H) is submitting this Interim Action Completion Report to document soil excavation activities conducted at the Stadium Cleaners site (DSCA ID No. 74-0008) located at 205 East Tenth Street in Greenville, Pitt County, North Carolina. A site location map is included as Figure 1.

The site property is currently owned by East Carolina University (ECU). Dry-cleaning operations were previously conducted on the site property using the dry-cleaning solvent tetrachloroethylene (PCE). The dry-cleaning facility building was demolished in May 2013. Asphalt paving and the former dry-cleaning facility building's concrete pad were in place at the site prior to the start of the excavation activities. ECU plans to utilize the property as green space in the near term with long-term plans to construct student housing.

PCE and its degradation compounds (e.g., trichloroethylene and cis-1,2-dichloroethylene) have been detected in soil and groundwater at the site as a result of historical releases from dry-cleaning operations. Previous assessment activities identified PCE in site soil at concentrations up to 47.5 mg/kg. Because of the site redevelopment activities, the DSCA Program decided to perform an interim action to address source area soil impacts.

To evaluate a clean-up goal for on-site soil impacts, H&H used the Groundwater Services, Inc. (GSI) RBCA Tool Kit for Chemical Releases model. The primary exposure pathway of concern is future residential indoor inhalation. H&H modeled this pathway as soil leaching to groundwater with 0 ft to the point of exposure and set the groundwater target level as the vapor intrusion, residential, groundwater to indoor air screening level (11.6 µg/L for PCE). For the model inputs, H&H used site-specific data for the soil source zone dimensions, the infiltration rate (45% of annual rainfall), and the pH. The remaining model inputs were all default values. The GSI model calculated a site-specific target level (SSTL) for soil of 0.035 mg/kg. A copy of the model documentation is provided in Appendix A.

Interim action activities were conducted at the site in May and June 2013 to remove unsaturated zone soil (0 to 8 ft below ground surface – bgs) impacted with concentrations of PCE above the calculated SSTL of 0.035 mg/kg. The interim action activities consisted of:

- Removal and disposal of the portion of concrete underlying the former dry-cleaning operations area
- Excavation of PCE-impacted unsaturated zone soil
- Collection of confirmation samples from the base and sidewalls of the excavation area
- Placement of excavated soil in roll-off boxes
- “Contained-out” characterization sampling of the roll-off boxes
- Disposal of the excavated soil
- Backfilling and site restoration

This report documents the interim action activities and provides records related to remediation waste management and analytical results.

2.0 Interim Action Activities

The selected interim action approach to address source area PCE soil impacts at the Stadium Cleaners site was soil excavation. The interim action plan was based on soil analytical data from previous assessment work shown in Figures 2A and 2B. Prior to implementation, concrete pre-characterization samples were collected in December 2012. Excavation, waste disposal, and site restoration were completed in May and June 2013. The following sections further describe the interim action activities.

2.1 Concrete Characterization and Removal

Due to historical dry-cleaning activities, the concrete floor slab beneath the former dry-cleaning operations area had the potential to be impacted with PCE. To allow for quick removal and disposal of the concrete during the interim action field work, H&H pre-characterized the concrete and obtained pre-approval for disposal of the concrete.

On December 13, 2012, H&H collected four samples of the concrete from the dry-cleaning operations area (SB-9 concrete through SB-12 concrete). The sample locations correspond to soil samples SB-9 through SB-12 shown on Figures 2A and 2B. The samples were placed in laboratory-supplied containers, placed on ice in an insulated cooler, and submitted under chain-of-custody (COC) to Test America of Nashville, Tennessee for analysis of volatile organic compounds (VOCs) by EPA Method 8260B.

Low levels of PCE were detected in three of the four concrete samples at concentrations ranging from 0.00632 to 0.0155 mg/kg. Low concentrations of acetone, toluene, and 1,2-dichloroethane were also detected in the samples. The sample results are summarized in Table 1, and the analytical laboratory report is provided in Appendix B.

On April 30, 2013, H&H provided the concrete sample results to Ms. Robin Proctor with the DENR Hazardous Waste Section. Ms. Proctor approved disposal of the concrete in a Subtitle D landfill via e-mail on May 7, 2013.

The concrete was excavated from the site in May 2013. The majority of the concrete was loaded into three dump trucks on May 20 and 21, 2013 and transported directly to East Carolina Environmental landfill in Aulander, NC for disposal. Additional concrete was placed in a roll-off container, which was transported to East Carolina Environmental landfill on June 4, 2013. A total of 49.31 tons of concrete was removed and disposed off-site. The waste manifests and weight tickets are provided in Appendix C.

2.2 Soil Excavation

Soil with PCE concentrations greater than the calculated SSTL of 0.035 mg/kg was targeted for excavation. The lateral extents of the excavation area are shown in Figure 3. Prior to commencing excavation activities, H&H notified the North Carolina One-Call Center and retained a private utility locator to mark subsurface utility lines in the vicinity of the planned excavation area.

H&H contracted EVO Corporation of Winston-Salem, NC (EVO) to perform the soil excavation, backfill, and off-site disposal activities. Soil excavation was conducted using a track hoe and back hoe to excavate soils and transport the soils into roll-off containers. In accordance with the DENR Hazardous Waste Section (HWS) “Contained-In” Policy for Soil Contaminated with Listed Hazardous Waste (Contained-In Policy), soil in each of the roll-off containers was sampled to determine the proper off-site management option for the soil. Excavation soil management and off-site disposal activities are detailed in Section 2.3.

Photographs taken during the excavation activities are included in Appendix D.

2.3 Excavation Confirmation Sampling

Sidewall and base samples were collected from the excavation to document VOC concentrations remaining in place and confirm that soils impacted at concentrations exceeding the SSTL had

been removed. The excavation confirmation sampling procedures and results are discussed below.

2.2.1 Sampling Procedures

H&H collected at least one confirmation sample from each sidewall of the excavation and multiple samples from sidewalls that exceeded approximately 20 ft in length. Sidewall samples SW-1 through SW-12 were collected at a depth of 4 ft bgs. H&H also collected five base samples. Base samples BS-1, BS-2, and BS-5 were collected at 4 ft bgs and base samples BS-3 and BS-4 were collected at 8 ft bgs. H&H screened the sidewalls and base of the excavation for VOC concentrations using a photoionization detector (PID), and no elevated PID readings were detected.

Prior to collecting a confirmation sample for laboratory analysis, H&H personnel scraped approximately three inches of soil away from the face of the sidewall in the sample location. A soil sample was then collected from the newly-exposed soil, placed directly into a laboratory-supplied sample container, and submitted to Con-Test Analytical Laboratory (Con-Test), a North Carolina-certified laboratory, for analysis of VOCs by EPA Method 8260.

2.2.2 Sampling Results

The analytical results for the excavation sidewall samples and base samples were compared to the SSTL to confirm that PCE-impacted soil was adequately removed by the excavation activities. There were no analytes detected above the SSTL in any of the sidewall or base samples. Detectable concentrations of PCE, below the SSTL, were detected in four of the twelve sidewall samples and one of the five base samples at concentrations ranging from 0.0017 to 0.0034 mg/kg. Methylene chloride, a likely laboratory contaminant, was detected in four of the twelve sidewall samples and three of the five base samples at concentrations below the DSCA Tier 1 risk-based screening level (RBSL) of 0.060 mg/Kg. The excavation sidewall and base sample analytical results are summarized in Table 2, and the sample locations are shown in Figure 3. Laboratory analytical reports are included in Appendix B.

2.3 Excavation Soil Management and Off-Site Disposal

Excavated soils were placed into roll-off boxes that were staged on the adjacent property, and samples were collected from each roll-off for waste characterization purposes in accordance with DENR's Contained-In Policy. Two samples were collected from each roll-off box and analyzed by Con-Test for total VOCs by EPA Method 8260. The analytical results for the roll-off samples indicated concentrations below the NC "Contained-Out" levels for disposal in a municipal solid waste landfill (MSWLF). The laboratory analytical reports for the roll-off samples are included in Appendix B. The roll-off sample analytical results are summarized in Table 3.

Based on the sampling results, the excavated soil was managed as non-hazardous waste. The roll-off boxes were transported from the site to East Carolina Environmental landfill located in Aulander, NC for disposal. A total of 363.60 tons of non-hazardous waste was transported to the facility. The non-hazardous waste disposal manifests are included in Appendix C.

2.4 Excavation Backfilling and Site Restoration

Following completion of the excavation activities and sidewall confirmation sampling, the excavated area was backfilled with imported soil. Prior to backfilling, H&H collected one sample of the backfill material (BF-1). The sample was submitted to Con-Test for analysis of VOCs by EPA Method 8260. There were no dry-cleaning related constituents detected in the backfill sample. There was an estimated (J flagged) concentration of methylene chloride (0.019 mg/Kg) detected in the sample. Methylene chloride is a common laboratory contaminant. The laboratory analytical report is included in Appendix B.

The backfill soil was placed in the excavation and compacted using excavation and transport equipment in approximate 1-ft lifts. Photographs of the backfilling activities are included in Appendix D.

3.0 Summary

An interim action was conducted at Stadium Cleaners (DSCA ID No. 74-0008) to remove unsaturated zone soil impacted with PCE at concentrations above the calculated SSTL of 0.035 mg/kg. Interim action soil excavation and backfill/site restoration activities were conducted at the site between May 20, 2013 and May 31, 2013. Removal of the roll-off boxes from the site was completed on June 3, 2013. The following is a summary of the interim action activities:

- A total of 49.31 tons of PCE-impacted concrete and 363.60 tons of PCE-impacted soil were removed and disposed of off-site. Excavation sidewall and base sample results confirm that soils with PCE concentrations above the SSTL were successfully removed from the site.
- Excavated soils were managed in accordance with DENR's Contained-In Policy. Analytical results of soil samples collected from the roll-off boxes were below the NC "Contained-Out" levels for disposal in a MSWLF indicating the soil could be managed as non-hazardous waste. The soil was transported to the East Carolina Environmental Landfill located at 1922 Republican Road, Aulander, NC for disposal.
- The excavation area was backfilled after completion of soil excavation activities.

The interim action activities have successfully removed PCE-impacted soil from the site.

Table 1
Analytical Data for Concrete Samples
Stadium Cleaners DSCA ID No. 74-0008

Sample ID	Sampling Date	Acetone	1,2-Dichloroethane	Tetrachloroethylene	Toluene
		mg/Kg			
SB-9 Concrete	05/21/13	0.0868	<0.00172	0.00632	0.00172
SB-10 Concrete	05/21/13	<0.0443	0.00261	<0.00177	<0.00177
SB-11 Concrete	05/21/13	<0.0426	0.00238	0.00869	<0.00170
SB-12 Concrete	05/21/13	0.0548	0.00203	0.0155	<0.00170

Note:

1. Only constituents detected in at least one sample are shown in table.

Table 2
Analytical Data for Confirmation Soil Samples
Stadium Cleaners DSCA ID No. 74-0008

Sample ID	Sample Depth (ft bgs)	Sampling Date	Tetrachloroethylene	Methylene Chloride
			mg/Kg	
SW-1	4	05/21/13	<0.0025	<0.0025
SW-2	4	05/21/13	<0.0026	<0.0026
SW-3	4	05/21/13	<0.0019	<0.019
SW-4	4	05/21/13	0.0017 J	<0.0022
SW-5	4	05/24/13	<0.0022	<0.0022
SW-6	4	05/24/13	<0.0021	<0.0021
SW-7	4	05/24/13	0.0026	<0.0020
SW-8	4	05/24/13	<0.0018	<0.0018
SW-9	4	05/24/13	0.0021	0.0081 J
SW-10	4	05/28/13	0.0024	0.010 J
SW-11	4	05/28/13	<0.0019	0.0091 J
SW-12	4	05/28/13	<0.0020	0.0091 J
BS-1	4	05/24/13	<0.0021	<0.0021
BS-2	4	05/24/13	<0.0020	<0.0020
BS-3	8	05/28/13	0.0034	0.015 J
BS-4	8	05/28/13	<0.0028	0.017 J
BS-5	4	05/28/13	<0.0021	0.0096 J

Notes:

1. J = detected but below the Reporting Limit (lowest calibration standard); therefore, result is an estimated concentration.
2. Only constituents detected in at least one sample are shown in table.

Table 3
Analytical Data for Waste Characterization Soil Samples
Stadium Cleaners DSCA ID No. 74-0008

Sample ID	Sample Date	cis-1,2-Dichloroethene	Trichloroethene	Tetrachloroethene	Methylene Chloride	1,2-Dichloroethane
		(mg/kg)				
"Contained-Out" Levels for Disposal in MSWLF		140	10	14	9	10
R-18303-RT-1	5/20/2013	<0.0016	<0.0016	0.0091	0.0087J	<0.0016
R-18303-RT-2	5/20/2013	<0.0017	<0.0017	<0.0017	0.0073J	<0.0017
R-18303-RT-1-52413	5/24/2013	<0.0017	<0.0017	0.027	<0.017	<0.0017
R-18303-RT-2-52413	5/24/2013	<0.0023	<0.0023	0.026	<0.023	<0.0023
EVO-906-1	5/20/2013	<0.0015	<0.0015	<0.0015	0.0068J	<0.0015
EVO-906-2	5/20/2013	<0.0018	<0.0018	0.011	0.0089J	<0.0018
EVO-906-1-52413	5/24/2013	<0.0018	<0.0018	0.0068	<0.0036	<0.0018
EVO-906-2-52413	5/24/2013	<0.0019	<0.0019	0.041	<0.019	<0.0019
EVO-910-1	5/20/2013	<0.0021	<0.0021	0.031	0.010J	<0.0021
EVO-910-2	5/20/2013	<0.0022	<0.0022	0.0041	0.0090J	<0.0022
EVO-910-1-52413	5/24/2013	<0.0020	<0.0020	0.013	<0.020	<0.0020
EVO-910-2-52413	5/24/2013	<0.0024	<0.0024	0.020	0.011J	<0.0024
RB-37386-1	5/20/2013	<0.0022	<0.0022	0.0049	0.0099J	<0.0022
RB-37386-2	5/20/2013	0.0010J	<0.0021	0.052	<0.021	<0.0021
RB-37386-1-52413	5/24/2013	<0.0021	<0.0021	0.016	<0.021	<0.0021
RB-37386-2-52413	5/24/2013	<0.0022	<0.0022	0.024	<0.022	<0.0022
EVO-904-1	5/20/2013	<0.0021	<0.0021	0.0064	<0.021	<0.0021
EVO-904-2	5/20/2013	<0.0022	<0.0022	0.028	<0.022	<0.0022
EVO-904-1-52413	5/24/2013	<0.0024	<0.0024	0.031	<0.024	<0.0024
EVO-904-2-52413	5/24/2013	<0.0021	<0.0021	0.028	<0.021	<0.0021
EVO-907-1	5/20/2013	<0.0018	<0.0018	0.027	<0.018	<0.0018
EVO-907-2	5/20/2013	<0.0021	<0.0021	0.029	0.0078J	<0.0021
EVO-907-1-52413	5/24/2013	<0.0024	<0.0024	0.055	<0.024	<0.0024
EVO-907-2-52413	5/24/2013	0.0013J	0.0014J	0.084	<0.020	<0.0020
RB-37390-RT-1	5/20/2013	<0.0022	<0.0022	0.024	0.0081J	<0.0022
RB-37390-RT-2	5/20/2013	<0.0020	<0.0020	0.013	0.0075J	<0.0020
RB-37390-RT-1-52413	5/24/2013	0.0051	0.0018J	0.086	<0.020	0.0051
RB-37390-RT-2-52413	5/24/2013	<0.0021	<0.0021	0.076	<0.021	<0.0021
RB-37391-RT-1	5/20/2013	<0.0014	<0.0014	0.013	0.0052J	<0.0014
RB-37391-RT-2	5/20/2013	<0.0020	<0.0020	0.020	0.0074J	<0.0020
RB-37391-RT-1-52413	5/24/2013	<0.0020	<0.0020	0.026	0.010J	<0.0020
RB-37391-RT-2-52413	5/24/2013	<0.0020	<0.0020	0.047	<0.020	<0.0020
EVO-903-1	5/21/2013	<0.0021	<0.0021	0.030	<0.021	<0.0021
EVO-903-2	5/21/2013	<0.0022	<0.0022	0.075	<0.022	<0.0022

Table 3
Analytical Data for Waste Characterization Soil Samples
Stadium Cleaners DSCA ID No. 74-0008

Sample ID	Sample Date	cis-1,2-Dichloroethene	Trichloroethene	Tetrachloroethene	Methylene Chloride	1,2-Dichloroethane
		(mg/kg)				
"Contained-Out" Levels for Disposal in MSWLF		140	10	14	9	10
EVO-903-1-52813	5/28/2013	<0.0024	<0.0024	0.023	0.011J	<0.0024
EVO-903-2-52813	5/28/2013	<0.0023	<0.0023	0.026	0.011J	<0.0023
BKRU-025917-1	5/21/2013	<0.0021	<0.0021	0.022	<0.021	<0.0021
BKRU-025917-2	5/21/2013	<0.0026	<0.0026	0.030	<0.026	<0.0026
BKRU-025917-1	5/28/2013	<0.0027	<0.0027	0.014	0.011J	<0.0027
BKRU-025917-2	5/28/2013	<0.0023	<0.0023	0.022	0.0092J	<0.0023
BKRU-026512-1	5/21/2013	<0.0023	<0.0023	0.010	<0.023	<0.0023
BKRU-026512-2	5/21/2013	<0.0026	<0.0026	0.054	<0.026	<0.0026
BKRU-026512-1-52813	5/28/2013	<0.0023	<0.0023	0.0057	0.014J	<0.0023
BKRU-026512-2-52813	5/28/2013	<0.0021	<0.0021	0.0025	0.012J	<0.0021
RB-37389-RT-1	5/21/2013	<0.0021	<0.0021	0.094	<0.021	<0.0021
RB-37389-RT-2	5/21/2013	0.0021J	0.0021J	0.14	<0.029	<0.0029
RB-37389-RT-1-52813	5/28/2013	<0.0024	<0.0024	0.030	0.012J	<0.0024
RB-37389-RT-2-52813	5/28/2013	<0.0025	<0.0025	0.024	0.020J	<0.0025
BKRU-026526-1	5/21/2013	<0.0024	<0.0024	0.10	<0.024	<0.0024
BKRU-026526-2	5/21/2013	0.0033	0.0029	0.20	<0.028	0.0029
RB-37387-RT-1	5/21/2013	<0.0028	<0.0028	0.047	<0.028	<0.0028
RB-37387-RT-2	5/21/2013	<0.0026	<0.0026	0.031	<0.026	<0.0026
RB-12665-RT-1	5/21/2013	0.0032	0.0017J	0.092	<0.022	0.0026
RB-12665-RT-2	5/21/2013	<0.0022	<0.0022	0.049	<0.022	<0.0022
RB-12665-RT-1-52813	5/28/2013	<0.0025	<0.0025	0.0050	0.014J	<0.0025
RB-12665-RT-2-52813	5/28/2013	<0.0027	<0.0027	0.0031	0.016J	<0.0027
EVO-908-1	5/21/2013	0.0013	0.0012J	0.078	<0.022	<0.0022
EVO-908-2	5/21/2013	<0.0026	<0.0026	0.065	<0.026	<0.0026

Notes:

1. J = detected but below the Reporting Limit (lowest calibration standard); therefore, result is an estimated concentration.
2. Only constituents detected in at least one sample are shown in table.

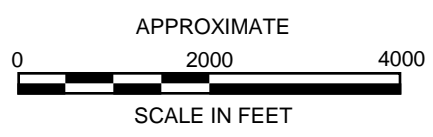
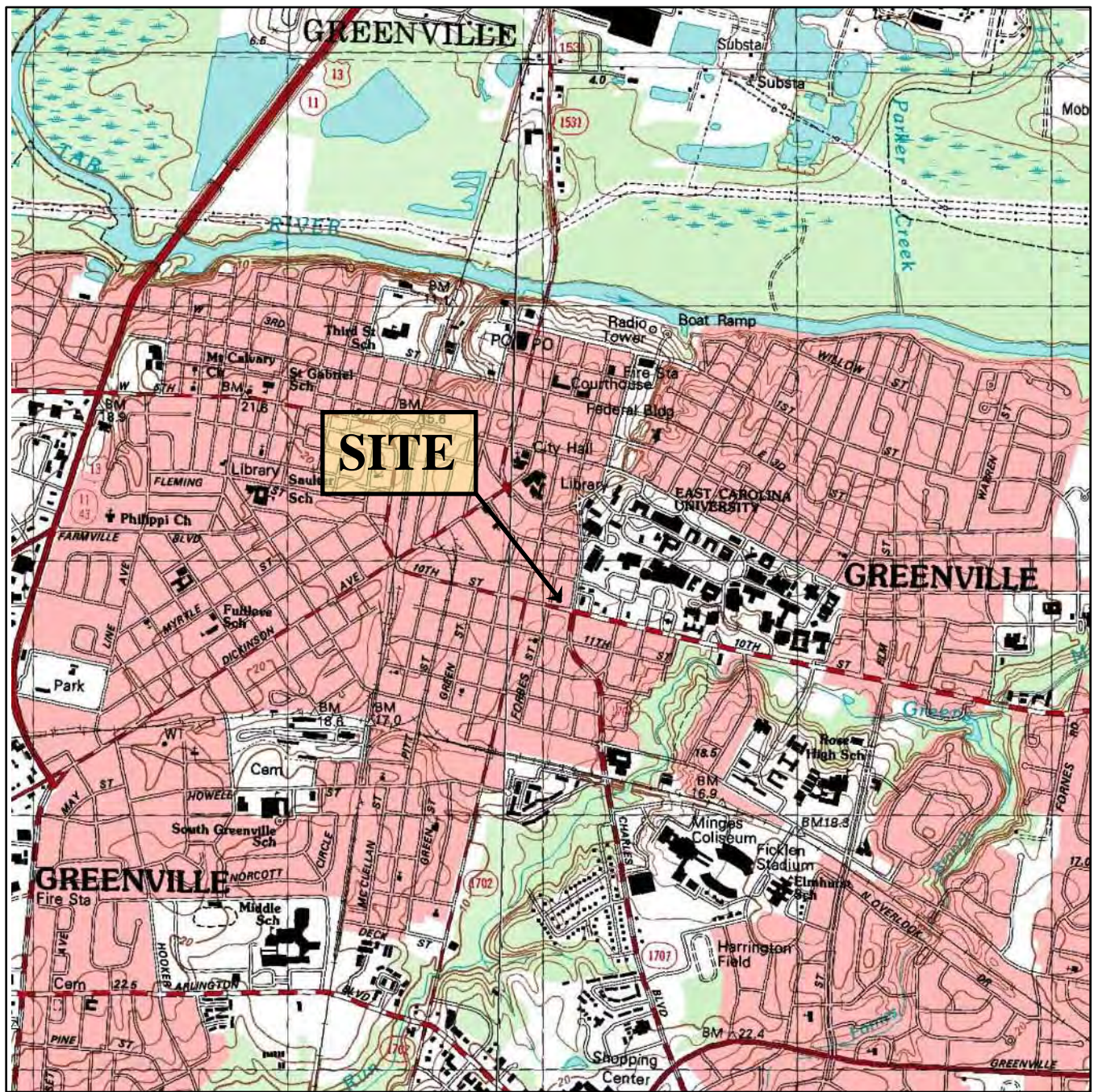

U.S.G.S. QUADRANGLE MAP
GREENVILLE SE, NORTH CAROLINA 1998

QUADRANGLE
 7.5 MINUTE SERIES (TOPOGRAPHIC)

TITLE	SITE LOCATION MAP	
PROJECT	STADIUM CLEANERS DSCA ID: 74-008 205 EAST TENTH STREET GREENVILLE, PITT COUNTY	
	 SMARTER ENVIRONMENTAL SOLUTIONS	2923 South Tryon Street-Suite 100 Charlotte, North Carolina 28203 704-586-0007 (p) 704-586-0373 (f)
DATE:	8-29-13	REVISION NO: 0
JOB NO:	DS0-71	FIGURE NO. 1

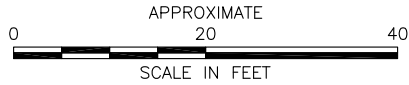
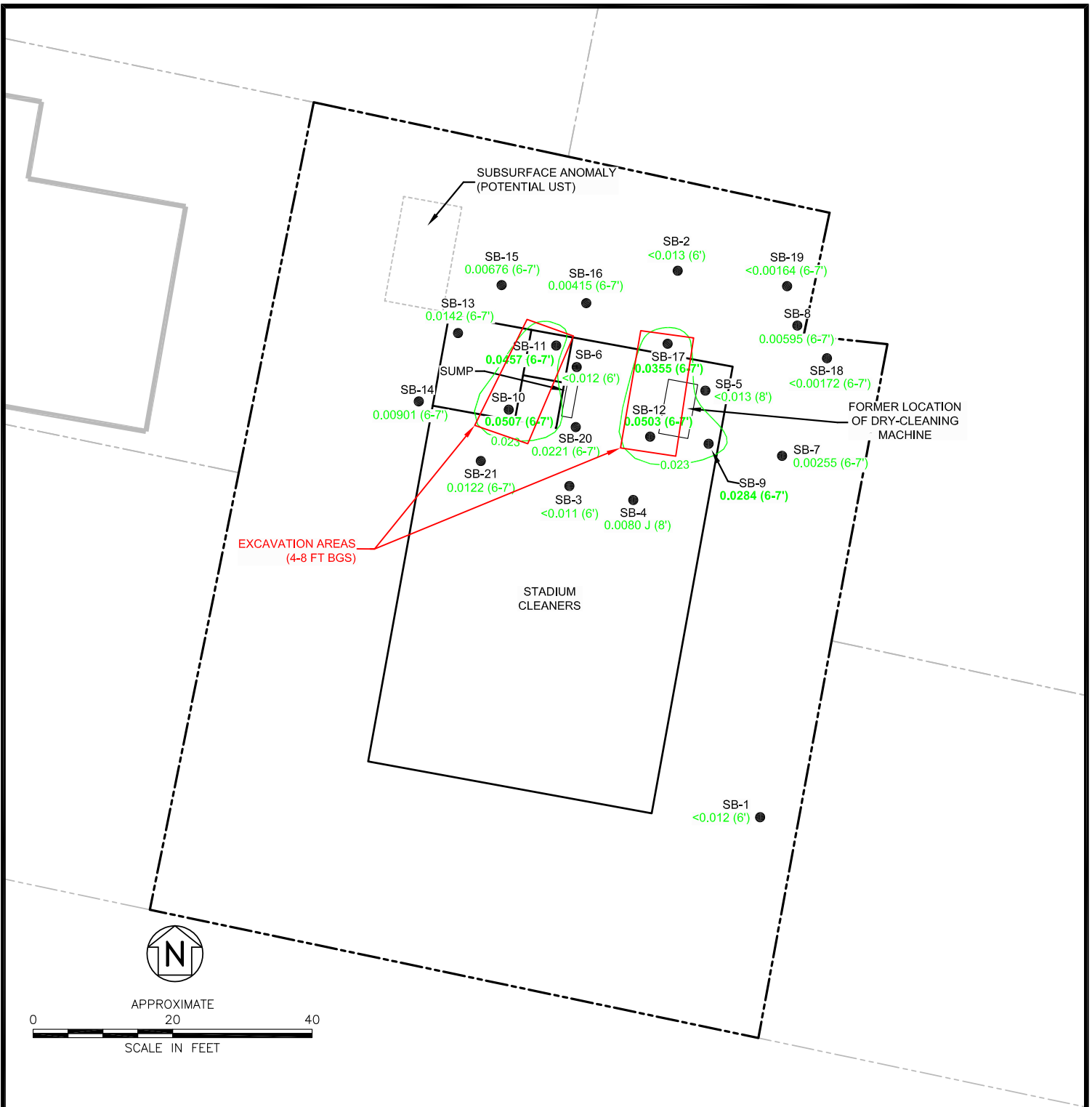

NOTES:

- SOIL SAMPLES FROM BORINGS SB-1 THROUGH SB-6 COLLECTED ON 7/26/12; SB-7 THROUGH SB-12 COLLECTED ON 12/13/12; AND SB-13 THROUGH SB-21 COLLECTED ON 3/08/13.
- BOLD** PCE CONCENTRATION INDICATES EXCEEDANCE OF TIER 1 RISK BASED SCREENING LEVEL.

LEGEND

- PROPERTY BOUNDARY
- PARCEL BOUNDARY
- DRY-CLEANING FACILITY
- OFF-SITE BUILDING
- PROPOSED EXCAVATION AREA
- SOIL BORING
- <0.012 (6') PCE CONCENTRATION IN mg/kg (DEPTH IN FEET)
- 0.023 PCE ISOCONTOUR LINE (mg/kg)

TITLE PRE-EXCAVATION SUBSURFACE SOIL (> 3 FT BGS) PROPOSED EXCAVATION AREA	
PROJECT STADIUM CLEANERS DSCA ID: 74-0008 205 EAST TENTH STREET GREENVILLE, PITT COUNTY	
2923 South Tryon Street-Suite 100 Charlotte, North Carolina 28203 704-586-0007(p) 704-586-0373(f) License # C-1269 / #C-245 Geology SMARTER ENVIRONMENTAL SOLUTIONS	
DATE: 8-29-13	REVISION NO. 0
JOB NO. DSO-71	FIGURE NO. 2B

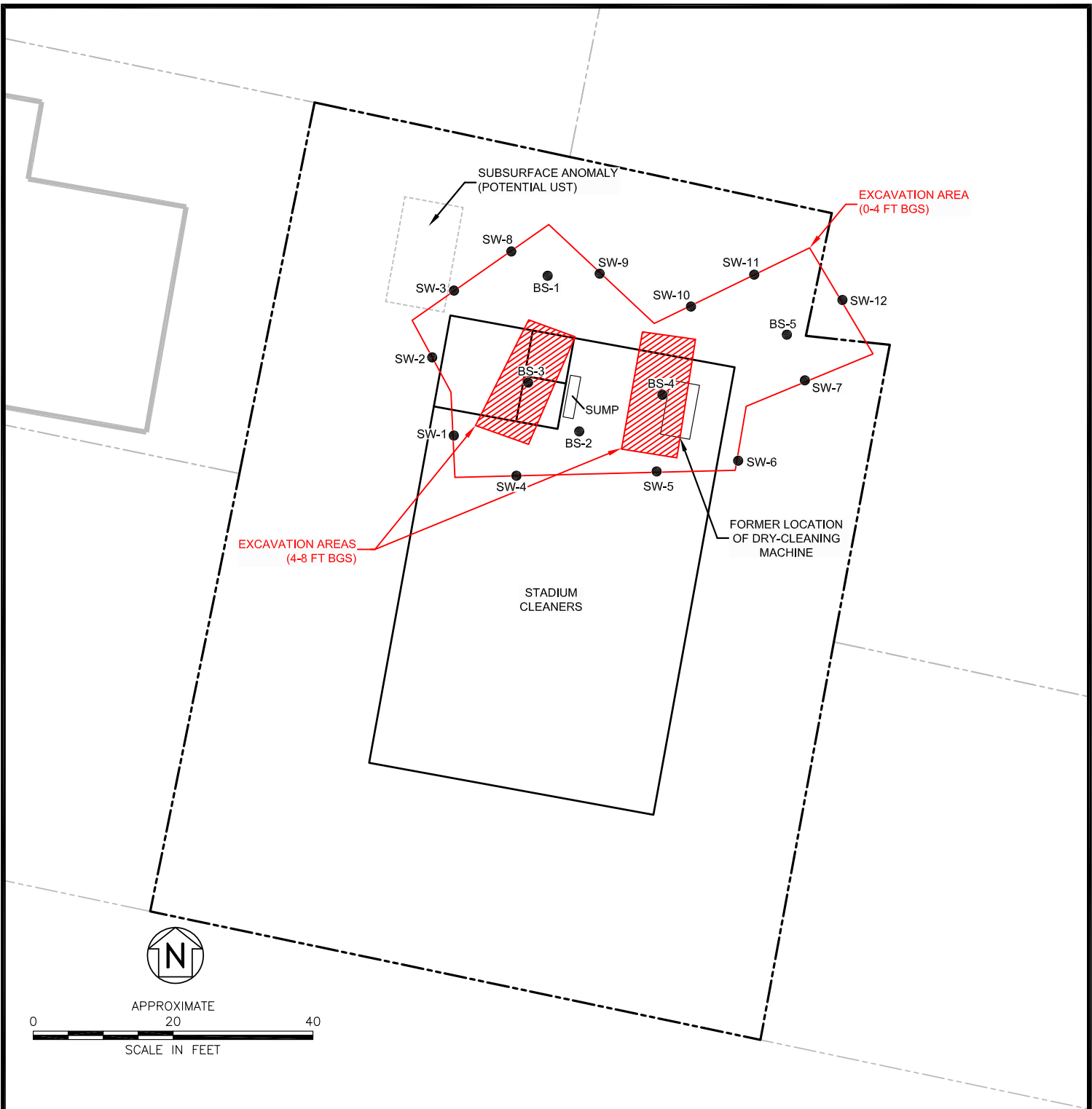

LEGEND

- PROPERTY BOUNDARY
- PARCEL BOUNDARY
- DRY-CLEANING FACILITY
- OFF-SITE BUILDING
- CONFIRMATION SOIL SAMPLE

TITLE EXCAVATION CONFIRMATION SAMPLE LOCATION MAP	
PROJECT STADIUM CLEANERS DSCA ID: 74-0008 205 EAST TENTH STREET GREENVILLE, PITT COUNTY	
 2923 South Tryon Street-Suite 100 Charlotte, North Carolina 28203 704-586-0007(p) 704-586-0373(f) License # C-1269 / #C-245 Geology	
DATE: 8-29-13	REVISION NO. 0
JOB NO. DS0-71	FIGURE NO. 3

Appendix A
GSI Model Documentation

Main Screen

RBCA Tool Kit for Chemical Releases
Version 2.6 © 2011 GSI Environmental Inc.

1. Project Information

Site Name: Stadium Cleaners, DSCA ID 74-0008
 Location: 205 E Tenth St. Greenville, Pitt County
 Completed By: Hart & Hickman
 Date: 22-Mar-13 Job ID: DS0-71

2. Which Type of RBCA Analysis?

Tier 1

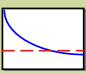
Risk-Based Screening Levels

Tier 2/3

Site-Specific Target Levels

3. Calculation Options

Affects which input data are required

- Baseline Risks (Forward mode)**
- RBCA Cleanup Levels (Backward mode)**
- Individual Constituent Risk Goals Only
- Individual and Cumulative Risk Goals
- Apply Source Depletion Algorithm
 Time to Future Exposure (yr)

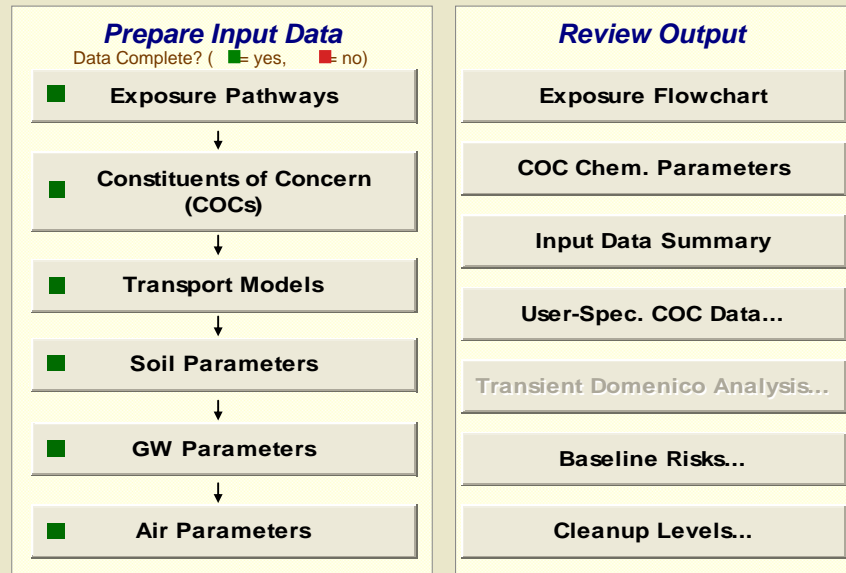
4. RBCA Evaluation Process



5. Commands and Options

New Site

Load Data...

Save Data As...

User Chemical Database

Set Units

Print Sheet

Print Report

Help

Quit

Exposure Pathway Identification

1. Groundwater Exposure ?

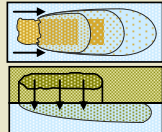

Groundwater Ingestion/ Surface Water Impact ?

Receptor: MCL

Distance: (cm)

Source Media:

- Affected Groundwater
- Affected Soils Leaching to Groundwater

Option:

- Apply MCL value as ingestion RBEL (backward mode only)

GW Discharge to Surface Water Exposure

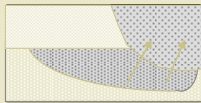

- Swimming
- Fish Consumption
- Specified Water Quality Criteria

2. Surface Soil Exposure ?

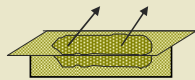

Combined Exposure ?

Receptor:

Distance: (cm)

Source Media:

- Direct Ingestion
- Dermal Contact
- Inhalation (vol+part)
- Vegetable Ingestion

Option:

- Apply UK (CLEA) SGV as soil concentration limit

Site Name: Stadium Cleaners, DSCA ID 74-0008

Location: 205 E Tenth St. Greenville, Pitt County

Compl. By: Hart & Hickman

Job ID: DS0-71

Date: 22-Mar-13

3. Air Exposure ?

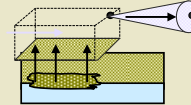

Volatilization and Particulates to Outdoor Air Inhalation ?

Receptor:

Distance: (cm)

Source Media:

- Construction worker
- Affected Soils--Volatilization to Ambient Outdoor Air
- Affected Groundwater--Volatilization to Ambient Outdoor Air
- Affected Surface Soils--Particulates to Ambient Outdoor Air

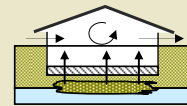

Volatilization to Indoor Air Inhalation ?

Receptor: Res.

Distance: (cm)

Source Media:

- Affected Soils--Volatilization to Enclosed Space
- Affected Soils Leaching to GW--Volatilization to Enclosed Space
- Affected Groundwater--Volatilization to Enclosed Space

4. Commands and Options

Exposure Factors & Target Risks

Exposure Factors and Target Risk Limits

1. Exposure Parameters

	Residential Receptors			Commerical Receptors		User
	Child	Adolescent	Adult	Adult	Construc.	Defined
Averaging time, carcinogens (yr)	70					
Averaging time, non-carcinogens (yr)	6	12	30	25	1	-
Body weight (kg)	15	35	70	70	70	-
Exposure duration (yr)	6	12	30	25	1	-
Averaging Time for Vapor Flux (yr)	30			30	30	-
Exposure frequency (d/yr)	350			250	180	-
Dermal exposure freq. (d/yr)	350			250	180	-
Seasonal-avg skin surface area (cm ² /d)	2023	2023	3160	3160	3160	-
Soil dermal adherence factor (mg/cm ²)	0.5	0.5	0.5	0.5	0.5	-
Water ingestion rate (L/d)	1	1	2	1	1	-
Soil ingestion rate (mg/d)	200	200	100	50	100	-
Swimming exposure time (hr/event)	1	3	3			
Swimming event frequency (events/yr)	12	12	12			
Swimming water ingestion rate (L/hr)	0.5	0.5	0.05			
Skin surface area, swimming (cm ²)	3500	8100	23000			
Fish consumption rate (kg/d)	0.025	0.025	0.025			
Vegetable ingestion rate (kg/d)						
Above-ground vegetables	0.002	0.002	0.006			
Below-ground vegetables	0.001	0.001	0.002			
Contaminated fish fraction (-)	1					

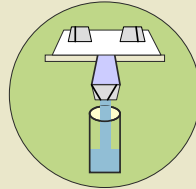

Site Name: Stadium Cleaners, DSCA ID 74-0008
 Location: 205 E Tenth St. Greenville, Pitt County
 Compl. By: Hart & Hickman
 Job ID: DS0-71 Date: 22-Mar-13

2. Age Adjustment for Carcinogens

(residential receptor only)

	Adjustment Factor
<input checked="" type="checkbox"/> Seasonal skin surface area, soil contact	1022.26 (cm ² -yr/kg)
<input checked="" type="checkbox"/> Water ingestion	1.08571 (mg-yr/L-day)
<input checked="" type="checkbox"/> Soil ingestion	165.714 (mg-yr/kg-day)
<input checked="" type="checkbox"/> Swimming water ingestion	4.56 (L/kg)
<input checked="" type="checkbox"/> Skin surface area, swimming	80640 (cm ² -yr/kg)
<input checked="" type="checkbox"/> Fish consumption	0.02286 (kg-yr/kg-day)
<input checked="" type="checkbox"/> Below-ground vegetable ingestion	0.38 (kg-yr/kg-day)
<input checked="" type="checkbox"/> Above-ground vegetable ingestion	0.88 (kg-yr/kg-day)

3. Non-Carcinogenic Receptor

(residential receptor only) Child

4. Target Health Risk Limits

	Individual	Cumulative
Target Cancer Risk (Carcinogens)	1.0E-5	1.0E-5
Target Hazard Quotient/Index (non-Carc.)	1.0E+0	1.0E+0

5. Commands and Options

Return to Exposure Pathways

Site Name: Stadium Cleaners, DSCA ID 74-0008
 Location: 205 E Tenth St. Greenville, Pitt County
 Compl. By: Hart & Hickman

Job ID: DS0-71
 Date: 22-Mar-13

Commands and Options

Main Screen

Print Sheet

Help

Source Media Constituents of Concern (COCs)

Apply Raoult's Law ?

Selected COCs ?

Representative COC Concentration ?

<p>COC Select:</p> <p>Add/Insert</p> <p>Delete</p>	<p>Sort List:</p> <p>Top</p> <p>Bottom</p> <p>MoveUp</p> <p>MoveDown</p>
---	---

Groundwater Source Zone

Enter Directly ▼ Enter Site Data

(mg/L) note

Soil Source Zone

Enter Directly ▼ Enter Site Data

(mg/kg) note

4.8E+1 Maximum concentration

Mole Fraction in Source Material

(-)

Tetrachloroethylene

Chemicals in yellow have parameters that differ from the default RBCA Tool Kit chemical database.

View Chemical Parameters

Transport Modeling Options

1. Vertical Transport, Surface Soil Column

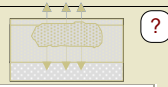

Outdoor Air Volatilization Factors

- Surface soil volatilization model only ASTM Model
- Combination surface soil/Johnson & Ettinger models
 Thickness of surface soil zone (cm)
- User-specified VF from other model Enter VF Values

Indoor Air Volatilization Factors

More Info: **BioVapor** model

- Johnson & Ettinger model for soil and groundwater volatilization
- Johnson & Ettinger for soil, Mass Flux model for groundwater
- User-specified VF from other model Enter VF Values

Soil-to-Groundwater Leaching Factor

- ASTM Model
- Apply Soil Attenuation Model (SAM) Enter Decay Rates
- Allow first-order biodecay Enter LF Values
- User-specified LF from other model

Modeling Options

- Disable Mass Balance Limit
- Apply Dual Equilibrium Desorption Model

2. Lateral Air Dispersion Factor

- 3-D Gaussian dispersion model Off-site 1 Off-site 2 (-)
- User-Specified ADF

Site Name: Stadium Cleaners, DSCA ID 74-0008

Job ID: DS0-71

Location: 205 E Tenth St. Greenville, Pitt County

Date: 22-Mar-13

Compl. By: Hart & Hickman

3. Groundwater Dilution Attenuation Factor



Calculate DAF using Domenico Model

- Domenico equation with dispersion only (no biodegradation)
 - Domenico equation first-order decay Enter Decay Rates
 - Modified Domenico equation using electron acceptor superposition Enter Site Data
- Biodegradation Capacity (mg/L)
- or —

User-Specified DAF Values

- DAF values from other model or site data Enter DAF Values

4. Chemical Decay and Source Depletion



Enter Decay Rates

Enter Source Mass

5. Commands and Options

Main Screen

Print Sheet

Help

Site-Specific Soil Parameters

1. Soil Source Zone Characteristics ?

Hydrogeology

Depth to water-bearing unit (cm)
 Capillary zone thickness (cm)
 Soil column thickness (cm)

Affected Soil Zone

Depth to top of affected soils (cm)
 Depth to base of affected soils (cm)
 Length of affected soil parallel to assumed GW flow direction (cm)

	Res/Com	Construction	
Affected soil area	2025		(cm ²)
Length of affected soil parallel to assumed wind direction	45	45	(cm)

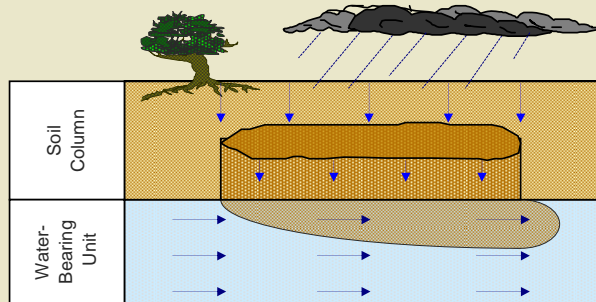

Site Name: Stadium Cleaners, DSCA ID 74-0008
 Location: 205 E Tenth St. Greenville, Pitt County
 Compl. By: Hart & Hickman

Job ID: DS0-71
 Date: 22-Mar-13

2. Surface Soil Column ?

Predominant USCS Soil Type

	Vadose Zone	Capillary Fringe	
Volumetric water content	<input type="text" value="0.12"/>	<input type="text" value="0.342"/>	(-)
Volumetric air content	<input type="text" value="0.26"/>	<input type="text" value="0.038"/>	(-)
Total porosity	<input type="text" value="0.38"/>		(-)
Dry bulk density	<input type="text" value="1.5"/>		(kg/L)
Vertical hydraulic conductivity	<input type="text" value="864"/>		(cm/d)
Vapor permeability	<input type="text" value="9.29E-06"/>		(cm ²)
Capillary zone thickness	<input type="text" value="5"/>		(cm)

Net Rainfall Infiltration

Net infiltration estimate (in/yr)
 or (in/yr)
 Average annual precipitation (in/yr)

Partitioning Parameters

Fraction organic carbon - entire soil column (-)
 Fraction organic carbon - root zone (-)
 Soil/water pH (-)

3. Commands and Options

[Main Screen](#)

Use/Set Default Values

[Print Sheet](#)

[Set Units](#)

[Help](#)

Site-Specific Groundwater Parameters

1. Water-Bearing Unit ?

Hydrogeology

Groundwater Darcy velocity	<input type="text" value="4.1E+0"/>	(cm/d)
Groundwater seepage velocity	<input type="text" value="1.1E+1"/>	(cm/d)
or <input type="button" value="Calculate"/> or <input type="text" value="↑"/>		
Hydraulic conductivity	<input type="text" value="6.9E+2"/>	(cm/d)
Hydraulic gradient	<input type="text" value="0.006"/>	(-)
Effective porosity	<input type="text" value="0.38"/>	(-)

Sorption

Fraction organic carbon--saturated zone	<input type="text" value="0.002"/>	(-)
Groundwater pH	<input type="text" value="6.2"/>	(-)

2. Groundwater Source Zone ?

Groundwater plume width at source	<input type="text" value="45"/>	(cm)
Plume (mixing zone) thickness at source	<input type="text" value="200"/>	(cm)
<input type="button" value="Enter Directly"/> or <input type="text" value="↑"/>		
Saturated thickness	<input type="text" value="60.96"/>	(cm)
Length of source zone	<input type="text" value="822.96"/>	(cm)

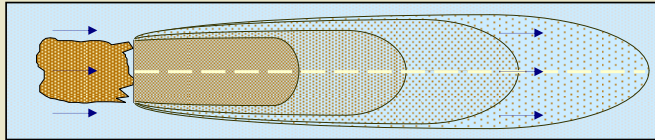

Site Name: Stadium Cleaners, DSCA ID 74-0008

Job ID: DS0-71

Location: 205 E Tenth St. Greenville, Pitt County

Date: 22-Mar-13

Compl. By: Hart & Hickman

3. Groundwater Dispersion ?

Model:	<input type="text" value="ASTM Default"/>	GW Ingestion		GW to Indoor Air	
		Off-site 1	Off-site 2	Off-site 1	Off-site 2
Distance to GW receptors	<input type="text" value="0"/>	<input type="text" value="0"/>	<input type="text" value="0"/>	<input type="text" value="0"/>	<input type="text" value="0"/>
		↓	↓	↓	↓
Longitudinal dispersivity	<input type="text"/>	<input type="text"/>	<input type="text"/>	<input type="text"/>	<input type="text"/>
Transverse dispersivity	<input type="text"/>	<input type="text"/>	<input type="text"/>	<input type="text"/>	<input type="text"/>
Vertical dispersivity	<input type="text"/>	<input type="text"/>	<input type="text"/>	<input type="text"/>	<input type="text"/>

4. Groundwater Discharge to Surface Water ?

	Off-site 2
Distance to GW/SW discharge point	<input type="text" value="NA"/>
Plume width at GW/SW discharge	<input type="text" value="0"/>
Plume thickness at GW/SW discharge	<input type="text" value="0"/>
Surface water flowrate at GW/SW discharge	<input type="text" value="0.0E+0"/>

5. Commands and Options

[Main Screen](#)

[Use/Set Default Values](#)

[Print Sheet](#)

[Set Units](#)

[Help](#)

RBCA SITE ASSESSMENT

Site Name: Stadium Cleaners, DSCA ID 74-0008
 Site Location: 205 E Tenth St. Greenville, Pitt County

Completed By: Hart & Hickman
 Date Completed: 22-Mar-13

Job ID: DS0-71

**SURFACE SOIL (0 - 91 cm)
 SSTL VALUES**

Target Risk (Class A & B) 1.0E-5
 Target Hazard Quotient 1.0E+0

Groundwater DAF Option:

SSTL Results For Complete Exposure Pathways (Checked if Pathway is Complete)

CONSTITUENTS OF CONCERN		Representative Concentration (mg/kg)	Soil Leaching to Groundwater Ingestion			Soil Leaching to Groundwater/ Groundwater Volatilization to Indoor Air			Soil Vol. to Indoor Air	Soil Volatilization and Surface Soil Particulates to Outdoor Air			Direct Contact Pathways: direct combined pathways		Applicable SSTL (mg/kg)	SSTL Exceeded? ■* if yes	Required CRF Only if "yes" left		
			On-site (0 cm)	Off-site 1 (0 cm)	Off-site 2 (0 cm)	On-site (0 cm)	Off-site 1 (0 cm)	Off-site 2 (0 cm)	On-site (0 cm)	On-site (0 cm)	Construction Worker	Off-site 1 (0 cm)	Off-site 2 (0 cm)	On-site (0 cm)				Construction Worker	
CAS No.	Name	(mg/kg)	MCL	None	None	Residential	None	None	None	None	Construction Worker	None	None	None	None	Construction Worker	(mg/kg)	■* if yes	1.3E+3
127-18-4	Tetrachloroethylene *	4.8E+1	3.5E-2			2.1E+1											3.5E-2	■	1.3E+3

* = Chemical with user-specified data

">" indicates risk-based target concentration greater than constituent residual saturation value. NA = Not applicable. NC = Not calculated.

RBCA SITE ASSESSMENT	Chemical-Specific Tier 2 Cleanup Summary
-----------------------------	---

Site Name: Stadium Cleaners, DSCA ID 74-0008 Completed By: Hart & Hickman Job ID: DS0-71
 Site Location: 205 E Tenth St. Greenville, Pitt County Date Completed: 22-Mar-13 1 of 3

Constituent: Tetrachloroethylene * CAS No.: 127-18-4

Site-Specific Target Level (SSTL) Concentrations			
	On-site	Off-site1	Off-site2
Groundwater Ingestion			
Receptor Type / Distance (cm)	None	None	None
SSTL _{gw} THQ = 1E+0	NA	NA	NA
(mg/L) TR = 1E-5	NA	NA	NA
Soil Leaching to Groundwater Ingestion			
Receptor Type / Distance (cm)	MCL / 0	None	None
SSTL _s THQ = 1E+0	3.5E-2	NA	NA
(mg/kg) TR = 1E-5	3.5E-2	NA	NA
Surface Soil Ingestion and Dermal Contact			
Receptor Type / Distance (cm)	None	No Off-site Receptors	
SSTL _{ss} THQ = 1E+0	NA		
(mg/kg) TR = 1E-5	NA		
Outdoor Air Inhalation			
Receptor Type / Distance (cm)	None	None	None
RBEL _{air} THQ = 1E+0	NA	NA	NA
(µg/m ³) TR = 1E-5	NA	NA	NA
Soil Volatilization/Particulates to Outdoor Air Inhalation			
Receptor Type / Distance (cm)	None	None	None
SSTL _s THQ = 1E+0	NA	NA	NA
(mg/kg) TR = 1E-5	NA	NA	NA
Groundwater Volatilization to Outdoor Air Inhalation			
Receptor Type / Distance (cm)	None	None	None
SSTL _{gw} THQ = 1E+0	NA	NA	NA
(mg/L) TR = 1E-5	NA	NA	NA
Indoor Air Inhalation			
Receptor Type / Distance (cm)	Residential	None	None
RBEL _{air} THQ = 1E+0	4.2E+1	NA	NA
(µg/m ³) TR = 1E-5	9.4E+1	NA	NA
Soil Volatilization to Indoor Air Inhalation			
Receptor Type / Distance (cm)	None	No Off-site Receptors	
SSTL _s THQ = 1E+0	NA		
(mg/kg) TR = 1E-5	NA		
Groundwater Volatilization to Indoor Air Inhalation			
Receptor Type / Distance (cm)	None	None	None
SSTL _{gw} THQ = 1E+0	NA	NA	NA
(mg/L) TR = 1E-5	NA	NA	NA
Soil Leaching to Groundwater to Indoor Air Inhalation			
Receptor Type / Distance (cm)	Residential / 0	None	None
SSTL _{gw} THQ = 1E+0	2.1E+1	NA	NA
(mg/L) TR = 1E-5	4.8E+1	NA	NA

Chemical Parameters			
	Units	Value	Reference
Physical Properties			
MW	(g/mol)	1.7E+2	EPA-12
Sol	(mg/L)	2.1E+2	EPA-12
P _{vap}	(mmHg)	1.8E+1	TX11
H	(L-wat/L-air)	7.2E-1	EPA-12
log(K _{oc})	(log[L/kg])	2.0E+0	EPA-12
log(K _{ow})	(log[L/kg])	3.0E+0	TX11
D _{air}	(cm ² /sec)	5.0E-2	EPA-12
D _{wat}	(cm ² /sec)	9.5E-6	EPA-12
Toxicity Data			
SF _o	(1/[mg/kg/day])	2.1E-3	EPA-12
SF _d	(1/[mg/kg/day])	2.1E-3	EPA-12
URF _i	(1/[µg/m ³])	2.6E-7	EPA-12
RfD _o	(mg/kg/day)	6.0E-3	EPA-12
RfD _d	(mg/kg/day)	6.0E-3	EPA-12
RfC _i	(mg/m ³)	4.0E-2	EPA-12
BCF	(-)	4.9E+1	LY
RBAF	(-)	1.0E+0	TX11
Dermal Exposure Parameters			
RAF _d	(-)	0.0E+0	EPA-12
abs.d	(-)	0.0E+0	EPA-12
abs.gi	(-)	1.0E+0	EPA-12
K _p	(cm/hr)	3.3E-2	D
tau _d	(hr/event)	8.9E-1	D
t _{crit}	(hr)	2.1E+0	D
B	(-)	1.7E-1	D
Regulatory Standards			
MCL	(mg/L)	1.2E-2	*
TWA	(mg/m3)	6.9E+2	OS
SWQC	(mg/L)	-	-
Br.Abg	(-)	-	-
Br.bg	(-)	-	-
Miscellaneous Parameters			
ADL _{gw}	(mg/L)	5.0E-4	S
ADL _s	(mg/kg)	-	-
t _{1/2,sat}	(d)	7.2E+2	H
t _{1/2,unsat}	(d)	7.2E+2	H

	Units	Residential	Commercial	Construction
Cross-Media Transfer Factors				
VF _{ss}	(kg-soil/m3-air)	NA	NA	NA
VF _{samb}	(kg-soil/m3-air)	NA	NA	NA
VF _{wamb}	(m3-wat/m3-air)	NA	NA	NA
VF _{seep}	(kg-soil/m3-air)	NA	NA	NA
VF _{wesp}	(m3-wat/m3-air)	NA	NA	NA
LF	(kg-soil/L-wat)	All exposures: 3.4E-1		NA

	Units	On-Site	Off-Site1	Off-Site2
Lateral Transport Factors				
DAF _{gw}	(-)	NA	NA	NA
DAFs/gw	(-)	1.0E+0	NA	NA

	Units	Value
Derived Parameters		
K _{sw}	(L-wat/kg-soil)	2.5E+0
C _{sat}	(mg/kg-soil)	8.1E+1
C _{sat,vap}	(µg/m ³ -air)	1.7E+8
D _{eff,s}	(cm ² /sec)	3.9E-3
D _{eff,crk}	(cm ² /sec)	3.9E-3
D _{eff,cap}	(cm ² /sec)	9.1E-6
D _{eff,ws}	(cm ² /sec)	8.3E-4
R _{sat}	(-)	-
R _{unsat}	(-)	-
Z	(cm/event)	1.6E-1

Notes: 1) NA = Not applicable; NC = Not calculated.
 2) Definitions and references presented on page 2 of 2.

Appendix C
Non-Hazardous Waste Disposal Manifests and Weight Tickets



NON-HAZARDOUS SPECIAL WASTE & ASBESTOS MANIFEST

483464

If waste is asbestos waste, complete Sections I, II, III and IV
If waste is NOT asbestos waste, complete Sections I, II and III

I. GENERATOR (Generator completes Ia-r)

Form I: Generator information including EPA ID, manifest number, generator name/location, mailing address, phone numbers, owner information, waste profile, and shipping details.

II. TRANSPORTER (Generator completes IIa-b and Transporter completes IIc-e)

Form II: Transporter information including name/address, phone, driver name, signature, and date.

III. DESTINATION (Generator complete IIIa-c and Destination Site completes III d-g)

Form III: Destination information including disposal facility address, EPA number, discrepancy space, and authorized agent details.

IV. ASBESTOS (Generator completes IVa-f and Operator complete IVg-i)

Form IV: Asbestos information including operator name/address, responsible agency, special handling instructions, and operator certification.

SITE EAST CAROLINA ENV LANDFILL
 AULANDER, NC 27805 242-348-3322

CUSTOMER
 000939
 Evo Corporation
 1703 Vargrave Street
 Winston-Salem, NC 27107
 3026137803

WEIGHMASTER
 TICKET # 924912
 CELL M34M33CELL12LIFT4

JAMES F.
 DATE/TIME IN 06-04-2013 7:49 am
 DATE/TIME OUT 06-4-2013 8:10 am
 CONTAINER

VEHICLE
 TRUCK REFERENCE

INVOICE

SCALE IN	GROSS WEIGHT	NET TONS	NET WEIGHT	SCALE OUT	TARE WEIGHT	NET WEIGHT	INBOUND
0.00	42,960	5.46	10,920	5.46	32,040	10,920	INBOUND
YD	TRACKING QTY			TN	SW-CONST DEBRIS	PITT	

NET AMOUNT

TENDERED

CHANGE

CHECK#

NET AMOUNT

TENDERED

CHANGE

CHECK#

Indemnification. Generator agrees to indemnify, hold harmless, and defend Republic Services of NC, LLC, its subsidiaries, affiliates, employees, officer and directors from and against any and all liabilities, claims, penalties, forfeitures, suits, and cost and expenses incident thereto, including cost of defense, settlement and reasonable attorney's fees, which may be incurred, as a result of death or injuries to any person, or damage to any property contamination of or adverse effect on the undersigned individual signing this document on behalf of Customer acknowledges that he or she has read and understands the terms and conditions on the reverse side and that he or she has the authority to sign this document on behalf of the customer.

SIGNATURE *Jim L. Myer*



NON-HAZARDOUS SPECIAL WASTE & ASBESTOS MANIFEST

483431

If waste is asbestos waste, complete Sections I, II, III and IV
If waste is NOT asbestos waste, complete Sections I, II and III

I. GENERATOR (Generator completes la-r)

Form I: Generator information including EPA ID, manifest number, name, location, mailing address, phone numbers, waste profile, and certification. Includes handwritten notes like 'slaw 004' and '1335'.

II. TRANSPORTER (Generator completes IIa-b and Transporter completes IIc-e)

Form II: Transporter information including name, address, phone, driver name, signature, and date.

III. DESTINATION (Generator complete IIIa-c and Destination Site completes III d-g)

Form III: Destination information including disposal facility address, EPA number, discrepancy space, and authorized agent details.

IV. ASBESTOS (Generator completes IVa-f and Operator complete IVg-i)

Form IV: Asbestos information including operator name, responsible agency, friable/non-friable status, and operator certification.

SITE	TICKET #	CELL
01	923498	M34M33CELL12LIFT4
WEIGHMASTER		
JAMES E.		
DATE/TIME IN	DATE/TIME OUT	
05-21-2013 9:45 am	05-21-2013 10:13 am	
VEHICLE	CONTAINER	
TRUCK		
REFERENCE	INVOICE	
BILL OF LADING		

SITE	EAST CAROLINA ENV LANDFILL	
AULANDER, NC	27805	242-348-3322
CUSTOMER		
000939	Evo Corporation	
	1703 Vargrave Street	
	Winston-Salem, NC 27107	
3026137803		

SCALE IN	GROSS WEIGHT	NET TONS	SCALE OUT	TARE WEIGHT	NET WEIGHT	INBOUND
	61,540	13.35		34,840	26,700	

QTY	UNIT	DESCRIPTION	RATE	EXTENSION	TAX	TOTAL
0.00	YD	TRACKING QTY				
13.35	TN	SW-CONST DEBRIS				
1.00		ENVIRONMENTAL FEE 4				
1.00		ENVIRONMENTAL FEE 5				

Indemnification. Generator agrees to indemnify, hold harmless, and defend Republic Services of NC, LLC, its subsidiaries, affiliates, employees, officer and directors from and against any and all liabilities, claims, penalties, forfeitures, suits, and cost and expenses incident thereto, including cost of defense, settlement and reasonable attorney's fees, which may be incurred, as a result of death or injuries to any person, or damage to any property contamination of or adverse effect on the undersigned individual signing this document on behalf of Customer acknowledges that he or she has read and understands the terms and conditions on the reverse side and that he or she has the authority to sign this document on behalf of the customer.

NET AMOUNT

TENDERED

CHANGE

CHECK#

SIGNATURE *[Signature]*



NON-HAZARDOUS SPECIAL WASTE & ASBESTOS MANIFEST

483429

If waste is asbestos waste, complete Sections I, II, III and IV
If waste is **NOT** asbestos waste, complete Sections I, II and III

I. GENERATOR (Generator completes Ia-r)

a. Generator's US EPA ID Number NCP000163352		b. Manifest Document Number		c. Page 1 of		
d. Generator's Name and Location: Petitioner for DSCA Site #74-0008 705 E. Tenth Street Greenville, NC 27838 <i>51aw 004</i>			e. Generator's Mailing Address: Petitioner for DSCA Site #74-0008 1940 Mail Service Center Raleigh, NC 27600			
f. Phone:			g. Phone: 919 707 3257			
If owner of the generating facility differs from the generator, provide:						
h. Owner's Name:			i. Owner's Phone No.:			
j. Waste Profile #	k. Exp. Date	l. Waste Shipping Name and Description	m. Containers No.	m. Containers Type	n. Total Quantity	o. Unit Wt/Vol
3028137603	5/20/13	Concrete (with PCE)			15.46	

GENERATOR'S CERTIFICATION: I hereby certify that the above named material is not a hazardous waste as defined by 40 CFR 261 or any applicable state law, has been properly described, classified and packaged, and is in proper condition for transportation according to applicable regulations; AND, if this waste is a treatment residue of a previously restricted hazardous waste subject to the Land Disposal Restrictions, I certify and warrant that the waste has been treated in accordance with the requirements of 40 CFR 268 and is no longer a hazardous waste as defined by 40 CFR 261.

p. Generator Authorized Agent Name (Print) <i>Matt Gillis on behalf of DSCA 74-0008</i>		q. Signature <i>Matt Gillis</i>	r. Date <i>5/20/13</i>
--	--	------------------------------------	---------------------------

II. TRANSPORTER (Generator completes IIa-b and Transporter completes IIc-e)

a. Transporter's Name and Address: EVO Corporation 1703 Vantage Street Winston Salem, NC 27107 336-726-5544		b. Phone:	
c. Driver Name (Print) <i>Derek L. ...</i>	d. Signature <i>[Signature]</i>	e. Date <i>5/20/13</i>	

III. DESTINATION (Generator complete IIIa-c and Destination Site completes III d-g)

a. Disposal Facility and Site Address: Evo Carolina Environmental LP 1900 Republican Road Aulander, NC 27005 b. 252-348-3373	c. US EPA Number N/A	d. Discrepancy Indication Space:
--	-------------------------	----------------------------------

I hereby certify that the above named material has been accepted and to the best of my knowledge the foregoing is true and accurate.

e. Name of Authorized Agent (Print) <i>M. Goodson</i>	f. Signature <i>M. Goodson</i>	g. Date <i>5-20-13</i>
--	-----------------------------------	---------------------------

IV. ASBESTOS (Generator completes IVa-f and Operator complete IVg-i)

a. Operator's Name and Address:	b. Phone:	c. Responsible Agency Name and Address:	d. Phone:
e. Special Handling Instructions and Additional Information:			

f. Friable Non-Friable Both % Friable % Non-Friable

OPERATOR'S CERTIFICATION: I hereby declare that the contents of this consignment are fully and accurately described above by the proper shipping name and are classified, packaged, marked and labeled/placarded, and are in all respects in proper condition for transport according to applicable international and national governmental regulations.

g. Operator's Name and Title (Print)	h. Signature	i. Date
--------------------------------------	--------------	---------

*Operator refers to the company which owns, leases, operates, controls, or supervises the facility being demolished or renovated, or the demolition or renovation operation or both

SITE	TICKET #	CELL
01	923386	M34M33CELL12LIFT4
WEIGHMASTER		
ARCHIE B.		
DATE/TIME IN	DATE/TIME OUT	
05-20-2013 12:33 pm	05-20-2013 12:54 pm	
VEHICLE	CONTAINER	
TRIC03		
REFERENCE	INVOICE	
BILL OF LADING		

SITE	EAST CAROLINA ENV LANDELL	
AULANDER, NC	27805	242-348-3322
CUSTOMER	000939	
	Evo Corporation	
	1703 Vargrave Street	
	Winston-Salem, NC 27107	
	3026137803	

QTY	UNIT	DESCRIPTION	NET TONS	NET WEIGHT	SCALE IN	SCALE OUT	GROSS WEIGHT	TARE WEIGHT	NET TONS	NET WEIGHT	SCALE IN	SCALE OUT	RATE	EXTENSION	TAX	TOTAL
0.00	YD	TRACKING QTY							15.46							
15.46	TN	SW-CONST DEBRIS					65,580									
1.00		ENVIRONMENTAL FEE 4					34,660									
1.00		ENVIRONMENTAL FEE 5														

Indemnification. Generator agrees to indemnify, hold harmless, and defend Republic Services of NC, LLC, its subsidiaries, affiliates, employees, officer and directors from and against any and all liabilities, claims, penalties, forfeitures, suits, and cost and expenses incident thereto, including cost of defense, settlement and reasonable attorney's fees, which may be incurred, as a result of death or injuries to any person, or damage to any property contamination of or adverse effect on the undersigned individual signing this document on behalf of Customer acknowledges that he or she has read and understands the terms and conditions on the reverse side and that he or she has the authority to sign this document on behalf of the customer.

NET AMOUNT

TENDERED

CHANGE

CHECK#

SIGNATURE *Deek*

RS-F042UPR (07/12)



NON-HAZARDOUS SPECIAL WASTE & ASBESTOS MANIFEST

483430

If waste is asbestos waste, complete Sections I, II, III and IV
If waste is **NOT** asbestos waste, complete Sections I, II and III

I. GENERATOR (Generator completes Ia-r)

a. Generator's US EPA ID Number NCR000155262		b. Manifest Document Number		c. Page 1 of		
d. Generator's Name and Location: Petitioner for DSCA Site #74-0008 305 E. North Street Greenville, NC 27608 <i>slaw 004</i>			e. Generator's Mailing Address: Petitioner for DSCA Site #74-0008 1540 Mail Service Center Raleigh, NC 27609			
f. Phone:			g. Phone: 919 707 5557			
If owner of the generating facility differs from the generator, provide:						
h. Owner's Name:			i. Owner's Phone No.:			
j. Waste Profile #	k. Exp. Date	l. Waste Shipping Name and Description	m. Containers No.	m. Containers Type	n. Total Quantity	o. Unit Wt/Vol
3028137803	10/2014	Concrete (with PCE)			1504	
GENERATOR'S CERTIFICATION: I hereby certify that the above named material is not a hazardous waste as defined by 40 CFR 261 or any applicable state law, has been properly described, classified and packaged, and is in proper condition for transportation according to applicable regulations; AND, if this waste is a treatment residue of a previously restricted hazardous waste subject to the Land Disposal Restrictions. I certify and warrant that the waste has been treated in accordance with the requirements of 40 CFR 268 and is no longer a hazardous waste as defined by 40 CFR 261.						
p. Generator Authorized Agent Name (Print) <i>Matthew</i>			q. Signature <i>Matthew</i>		r. Date 5/20/13	

II. TRANSPORTER (Generator completes IIa-b and Transporter completes IIc-e)

a. Transporter's Name and Address: EVO Corporation 1703 Margrave Street Winston-Salem, NC 27107 336 725-6844		
b. Phone:		
c. Driver Name (Print) <i>David</i>	d. Signature <i>David</i>	e. Date 5/20/13

III. DESTINATION (Generator complete IIIa-c and Destination Site completes IIId-g)

a. Disposal Facility and Site Address: East Carolina Environmental LE 1000 Republican Road Aulander, NC 27905 b. 252 348-3322		c. US EPA Number N/A	d. Discrepancy Indication Space:
I hereby certify that the above named material has been accepted and to the best of my knowledge the foregoing is true and accurate.			
e. Name of Authorized Agent (Print) <i>Archie Bush</i>	f. Signature <i>Archie Bush</i>	g. Date 5-20-13	

IV. ASBESTOS (Generator completes IVa-f and Operator complete IVg-i)

a. Operator's Name and Address:		c. Responsible Agency Name and Address:	
b. Phone:		d. Phone:	
e. Special Handling Instructions and Additional Information:			
f. <input type="checkbox"/> Friable <input type="checkbox"/> Non-Friable <input type="checkbox"/> Both % Friable % Non-Friable			
OPERATOR'S CERTIFICATION: I hereby declare that the contents of this consignment are fully and accurately described above by the proper shipping name and are classified, packaged, marked and labeled/placarded, and are in all respects in proper condition for transport according to applicable international and national governmental regulations.			
g. Operator's Name and Title (Print)		i. Date	
h. Signature		i. Date	
*Operator refers to the company which owns, leases, operates, controls, or supervises the facility being demolished or renovated, or the demolition or renovation operation or both			



NON-HAZARDOUS SPECIAL WASTE & ASBESTOS MANIFEST

483434

If waste is asbestos waste, complete Sections I, II, III and IV
If waste is NOT asbestos waste, complete Sections I, II and III

zdf

I. GENERATOR (Generator completes la-r)

Form I: Generator information including US EPA ID Number, Manifest Document Number, Generator Name and Location, Mailing Address, Phone, Owner's Name, Waste Profile #, Exp. Date, Waste Shipping Name and Description, Containers, Total Quantity, Unit, and Generator's Certification.

II. TRANSPORTER (Generator completes IIa-b and Transporter completes IIc-e)

Form II: Transporter information including Name and Address, Phone, Driver Name, Signature, and Date.

III. DESTINATION (Generator complete IIIa-c and Destination Site completes III d-g)

Form III: Destination information including Disposal Facility and Site Address, US EPA Number, Discrepancy Indication Space, and Name of Authorized Agent, Signature, and Date.

IV. ASBESTOS (Generator completes IVa-f and Operator complete IVg-i)

Form IV: Asbestos information including Operator's Name and Address, Responsible Agency Name and Address, Phone, Special Handling Instructions, Friable/Non-Friable status, Operator's Certification, and Name and Title, Signature, and Date.



NON-HAZARDOUS SPECIAL WASTE & ASBESTOS MANIFEST 201

483433

If waste is asbestos waste, complete Sections I, II, III and IV
If waste is NOT asbestos waste, complete Sections I, II and III

I. GENERATOR (Generator completes Ia-r)

Form I: Generator information including EPA ID Number, Manifest Document Number, Generator Name and Location, Mailing Address, Phone, Owner Name, Waste Profile #, Exp. Date, Waste Shipping Name and Description, Containers, Total Quantity, Unit Wt/Vol, and Generator's Certification.

II. TRANSPORTER (Generator completes IIa-b and Transporter completes IIc-e)

Form II: Transporter information including Name and Address, Phone, Driver Name, Signature, and Date.

III. DESTINATION (Generator complete IIIa-c and Destination Site completes IIId-g)

Form III: Destination information including Disposal Facility and Site Address, US EPA Number, Discrepancy Indication Space, Authorized Agent Name, Signature, and Date.

IV. ASBESTOS (Generator completes IVa-f and Operator complete IVg-i)

Form IV: Asbestos information including Operator's Name and Address, Responsible Agency Name and Address, Special Handling Instructions, Friable/Non-Friable status, Operator's Certification, and Operator Name, Signature, and Date.

SITE	EAST CAROLINA ENV LANDFILL	
CUSTOMER	AULANDER, NC 27805	242-348-3322
000939	Evo Corporation	
	1703 Vargrave Street	
	Winston-Salem, NC 27107	
	3026138260	

SITE	TICKET #	CELL
01	923789	M34M33CELL12LIFT4
WEIGHMASTER		
IN DATE/TIME	ARCHIE B. OUT DATE/TIME	JAMES F.
05-23-2013 12:27 pm	05-23-2013 1:09 pm	
VEHICLE	CONTAINER	
TRUCK REFERENCE	INVOICE	
208		
BILL OF LADING		

SCALE IN	GROSS WEIGHT	NET TONS	NET WEIGHT	INBOUND
SCALE OUT	64,500	11.06	22,120	
TARE WEIGHT	42,380			
UNIT	DESCRIPTION	RATE	EXTENSION	TAX TOTAL
0.00 YD	TRACKING QTY			
11.06 TN	SW-CONT SOIL			
	PITT			

Indemnification. Generator agrees to indemnify, hold harmless, and defend Republic Services of NC, LLC, its subsidiaries, affiliates, employees, officer and directors from and against any and all liabilities, claims, penalties, forfeitures, suits, and cost and expenses incident thereto, including cost of defense, settlement and reasonable attorney's fees, which may be incurred, as a result of death or injuries to any person or damage to any property contamination of or adverse effect on the undersigned individual signing this document on behalf of customer acknowledges that he or she has read and understands the terms and conditions on the reverse side and that he or she has the authority to sign this document on behalf of the customer.

NET AMOUNT

TENDERED

CHANGE

CHECK#

RS-F042UPR (07/12) 2/21

SIGNATURE *Jim Pitt*



NON-HAZARDOUS SPECIAL WASTE & ASBESTOS MANIFEST

24

483437

If waste is asbestos waste, complete Sections I, II, III and IV
If waste is **NOT** asbestos waste, complete Sections I, II and III

I. GENERATOR (Generator completes Ia-r)

a. Generator's US EPA ID Number 10 D000145382		b. Manifest Document Number		c. Page 1 of	
d. Generator's Name and Location: Pattinor for DSCA Site #74-0008 305 E. York Street Greenville, NC 27838			e. Generator's Mailing Address: Pattinor for DSCA Site #74-0008 1048 Mail Service Center Raleigh, NC 27609		
f. Phone:			g. Phone: 919-707-3367		
If owner of the generating facility differs from the generator, provide:					
h. Owner's Name:			i. Owner's Phone No.:		
j. Waste Profile # Approval # 3826138260 EVO-906	k. Exp. Date	l. Waste Shipping Name and Description Excavated Soil	m. Containers No.	Type	n. Total Quantity 10.22
o. Unit Wt/Vol					
GENERATOR'S CERTIFICATION: I hereby certify that the above named material is not a hazardous waste as defined by 40 CFR 261 or any applicable state law, has been properly described, classified and packaged, and is in proper condition for transportation according to applicable regulations; AND, if this waste is a treatment residue of a previously restricted hazardous waste subject to the Land Disposal Restrictions. I certify and warrant that the waste has been treated in accordance with the requirements of 40 CFR 268 and is no longer a hazardous waste as defined by 40 CFR 261.					
p. Generator Authorized Agent Name (Print) Matt New			q. Signature <i>Matt New</i>		r. Date 5/23/13

II. TRANSPORTER (Generator completes IIa-b and Transporter completes IIc-e)

a. Transporter's Name and Address: EVO Corporation 1703 Wainwright Street Winston-Salem, NC 27107		
b. Phone: 336-736-5844		
c. Driver Name (Print) Tim L Myers	d. Signature <i>Tim L Myers</i>	e. Date 5-23-13

III. DESTINATION (Generator complete IIIa-c and Destination Site completes IIId-g)

a. Disposal Facility and Site Address: East Carolina Environmental 1800 Republic Road Aurander, NC 27905		b. US EPA Number N/A	d. Discrepancy Indication Space:
b. 252-248-3321			
I hereby certify that the above named material has been accepted and to the best of my knowledge the foregoing is true and accurate.			
e. Name of Authorized Agent (Print) James Givens		f. Signature <i>James Givens</i>	g. Date 5-23-13

IV. ASBESTOS (Generator completes IVa-f and Operator complete IVg-i)

a. Operator's Name and Address:		c. Responsible Agency Name and Address:	
b. Phone:		d. Phone:	
e. Special Handling Instructions and Additional Information:			
f. <input type="checkbox"/> Friable <input type="checkbox"/> Non-Friable <input type="checkbox"/> Both % Friable % Non-Friable			
OPERATOR'S CERTIFICATION: I hereby declare that the contents of this consignment are fully and accurately described above by the proper shipping name and are classified, packaged, marked and labeled/placarded, and are in all respects in proper condition for transport according to applicable international and national governmental regulations.			
g. Operator's Name and Title (Print)		h. Signature	
		i. Date	
*Operator refers to the company which owns, leases, operates, controls, or supervises the facility being demolished or renovated, or the demolition or renovation operation or both			

SITE	TICKET #	CELL
01	923847	M34M33CELL12LIFT4
WEIGHMASTER		
JAMES F.	DATE/TIME IN	DATE/TIME OUT
05-23-2013	3:53 pm	05-23-2013 4:29 pm
VEHICLE	CONTAINER	
TRUCK		
REFERENCE		
RO24		
BILL OF LADING	INVOICE	

SITE	EAST CAROLINA ENV LANDELL	
AULANDER, NC	27805	242-348-3322
CUSTOMER		
000939	Evo Corporation	
1703 Vargrave Street		
Winston-Salem, NC 27107		
3026138260		

SCALE IN	GROSS WEIGHT	NET TONS	SCALE OUT	TARE WEIGHT	NET WEIGHT	INBOUND
0.00	52,600	10.22	10.22	32,160	20,440	
YD	TRACKING QTY		DESCRIPTION		RATE	EXTENSION
TN	SW-CONT SOIL		PITT			
					TAX	TOTAL

Indemnification. Generator agrees to indemnify, hold harmless, and defend Republic Services of NC, LLC, its subsidiaries, affiliates, employees, officer and directors from and against any and all liabilities, claims, penalties, forfeitures, suits, and cost and expenses incident thereto, including cost of defense, settlement and reasonable attorney's fees, which may be incurred, as a result of death or injuries to any person, or damage to any property contamination of or adverse effect on the undersigned individual signing this document on behalf of Customer acknowledges that he or she has read and understands the terms and conditions on the reverse side and that he or she has the authority to sign this document on behalf of the customer.

NET AMOUNT

TENDERED

CHANGE

CHECK#

SIGNATURE *[Signature]*



NON-HAZARDOUS SPECIAL WASTE & ASBESTOS MANIFEST

7024

483432

If waste is asbestos waste, complete Sections I, II, III and IV
If waste is NOT asbestos waste, complete Sections I, II and III

I. GENERATOR (Generator completes Ia-r)

Form I: Generator information including EPA ID Number, Manifest Document Number, Generator Name and Location, Mailing Address, Phone numbers, Owner's Name, Waste Profile #, Exp. Date, Shipping Description, Containers, Total Quantity, Unit, and Generator's Certification.

II. TRANSPORTER (Generator completes IIa-b and Transporter completes IIc-e)

Form II: Transporter information including Name and Address, Phone, Driver Name, Signature, and Date.

III. DESTINATION (Generator complete IIIa-c and Destination Site completes III d-g)

Form III: Destination information including Disposal Facility and Site Address, US EPA Number, Discrepancy Indication Space, Authorized Agent Name, Signature, and Date.

IV. ASBESTOS (Generator completes IVa-f and Operator complete IVg-i)

Form IV: Asbestos information including Operator's Name and Address, Responsible Agency Name and Address, Special Handling Instructions, Friable/Non-Friable status, Operator's Certification, Operator's Name and Title, Signature, and Date.



NON-HAZARDOUS SPECIAL WASTE & ASBESTOS MANIFEST

483435

If waste is asbestos waste, complete Sections I, II, III and IV
 If waste is NOT asbestos waste, complete Sections I, II and III

I. GENERATOR (Generator completes Ia-r)

a. Generator's US EPA ID Number NC R000165282		b. Manifest Document Number		c. Page 1 of	
d. Generator's Name and Location: Petitioner for DSCA Site #74-0008 205 E. Tenth Street Greensboro, NC 27408			e. Generator's Mailing Address: Petitioner for DSCA Site #74-0008 1648 Mail Services Center Raleigh, NC 27609		
f. Phone: <i>51aw 004</i>			g. Phone: 919-707-8267		
If owner of the generating facility differs from the generator, provide:					
h. Owner's Name:			i. Owner's Phone No.:		
j. Waste Profile # <i>Approval #</i> 8026138260 RB-3739H RT	k. Exp. Date	l. Waste Shipping Name and Description Excavated Soil		m. Containers No. Type	n. Total Quantity 1702
o. Unit Wt/Vol					
GENERATOR'S CERTIFICATION: I hereby certify that the above named material is not a hazardous waste as defined by 40 CFR 261 or any applicable state law, has been properly described, classified and packaged, and is in proper condition for transportation according to applicable regulations; AND, if this waste is a treatment residue of a previously restricted hazardous waste subject to the Land Disposal Restrictions. I certify and warrant that the waste has been treated in accordance with the requirements of 40 CFR 268 and is no longer a hazardous waste as defined by 40 CFR 261.					
p. Generator Authorized Agent Name (Print) <i>Matt Gillis on behalf of</i> Petitioners for DSCA Site #74-0008			q. Signature <i>Matt Gillis</i>		r. Date 5/23/13

II. TRANSPORTER (Generator completes IIa-b and Transporter completes IIc-e)

a. Transporter's Name and Address: EVO Corporation 1703 Vantage Street Winston-Salem, NC 27107 336-735-0944		
b. Phone:		
c. Driver Name (Print) <i>Jim Gharouh</i>	d. Signature <i>[Signature]</i>	e. Date <i>5-23-13</i>

III. DESTINATION (Generator complete IIIa-c and Destination Site completes III d-g)

a. Disposal Facility and Site Address: East Carolina Environmental LP 1872 Republic Road Asheville, NC 27006 b. 352-243-1102		c. US EPA Number N/A	d. Discrepancy Indication Space:
I hereby certify that the above named material has been accepted to the best of my knowledge the foregoing is true and accurate.			
e. Name of Authorized Agent (Print) <i>James Gharouh</i>		f. Signature <i>[Signature]</i>	g. Date <i>5-29-13</i>

IV. ASBESTOS (Generator completes IVa-f and Operator complete IVg-i)

a. Operator's Name and Address:		c. Responsible Agency Name and Address:	
b. Phone:		d. Phone:	
e. Special Handling Instructions and Additional Information:			
f. <input type="checkbox"/> Friable <input type="checkbox"/> Non-Friable <input type="checkbox"/> Both % Friable % Non-Friable			
OPERATOR'S CERTIFICATION: I hereby declare that the contents of this consignment are fully and accurately described above by the proper shipping name and are classified, packaged, marked and labeled/placarded, and are in all respects in proper condition for transport according to applicable international and national governmental regulations.			
g. Operator's Name and Title (Print)		i. Date	
h. Signature		i. Date	
*Operator refers to the company which owns, leases, operates, controls, or supervises the facility being demolished or renovated, or the demolition or renovation operation or both			



NON-HAZARDOUS SPECIAL WASTE & ASBESTOS MANIFEST

208
07741

483439

If waste is asbestos waste, complete Sections I, II, III and IV
If waste is NOT asbestos waste, complete Sections I, II and III

I. GENERATOR (Generator completes la-r)

a. Generator's US EPA ID Number NC0000160382		b. Manifest Document Number		c. Page 1 of	
d. Generator's Name and Location: Partner for DSCA Site #74-0008 210 E. Tenth Street Greensboro, NC 27402			e. Generator's Mailing Address: Partner for DSCA Site #74-0008 1200 Main Service Center Raleigh, NC 27609		
f. Phone:			g. Phone: 919-707-0367		
If owner of the generating facility differs from the generator, provide:					
h. Owner's Name:			i. Owner's Phone No.:		
j. Waste Profile # Approval # 3826138260 EVO-904		k. Exp. Date	l. Waste Shipping Name and Description Styrofoam		o. Unit Wt/Vol 11.28
m. Containers No.		n. Total Quantity		o. Unit Wt/Vol	
GENERATOR'S CERTIFICATION: I hereby certify that the above named material is not a hazardous waste as defined by 40 CFR 261 or any applicable state law, has been properly described, classified and packaged, and is in proper condition for transportation according to applicable regulations; AND, If this waste is a treatment residue of a previously restricted hazardous waste subject to the Land Disposal Restrictions. I certify and warrant that the waste has been treated in accordance with the requirements of 40 CFR 268 and is no longer a hazardous waste as defined by 40 CFR 261.					
p. Generator Authorized Agent Name (Print) Next on his behalf of Petitioners for DSCA site #74-0008 Matt New				q. Signature Matt New	
r. Date				5/24/13	

II. TRANSPORTER (Generator completes IIa-b and Transporter completes IIc-e)

a. Transporter's Name and Address: EVO Corporation 1703 Vergrava Street Winston Salem, NC 27107		b. Phone: 336-735-5811	
c. Driver Name (Print) Jim Glanovsky		d. Signature Jim Glanovsky	
e. Date		5-24-13	

III. DESTINATION (Generator complete IIIa-c and Destination Site completes IIId-g)

a. Disposal Facility and Site Address: East Carolina Environmental LP 1912 Republican Road Auburn, NC 27003		b. US EPA Number	d. Discrepancy Indication Space:
I hereby certify that the above named material has been accepted and to the best of my knowledge the foregoing is true and accurate.			
e. Name of Authorized Agent (Print) James Goble		f. Signature James Goble	
g. Date		5-24-13	

IV. ASBESTOS (Generator completes IVa-f and Operator complete IVg-i)

a. Operator's Name and Address:		c. Responsible Agency Name and Address:	
b. Phone:		d. Phone:	
e. Special Handling Instructions and Additional Information:			
f. <input type="checkbox"/> Friable <input type="checkbox"/> Non-Friable <input type="checkbox"/> Both % Friable % Non-Friable			
OPERATOR'S CERTIFICATION: I hereby declare that the contents of this consignment are fully and accurately described above by the proper shipping name and are classified, packaged, marked and labeled/placarded, and are in all respects in proper condition for transport according to applicable international and national governmental regulations.			
g. Operator's Name and Title (Print)		h. Signature	
i. Date			
*Operator refers to the company which owns, leases, operates, controls, or supervises the facility being demolished or renovated, or the demolition or renovation operation or both			

SITE EAST CAROLINA ENV LANDEFILL
 AULANDER, NC 27805 242-348-3322

CUSTOMER
 000939
 Evo Corporation
 1703 Vargrave Street
 Winston-Salem, NC 27107
 3026138260

TICKET # 923925
 CELL M34M33CELL12LIFT4

WEIGHMASTER
 JAMES E.
 DATE/TIME IN 05-24-2013 11:02 am
 DATE/TIME OUT 05-24-2013 11:26 am

VEHICLE CONTAINER
 TRUCK
 REFERENCE 07741

BILL OF LADING INVOICE

SCALE IN GROSS WEIGHT 62,620 NET TONS 11.28
 SCALE OUT TARE WEIGHT 40,060 NET WEIGHT 22,560 INBOUND

QTY	UNIT	DESCRIPTION	RATE	EXTENSION	TAX	TOTAL
0.00	YD	TRACKING QTY				
11.28	TN	SW-CONT SOIL				
		PITT				

Indemnification. Generator agrees to indemnify, hold harmless, and defend Republic Services of NC, LLC, its subsidiaries, affiliates, employees, officer and directors from and against any and all liabilities, claims, penalties, forfeitures, suits, and cost and expenses incident thereto, including cost of defense, settlement and reasonable attorney's fees, which may be incurred, as a result of death or injuries to any person, or damage to any property contamination of or adverse effect on the undersigned individual signing this document on behalf of Customer acknowledges that he or she has read and understands the terms and conditions on the reverse side and that he or she has the authority to sign this document on behalf of the customer.

NET AMOUNT

TENDERED

CHANGE

CHECK#

SIGNATURE *James E. ...*



NON-HAZARDOUS SPECIAL WASTE & ASBESTOS MANIFEST

R024

483438

If waste is asbestos waste, complete Sections I, II, III and IV
If waste is NOT asbestos waste, complete Sections I, II and III

I. GENERATOR (Generator completes Ia-r)

Form I: Generator information including EPA ID, manifest number, name, address, phone, waste profile, and certification.

II. TRANSPORTER (Generator completes IIa-b and Transporter completes IIc-e)

Form II: Transporter information including name, address, driver name, signature, and date.

III. DESTINATION (Generator complete IIIa-c and Destination Site completes III d-g)

Form III: Destination information including disposal facility address, EPA number, and agent details.

IV. ASBESTOS (Generator completes IVa-f and Operator complete IVg-i)

Form IV: Asbestos handling information including operator name, agency name, friability, and certification.

SITE EAST CAROLINA ENV LANDFILL
CUSTOMER AULANDER, NC 27805 242-348-3322
 000939
 Evo Corporation
 1703 Vargrave Street
 Winston-Salem, NC 27107
 3026138260

SITE 01 **TICKET #** 923926 **CELL** M34M33CELL12LIFT4
WEIGHMASTER
JAMES F.
DATE/TIME IN 05-24-2013 11:03 am **DATE/TIME OUT** 05-24-2013 11:28 am
VEHICLE TRUCK **CONTAINER**
REFERENCE RO24 **INVOICE**
BILL OF LADING

SCALE IN GROSS WEIGHT 58,080 NET TONS 12.98
 SCALE OUT TARE WEIGHT 32,120 NET WEIGHT 25,960 INBOUND

QTY	UNIT	DESCRIPTION	RATE	EXTENSION	TAX	TOTAL
0.00	YD	TRACKING QTY				
12.98	TN	SW-CONT SOIL				
		PITT				

NET AMOUNT
TENDERED
CHANGE
CHECK#

Indemnification. Generator agrees to indemnify, hold harmless, and defend Republic Services of NC, LLC, its subsidiaries, affiliates, employees, officer and directors from and against any and all liabilities, claims, penalties, forfeitures, suits, and cost and expenses incident thereto, including cost of defense, settlement and reasonable attorney's fees, which may be incurred, as a result of death or injuries to any person, or damage to any property contamination of or adverse effect on The undersigned individual signing this document on behalf of Customer acknowledges that he or she has read and understands the terms and conditions on the reverse side and that he or she has the authority to sign this document on behalf of the customer.

RS-F042UPR (07/12) 2/21 SIGNATURE *Jim May*



NON-HAZARDOUS SPECIAL WASTE & ASBESTOS MANIFEST

483436

If waste is asbestos waste, complete Sections I, II, III and IV
If waste is NOT asbestos waste, complete Sections I, II and III

I. GENERATOR (Generator completes Ia-r)

a. Generator's US EPA ID Number NC R000150382		b. Manifest Document Number		c. Page 1 of	
d. Generator's Name and Location: Petitioner for DSCA Site # 74-0008 205 E. Tenth Street Greensboro, NC 27408 <i>Slaw 004</i>			e. Generator's Mailing Address: Petitioner for DSCA Site #74-0008 1046 Mail Service Center Raleigh, NC 27608		
f. Phone:			g. Phone: 919-707-5367		
If owner of the generating facility differs from the generator, provide:					
h. Owner's Name:			i. Owner's Phone No.:		
j. Waste Profile # <i>Approval #</i> 3026138260 RB-37390-RT	k. Exp. Date	l. Waste Shipping Name and Description Excavated Soil		m. Containers No. Type	n. Total Quantity 962
o. Unit Wt/Vol					
GENERATOR'S CERTIFICATION: I hereby certify that the above named material is not a hazardous waste as defined by 40 CFR 261 or any applicable state law, has been properly described, classified and packaged, and is in proper condition for transportation according to applicable regulations; AND, if this waste is a treatment residue of a previously restricted hazardous waste subject to the Land Disposal Restrictions. I certify and warrant that the waste has been treated in accordance with the requirements of 40 CFR 268 and is no longer a hazardous waste as defined by 40 CFR 261.					
p. Generator Authorized Agent Name (Print) <i>Matt Gillis on behalf of Petitioner for DSCA site #74-0008</i>			q. Signature <i>Matthew Gillis</i>		r. Date 5/23/13

II. TRANSPORTER (Generator completes IIa-b and Transporter completes IIc-e)

a. Transporter's Name and Address: EVO Corporation 4700 Margrave Street Winston-Salem, NC 27107 336-726-6844		
b. Phone:		
c. Driver Name (Print) <i>Tim L Myers</i>	d. Signature <i>Tim L Myers</i>	e. Date 5-28-13

III. DESTINATION (Generator complete IIIa-c and Destination Site completes III d-g)

a. Disposal Facility and Site Address: East Carolina Environmental LLC 1822 Republican Road Arlender, NC 27805 b. 252-348-8202		c. US EPA Number N/A	d. Discrepancy Indication Space:
I hereby certify that the above named material has been accepted and to the best of my knowledge the foregoing is true and accurate.			
e. Name of Authorized Agent (Print) <i>James Greathouse</i>		f. Signature <i>James Greathouse</i>	g. Date 5-29-13

IV. ASBESTOS (Generator completes IVa-f and Operator complete IVg-i)

a. Operator's Name and Address:		c. Responsible Agency Name and Address:	
b. Phone:		d. Phone:	
e. Special Handling Instructions and Additional Information:			
f. <input type="checkbox"/> Friable <input type="checkbox"/> Non-Friable <input type="checkbox"/> Both % Friable % Non-Friable			
OPERATOR'S CERTIFICATION: I hereby declare that the contents of this consignment are fully and accurately described above by the proper shipping name, and are classified, packaged, marked and labeled/placarded, and are in all respects in proper condition for transport according to applicable international and national governmental regulations.			
g. Operator's Name and Title (Print)		h. Signature	
		i. Date	
*Operator refers to the company which owns, leases, operates, controls, or supervises the facility being demolished or renovated, or the demolition or renovation operation or both			



NON-HAZARDOUS SPECIAL WASTE & ASBESTOS MANIFEST

483443

If waste is asbestos waste, complete Sections I, II, III and IV
 If waste is **NOT** asbestos waste, complete Sections I, II and III

I. GENERATOR (Generator completes la-r)

a. Generator's US EPA ID Number NCR000156352		b. Manifest Document Number		c. Page 1 of	
d. Generator's Name and Location: Petitioner for DSCA Site #74-0008 303 E. Tenth Street Greensboro, NC 27808		e. Generator's Mailing Address: Petitioner for DSCA Site #74-0008 1000 Main Building Center Raleigh, NC 27609			
f. Phone:		g. Phone: 919.707.8267			
If owner of the generating facility differs from the generator, provide:					
h. Owner's Name:			i. Owner's Phone No.:		
j. Waste Profile # Approval # 3826138260 BKRU-025917	k. Exp. Date	l. Waste Shipping Name and Description Evaporated Sol		m. Containers No. Type 001 reloff	n. Total Quantity 12.39
o. Unit Wt/Vol					
GENERATOR'S CERTIFICATION: I hereby certify that the above named material is not a hazardous waste as defined by 40 CFR 261 or any applicable state law, has been properly described, classified and packaged, and is in proper condition for transportation according to applicable regulations; AND, if this waste is a treatment residue of a previously restricted hazardous waste subject to the Land Disposal Restrictions. I certify and warrant that the waste has been treated in accordance with the requirements of 40 CFR 268 and is no longer a hazardous waste as defined by 40 CFR 261.					
p. Generator Authorized Agent Name (Print) Matt Gillis on behalf of petitioners for DSCA site #74-0008				q. Signature MATT GILLIS	
				r. Date 5/28/13	

II. TRANSPORTER (Generator completes IIa-b and Transporter completes IIc-e)

a. Transporter's Name and Address: EVO Corporation 1703 Morgans Street Winston-Salem, NC 27107		b. Phone: 336.726.5644	
c. Driver Name (Print) Jim Glanovsky		d. Signature Jim Glanovsky	
		e. Date 4-28-13	

III. DESTINATION (Generator complete IIIa-c and Destination Site completes IIId-g)

a. Disposal Facility and Site Address: East Carolina Environmental LF 1502 Republican Road Aurander, NC 27805	b. US EPA Number N/A	d. Discrepancy Indication Space:	
c. US EPA Number			
I hereby certify that the above named material has been accepted and to the best of my knowledge the foregoing is true and accurate.			
e. Name of Authorized Agent (Print) James Overholt		f. Signature James Overholt	
		g. Date 5-28-13	

IV. ASBESTOS (Generator completes IVa-f and Operator complete IVg-l)

a. Operator's Name and Address:		c. Responsible Agency Name and Address:	
b. Phone:		d. Phone:	
e. Special Handling Instructions and Additional Information:			
f. <input type="checkbox"/> Friable <input type="checkbox"/> Non-Friable <input type="checkbox"/> Both % Friable % Non-Friable			
OPERATOR'S CERTIFICATION: I hereby declare that the contents of this consignment are fully and accurately described above by the proper shipping name and are classified, packaged, marked and labeled/placarded, and are in all respects in proper condition for transport according to applicable international and national governmental regulations.			
g. Operator's Name and Title (Print)		h. Signature	
		i. Date	
*Operator refers to the company which owns, leases, operates, controls, or supervises the facility being demolished or renovated, or the demolition or renovation operation or both			

EAST CAROLINA ENV LANDELL
 AULANDER, NC 27805 242-348-3322
 CUSTOMER
 000939
 Evo Corporation
 1703 Vargrave Street
 Winston-Salem, NC 27107
 3026138260

TICKET # 924173 CELL M34M33CELL12LIFT4
 WEIGHMASTER
 JAMES F.
 DATE/TIME IN 05-28-2013 10:44 am DATE/TIME OUT 11-11-11 at
 VEHICLE CONTAINER
 TRUCK
 REFERENCE INVOICE
 BILL OF LADING

SCALE IN GROSS WEIGHT 67,160 NET TONS 12.39
 SCALE OUT TARE WEIGHT 42,380 NET WEIGHT 24,780 INBOUND

QTY	UNIT	DESCRIPTION	RATE	EXTENSION
0.00	YD	TRACKING QTY		
12.39	TN	SW-CONT SOIL		
		PITT		

Indemnification. Generator agrees to indemnify, hold harmless, and defend Republic Services of NC, LLC, its subsidiaries, affiliates, employees, officer and directors from and against any and all liabilities, claims, penalties, forfeitures, suits, and cost and expenses incident thereto, including cost of defense, settlement and reasonable attorney's fees, which may be incurred, as a result of death or injuries to any person, or damage to any property, so long as the Generator is not negligent. The undersigned individual signing this document on behalf of the customer acknowledges the terms and conditions on the reverse side and that he or she has the authority to sign this document on behalf of the customer.

NET AMOUNT
 TENDERED
 CHANGE
 CHECK#

RS-F042UPR (07/12) 2/21

SIGNATURE



NON-HAZARDOUS SPECIAL WASTE & ASBESTOS MANIFEST

483446

If waste is asbestos waste, complete Sections I, II, III and IV
If waste is NOT asbestos waste, complete Sections I, II and III

I. GENERATOR (Generator completes Ia-r)

Form I: Generator information including US EPA ID Number, Manifest Document Number, Generator Name and Location, Mailing Address, Phone, Owner's Name, Waste Profile #, Exp. Date, Shipping Name and Description, Containers, Total Quantity, Unit, and Generator's Certification.

II. TRANSPORTER (Generator completes IIa-b and Transporter completes IIc-e)

Form II: Transporter information including Name and Address, Phone, Driver Name, Signature, and Date.

III. DESTINATION (Generator complete IIIa-c and Destination Site completes IIId-g)

Form III: Destination information including Disposal Facility and Site Address, US EPA Number, Discrepancy Indication Space, Authorized Agent Name, Signature, and Date.

IV. ASBESTOS (Generator completes IVa-f and Operator complete IVg-i)

Form IV: Asbestos information including Operator's Name and Address, Responsible Agency Name and Address, Special Handling Instructions, Friable/Non-Friable status, Operator's Certification, Operator's Name and Title, Signature, and Date.

SITE		TICKET #	CELL
01		924225	M34M33CELL12LIET4
WEIGHMASTER			
JAMES F.			
DATE/TIME IN	DATE/TIME OUT		
05-28-2013 1:55 pm	05-28-2013 2:31 pm		
VEHICLE		CONTAINER	
TRUCK			
REFERENCE		INVOICE	
07741			
BILL OF LADING			

SITE		EAST CAROLINA ENV LANDFILL	
CUSTOMER		AULANDER, NC 27805 242-348-3322	
000939			
Evo Corporation			
1703 Vargrave Street			
Winston-Salem, NC 27107			
3026138260			

SCALE IN	GROSS WEIGHT	NET TONS	NET WEIGHT	INBOUND
SCALE OUT	TARE WEIGHT			
	42,280	11.62	23,240	
0.00 YD	TRACKING QTY			
11.62 TN	SW-CONT SOIL			
	PITT			

Indemnification. Generator agrees to indemnify, hold harmless, and defend Republic Services of NC, LLC, its subsidiaries, affiliates, employees, officer and directors from and against any and all liabilities, claims, penalties, forfeitures, suits, and cost and expenses incident thereto, including cost of defense, settlement and reasonable attorney's fees, which may be incurred, as a result of death or injuries to any person or damage to any property contained on or adjacent to the site. The undersigned individual signing this document acknowledges that he or she has read and understands the terms and conditions on the reverse side and that he or she has the authority to sign this document on behalf of the customer.

NET AMOUNT

TENDERED

CHANGE

CHECK#

SIGNATURE *[Signature]*



NON-HAZARDOUS SPECIAL WASTE & ASBESTOS MANIFEST

0744

483440

If waste is asbestos waste, complete Sections I, II, III and IV
If waste is NOT asbestos waste, complete Sections I, II and III

I. GENERATOR (Generator completes la-r)

Form I: Generator information including EPA ID, manifest number, name, location, mailing address, phone numbers, and waste profile details.

II. TRANSPORTER (Generator completes IIa-b and Transporter completes IIc-e)

Form II: Transporter information including name, address, phone, driver name, signature, and date.

III. DESTINATION (Generator complete IIIa-c and Destination Site completes III d-g)

Form III: Destination information including disposal facility address, EPA number, discrepancy space, and authorized agent details.

IV. ASBESTOS (Generator completes IVa-f and Operator complete IVg-i)

Form IV: Asbestos information including operator name, responsible agency, special handling instructions, friability, and operator certification.

SITE EAST CAROLINA ENV LANDFILL
 AULANDER, NC 27805 242-348-3322
 CUSTOMER
 000939
 Evo Corporation
 1703 Vargrave Street
 Winston-Salem, NC 27107
 3026138260

TICKET # 924135
 CELL M34M33CELL12LIFT4
 WEIGHMASTER
 JAMES E.
 DATE/TIME IN 05-28-2013 7:39 am
 DATE/TIME OUT 05-28-2013 8:08 am
 VEHICLE TRUCK
 CONTAINER
 REFERENCE 07741
 INVOICE
 BILL OF LADING

SCALE IN	GROSS WEIGHT	NET TONS
SCALE OUT	TARE WEIGHT	NET WEIGHT
	67,800	12.53
	42,740	25,060

QTY	UNIT	DESCRIPTION	RATE	EXTENSION	TOTAL
0.00	YD	TRACKING QTY			
12.53	TN	SW-CONT SOIL			
		PITT			

Indemnification. Generator agrees to indemnify, hold harmless, and defend Republic Services of NC, LLC, its subsidiaries, affiliates, employees, officer and directors from and against any and all liabilities, claims, penalties, forfeitures, suits, and cost and expenses incident thereto, including cost of defense, settlement and reasonable attorney's fees, which may be incurred, as a result of death or injuries to any person, or damage to any property contamination of or adverse effect on the reverse side and that he or she has the authority to sign this document on behalf of the customer.

The undersigned individual signing this document on behalf of Customer acknowledges that he or she has read and understands the terms and conditions on the reverse side and that he or she has the authority to sign this document on behalf of the customer.

NET AMOUNT
 TENDERED
 CHANGE
 CHECK#

SIGNATURE *Jim Dull*



NON-HAZARDOUS SPECIAL WASTE & ASBESTOS MANIFEST

R021

483441

If waste is asbestos waste, complete Sections I, II, III and IV
If waste is NOT asbestos waste, complete Sections I, II and III

I. GENERATOR (Generator completes Ia-r)

Form I: Generator information including EPA ID, manifest number, name, location, mailing address, phone, owner details, waste profile, and shipping description.

GENERATOR'S CERTIFICATION: I hereby certify that the above named material is not a hazardous waste as defined by 40 CFR 261 or any applicable state law, has been properly described, classified and packaged, and is in proper condition for transportation according to applicable regulations; AND, if this waste is a treatment residue of a previously restricted hazardous waste subject to the Land Disposal Restrictions. I certify and warrant that the waste has been treated in accordance with the requirements of 40 CFR 268 and is no longer a hazardous waste as defined by 40 CFR 261.

Form I continuation: Agent name, signature, and date.

II. TRANSPORTER (Generator completes IIa-b and Transporter completes IIc-e)

Form II: Transporter information including name, address, phone, driver name, signature, and date.

III. DESTINATION (Generator complete IIIa-c and Destination Site completes III d-g)

Form III: Destination information including facility address, EPA number, discrepancy space, agent name, signature, and date.

IV. ASBESTOS (Generator completes IVa-f and Operator complete IVg-i)

Form IV: Asbestos information including operator name, responsible agency, friability, operator certification, and signature.

SITE EAST CAROLINA ENV LANDFILL
 AULANDER, NC 27805 242-348-3522
 CUSTOMER
 000939
 Evo Corporation
 1703 Vargrave Street
 Winston-Salem, NC 27107
 3026138260

TICKET # 924136 CELL M34M33CELL12LIFT4
 WEIGHMASTER
 JAMES E.
 DATE/TIME IN 05-28-2013 7:41 am DATE/TIME OUT 05-28-2013 8:10 am
 VEHICLE TRUCK CONTAINER
 REFERENCE ROZ4
 BILL OF LADING INVOICE

SCALE IN	GROSS WEIGHT	NET TONS	NET WEIGHT	INBOUND
SCALE OUT	53,960	10.30	20,600	
	TARE WEIGHT			
	33,360			
UNIT	DESCRIPTION	RATE	EXTENSION	TAX
0.00	YD TRACKING QTY			
10.30	TN SW-CONT SOIL			
	PITT			

Indemnification. Generator agrees to indemnify, hold harmless, and defend Republic Services of NC, LLC, its subsidiaries, affiliates, employees, officer and directors from and against any and all liabilities, claims, penalties, forfeitures, suits, and cost and expenses incident thereto, including cost of defense, settlement and reasonable attorney's fees, which may be incurred, as a result of death or injuries to any person, or damage to any property contamination of or adverse effect on The undersigned individual signing this document on behalf of Customer acknowledges that he or she has read and understands the terms and conditions on the reverse side and that he or she has the authority to sign this document on behalf of the customer.

NET AMOUNT
 TENDERED
 CHANGE
 CHECK#

RS-F042UPR (07/12) 2/11 SIGNATURE *[Signature]*



NON-HAZARDOUS SPECIAL-WASTE & ASBESTOS MANIFEST

2

483442

If waste is asbestos waste, complete Sections I, II, III and IV
If waste is NOT asbestos waste, complete Sections I, II and III

I. GENERATOR (Generator completes Ia-r)

Form I: Generator information including EPA ID, manifest number, name, location, mailing address, phone, and waste profile details.

II. TRANSPORTER (Generator completes IIa-b and Transporter completes IIc-e)

Form II: Transporter information including name, address, phone, driver name, signature, and date.

III. DESTINATION (Generator complete IIIa-c and Destination Site completes III d-g)

Form III: Destination information including disposal facility address, EPA number, discrepancy space, and authorized agent details.

IV. ASBESTOS (Generator completes IVa-f and Operator complete IVg-i)

Form IV: Asbestos handling information including operator name, responsible agency, friability, and operator certification.



NON-HAZARDOUS SPECIAL WASTE & ASBESTOS MANIFEST

483444

If waste is asbestos waste, complete Sections I, II, III and IV
If waste is NOT asbestos waste, complete Sections I, II and III

I. GENERATOR (Generator completes Ia-r)

a. Generator's US EPA ID Number NC 9000166103		b. Manifest Document Number		c. Page 1 of	
d. Generator's Name and Location: Petting for DSCA Site #74-0008 205 E. Tech Road Greenville, NC 27836			e. Generator's Mailing Address: Petitioner for DSCA Site #74-0008 1140 West Service Center Raleigh, NC 27609		
f. Phone:			g. Phone: 919-707-8037		
If owner of the generating facility differs from the generator, provide:					
h. Owner's Name:			i. Owner's Phone No.:		
j. Waste Profile # Approval # 38201382600		k. Exp. Date	l. Waste Shipping Name and Description		m. Containers No. Type
RB-37389-RT			Evaporated Sol.		001 RD 10.71

GENERATOR'S CERTIFICATION: I hereby certify that the above named material is not a hazardous waste as defined by 40 CFR 261 or any applicable state law, has been properly described, classified and packaged, and is in proper condition for transportation according to applicable regulations; AND, if this waste is a treatment residue of a previously restricted hazardous waste subject to the Land Disposal Restrictions. I certify and warrant that the waste has been treated in accordance with the requirements of 40 CFR 268 and is no longer a hazardous waste as defined by 40 CFR 261.

p. Generator Authorized Agent Name (Print) Matt Grims on behalf of Petitioners for DSCA Site 74-0008		q. Signature Matt Grims		r. Date 5/28/13	
---	--	----------------------------	--	--------------------	--

II. TRANSPORTER (Generator completes IIa-b and Transporter completes IIc-e)

a. Transporter's Name and Address: EVO Corporation 1700 Vargrave Street Winston-Salem, NC 27107 373-722-6674			
b. Phone:			
c. Driver Name (Print) Tim L Myers		d. Signature Tim L Myers	e. Date 5-28-13

III. DESTINATION (Generator complete IIIa-c and Destination Site completes III d-g)

a. Disposal Facility and Site Address: East Carolina Environmental LE 1802 Republican Road Anderson, NC 27804 b. EPA ID # 4002		c. US EPA Number N/A	d. Discrepancy Indication Space:
I hereby certify that the above named material has been accepted and to the best of my knowledge the foregoing is true and accurate.			
e. Name of Authorized Agent (Print) James Everett		f. Signature James Everett	g. Date 5-28-13

IV. ASBESTOS (Generator completes IVa-f and Operator complete IVg-i)

a. Operator's Name and Address:		c. Responsible Agency Name and Address:	
b. Phone:		d. Phone:	
e. Special Handling Instructions and Additional Information:			
f. <input type="checkbox"/> Friable <input type="checkbox"/> Non-Friable <input type="checkbox"/> Both % Friable % Non-Friable			
OPERATOR'S CERTIFICATION: I hereby declare that the contents of this consignment are fully and accurately described above by the proper shipping name and are classified, packaged, marked and labeled/placarded, and are in all respects in proper condition for transport according to applicable international and national governmental regulations.			
g. Operator's Name and Title (Print)		h. Signature	i. Date
*Operator refers to the company which owns, leases, operates, controls, or supervises the facility being demolished or renovated, or the demolition or renovation operation or both			

SITE EAST CAROLINA ENV LANDFILL
 AULANDER, NC 27805 242-348-3322
 CUSTOMER
 000939
 Evo Corporation
 1703 Vargrave Street
 Winston-Salem, NC 27107
 3026138260

SITE 01 TICKET # 924227 CELL M34M33CELL12LIFT4
 WEIGHMASTER
 JAMES E.
 DATE/TIME IN 05-28-2013 1:56 pm DATE/TIME OUT 05-28-2013 2:34 pm
 VEHICLE TRUCK CONTAINER
 TRUCK
 REFERENCE 024 INVOICE
 BILL OF LADING

SCALE IN GROSS WEIGHT 55,140 NET TONS 10.71
 SCALE OUT TARE WEIGHT 33,720 NET WEIGHT 21,420 INBOUND

QTY	UNIT	DESCRIPTION	RATE	EXTENSION	TAX	TOTAL
0.00	YD	TRACKING QTY				
10.71	TN	SW-CONT SOIL				
		PITT				

NET AMOUNT
TENDERED
CHANGE
CHECK#

Indemnification. Generator agrees to indemnify, hold harmless, and defend Republic Services of NC, LLC, its subsidiaries, affiliates, employees, officer and directors from and against any and all liabilities, claims, penalties, forfeitures, suits, and cost and expenses incident thereto, including cost of defense, settlement and reasonable attorney's fees, which may be incurred, as a result of death or injuries to any person, or damage to any property containing or arising from the use of the waste at the site. The undersigned individual signing this document on behalf of the customer acknowledges the terms and conditions on the reverse side and that he or she has the authority to sign this document on behalf of the customer.

SIGNATURE John M...



NON-HAZARDOUS SPECIAL WASTE & ASBESTOS MANIFEST

2

483447

If waste is asbestos waste, complete Sections I, II, III and IV
If waste is **NOT** asbestos waste, complete Sections I, II and III

I. GENERATOR (Generator completes Ia-r)

a. Generator's US EPA ID Number NC0000196253		b. Manifest Document Number		c. Page 1 of	
d. Generator's Name and Location: Petitioner for DSCA Site #74-0008 205 E. Tenth Street Greenville, NC 27838			e. Generator's Mailing Address: Petitioner for DSCA Site #74-0008 1048 Wall Service Center Raleigh, NC 27609		
f. Phone: <i>slaw 004</i>			g. Phone: 919-707-2357		
If owner of the generating facility differs from the generator, provide:					
h. Owner's Name:			i. Owner's Phone No.:		
j. Waste Profile # <i>Approval #</i> <i>3826138260</i> <i>EVO-908</i>		k. Exp. Date	l. Waste Shipping Name and Description <i>Excavated Soil</i>		m. Containers No. Type <i>801 RD</i>
					n. Total Quantity <i>10-10</i>
					o. Unit Wt/Vol
GENERATOR'S CERTIFICATION: I hereby certify that the above named material is not a hazardous waste as defined by 40 CFR 261 or any applicable state law, has been properly described, classified and packaged, and is in proper condition for transportation according to applicable regulations; AND, if this waste is a treatment residue of a previously restricted hazardous waste subject to the Land Disposal Restrictions. I certify and warrant that the waste has been treated in accordance with the requirements of 40 CFR 268 and is no longer a hazardous waste as defined by 40 CFR 261.					
p. Generator Authorized Agent Name (Print) <i>Mark Gatto on behalf of</i> <i>Petitioners for DSCA site #74-0008</i>			q. Signature <i>Mark Gatto</i>		r. Date <i>5/29/13</i>

II. TRANSPORTER (Generator completes IIa-b and Transporter completes IIc-e)

a. Transporter's Name and Address: EVO Corporation 1700 Vantage Street Winston-Salem, NC 27107		
b. Phone: 336-725-5844		
c. Driver Name (Print) <i>Tim L Myers</i>	d. Signature <i>Tim L Myers</i>	e. Date <i>5-29-13</i>

III. DESTINATION (Generator complete IIIa-c and Destination Site completes IIId-g)

a. Disposal Facility and Site Address: East Carolina Environmental LF 1922 Republican Road Greenville, NC 27835		b. US EPA Number EVA	c. US EPA Number	d. Discrepancy Indication Space:
I hereby certify that the above named material has been accepted and to the best of my knowledge the foregoing is true and accurate.				
e. Name of Authorized Agent (Print)		f. Signature		g. Date

IV. ASBESTOS (Generator completes IVa-f and Operator complete IVg-i)

a. Operator's Name and Address:		c. Responsible Agency Name and Address:	
b. Phone:		d. Phone:	
e. Special Handling Instructions and Additional Information:			
f. <input type="checkbox"/> Friable <input type="checkbox"/> Non-Friable <input type="checkbox"/> Both % Friable % Non-Friable			
OPERATOR'S CERTIFICATION: I hereby declare that the contents of this consignment are fully and accurately described above by the proper shipping name and are classified, packaged, marked and labeled/placarded, and are in all respects in proper condition for transport according to applicable international and national governmental regulations.			
g. Operator's Name and Title (Print)		h. Signature	i. Date
*Operator refers to the company which owns, leases, operates, controls, or supervises the facility being demolished or renovated, or the demolition or renovation operation or both			



NON-HAZARDOUS SPECIAL WASTE & ASBESTOS MANIFEST

483448

If waste is asbestos waste, complete Sections I, II, III and IV
 If waste is **NOT** asbestos waste, complete Sections I, II and III

I. GENERATOR (Generator completes Ia-r)

a. Generator's US EPA ID Number NC R000106383		b. Manifest Document Number		c. Page 1 of	
d. Generator's Name and Location: Partners for DSCA Sites #74-008 3% E Tenth Street Greenville, NC 27833			e. Generator's Mailing Address: Partners for DSCA Sites #74-008 1249 Mail Service Center Raleigh, NC 27608		
f. Phone: <i>glaw 004</i>			g. Phone: 919-707-2337		
If owner of the generating facility differs from the generator, provide:					
h. Owner's Name:			i. Owner's Phone No.:		
j. Waste Profile # <i>Approval #</i> 3826138260 RB-37387-RT		k. Exp. Date	l. Waste Shipping Name and Description Generated Soil		o. Unit Wt/Vol
			m. Containers No. Type 001 20		n. Total Quantity 11.57
GENERATOR'S CERTIFICATION: I hereby certify that the above named material is not a hazardous waste as defined by 40 CFR 261 or any applicable state law, has been properly described, classified and packaged, and is in proper condition for transportation according to applicable regulations; AND, if this waste is a treatment residue of a previously restricted hazardous waste subject to the Land Disposal Restrictions. I certify and warrant that the waste has been treated in accordance with the requirements of 40 CFR 268 and is no longer a hazardous waste as defined by 40 CFR 261.					
p. Generator Authorized Agent Name (Print) <i>Matt Gillis on behalf of Partners for DSCA site # 74-008</i>			q. Signature <i>Matt Gillis</i>		r. Date 5/29/13

II. TRANSPORTER (Generator completes IIa-b and Transporter completes IIc-e)

a. Transporter's Name and Address: EVO Corporation 1700 Vantage Street Winston-Salem, NC 27107 336-735-8844		
b. Phone:		
c. Driver Name (Print) <i>Jim Glanovsky</i>	d. Signature <i>Jim Glanovsky</i>	e. Date 5-29-13

III. DESTINATION (Generator complete IIIa-c and Destination Site completes III d-g)

a. Disposal Facility and Site Address: East Carolina Environmental LP 1930 Republican Road Greenville, NC 27833		b. US EPA Number N/A	d. Discrepancy Indication Space:
I hereby certify that the above named material has been accepted and to the best of my knowledge the foregoing is true and accurate.			
e. Name of Authorized Agent (Print) <i>JAMES GREAT</i>		f. Signature <i>James Great</i>	g. Date 5-29-13

IV. ASBESTOS (Generator completes IVa-f and Operator complete IVg-i)

a. Operator's Name and Address:		c. Responsible Agency Name and Address:	
b. Phone:		d. Phone:	
e. Special Handling Instructions and Additional Information:			
f. <input type="checkbox"/> Friable <input type="checkbox"/> Non-Friable <input type="checkbox"/> Both % Friable % Non-Friable			
OPERATOR'S CERTIFICATION: I hereby declare that the contents of this consignment are fully and accurately described above by the proper shipping name and are classified, packaged, marked and labeled/placarded, and are in all respects in proper condition for transport according to applicable international and national governmental regulations.			
g. Operator's Name and Title (Print)		i. Date	
h. Signature			
*Operator refers to the company which owns, leases, operates, controls, or supervises the facility being demolished or renovated, or the demolition or renovation operation or both			

SITE	01	TICKET #	924295	CELL	M34M33CELL12LIIFT4
WEIGHMASTER					
JAMES E.					
DATE/TIME IN	05-29-2013	8:25 am	DATE/TIME OUT	05-29-2013	9:18 am
VEHICLE	TRUCK		CONTAINER		
REFERENCE	INVOICE				
BILL OF LADING					

SITE	EAST CAROLINA ENV LANDFILL				
AULANDER, NC	27805	242-348-3322			
CUSTOMER	000939				
Evo Corporation	1703 Vargrave Street				
Winston-Salem, NC	27107				
3026138260					

SCALE IN	GROSS WEIGHT	NET TONS	NET WEIGHT	INBOUND
SCALE OUT	72,960	11.57	23,140	

QTY	UNIT	DESCRIPTION	RATE	EXTENSION	TAX	TOTAL
0.00	YD	TRACKING QTY				
11.57	TN	SW-CONT SOIL				
		PITT				

NET AMOUNT
TENDERED
CHANGE
CHECK#

Indemnification. Generator agrees to indemnify, hold harmless, and defend Republic Services of NC, LLC, its subsidiaries, affiliates, employees, officer and directors from and against any and all liabilities, claims, penalties, forfeitures, suits, and cost and expenses incident thereto, including cost of defense, settlement and reasonable attorney's fees, which may be incurred, as a result of death or injuries to any person, or damage to any property contamination of or adverse effect on the reverse side and that he or she has the authority to sign this document on behalf of the customer.

The undersigned individual signing this document on behalf of Customer acknowledges that he or she has read and understands the terms and conditions on the reverse side and that he or she has the authority to sign this document on behalf of the customer.

James E. [Signature]



NON-HAZARDOUS SPECIAL WASTE & ASBESTOS MANIFEST

483450

If waste is asbestos waste, complete Sections I, II, III and IV
If waste is NOT asbestos waste, complete Sections I, II and III

I. GENERATOR (Generator completes Ia-r)

Form I: Generator information including EPA ID, Manifest Document Number, Name and Location, Mailing Address, Phone, and Owner details.

GENERATOR'S CERTIFICATION: I hereby certify that the above named material is not a hazardous waste as defined by 40 CFR 261 or any applicable state law...

Form I-p, q, r: Generator Authorized Agent Name, Signature, and Date.

II. TRANSPORTER (Generator completes IIa-b and Transporter completes IIc-e)

Form II: Transporter information including Name and Address, Phone, Driver Name, Signature, and Date.

III. DESTINATION (Generator complete IIIa-c and Destination Site completes IIId-g)

Form III: Disposal Facility information including Site Address, US EPA Number, Discrepancy Indication Space, and Authorized Agent details.

IV. ASBESTOS (Generator completes IVa-f and Operator complete IVg-i)

Form IV: Asbestos handling information including Operator Name and Address, Responsible Agency Name and Address, Special Handling Instructions, and Operator Certification.

SITE	TICKET #	CELL
01	924570	M34M33CELL12LIFT4
WEIGHMASTER		
JAMES E.		
DATE/TIME IN	DATE/TIME OUT	
05-31-2013 7:01 am	05-31-2013 7:28 am	
VEHICLE	CONTAINER	
TRUCK		
REFERENCE	INVOICE	
BILL OF LADING		

SITE	EAST CAROLINA ENV LANDFILL	
AULANDER, NC	27805	242-348-3322
CUSTOMER	000939	
Evo Corporation	1703 Vargrave Street	
Winston-Salem, NC	27107	
3026138260		

SCALE IN	GROSS WEIGHT	NET TONS	NET WEIGHT
SCALE OUT	75,540	16.55	33,100
TARE WEIGHT	42,440		INBOUND

QTY	UNIT	DESCRIPTION	RATE	EXTENSION	TAX	TOTAL
0.00	YD	TRACKING QTY				
16.55	TN	SW-CONT SOIL				
		PITT				

NET AMOUNT
TENDERED
CHANGE
CHECK#

Indemnification. Generator agrees to indemnify, hold harmless, and defend Republic Services of NC, LLC, its subsidiaries, affiliates, employees, officer and directors from and against any and all liabilities, claims, penalties, forfeitures, suits, and cost and expenses incident thereto, including cost of defense, settlement and reasonable attorney's fees, which may be incurred, as a result of death or injuries to any person, or damage to any property contamination of or adverse effect on

The undersigned individual signing this document on behalf of Customer acknowledges that he or she has read and understands the terms and conditions on the reverse side and that he or she has the authority to sign this document on behalf of the customer.

James E. [Signature]
SIGNATURE



NON-HAZARDOUS SPECIAL WASTE & ASBESTOS MANIFEST

483452

If waste is asbestos waste, complete Sections I, II, III and IV
If waste is NOT asbestos waste, complete Sections I, II and III

I. GENERATOR (Generator completes Ia-r)

a. Generator's US EPA ID Number 112P000155007		b. Manifest Document Number		c. Page 1 of	
d. Generator's Name and Location: Particular for DSCA Site # 74-0008 200 E. Tenth Street Greenville, NC 27608 <i>slaw 004</i>			e. Generator's Mailing Address: Particular for DSCA Site # 74-0008 1040 Mail Service Center Greenville, NC 27603		
f. Phone:			g. Phone: 813-707-8357		
If owner of the generating facility differs from the generator, provide:					
h. Owner's Name:			i. Owner's Phone No.:		
j. Waste Profile #	k. Exp. Date	l. Waste Shipping Name and Description		m. Containers No. Type	n. Total Quantity
3025133260	12/1/2013	Excavated Soil			13.57
DOK RB3738ART					
GENERATOR'S CERTIFICATION: I hereby certify that the above named material is not a hazardous waste as defined by 40 CFR 261 or any applicable state law, has been properly described, classified and packaged, and is in proper condition for transportation according to applicable regulations; AND, if this waste is a treatment residue of a previously restricted hazardous waste subject to the Land Disposal Restrictions. I certify and warrant that the waste has been treated in accordance with the requirements of 40 CFR 268 and is no longer a hazardous waste as defined by 40 CFR 261.					
p. Generator Authorized Agent Name (Print) <i>Matt Griles on behalf of Particular for DSCA site # 74-0008</i>			q. Signature <i>Matthew Allen</i>		r. Date <i>5/31/13</i>

II. TRANSPORTER (Generator completes IIa-b and Transporter completes IIc-e)

a. Transporter's Name and Address: EVO Corporation 1700 Margrave Street Winston-Salem, NC 27107 336-725-5844		
b. Phone:		
c. Driver Name (Print) <i>Jim Galanovsky</i>	d. Signature <i>Jim Galanovsky</i>	e. Date <i>5-31-13</i>

III. DESTINATION (Generator complete IIIa-c and Destination Site completes III d-g)

a. Disposal Facility and Site Address: East Carolina Environmental Co. 1922 Republic Road Arlington, NC 27606 b. 252-348-4000		c. US EPA Number 11A	d. Discrepancy Indication Space:
I hereby certify that the above named material has been accepted and to the best of my knowledge the foregoing is true and accurate.			
e. Name of Authorized Agent (Print) <i>James Gray</i>		f. Signature <i>James Gray</i>	g. Date <i>5-31-13</i>

IV. ASBESTOS (Generator completes IVa-f and Operator complete IVg-i)

a. Operator's Name and Address:		c. Responsible Agency Name and Address:	
b. Phone:		d. Phone:	
e. Special Handling Instructions and Additional Information:			
f. <input type="checkbox"/> Friable <input type="checkbox"/> Non-Friable <input type="checkbox"/> Both % Friable % Non-Friable			
OPERATOR'S CERTIFICATION: I hereby declare that the contents of this consignment are fully and accurately described above by the proper shipping name and are classified, packaged, marked and labeled/placarded, and are in all respects in proper condition for transport according to applicable international and national governmental regulations.			
g. Operator's Name and Title (Print)		h. Signature	
		i. Date	
*Operator refers to the company which owns, leases, operates, controls, or supervises the facility being demolished or renovated, or the demolition or renovation operation or both			



NON-HAZARDOUS SPECIAL WASTE & ASBESTOS MANIFEST

483453

If waste is asbestos waste, complete Sections I, II, III and IV
If waste is NOT asbestos waste, complete Sections I, II and III

I. GENERATOR (Generator completes Ia-r)

Form I: Generator information including EPA ID, manifest number, generator name, mailing address, phone numbers, and waste profile table.

II. TRANSPORTER (Generator completes IIa-b and Transporter completes IIc-e)

Form II: Transporter information including name, address, phone, driver name, signature, and date.

III. DESTINATION (Generator complete IIIa-c and Destination Site completes III d-g)

Form III: Destination information including disposal facility address, EPA number, discrepancy space, and agent signature.

IV. ASBESTOS (Generator completes IVa-f and Operator complete IVg-i)

Form IV: Asbestos information including operator name, responsible agency, friability, and operator certification.

SITE EAST CAROLINA ENV LANDFILL
 AULANDER, NC 27805 242-348-3322
 CUSTOMER
 000939
 Evo Corporation
 1703 Vargrave Street
 Winston-Salem, NC 27107
 3026138260

TICKET # 924641 CELL M34M33CELL12LIFT4
 WEIGHMASTER
 JAMES E.
 DATE/TIME IN 05-31-2013 12:46 pm DATE/TIME OUT 05-31-2013 1:14 PM
 VEHICLE TRUCK CONTAINER
 TRUCK REFERENCE
 INVOICE
 BILL OF LADING

SCALE IN	GROSS WEIGHT	NET TONS	NET WEIGHT	SCALE OUT	TARE WEIGHT	NET WEIGHT
0.00	60,860	10.77	21,540	10.77	39,320	INBOUND
UNIT	DESCRIPTION	RATE	EXTENSION	TOTAL		
YD	TRACKING QTY					
TN	SW-CONT SOIL					

Indemnification. Generator agrees to indemnify, hold harmless, and defend Republic Services of NC, LLC, its subsidiaries, affiliates, employees, officer and directors from and against any and all liabilities, claims, penalties, forfeitures, suits, and cost and expenses incident thereto, including cost of defense, settlement and reasonable attorney's fees, which may be incurred, as a result of death or injuries to any person, or damage to any property contamination of or adverse effect on the undersigned individual signing this document on behalf of customer acknowledges that he or she has read and understands the terms and conditions on the reverse side and that he or she has the authority to sign this document on behalf of the customer.

SIGNATURE *Jim Pitt*

NET AMOUNT
 TENDERED
 CHANGE
 CHECK#



NON-HAZARDOUS SPECIAL WASTE & ASBESTOS MANIFEST

483456

If waste is asbestos waste, complete Sections I, II, III and IV
If waste is NOT asbestos waste, complete Sections I, II and III

I. GENERATOR (Generator completes Ia-r)

Form I: Generator information including EPA ID Number, Manifest Document Number, Generator Name and Location, Mailing Address, Phone, and Waste Profile details.

GENERATOR'S CERTIFICATION: I hereby certify that the above named material is not a hazardous waste as defined by 40 CFR 261 or any applicable state law, has been properly described, classified and packaged, and is in proper condition for transportation according to applicable regulations; AND, if this waste is a treatment residue of a previously restricted hazardous waste subject to the Land Disposal Restrictions. I certify and warrant that the waste has been treated in accordance with the requirements of 40 CFR 268 and is no longer a hazardous waste as defined by 40 CFR 261.

Form p-q: Generator Authorized Agent Name (Print), Signature, and Date.

II. TRANSPORTER (Generator completes IIa-b and Transporter completes IIc-e)

Form II: Transporter information including Name and Address, Phone, Driver Name (Print), Signature, and Date.

III. DESTINATION (Generator complete IIIa-c and Destination Site completes IIId-g)

Form III: Disposal Facility and Site Address, US EPA Number, Discrepancy Indication Space, and Authorized Agent Name, Signature, and Date.

IV. ASBESTOS (Generator completes IVa-f and Operator complete IVg-i)

Form IV: Operator's Name and Address, Responsible Agency Name and Address, Special Handling Instructions, Friable/Non-Friable status, OPERATOR'S CERTIFICATION, and Operator Name, Signature, and Date.

SITE EAST CAROLINA ENV LANDFILL
 AULANDER, NC 27805 242-348-3322
 CUSTOMER
 000939
 Evo Corporation
 1703 Vargrave Street
 Winston-Salem, NC 27107
 3026138260

TICKET # 924691
 CELL M34M33CELL12LIFT4
 WEIGHMASTER
 JAMES E.
 DATE/TIME IN 05-31-2013 3:52 pm
 DATE/TIME OUT 05-31-2013 4:20 pm
 VEHICLE TRUCK
 CONTAINER
 REFERENCE INVOICE
 BILL OF LADING

SCALE IN	GROSS WEIGHT	NET TONS	NET WEIGHT	SCALE OUT	TARE WEIGHT	NET WEIGHT
SCALE IN	67,980	12.99	NET TONS	SCALE OUT	42,000	NET WEIGHT
						25,980
						INBOUND
QTY	UNIT	DESCRIPTION	RATE	EXTENSION	TAX	TOTAL
0.00	YD	TRACKING QTY				
12.99	TN	SW-CONT SOIL				
		PITT				

NET AMOUNT
 TENDERED
 CHANGE
 CHECK#

Indemnification. Generator agrees to indemnify, hold harmless, and defend Republic Services of NC, LLC, its subsidiaries, affiliates, employees, officer and directors from and against any and all liabilities, claims, penalties, forfeitures, suits, and cost and expenses incident thereto, including cost of defense, settlement and reasonable attorney's fees, which may be incurred, as a result of death or injuries to any person, or damage to any property contamination of or adverse effect on The undersigned individual signing this document on behalf of Customer acknowledges that he or she has read and understands the terms and conditions on the reverse side and that he or she has the authority to sign this document on behalf of the customer.

SIGNATURE 



NON-HAZARDOUS SPECIAL WASTE & ASBESTOS MANIFEST

483451

If waste is asbestos waste, complete Sections I, II, III and IV
If waste is NOT asbestos waste, complete Sections I, II and III

I. GENERATOR (Generator completes Ia-r)

Form I: Generator information including US EPA ID Number, Manifest Document Number, Generator Name and Location, Mailing Address, and Waste Profile table.

II. TRANSPORTER (Generator completes IIa-b and Transporter completes IIc-e)

Form II: Transporter information including Name and Address, Driver Name, Signature, and Date.

III. DESTINATION (Generator complete IIIa-c and Destination Site completes III d-g)

Form III: Destination information including Disposal Facility and Site Address, US EPA Number, and Authorized Agent details.

IV. ASBESTOS (Generator completes IVa-f and Operator complete IVg-i)

Form IV: Asbestos information including Operator's Name and Address, Responsible Agency Name and Address, and Operator's Certification.



NON-HAZARDOUS SPECIAL WASTE & ASBESTOS MANIFEST

483449

If waste is asbestos waste, complete Sections I, II, III and IV
If waste is NOT asbestos waste, complete Sections I, II and III

I. GENERATOR (Generator completes Ia-r)

Form I: Generator information including EPA ID, manifest number, generator name/location, mailing address, phone, owner details, waste profile, and shipping information.

II. TRANSPORTER (Generator completes IIa-b and Transporter completes IIc-e)

Form II: Transporter information including name/address, phone, driver name, signature, and date.

III. DESTINATION (Generator complete IIIa-c and Destination Site completes III d-g)

Form III: Destination information including disposal facility address, EPA number, discrepancy space, and authorized agent details.

IV. ASBESTOS (Generator completes IVa-f and Operator complete IVg-i)

Form IV: Asbestos handling information including operator name/address, responsible agency, special handling instructions, friability, and operator certification.



NON-HAZARDOUS SPECIAL WASTE & ASBESTOS MANIFEST

483454

If waste is asbestos waste, complete Sections I, II, III and IV
If waste is NOT asbestos waste, complete Sections I, II and III

I. GENERATOR (Generator completes la-r)

Form I: Generator information including US EPA ID Number, Manifest Document Number, Generator Name and Location, Mailing Address, Phone numbers, and Waste Profile table.

II. TRANSPORTER (Generator completes IIa-b and Transporter completes IIc-e)

Form II: Transporter information including Name and Address, Phone, Driver Name, Signature, and Date.

III. DESTINATION (Generator complete IIIa-c and Destination Site completes III d-g)

Form III: Destination information including Disposal Facility and Site Address, US EPA Number, Discrepancy Indication Space, and Authorized Agent Name, Signature, and Date.

IV. ASBESTOS (Generator completes IVa-f and Operator complete IVg-i)

Form IV: Asbestos information including Operator's Name and Address, Responsible Agency Name and Address, Special Handling Instructions, Friable/Non-Friable checkboxes, Operator's Certification, and Operator Name, Signature, and Date.



NON-HAZARDOUS SPECIAL WASTE & ASBESTOS MANIFEST

483457

If waste is asbestos waste, complete Sections I, II, III and IV
 If waste is NOT asbestos waste, complete Sections I, II and III

I. GENERATOR (Generator completes Ia-r)

a. Generator's US EPA ID Number NC R00015A383		b. Manifest Document Number		c. Page 1 of		
d. Generator's Name and Location: Petitioner for DSCA Site #740008 355 E. Tenth Street Greensville, NC 27859 <i>slaw 004</i>			e. Generator's Mailing Address: Petitioner for DSCA Site #74-0008 1640 Mail Service Center Raleigh, NC 27609			
f. Phone:			g. Phone: 919.707.8367			
If owner of the generating facility differs from the generator, provide:						
h. Owner's Name:			i. Owner's Phone No.:			
j. Waste Profile #		k. Exp. Date	l. Waste Shipping Name and Description	m. Containers No.	n. Total Quantity	o. Unit Wt/Vol
3025138280 <i>EVO-904</i>		12/31/2013	Excavated Soil	<i>001 NO</i>	<i>12.39</i>	

GENERATOR'S CERTIFICATION: I hereby certify that the above named material is not a hazardous waste as defined by 40 CFR 261 or any applicable state law, has been properly described, classified and packaged, and is in proper condition for transportation according to applicable regulations; AND, if this waste is a treatment residue of a previously restricted hazardous waste subject to the Land Disposal Restrictions, I certify and warrant that the waste has been treated in accordance with the requirements of 40 CFR 268 and is no longer a hazardous waste as defined by 40 CFR 261.

p. Generator Authorized Agent Name (Print) <i>Matt Gillis on behalf of Petitioner for DSCA site #74-0008</i>		q. Signature <i>Matt Gillis</i>		r. Date <i>5/31/13</i>	
---	--	------------------------------------	--	---------------------------	--

II. TRANSPORTER (Generator completes IIa-b and Transporter completes IIc-e)

a. Transporter's Name and Address: EVO Corporation 1700 Vantage Street Winston-Salem, NC 27107 336.725.5844		
b. Phone:		
c. Driver Name (Print) <i>Tim L Myers</i>	d. Signature <i>Tim L Myers</i>	e. Date <i>5-31-13</i>

III. DESTINATION (Generator complete IIIa-c and Destination Site completes III d-g)

a. Disposal Facility and Site Address: East Carolina Environmental LP 1900 Republican Road Aulander, NC 27806 b. 252.848.3822		c. US EPA Number N/A	d. Discrepancy Indication Space:
I hereby certify that the above named material has been accepted and to the best of my knowledge the foregoing is true and accurate.			
e. Name of Authorized Agent (Print) <i>JAMES GREFFE</i>		f. Signature <i>[Signature]</i>	g. Date <i>5-31-13</i>

IV. ASBESTOS (Generator completes IVa-f and Operator complete IVg-i)

a. Operator's Name and Address:		c. Responsible Agency Name and Address:	
b. Phone:		d. Phone:	
e. Special Handling Instructions and Additional Information:			
f. <input type="checkbox"/> Friable <input type="checkbox"/> Non-Friable <input type="checkbox"/> Both % Friable % Non-Friable			
OPERATOR'S CERTIFICATION: I hereby declare that the contents of this consignment are fully and accurately described above by the proper shipping name and are classified, packaged, marked and labeled/placarded, and are in all respects in proper condition for transport according to applicable international and national governmental regulations.			
g. Operator's Name and Title (Print)		h. Signature	i. Date
*Operator refers to the company which owns, leases, operates, controls, or supervises the facility being demolished or renovated, or the demolition or renovation operation or both			



NON-HAZARDOUS SPECIAL WASTE & ASBESTOS MANIFEST

2

483461

If waste is asbestos waste, complete Sections I, II, III and IV
If waste is NOT asbestos waste, complete Sections I, II and III

I. GENERATOR (Generator completes 1a-r)

Form section I: Generator information including US EPA ID Number, Manifest Document Number, Generator's Name and Location, and Mailing Address.

Table with 6 columns: Waste Profile #, Exp. Date, Waste Shipping Name and Description, Containers No./Type, Total Quantity, Unit Wt/Vol. Row 1: EVO-903, 12/31/2013, Excavated Soil, 001 RO, 13.35.

GENERATOR'S CERTIFICATION: I hereby certify that the above named material is not a hazardous waste as defined by 40 CFR 261 or any applicable state law, has been properly described, classified and packaged, and is in proper condition for transportation according to applicable regulations; AND, if this waste is a treatment residue of a previously restricted hazardous waste subject to the Land Disposal Restrictions. I certify and warrant that the waste has been treated in accordance with the requirements of 40 CFR 268 and is no longer a hazardous waste as defined by 40 CFR 261.

Form section I (continued): Generator Authorized Agent Name (Print), Signature, and Date.

II. TRANSPORTER (Generator completes 11a-b and Transporter completes 11c-e)

Form section II: Transporter's Name and Address, and Phone.

Form section II (continued): Driver Name (Print), Signature, and Date.

III. DESTINATION (Generator complete 111a-c and Destination Site completes 111d-g)

Form section III: Disposal Facility and Site Address, US EPA Number, and Discrepancy Indication Space.

I hereby certify that the above named material has been accepted and to the best of my knowledge the foregoing is true and accurate.

Form section III (continued): Name of Authorized Agent (Print), Signature, and Date.

IV. ASBESTOS (Generator completes 11Va-f and Operator complete 11Vg-i)

Form section IV: Operator's Name and Address, Responsible Agency Name and Address, and Phone.

Form section IV (continued): Special Handling Instructions and Additional Information.

Form section IV (continued): Friable/Non-Friable checkboxes and percentages.

OPERATOR'S CERTIFICATION: I hereby declare that the contents of this consignment are fully and accurately described above by the proper shipping name and are classified, packaged, marked and labeled/placarded, and are in all respects in proper condition for transport according to applicable international and national governmental regulations.

Form section IV (continued): Operator's Name and Title (Print), Signature, and Date.

*Operator refers to the company which owns, leases, operates, controls, or supervises the facility being demolished or renovated, or the demolition or renovation operation or both

SITE EAST CAROLINA ENV LANDFILL
CUSTOMER AULANDER, NC 27805 242-348-3322
 000939
 Evo Corporation
 1703 Vargrave Street
 Winston-Salem, NC 27107
 3026138260

SITE 01 **TICKET #** 924856 **CELL** M34M33CELL12LIFT4
WEIGHMASTER
 JAMES E.
DATE/TIME IN 06-03-2013 2:19 pm **DATE/TIME OUT** 06-3-2013 2:57 pm
VEHICLE TRUCK **CONTAINER**
REFERENCE INVOICE
BILL OF LADING

SCALE IN	GROSS WEIGHT	NET TONS	NET TONS	SCALE OUT	TARE WEIGHT	NET WEIGHT	NET WEIGHT
	60,220	13.35			33,520	26,700	INBOUND
QTY	UNIT	DESCRIPTION	RATE	EXTENSION	TAX	TOTAL	
0.00	YD	TRACKING QTY					
13.35	TN	SW-CONT SOIL					
		PITT					

NET AMOUNT
TENDERED
CHANGE
CHECK#

INDEMNIFICATION. Generator agrees to indemnify, hold harmless, and defend Republic Services of NC, LLC, its subsidiaries, affiliates, employees, officer and directors from and against any and all liabilities, claims, penalties, forfeitures, suits, and cost and expenses incident thereto, including cost of defense, settlement and reasonable attorney's fees, which may be incurred, as a result of death or injuries to any person, or damage to any property contamination of or adverse effect on The undersigned individual signing this document on behalf of Customer acknowledges that he or she has read and understands the terms and conditions on the reverse side and that he or she has the authority to sign this document on behalf of the customer.

SIGNATURE *Jim M...*



NON-HAZARDOUS SPECIAL WASTE & ASBESTOS MANIFEST

483462

If waste is asbestos waste, complete Sections I, II, III and IV
If waste is NOT asbestos waste, complete Sections I, II and III

I. GENERATOR (Generator completes la-r)

Form I: Generator information including EPA ID, manifest number, name, location, mailing address, phone, and waste profile details.

GENERATOR'S CERTIFICATION: I hereby certify that the above named material is not a hazardous waste as defined by 40 CFR 261 or any applicable state law...

Form I (continued): Generator Authorized Agent Name, Signature, and Date.

II. TRANSPORTER (Generator completes IIa-b and Transporter completes IIc-e)

Form II: Transporter information including name, address, phone, driver name, signature, and date.

III. DESTINATION (Generator complete IIIa-c and Destination Site completes III d-g)

Form III: Disposal facility information including site address, US EPA number, discrepancy space, and authorized agent details.

IV. ASBESTOS (Generator completes IVa-f and Operator complete IVg-i)

Form IV: Asbestos handling information including operator name, responsible agency, friability, and operator's certification.

SITE EAST CAROLINA ENV LANDFILL
 AULANDER, NC 27805 242-348-3322

CUSTOMER
 000939
 Evo Corporation
 1703 Vargrave Street
 Winston-Salem, NC 27107
 3026138260

TICKET # 924855
 CELL M34M33CELL12LIFT4

WEIGHMASTER
 JAMES E.

DATE/TIME IN 06-03-2013 2:17 pm
 DATE/TIME OUT 06-3-2013 2:55 pm

VEHICLE TRUCK
 CONTAINER

REFERENCE INVOICE

BILL OF LADING

SCALE IN GROSS WEIGHT 85,160 NET TONS 21.45
 SCALE OUT TARE WEIGHT 42,260 NET WEIGHT 42,900
 INBOUND

QTY	UNIT	DESCRIPTION	RATE	EXTENSION	TAX	TOTAL
0.00	YD	TRACKING QTY				
21.45	TN	SW-CONF SOIL				
		PITT				

Indemnification. Generator agrees to indemnify, hold harmless, and defend Republic Services of NC, LLC, its subsidiaries, affiliates, employees, officer and directors from and against any and all liabilities, claims, penalties, forfeitures, suits, and cost and expenses incident thereto, including cost of defense, settlement and reasonable attorney's fees, which may be incurred, as a result of death or injuries to any person, or damage to any property contamination of or adverse effect on the undersigned individual signing this document on behalf of Customer acknowledges that he or she has read and understands the terms and conditions on the reverse side and that he or she has the authority to sign this document on behalf of the customer.

2/21

RS-F042UPR (07/12)

SIGNATURE 

NET AMOUNT
TENDERED
CHANGE
CHECK#



NON-HAZARDOUS-SPECIAL WASTE & ASBESTOS MANIFEST

483460

If waste is asbestos waste, complete Sections I, II, III and IV
 If waste is NOT asbestos waste, complete Sections I, II and III

I. GENERATOR (Generator completes Ia-r)

a. Generator's US EPA ID Number NCR000156352		b. Manifest Document Number		c. Page 1 of		
d. Generator's Name and Location: Petitioner for DSCA Site #74-0008 205 E Tenth Street Greenville, NC 27608 <i>Slaw 004</i>			e. Generator's Mailing Address: Petitioner for DSCA Site #74-0008 1840 Wolf Service Center Raleigh, NC 27608 g. Phone: 919-707-8367			
f. Phone:			i. Owner's Phone No.:			
If owner of the generating facility differs from the generator, provide:						
h. Owner's Name:			i. Owner's Phone No.:			
j. Waste Profile #	k. Exp. Date	l. Waste Shipping Name and Description	m. Containers No.	m. Containers Type	n. Total Quantity	o. Unit Wt/Vol
3026158280 <i>R3-12665 RT</i>	12/31/2010	Remediated Soil	001	RO	1288	
GENERATOR'S CERTIFICATION: I hereby certify that the above named material is not a hazardous waste as defined by 40 CFR 261 or any applicable state law, has been properly described, classified and packaged, and is in proper condition for transportation according to applicable regulations; AND, if this waste is a treatment residue of a previously restricted hazardous waste subject to the Land Disposal Restrictions. I certify and warrant that the waste has been treated in accordance with the requirements of 40 CFR 268 and is no longer a hazardous waste as defined by 40 CFR 261.						
Matt G. ... on behalf of Petitioners for DSCA site #74-0008			Matthew		6/3/13	
p. Generator Authorized Agent Name (Print)			q. Signature		r. Date	

II. TRANSPORTER (Generator completes IIa-b and Transporter completes IIc-e)

a. Transporter's Name and Address: PVC Corporation 1700 Vargrave Street Winston-Salem, NC 27107 336-775-8844		
b. Phone:		
Jim Glanovsky	<i>[Signature]</i>	6/3/13
c. Driver Name (Print)	d. Signature	e. Date

III. DESTINATION (Generator complete IIIa-c and Destination Site completes III d-g)

a. Disposal Facility and Site Address: East Carolina Environmental LF 1802 Republican Road Arlington, NC 27606 b. 352-348-2892		c. US EPA Number N/A	d. Discrepancy Indication Space:
I hereby certify that the above named material has been accepted and to the best of my knowledge the foregoing is true and accurate.			
<i>JAMES GERTHE</i>		<i>[Signature]</i>	6-3-13
e. Name of Authorized Agent (Print)		f. Signature	g. Date

IV. ASBESTOS (Generator completes IVa-f and Operator complete IVg-i)

a. Operator's Name and Address:		c. Responsible Agency Name and Address:	
b. Phone:		d. Phone:	
e. Special Handling Instructions and Additional Information:			
f. <input type="checkbox"/> Friable <input type="checkbox"/> Non-Friable <input type="checkbox"/> Both % Friable % Non-Friable			
OPERATOR'S CERTIFICATION: I hereby declare that the contents of this consignment are fully and accurately described above by the proper shipping name and are classified, packaged, marked and labeled/placarded, and are in all respects in proper condition for transport according to applicable international and national governmental regulations.			
g. Operator's Name and Title (Print)		h. Signature	
		i. Date	
*Operator refers to the company which owns, leases, operates, controls, or supervises the facility being demolished or renovated, or the demolition or renovation operation or both			



NON-HAZARDOUS SPECIAL WASTE & ASBESTOS MANIFEST

483465

If waste is asbestos waste, complete Sections I, II, III and IV
If waste is **NOT** asbestos waste, complete Sections I, II and III

I. GENERATOR (Generator completes Ia-r)

a. Generator's US EPA ID Number NCR000155383		b. Manifest Document Number		c. Page 1 of		
d. Generator's Name and Location: Partner for DSCA Site #74-0007 205 E. Tenth Street Greenville, NC 27833 <i>glaw 004</i>			e. Generator's Mailing Address: Partner for DSCA Site #74-0008 1516 Mail Service Center Raleigh, NC 27609			
f. Phone:			g. Phone: 919-707-8267			
If owner of the generating facility differs from the generator, provide:						
h. Owner's Name:			i. Owner's Phone No.:			
j. Waste Profile #	k. Exp. Date	l. Waste Shipping Name and Description	m. Containers No.	m. Containers Type	n. Total Quantity	o. Unit Wt/Vol
3020130260 BKRU025917	12/31/2013	Evaporated Res	001	RD	16/16	
GENERATOR'S CERTIFICATION: I hereby certify that the above named material is not a hazardous waste as defined by 40 CFR 261 or any applicable state law, has been properly described, classified and packaged, and is in proper condition for transportation according to applicable regulations; AND, if this waste is a treatment residue of a previously restricted hazardous waste subject to the Land Disposal Restrictions. I certify and warrant that the waste has been treated in accordance with the requirements of 40 CFR 268 and is no longer a hazardous waste as defined by 40 CFR 261.						
p. Generator Authorized Agent Name (Print) <i>Partner for DSCA site #74-0008</i>			q. Signature <i>Matthew</i>		r. Date <i>6/4/13</i>	

II. TRANSPORTER (Generator completes IIa-b and Transporter completes IIc-e)

a. Transporter's Name and Address: EVO Corporation 1703 Morgans Street Winston-Salem, NC 27107		
b. Phone: 336-725-5844		
c. Driver Name (Print) <i>Jim Glawuski</i>	d. Signature <i>Jim Glawuski</i>	e. Date <i>6/4/13</i>

III. DESTINATION (Generator complete IIIa-c and Destination Site completes IIId-g)

a. Disposal Facility and Site Address: East Carolina Environmental LP 1927 Republican Road Asheboro, NC 27805		b. US EPA Number N/A	d. Discrepancy Indication Space:
I hereby certify that the above named material has been accepted and to the best of my knowledge the foregoing is true and accurate.			
e. Name of Authorized Agent (Print) <i>James Geph</i>		f. Signature <i>James Geph</i>	g. Date <i>6-4-13</i>

IV. ASBESTOS (Generator completes IVa-f and Operator complete IVg-i)

a. Operator's Name and Address:		c. Responsible Agency Name and Address:	
b. Phone:		d. Phone:	
e. Special Handling Instructions and Additional Information:			
f. <input type="checkbox"/> Friable <input type="checkbox"/> Non-Friable <input type="checkbox"/> Both % Friable % Non-Friable			
OPERATOR'S CERTIFICATION: I hereby declare that the contents of this consignment are fully and accurately described above by the proper shipping name and are classified, packaged, marked and labeled/placarded, and are in all respects in proper condition for transport according to applicable international and national governmental regulations.			
g. Operator's Name and Title (Print)		i. Date	
h. Signature		i. Date	
*Operator refers to the company which owns, leases, operates, controls, or supervises the facility being demolished or renovated, or the demolition or renovation operation or both			



NON-HAZARDOUS SPECIAL WASTE & ASBESTOS MANIFEST

483463

If waste is asbestos waste, complete Sections I, II, III and IV
If waste is NOT asbestos waste, complete Sections I, II and III

I. GENERATOR (Generator completes la-r)

Form I: Generator information including EPA ID, manifest number, name, location, mailing address, phone, and waste profile details.

II. TRANSPORTER (Generator completes IIa-b and Transporter completes IIc-e)

Form II: Transporter information including name, address, phone, driver name, signature, and date.

III. DESTINATION (Generator complete IIIa-c and Destination Site completes IIId-g)

Form III: Destination information including disposal facility address, EPA number, discrepancy space, and authorized agent details.

IV. ASBESTOS (Generator completes IVa-f and Operator complete IVg-i)

Form IV: Asbestos handling information including operator name, responsible agency, friability checkboxes, and operator certification.

SITE	TICKET #	CELL
01	924906	M34M33CELL12LIFT4
WEIGHMASTER		
JAMES E.		
DATE/TIME IN	DATE/TIME OUT	
06-04-2013 7:08 am	06-4-2013 7:36 am	
VEHICLE	CONTAINER	
TRUCK		
REFERENCE	INVOICE	
BILL OF LADING		

SITE	EAST CAROLINA ENV LANDFILL	
AULANDER, NC	27805	242-348-3322
CUSTOMER	000939	
	Evo Corporation	
	1703 Vargrave Street	
	Winston-Salem, NC 27107	
	3026138260	

SCALE IN	GROSS WEIGHT	62,040	NET TONS	13.81
SCALE OUT	TARE WEIGHT	34,420	NET WEIGHT	27,620
				INBOUND

QTY	UNIT	DESCRIPTION	RATE	EXTENSION	TAX	TOTAL
0.00	YD	TRACKING QTY				
13.81	TN	SW-CONT SOIL				

NET AMOUNT
TENDERED
CHANGE
CHECK#

Indemnification. Generator agrees to indemnify, hold harmless, and defend Republic Services of NC, LLC, its subsidiaries, affiliates, employees, officer and directors from and against any and all liabilities, claims, penalties, forfeitures, suits, and cost and expenses incident thereto, including cost of defense, settlement and reasonable attorney's fees, which may be incurred, as a result of death or injuries to any person, or damage to any property contamination of or adverse effect on the undersigned individual signing this document on behalf of Customer acknowledges that he or she has read and understands the terms and conditions on the reverse side and that he or she has the authority to sign this document on behalf of the customer.

SIGNATURE Lu T Myers

Appendix D
Photographs



Photograph 1: View of Stadium Cleaners prior to excavation. View is to the Southwest.



Photograph 2: View of Stadium Cleaners prior to excavation. View is to the South.



Photograph 3: View of the Stadium Cleaners excavation in progress. View is to the Southeast.



Photograph 4: View of the Stadium Cleaners excavation in progress. View is to the Northeast.



Photograph 5: View of the Stadium Cleaners excavation in progress. View is to the West.



Photograph 6: View of the Stadium Cleaners excavation in progress. View is to the Northeast.



Photograph 7: View of the backfilled excavation. View is to the Southwest.



Photograph 8: View of the backfilled excavation. View is to the South.