



IHSB
U-3315_052_053_054_057

North Carolina Department of Environment and Natural Resources
Division of Waste Management

Pat McCrory
Governor

Dexter R. Matthews
Director

John E. Skvarla, III
Secretary

May 7, 2013

Mr. Bobby R. Bowen
Ms. Blanche H. Wilson
PO Box 7044
Greenville, NC 27835

Re: **NOTICE OF REGULATORY REQUIREMENTS FOR CONTAMINANT ASSESSMENT AND CLEANUP**

Property located at:
1310 West Fourteenth Avenue
Parcels 07939, 07936, 10852
Greenville, Pitt County, NC

Dear Mr. Bowen and Ms. Wilson:

We recently received Environmental Site Assessments dated January, 2013, performed by ATC Associates of North Carolina, P.C. on behalf of North Carolina Department of Transportation concerning the property you own located at and adjacent to 1310 West Fourteenth Street, Greenville, NC (the "Site"). This report indicates the Site has been contaminated by one or more hazardous substances. Depending on the contaminants involved and whether the contaminants have impacted or may impact groundwater quality, you will be required to assess and cleanup the contamination under one or more cleanup authorities. Regulatory oversight for the assessment and cleanup under all applicable authorities will be provided by the Division of Waste Management through its Superfund Section, Inactive Hazardous Sites Branch ("Branch").

Based on information available to date, the Inactive Hazardous Sites Response Act ("IHSRA"), codified under N.C. Gen. Stat. § 130A-310, *et seq.*, applies to your Site. In addition, initial immediate actions may be required under 15A NCAC 2L, Groundwater Classifications and Standards.

I. ACTIONS REQUIRED AT THIS TIME:

Complete the Site Cleanup Questionnaire.

To comply with the requirements of State law, a Site Cleanup Questionnaire, available on the website noted at the end of this letter, must be completed and returned to this office. The information you provide will be reviewed along with other information to prioritize the site, so

1601 Mail Service Center, Raleigh, North Carolina 27699-1601
Phone: 919-707-8600 \ Internet: www.ncdenr.gov

please make certain that the information you provide is complete and accurate. Please note that your failure to inform the Branch of any nearby potable wells or other high risk conditions may adversely affect the Branch's ability to identify this site as a higher-risk site.

Take Initial Abatement Actions Required Under 15A NCAC 2L.

If you have not already done so, you must take the initial abatement actions required under 15A NCAC 2L. Pursuant to 15A NCAC 2L .0106(b), any person conducting or controlling an activity which results in the discharge of a waste or hazardous substance to the groundwaters of the State, or in proximity thereto, shall take immediate action to terminate and control the discharge, and mitigate any hazards resulting from exposure to the pollutants. Pursuant to 15A NCAC 2L .0106(c), if groundwater standards have been exceeded you must take immediate action to eliminate the source or sources of contamination. Beyond initial abatement actions, all assessment and remediation will be done through the IHSRA.

II. FUTURE ASSESSMENT AND CLEANUP ACTIVITIES:

All correspondence regarding this site should be sent to the Branch. Future assessment and cleanup activities (activities conducted after the initial abatement steps required in 15A NCAC 2L) may be conducted through the Voluntary Cleanup Program (discussed below) or pursuant to an Order issued under N.C. Gen. Stat. § 130A-310.3. In addition, if you choose not to conduct a cleanup through the Voluntary Cleanup Program, the site may be referred to the United States Environmental Protection Agency ("EPA"). If so referred, EPA will screen the site for Federal enforcement action under the Federal Superfund Program, established under the Comprehensive Environmental Responsibility, Compensation, and Liability Act ("CERCLA").

III. VOLUNTARY CLEANUP PROGRAM:

Under the IHSRA, persons who move forward to assess and remediate contamination, without being compelled to do so through formal legal action filed against them, are called "volunteers." To participate in the voluntary cleanup program, you will be required to enter into an administrative agreement with the Branch. The voluntary cleanup will proceed through the Registered Environmental Consultant Program or under direct oversight by the Branch Staff, as discussed below:

Agreement to Conduct Assessment and Remediation Through the Registered Environmental Consultant Program.

The Branch has a privatized oversight arm of the voluntary cleanup program known as the Registered Environmental Consultant ("REC") program. Based on the responses provided on the questionnaire (degree of hazard and public interest in the site), the Branch will determine whether a staff person or an REC will perform the oversight and approval of your assessment and cleanup action. Please note that having one or more of the conditions identified on the questionnaire does not necessarily preclude the site for qualifying for an REC-directed cleanup action.

Under the REC program, the volunteer hires an environmental consulting firm, which the State has approved as having met certain qualifications, to implement a cleanup and certify that the work is being performed in compliance with regulations. In other words, the REC's certifications of compliance are in place of direct oversight by the Branch. Details of the REC program can be found at <http://portal.ncdenr.org/web/wm/sf/ihs/recprogram>. If you have any questions specific to the REC Program, including how to participate, please contact the REC Program Manager, Kim Caulk, at (919) 707-8350.

Agreement to Conduct Assessment and Remediation Under State Oversight.

If the Branch determines that the site should be assessed and remediated pursuant to direct State oversight, it will not be eligible for a REC-directed cleanup. Rather, the remedial action will receive direct oversight by Branch staff.

IV. FAILURE TO RESPOND:

If we do not receive a completed questionnaire, the Branch will take further action to prioritize the site without your input. Failure to take the initial abatement steps required in 15A NCAC 2L may result in the assessment of a civil penalty against you. In addition, the Branch may seek an injunction compelling compliance with the initial abatement steps required in 15A NCAC 2L. For future work beyond the initial abatement steps required pursuant to 15A NCAC 2L, a unilateral Order may be issued pursuant to N.C. Gen. Stat. § 130A-310.3 to compel assessment and cleanup.

V. ADDITIONAL INFORMATION REGARDING THE IHSRA AND THE BRANCH:

People are often confused by the name of the Inactive Hazardous Sites Response Act and the Branch. By definition, "Inactive Hazardous Sites" are any areas where hazardous substances have come to be located and would include active and inactive facilities and a variety of property types. The term "inactive" simply refers to the fact that cleanup was inactive at large numbers of sites at the time of program enactment. Additional information about the Branch may be found at: <http://portal.ncdenr.org/web/wm/sf/ihs/home>.

Submit completed questionnaire to: Sue Murphy
Inactive Hazardous Sites Branch
1646 Mail Service Center
Raleigh, NC 27699-1646

All documents submitted to the Division in relation to this work must be provided in both paper and in an electronic format designated by the Division (see the Inactive Hazardous Sites Branch website located at <http://portal.ncdenr.org/web/wm/sf/ihs/home> for current specifications on electronic document submittal).

If you have additional questions about the requirements that apply to your site, please contact me at (919) 707-8354.

Sincerely,

A handwritten signature in black ink that reads "Sue Murphy". The signature is written in a cursive, flowing style.

Sue Murphy
Engineer
Inactive Hazardous Sites Branch
Superfund Section

Cc: G. Box, NCDOT
File

- LEGEND
- EXISTING RIGHT OF WAY
 - PROPOSED RIGHT OF WAY
 - PROPERTY LINE
 - U/G CABLE TV
 - U/G CABLE TELEPHONE
 - U/G CABLE TELEPHONE FIBER OPTIC
 - U/G ELECTRIC
 - EXISTING HYDRO
 - U/G CABLE TV FIBER OPTIC
 - PERMANENT UTILITY EASEMENT
 - FILL LINE
 - CUT LINE
 - CHL CHAIN LINK
 - CB CATCH BASIN
 - RCP REINFORCED CONCRETE PIPE
 - EOT EDGE OF TRAVEL
 - MH MANHOLE
 - TC TERRA COTTA PIPE
 - UTILITY SIGNAL POLE
 - UTILITY POLE
 - LIGHT POLE
 - SOIL BORING LOCATION
 - TEMPORARY WELL LOCATION
 - ESTIMATED EXTENT OF IMPACTED SOIL (DASHED WHERE IMPACTED)
 - NO ANALYZED COMPOUNDS DETECTED AT OR ABOVE MSCC AND/OR NCDEM ACTION LEVELS

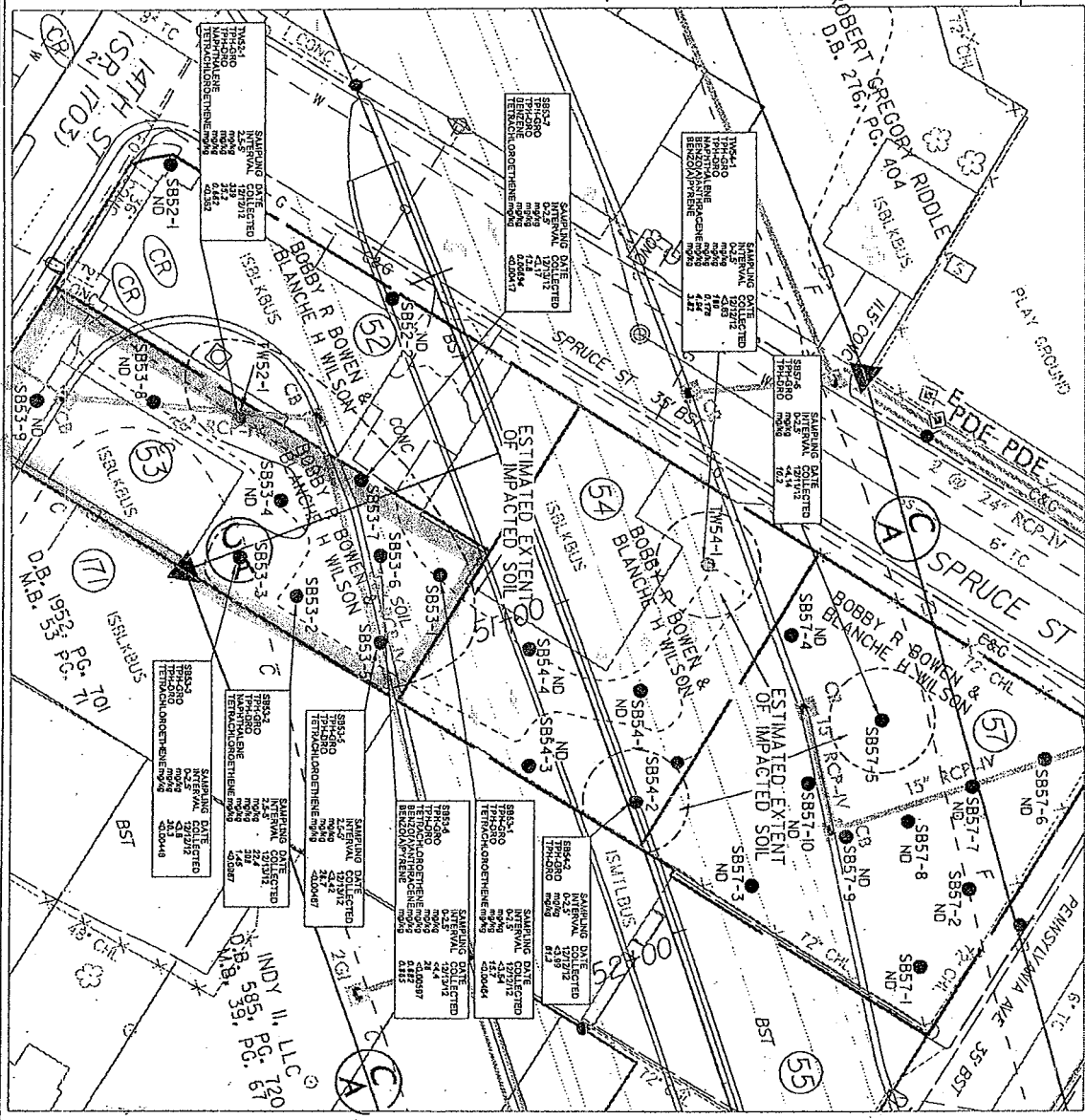
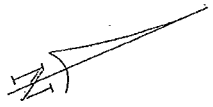

NOTES:
 1) VALUES IN BOLD INDICATE LEVELS ABOVE SOIL-TO-GROUNDWATER MAXIMUM SOIL CONTAMINANT CONCENTRATIONS (MSCC) AND/OR NCDEM'S ACTION LEVELS.

TABLE 4
 SOIL ANALYTICAL DATA
 BOBBY R BOWEN & BLANCHE H WILSON PROPERTY - PARCELS 52, 53, 54 & 57
 1310 W 14TH AVE
 GREENVILLE NC 27858



ATC Associates of North Carolina, P.C.

RALEIGH, NORTH CAROLINA (919) 871-0995 FAX (919) 871-0335

CAD FILE	REG ELEMENT	PREP. BY	REV. BY	SCALE	DATE	PROJECT NO.
	35781.1.2	JB	JC	1"=30'-0"	01-24-2013	45.19873.0007