

PHASING DIAGRAM

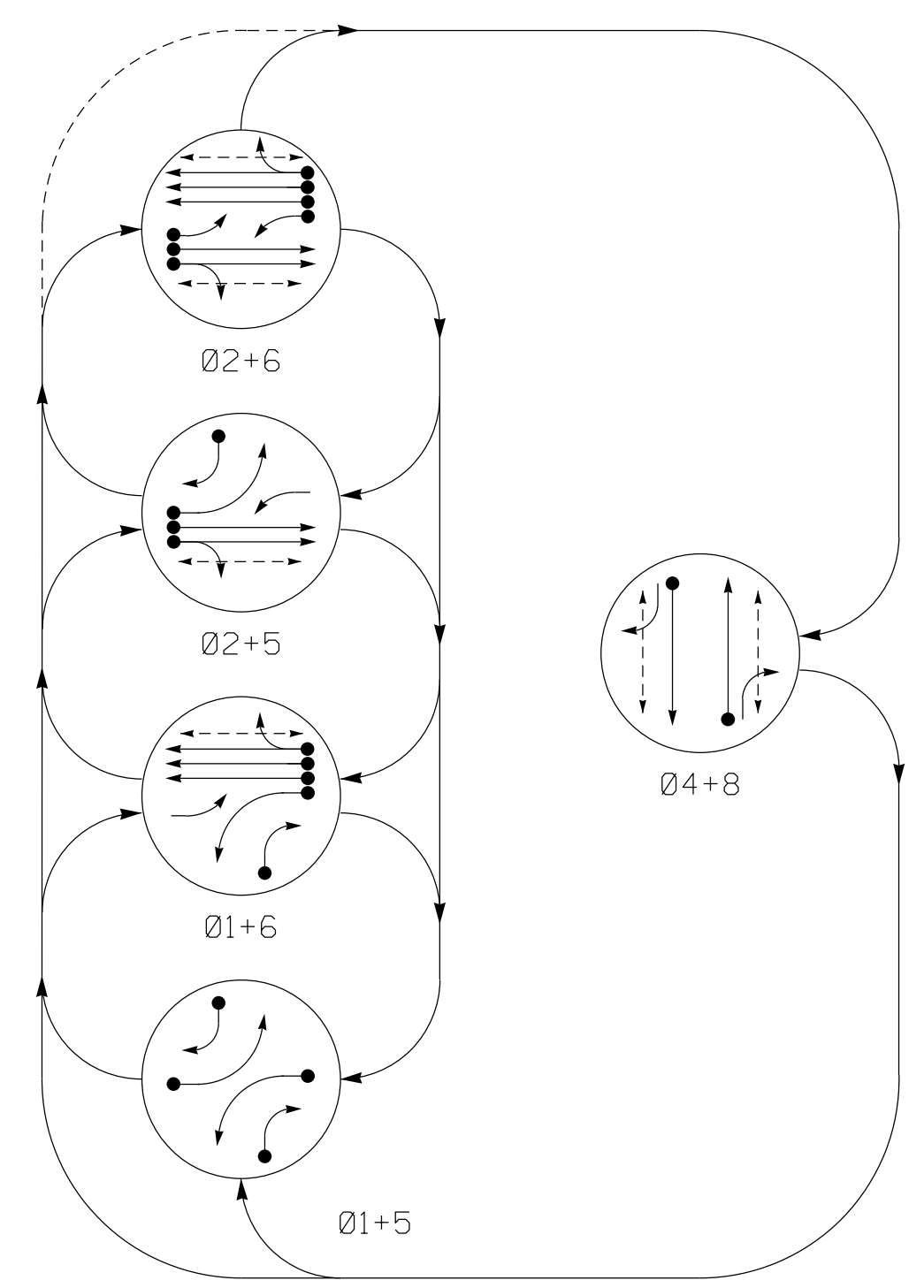

PHASING DIAGRAM DETECTION LEGEND

- ◄ ● DETECTED MOVEMENT
- ◄ ◄ UNDETECTED MOVEMENT (OVERLAP)
- ◄ ◄ ◄ UNSIGNALIZED MOVEMENT
- ◄ ◄ ◄ ◄ PEDESTRIAN MOVEMENT

TABLE OF OPERATION

SIGNAL FACE	PHASE				
	Ø 1 + 5	Ø 1 + 6	Ø 2 + 5	Ø 2 + 6	Ø 4 + 8
11	←	←	←	←	←
21, 22	R	R	G	G	R
41	R	R	R	R	G
42	R	R	R	R	G
51	←	←	←	←	←
61, 62, 63	R	G	R	G	R
81	R	R	R	R	G
82	R	R	R	R	G
P21, P22	DW	DW	W	W	DRK
P41, P42	DW	DW	DW	DW	DRK
P61, P62	DW	W	DW	W	DRK
P81, P82	DW	DW	DW	DW	DRK

SIGNAL FACE I.D.

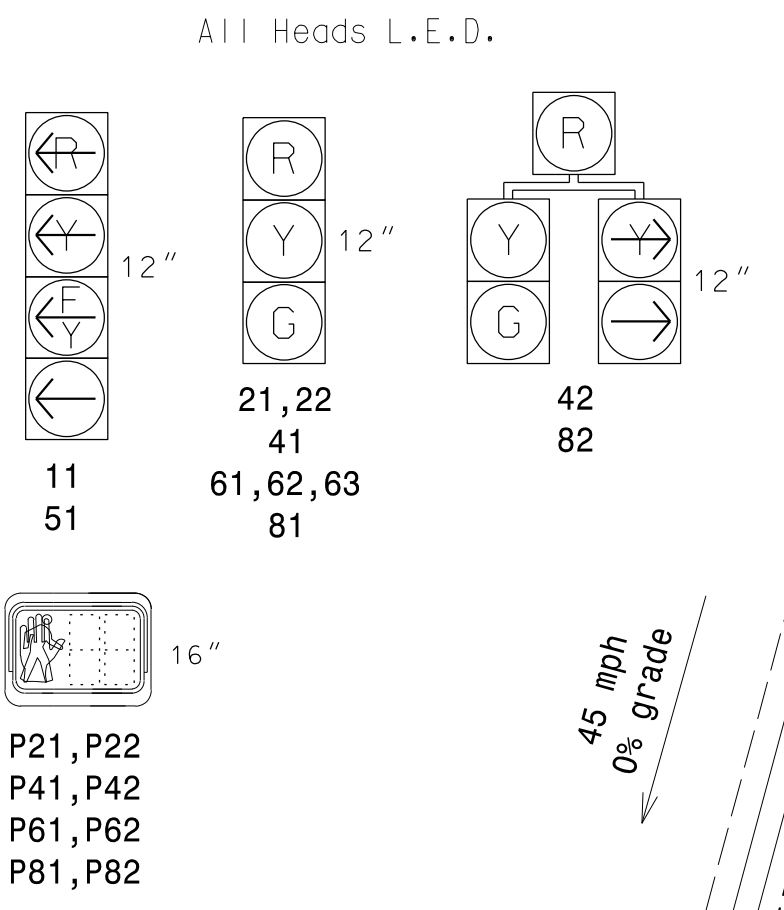

OASIS 2070 LOOP & DETECTOR INSTALLATION CHART

LOOP	SIZE (FT)	DISTANCE FROM STOPBAR (FT)	TURNS	NEW LOOP	DETECTOR PROGRAMMING				STRETCH TIME	DELAY TIME	SYSTEM LOOP	NEW CARD
					PHASE	CALLING	EXTENSION	FULL TIME DELAY				
1A	6X40	0	2-4-2	Y	1	Y	Y	-	-	15	-	-
1B	6X40	0	2-4-2	Y	6	Y	Y	-	-	3	-	-
2A	6X6	300	6	Y	2	Y	Y	-	-	-	-	-
2B	6X6	300	6	Y	2	Y	Y	-	-	-	-	-
4A	6X40	0	2-4-2	Y	4	Y	Y	-	-	-	-	-
5A	6X40	0	2-4-2	Y	5	Y	Y	-	-	15	-	-
5B	6X40	0	2-4-2	Y	2	Y	Y	-	-	3	-	-
6A	6X6	300	4	Y	6	Y	Y	-	-	-	-	-
6B	6X6	300	4	Y	6	Y	Y	-	-	-	-	-
6C	6X6	300	4	Y	6	Y	Y	-	-	-	-	Y
8A	6X40	0	2-4-2	Y	8	Y	Y	-	-	-	-	-

5 Phase Fully Actuated (Wilmington Signal System)

NOTES

1. Refer to "Roadway Standard Drawings NCDOT" dated January 2012 and "Standard Specifications for Roads and Structures" dated January 2012.
2. Do not program signal for late night flashing operation unless otherwise directed by the Engineer.
3. Phase 1 and/or phase 5 may be lagged.
4. Reposition existing signal heads numbered 11, 21, 22, 41, 42, 51, 61, 62, 81 & 82.
5. Run all lead-in cable overhead on existing utility poles where possible.
6. Set all detector units to presence mode.
7. Omit "WALK" and flashing "DON'T WALK" with no pedestrian calls.
8. Program pedestrian heads to countdown the flashing "Don't Walk" time only.
9. Pedestrian Pushbutton and sign shall be mounted parallel with associated crosswalk.
10. When pushbuttons are mounted on metal pole or pedestrian pedestal, the pole or pedestal shall be installed as close as possible to the back of curb at accessible ramps to minimize reach range.
11. Maximum times shown in timing chart are for free-run operation only. Coordinated signal system timing values supersede these values.
12. Signal system data: Controller Asset #0049.

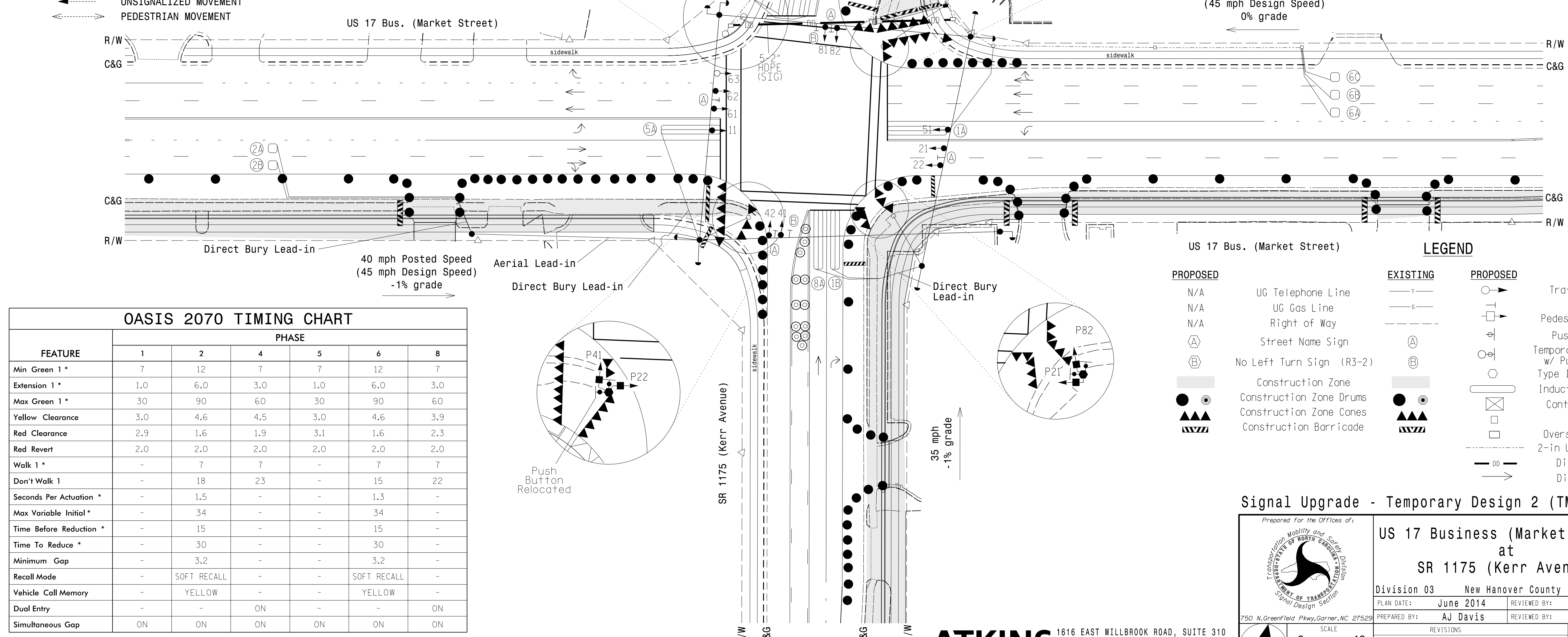

OASIS 2070 TIMING CHART

FEATURE	PHASE							
	1	2	4	5	6	8		
Min Green 1 *	7	12	7	7	12	7		
Extension 1 *	1.0	6.0	3.0	1.0	6.0	3.0		
Max Green 1 *	30	90	60	30	90	60		
Yellow Clearance	3.0	4.6	4.5	3.0	4.6	3.9		
Red Clearance	2.9	1.6	1.9	3.1	1.6	2.3		
Red Revert	2.0	2.0	2.0	2.0	2.0	2.0		
Walk 1 *	-	7	7	-	7	7		
Don't Walk 1	-	18	23	-	15	22		
Seconds Per Actuation *	-	1.5	-	-	1.3	-		
Max Variable Initial *	-	34	-	-	34	-		
Time Before Reduction *	-	15	-	-	15	-		
Time To Reduce *	-	30	-	-	30	-		
Minimum Gap	-	3.2	-	-	3.2	-		
Recall Mode	-	SOFT RECALL	-	-	SOFT RECALL	-		
Vehicle Call Memory	-	YELLOW	-	-	YELLOW	-		
Dual Entry	-	-	ON	-	-	ON		
Simultaneous Gap	ON	ON	ON	ON	ON	ON		

* These values may be field adjusted. Do not adjust Min Green and Extension times for phases 2 and 6 lower than what is shown. Min Green for all other phases should not be lower than 4 seconds.

LEGEND

PROPOSED	EXISTING	PROPOSED	EXISTING
N/A	UG Telephone Line	○	Traffic Signal Head
N/A	UG Gas Line	□	Sign
N/A	Right of Way	◻	Pedestrian Signal Head
(A)	Street Name Sign	◻	Push Button & Sign
(B)	No Left Turn Sign (R3-2)	◻	Temporary Pedestrian Post w/ Push Button & Sign
■	Construction Zone	○	Type II Signal Pedestal
●	Construction Zone Drums	◻	Inductive Loop Detector
▲	Construction Zone Cones	◻	Controller & Cabinet
▬	Construction Barricade	◻	Junction Box
		◻	Upsize Junction Box
		—	2-in Underground Conduit
		→	Directional Drill
		→	Directional Arrow

Signal Upgrade - Temporary Design 2 (TMP Phase III)

750 N. Greenfield Pkwy, Garner, NC 27529
SCALE 1"=40'

US 17 Business (Market Street) at SR 1175 (Kerr Avenue)

Division 03 New Hanover County Wilmington

PLAN DATE: June 2014 REVIEWED BY: MB Toth
PREPARED BY: AJ Davis REVIEWED BY: LM Moon

REVISIONS INIT. DATE

SEAL

Melissa B. Toth 12/19/2014
SIC. INVENTORY NO. 03-004912

13-JUL-2015 10:19 D:\Transportation\Projects\033388_Kerr_Sig_LTS\451\Signal\03-004912.dgn

ATKINS 1616 EAST MILLBROOK ROAD, SUITE 310 RALEIGH, NORTH CAROLINA 27609 (919) 876-8888 NGBEES #F-0326