

PROJECT REFERENCE NO.	SHEET NO.
U-3338B	EC-51/CONST.13
RW SHEET NO.	
ROADWAY DESIGN ENGINEER	HYDRAULICS ENGINEER

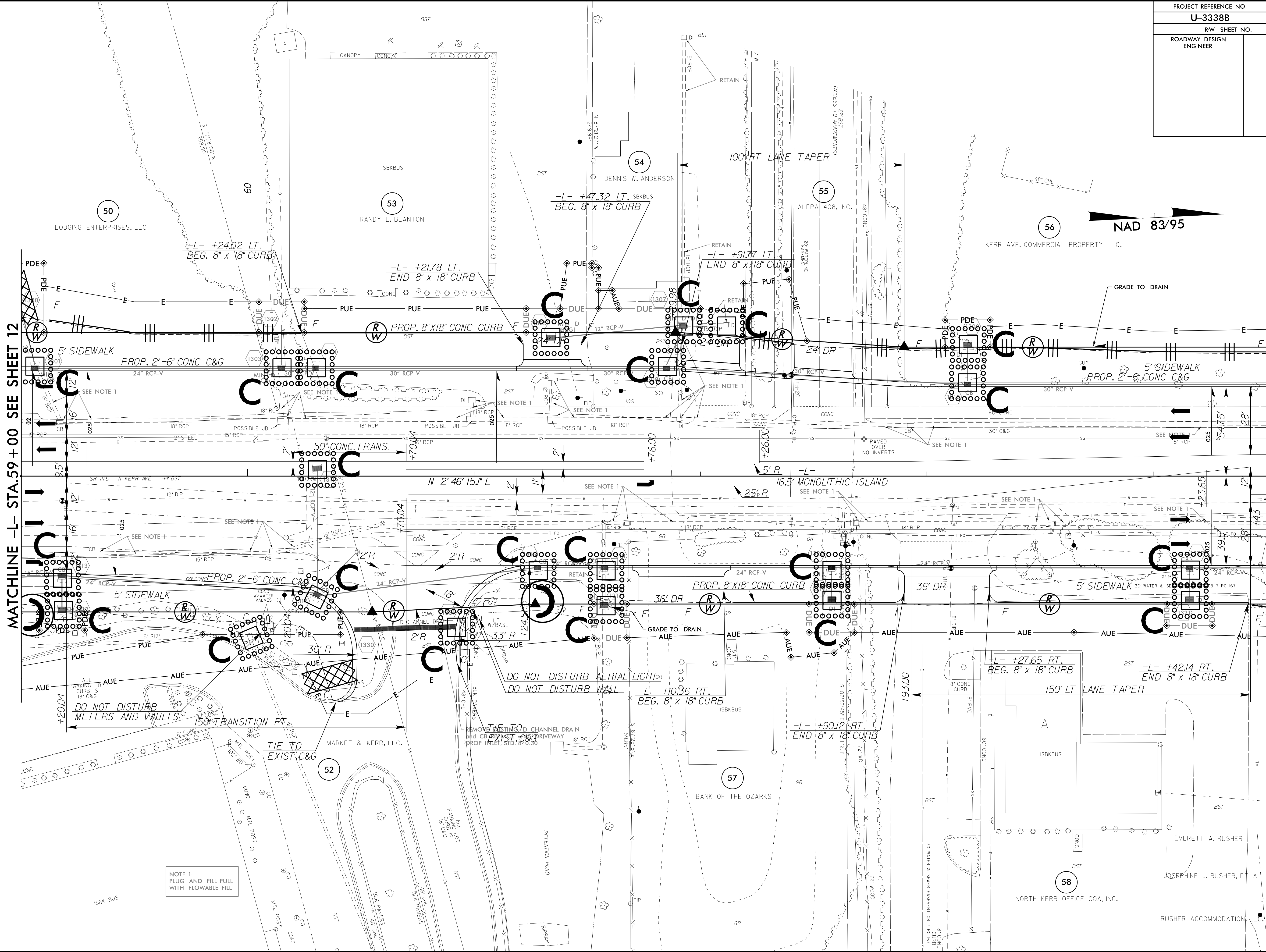

MATCHLINE -L- STA.59 + 00 SEE SHEET 12

MATCHLINE -L- STA.64 + 50 SEE SHEET 14

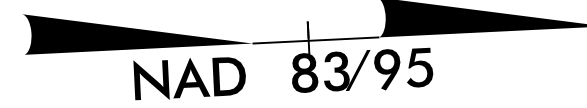

NOTE 1:
PLUG AND FILL FULL
WITH FLOWABLE FILL

50
LODGING ENTERPRISES, LLC

53
RANDY L. BLANTON

54
DENNIS W. ANDERSON

55
AHEPA 408, INC.

56
KERR AVE. COMMERCIAL PROPERTY LLC.

52
MARKET & KERR, LLC.

57
BANK OF THE OZARKS

58
NORTH KERR OFFICE COA, INC.

EVERETT A. RUSHER
JOSEPHINE J. RUSHER, ET AU
RUSHER ACCOMMODATION, LLC.

8/17/99

9/21/2015 14:55
 N:\Projects\U-3338B-EC.upsh.s13.dgn
 User: upsh
 Plot: U-3338B-EC.upsh.s13.dgn