

0400DEL_P30

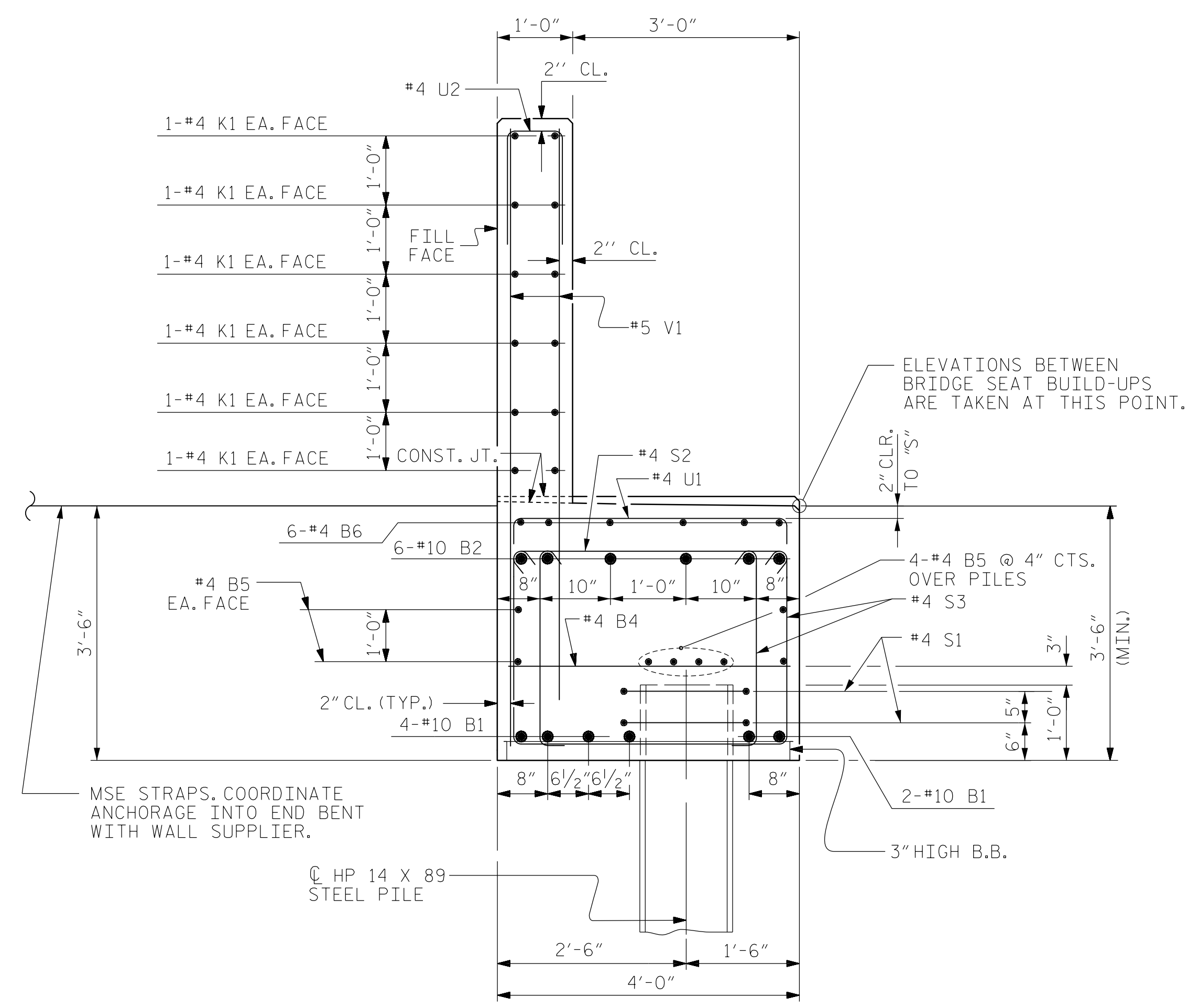

SECTION A-A

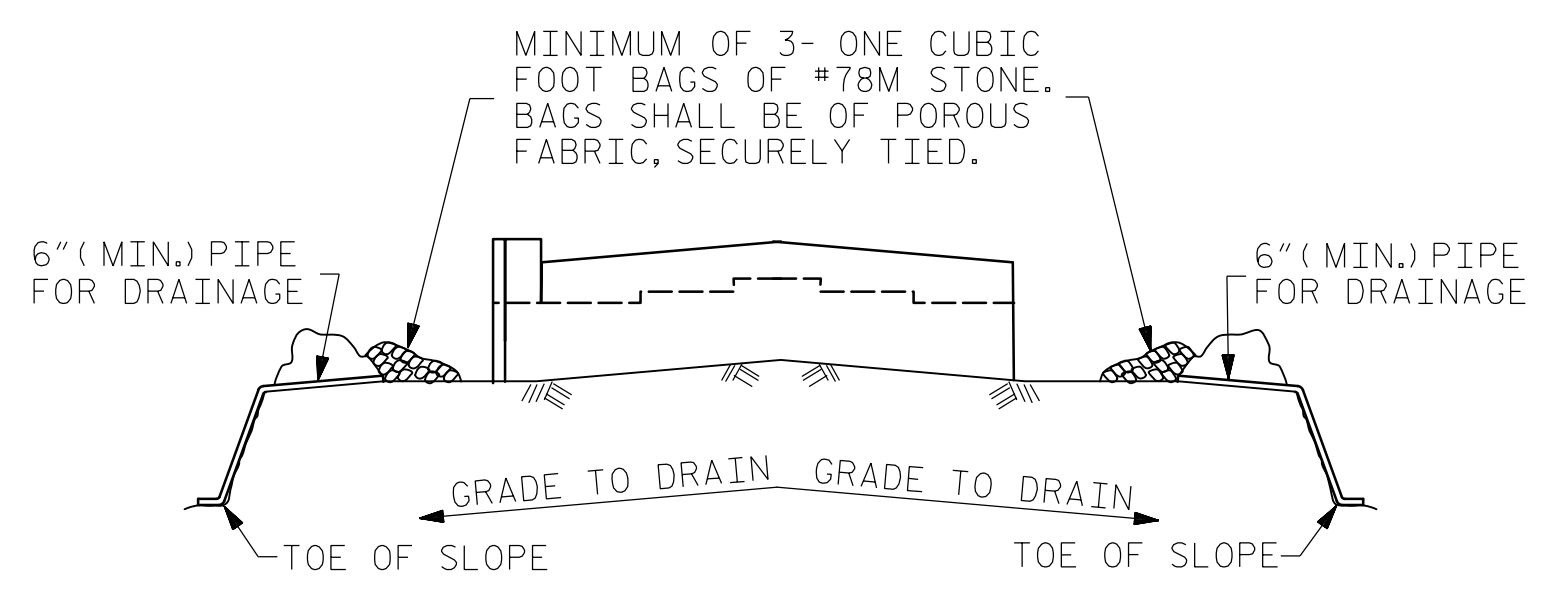

MINIMUM OF 3- ONE CUBIC FOOT BAGS OF #78M STONE. BAGS SHALL BE OF POROUS FABRIC, SECURELY TIED.

BAGGED STONE AND PIPE SHALL BE PLACED IMMEDIATELY AFTER COMPLETION OF END BENT EXCAVATION. PIPE MAY BE EITHER CONCRETE, CORRUGATED STEEL, CORRUGATED ALUMINUM ALLOY, OR CORRUGATED PLASTIC. PERFORATED PIPE WILL NOT BE ALLOWED.

BAGGED STONE SHALL REMAIN IN PLACE UNTIL THE ENGINEER DIRECTS THAT IT BE REMOVED. THE CONTRACTOR SHALL REMOVE AND DISPOSE OF SILT ACCUMULATIONS AT BAGGED STONE WHEN SO DIRECTED BY THE ENGINEER. BAGS SHALL BE REMOVED AND REPLACED WHENEVER THE ENGINEER DETERMINES THAT THEY HAVE DETERIORATED AND LOST THEIR EFFECTIVENESS.

NO SEPARATE PAYMENT WILL BE MADE FOR THIS WORK AND THE ENTIRE COST OF THIS WORK SHALL BE INCLUDED IN THE UNIT CONTRACT PRICE BID FOR THE SEVERAL PAY ITEMS.

TEMPORARY DRAINAGE AT END BENT

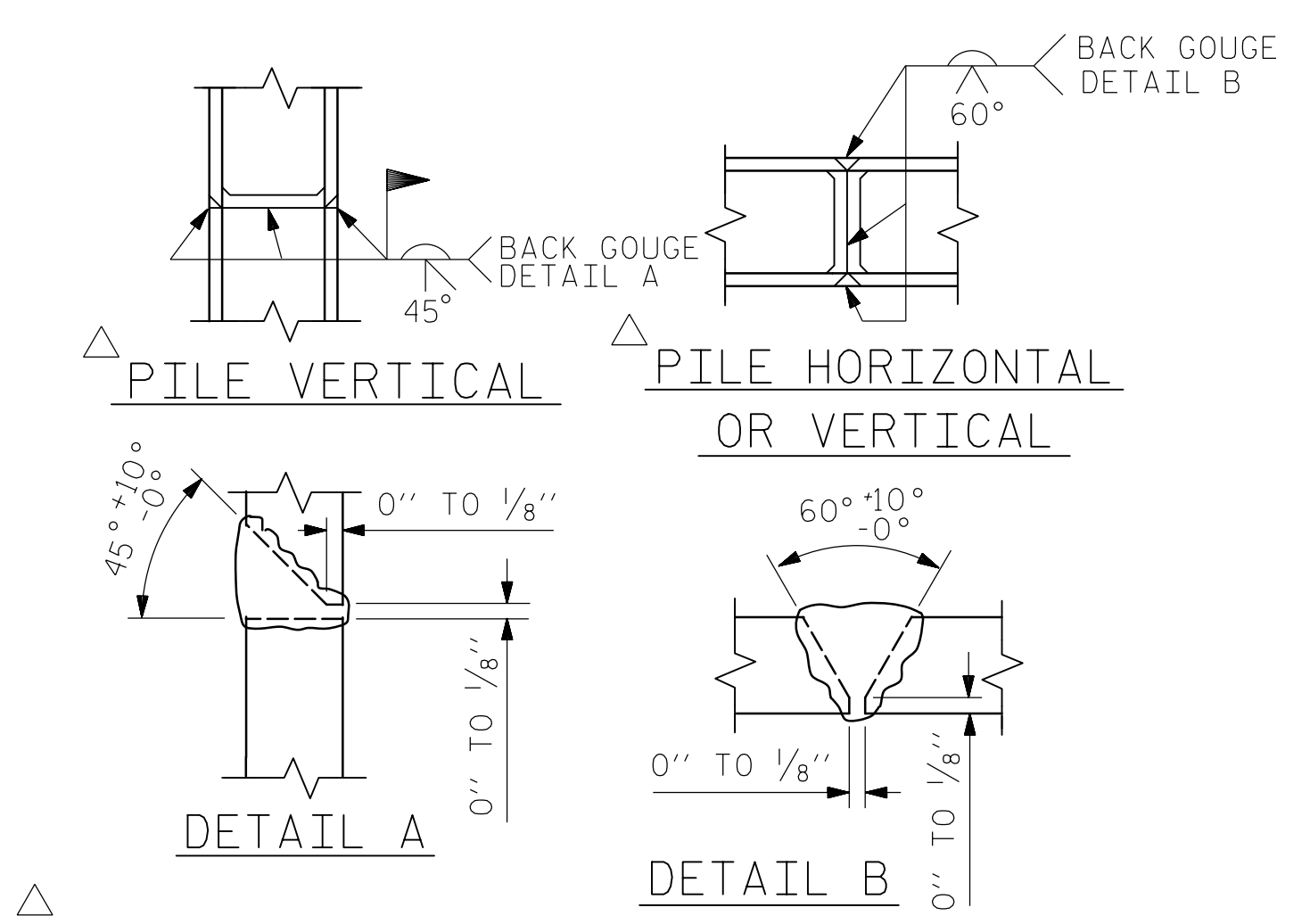

POSITION OF PILE DURING WELDING.
PILE SPLICE DETAILS

BAR TYPES

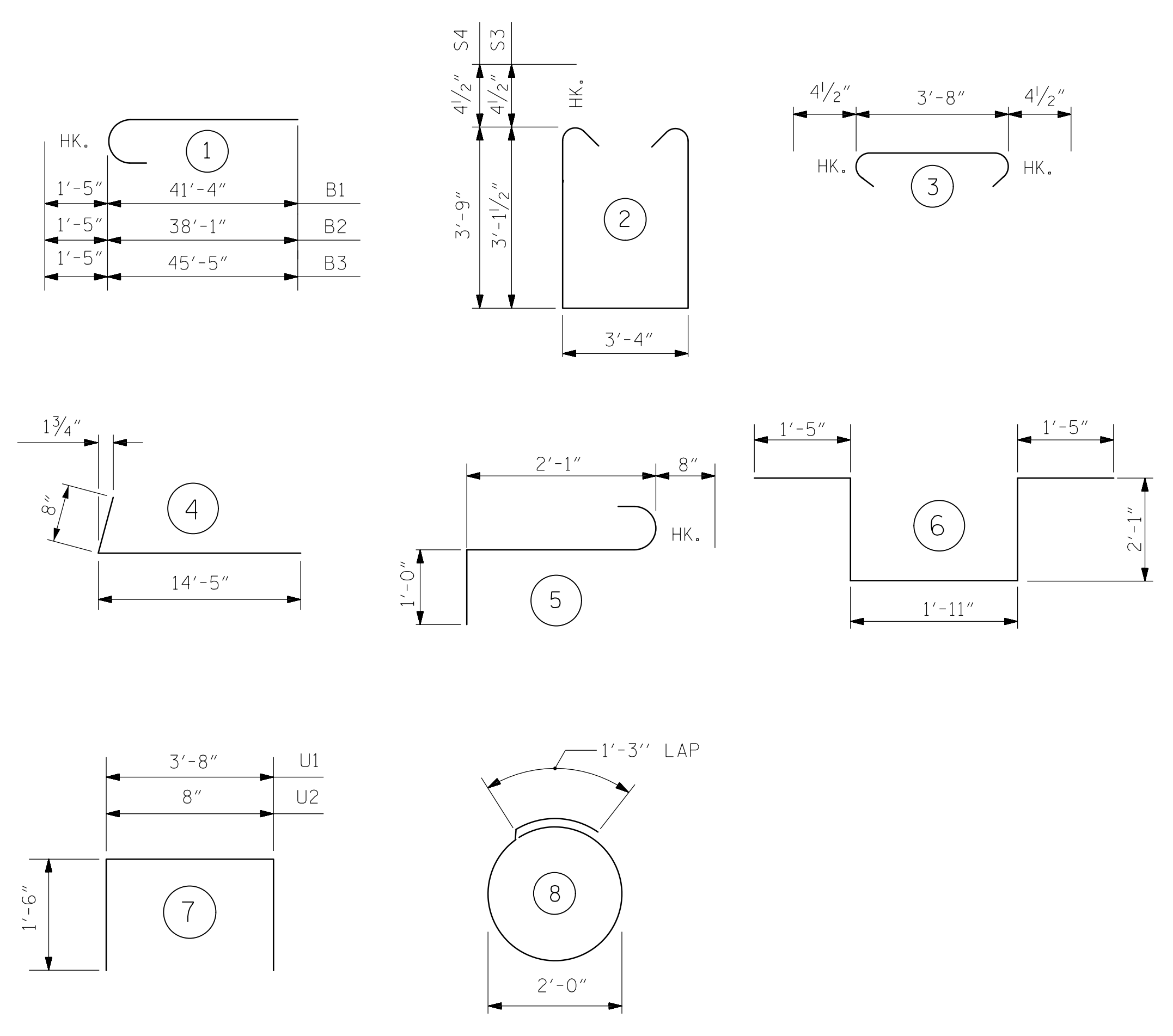

ALL BAR DIMENSIONS ARE OUT TO OUT.

BILL OF MATERIAL

END BENT 1					
BAR	NO.	SIZE	TYPE	LENGTH	WEIGHT
B1	12	10	1	42'-9"	2207
B2	6	10	1	39'-6"	1020
B3	6	10	1	46'-11"	1211
B4	18	4	STR.	3'-8"	44
B5	24	4	STR.	26'-6"	425
B6	12	4	STR.	10'-3"	82
B7	6	4	STR.	22'-3"	89
B8	4	4	STR.	20'-9"	55
H1	26	4	4	15'-1"	262
H2	6	4	STR.	4'-0"	16
K1	36	4	STR.	26'-6"	637
S1	22	4	8	7'-7"	111
S2	62	4	3	4'-5"	183
S3	50	4	2	10'-4"	345
S4	74	4	2	11'-7"	573
S5	1	6	6	8'-11"	13
S6	3	6	5	3'-9"	17
U1	25	4	7	6'-8"	111
U2	71	4	7	3'-8"	174
V1	142	5	STR.	9'-3"	1370
V2	10	5	STR.	11'-7"	121
V3	10	5	STR.	11'-10"	123
V4	8	5	STR.	12'-1"	101
V5	10	5	STR.	12'-3"	128
REINFORCING STEEL, LBS					9418
CLASS A CONCRETE				POUR 1	49.8 CY
				POUR 2	21.5 CY
TOTAL					71.3 CY
HP 14X89 STEEL PILES, NO					12
LIN FT					720
STEEL PILE POINTS, EA.					12

PROJECT NO. U-5008
MECKLENBURG COUNTY
 STATION: 20+45.05 -L- P.O.T. =
14+54.24 -Y4- P.O.T.

SHEET 3 OF 3

STATE OF NORTH CAROLINA
 DEPARTMENT OF TRANSPORTATION
 RALEIGH

END BENT 1
 DETAILS

KCI ASSOCIATES OF NC, P.A.
 9741 SOUTHERN PINE BLVD
 SUITE J
 CHARLOTTE, NC 28273
 704-499-9452
 NC LICENSE No. C-0764

NORTH CAROLINA
 PROFESSIONAL
 SEAL
 032954
 ENGINEER
 JARED C. MEDINA
 2/19/2015

REVISIONS					
NO.	BY:	DATE:	NO.	BY:	DATE:
1			3		
2			4		

SHEET NO. S-53
SHEETS 78

2/18/2015 1:10:07 PM Y:\0-cwings\2011 DWG\Structures\RFC\SH53.U-5008.SD.E1.3.dgn

DJD DRAWN BY : R.J. FLORY DATE : 10/03/14
 CHECKED BY : R.C. LARSON DATE : 10/06/14