

0400DEL\_P30

2/18/2015 Y:\0-ewings\2011 DWGS\Structures\RFC\SH49\_U-5008\_SD\_BM\_1.dgn

BILL OF MATERIAL

BAR TYPES

SPANS A,B,C												SPANS D,E,F,G					
BAR NO.	SIZE	TYPE	LENGTH	WEIGHT	BAR NO.	SIZE	TYPE	LENGTH	WEIGHT	BAR NO.	SIZE	TYPE	LENGTH	WEIGHT			
* A1	571	5	STR.	54'-9"	32607	A50	1	5	STR.	19'-1"	20	* A1	763	5	STR.	54'-9"	43571
A2	571	5	STR.	59'-2"	35237	A51	1	5	STR.	16'-5"	17	A2	763	5	STR.	59'-2"	47085
* A3	567	5	STR.	18'-6"	10941	A52	1	5	STR.	13'-10"	14	* A3	762	5	STR.	18'-6"	14703
A4	567	5	STR.	13'-9"	8131	A53	1	5	STR.	11'-2"	12	A4	762	5	STR.	13'-9"	10928
* A5	1	5	STR.	16'-9"	17	A54	1	5	STR.	8'-7"	9	* A70	1	5	STR.	51'-7"	54
* A6	1	5	STR.	14'-2"	15	A55	1	5	STR.	5'-11"	6	* A71	1	5	STR.	37'-10"	39
* A7	1	5	STR.	11'-6"	12	A56	1	5	STR.	3'-3"	3	* A72	1	5	STR.	24'-1"	25
* A8	1	5	STR.	8'-11"	9	* A57	1	5	STR.	58'-0"	60	* A73	1	5	STR.	10'-4"	11
A9	1	5	STR.	12'-0"	13	* A58	1	5	STR.	38'-4"	40	A74	1	5	STR.	51'-7"	54
A10	1	5	STR.	9'-5"	10	* A59	1	5	STR.	18'-7"	19	* A75	1	5	STR.	37'-10"	39
A11	1	5	STR.	6'-9"	7	A60	1	5	STR.	58'-0"	60	A76	1	5	STR.	24'-1"	25
A12	1	5	STR.	4'-2"	4	A61	1	5	STR.	38'-4"	40	A77	1	5	STR.	10'-4"	11
* A13	1	5	STR.	58'-6"	61	A62	1	5	STR.	18'-7"	19	* A78	1	5	STR.	13'-0"	14
* A14	1	5	STR.	55'-10"	58							A79	1	5	STR.	8'-1"	8
* A15	1	5	STR.	53'-3"	56	* B1	144	4	STR.	30'-0"	2886	* A80	1	5	STR.	58'-1"	61
* A16	1	5	STR.	50'-7"	53	B2	138	5	STR.	44'-3"	6369	* A81	1	5	STR.	32'-3"	34
* A17	1	5	STR.	48'-0"	50	* B3	96	8	STR.	46'-11"	12026	* A82	1	5	STR.	6'-5"	7
* A18	1	5	STR.	45'-4"	47	B4	138	8	STR.	45'-10"	16888	A83	1	5	STR.	58'-1"	61
* A19	1	5	STR.	42'-9"	45	* B5	94	8	STR.	38'-6"	9663	A84	1	5	STR.	32'-3"	34
* A20	1	5	STR.	40'-1"	42	B6	69	5	STR.	46'-10"	3370	A85	1	5	STR.	6'-5"	7
* A21	1	5	STR.	37'-6"	39	* B7	96	4	STR.	24'-3"	1555						
* A22	1	5	STR.	34'-10"	36	B8	138	8	STR.	44'-4"	16335	* B13	288	4	STR.	28'-7"	5499
* A23	1	5	STR.	32'-3"	34	* B9	96	8	STR.	45'-6"	11663	B14	276	5	STR.	42'-1"	12114
* A24	1	5	STR.	29'-7"	31	* B10	94	8	STR.	37'-1"	9307	* B15	288	8	STR.	44'-5"	34155
* A25	1	5	STR.	26'-11"	28	* B11	144	4	STR.	28'-1"	2701	B16	414	8	STR.	43'-4"	47900
* A26	1	5	STR.	24'-4"	25	B12	138	5	STR.	41'-3"	5937	* B17	192	4	STR.	22'-0"	2822
* A27	1	5	STR.	21'-8"	23	* B20	104	4	STR.	29'-3"	2032	B18	138	5	STR.	43'-3"	6225
* A28	1	5	STR.	19'-1"	20	* B21	98	4	STR.	28'-7"	1871	* B19	282	8	STR.	36'-0"	27106
* A29	1	5	STR.	16'-5"	17							* B22	136	4	STR.	30'-0"	2725
* A30	1	5	STR.	13'-10"	14	* G1	4	5	STR.	37'-6"	156	* B23	126	4	STR.	28'-10"	2427
* A31	1	5	STR.	11'-2"	12	* G2	354	4	STR.	8'-9"	2069						
* A32	1	5	STR.	8'-7"	9	* G3	372	4	STR.	7'-3"	1802	* G1	4	5	STR.	37'-6"	156
* A33	1	5	STR.	5'-11"	6							* G2	477	4	STR.	8'-9"	2788
* A34	1	5	STR.	3'-3"	3	* J1	110	4	7	1'-5"	104	* G3	482	4	STR.	7'-3"	2334
A35	1	5	STR.	58'-6"	61												
A36	1	5	STR.	55'-10"	58	* K1	24	8	2	20'-2"	1292	* K1	24	8	2	20'-2"	1292
A37	1	5	STR.	53'-3"	56	* K2	8	8	1	13'-4"	285	* K2	8	8	1	13'-4"	285
A38	1	5	STR.	50'-7"	53	* K3	14	4	STR.	5'-2"	48						
A39	1	5	STR.	48'-0"	50	K4	28	4	STR.	6'-7"	123	* K1	24	8	2	20'-2"	1292
A40	1	5	STR.	45'-4"	47	K5	140	4	STR.	8'-2"	764	* K2	8	8	1	13'-4"	285
A41	1	5	STR.	42'-9"	45	K6	28	4	STR.	5'-2"	97	K4	42	4	STR.	6'-7"	185
A42	1	5	STR.	40'-1"	42	K7	42	4	STR.	23'-1"	648	K5	210	4	STR.	8'-2"	1146
A43	1	5	STR.	37'-6"	39							K6	42	4	STR.	5'-2"	145
A44	1	5	STR.	34'-10"	36	* S1	84	5	3	6'-1"	533	K7	63	4	STR.	23'-1"	971
A45	1	5	STR.	32'-3"	34	* S2	42	4	4	3'-1"	87						
A46	1	5	STR.	29'-7"	31	S3	28	4	6	11'-3"	210	* S1	84	5	3	6'-1"	533
A47	1	5	STR.	26'-11"	28	S4	416	4	5	2'-9"	764	S3	42	4	6	11'-3"	316
A48	1	5	STR.	24'-4"	25							S4	924	4	5	2'-9"	1697
A49	1	5	STR.	21'-8"	23	U1	84	4	2	16'-8"	935						
						* U2	264	4	4	3'-8"	647	U1	126	4	2	16'-8"	1403
												* U2	347	4	4	3'-8"	850

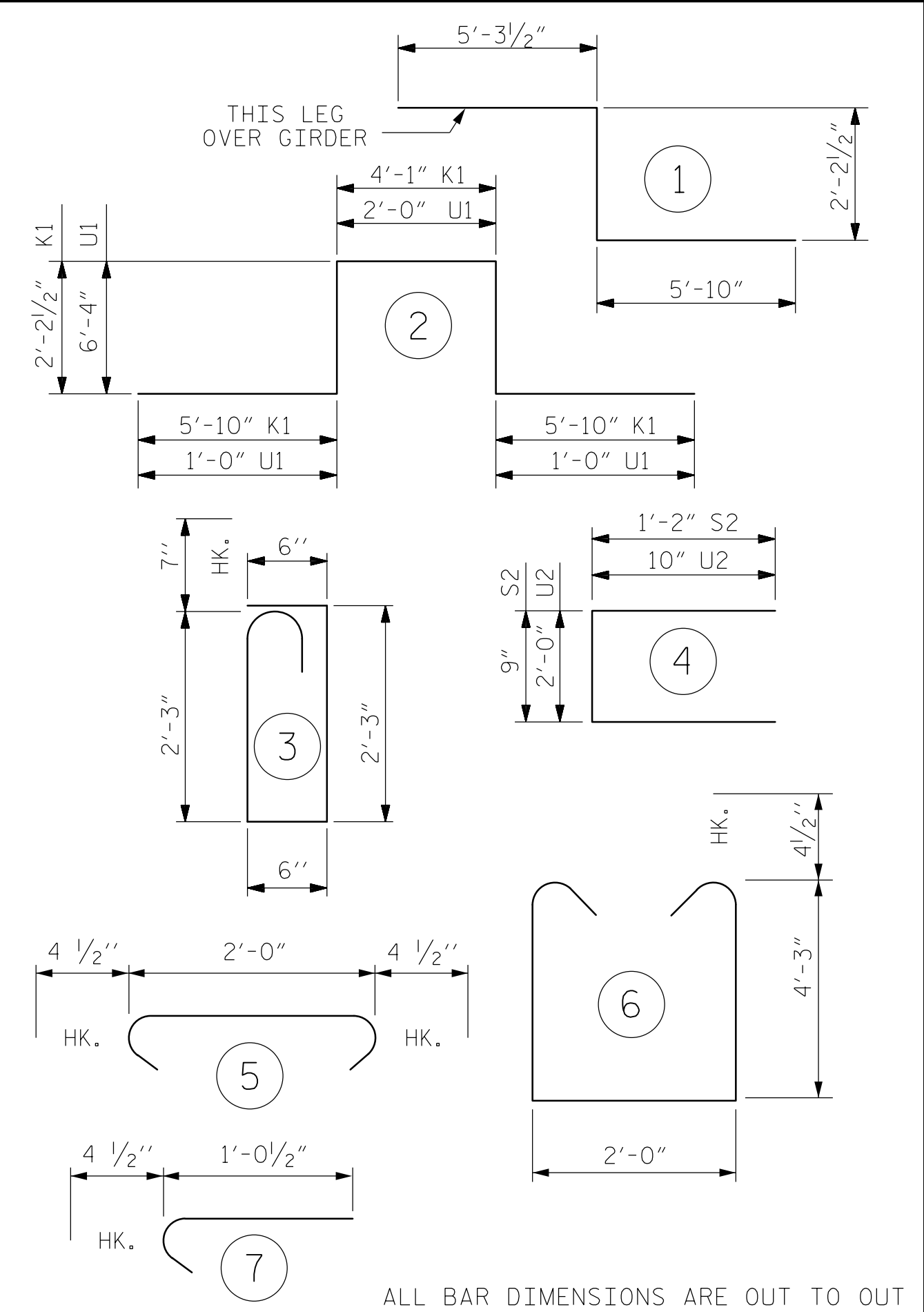

\* EPOXY COATED REINFORCING STEEL

SUPERSTRUCTURE REINFORCING STEEL LENGTHS ARE BASED ON THE FOLLOWING MINIMUM SPLICE LENGTHS

BAR SIZE	SUPERSTRUCTURE EXCEPT APPROACH SLABS, PARAPET, AND BARRIER RAIL		APPROACH SLABS		PARAPET AND BARRIER RAIL
	EPOXY COATED	UNCOATED	EPOXY COATED	UNCOATED	
#4	2'-0"	1'-9"	2'-0"	1'-9"	2'-9"
#5	2'-6"	2'-2"	2'-6"	2'-2"	3'-5"
#6	3'-0"	2'-7"	3'-10"	2'-7"	4'-4"
#7	5'-3"	3'-6"			
#8	6'-10"	4'-7"			

GROOVING BRIDGE FLOORS

APPROACH SLABS	1,424	SQ.FT.
BRIDGE DECK	42,989	SQ.FT.
TOTAL	44,413	SQ.FT.

PROJECT NO. U-5008  
MECKLENBURG COUNTY  
 STATION: 20+45.05 -L- P.O.T. =  
14+54.24 -Y4- P.O.T.  
 SHEET 1 OF 2

STATE OF NORTH CAROLINA  
 DEPARTMENT OF TRANSPORTATION  
 RALEIGH

**SUPERSTRUCTURE  
 BILL OF MATERIAL**

STD NO. BOM2

REVISIONS						SHEET NO. S-49
NO.	BY:	DATE:	NO.	BY:	DATE:	
1			3			SHEETS 78
2			4			

KCI ASSOCIATES OF NC, P.A.  
 9741 SOUTHERN PINE BLVD  
 SUITE J  
 CHARLOTTE, NC 28273  
 704-499-9452  
 NC LICENSE No. C-0764

NORTH CAROLINA  
 PROFESSIONAL  
 SEAL  
 032954  
 ENGINEER  
 JARED C. MEDLIN  
 2/19/2015

DRAWN BY: R.J. FLORY DATE: 9/8/14  
 CHECKED BY: R.C. LARSON DATE: 9/9/14