

0400DEL\_P30

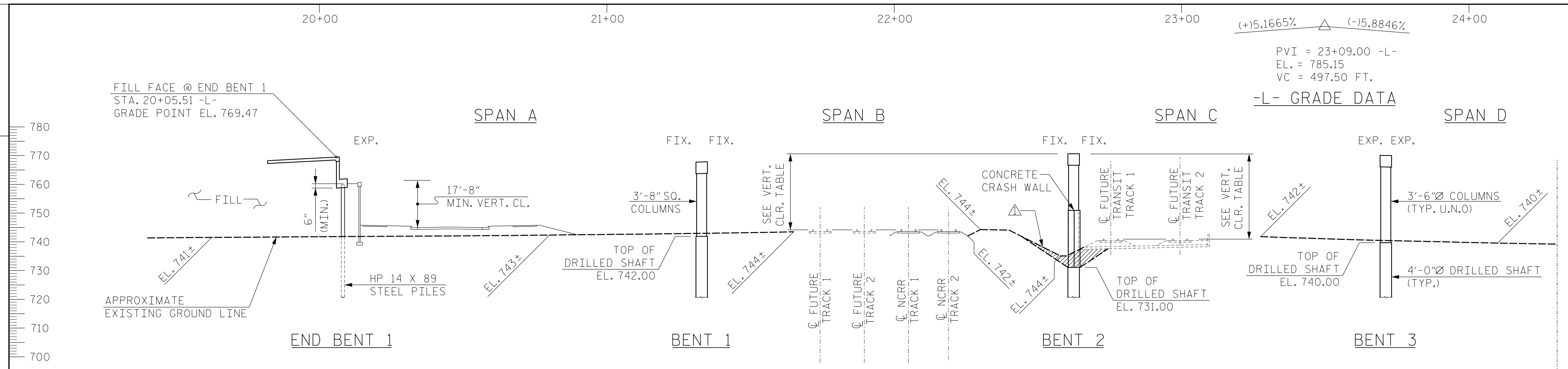

**SECTION ALONG -L-**  
(ELEVATION OF END BENTS AND BENTS ARE AT RIGHT ANGLES)

**-L- HORIZONTAL CURVE DATA**

PI Sta 18+92.92	PI Sta 24+30.99
$\Delta = 8^\circ 22' 16.2''$ (RT)	$\Delta = 6^\circ 34' 11.2''$ (LT)
D = 3°52'16.8"	D = 1°11'55.2"
L = 216.23'	L = 548.10'
T = 108.31'	T = 274.35'
R = 1,480.00'	R = 4,780.00'

⚠ FOUNDATION EXCAVATION LIMITS (1.5:1 SLOPES NORMAL TO BENT)  
FOUNDATION EXCAVATION SHOWN ASSUMES TRACKS NOT IN PLACE AT TIME OF EXCAVATION. IF TRACKS ARE CONSTRUCTED AT THE TIME OF EXCAVATION, TEMPORARY RAILROAD SHORING WILL BE REQUIRED AND WILL BE PAID FOR AS SUPPLEMENTAL WORK.

RAIL	MIN. CLR.
-NCR TRACK 1-	24'-11"
-NCR TRACK 2-	25'-4"
** -FUTURE TRACK 1-	24'-3"
** -FUTURE TRACK 2-	24'-7"
-F. TRAN. TRK 1-	29'-6"
-F. TRAN. TRK 2-	29'-6"

\*\* FUTURE TRACKS ASSUMED TO BE AT THE SAME ELEVATION AND STATION AS TRK1 AT A NORMAL 15'-0" OFFSET.

**RR TIE-EQUALITIES**

- \*\* (A) STA. 21+74.09 -L- P.O.C = STA. 16+92.46 -FTRK1- P.O.T.
- \*\* (B) STA. 21+89.47 -L- P.O.C = STA. 16+89.06 -FTRK2- P.O.T.
- (C) STA. 22+04.94 -L- P.O.C = STA. 16+85.61 -TRK1- P.O.T.
- (D) STA. 22+18.83 -L- P.O.C = STA. 16+88.58 -TRK2- P.O.T.
- (E) STA. 22+75.42 -L- P.O.C = STA. 1174+05.23 -FTNTRK1- P.O.T.
- (F) STA. 22+99.37 -L- P.O.C = STA. 1174+10.48 -FTNTRK2- P.O.T.

**ANGLES**

- ① 102°37'9.4"
- ② 103°53'1" (TAN. TO CURVE)
- ③ 90°0'0" (TAN. TO CURVE)
- ④ 103°3'4.8" (TAN. TO CURVE)
- ⑤ 103°13'7.5" (TAN. TO CURVE)
- ⑥ 103°54'48.1" (TAN. TO CURVE)
- ⑦ 106°1'23.6" (TAN. TO CURVE)

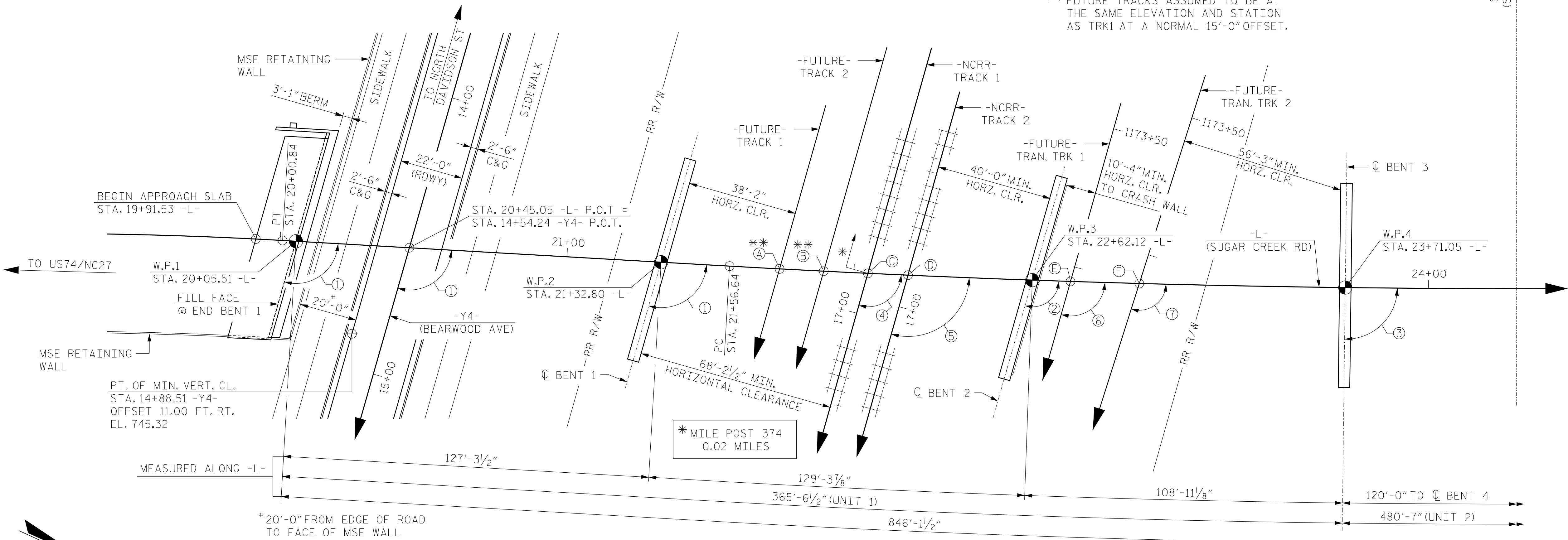

**-Y4- HORIZONTAL CURVE DATA**

PI Sta 11+94.56
$\Delta = 69^\circ 18' 55.3''$ (RT)
D = 22°55'05.9"
L = 302.45'
T = 172.84'
R = 250.00'

**PLAN**  
(PILES & DRILLED PIERS NOT SHOWN IN PLAN VIEW)

MATCH LINE  
STA. 24+30.69 -L-  
(SEE SHEET 2 OF 6)

PROJECT NO. U-5008  
MECKLENBURG COUNTY  
STATION: 20+45.05 -L- P.O.T. =  
14+54.24 -Y4- P.O.T.  
SHEET 1 OF 6 BRIDGE NO. 1317

STATE OF NORTH CAROLINA  
DEPARTMENT OF TRANSPORTATION  
RALEIGH  
**GENERAL DRAWING**  
FOR BRIDGE ON SUGAR CREEK RD  
OVER BEARWOOD AVE, NCR/NSRR,  
AND RALEIGH ST  
BTW US74/NC27 & US29/NC49

REVISIONS						SHEET NO.	
NO.	BY:	DATE:	NO.	BY:	DATE:	S-1	
1			3			SHEETS	
2			4			78	

KCI ASSOCIATES OF NC, P.A.  
9741 SOUTHERN PINE BLVD  
SUITE J  
CHARLOTTE, NC 28273  
704-499-9452  
NC LICENSE No. C-0764

MP MAIN 374.02

**PROFESSIONAL SEAL**  
032954  
JARED C. MEDLIN  
JARED C. MEDLIN  
12/19/2015  
BAFEE71A3384F8

2/18/2015 Y:\D:\wings\2011 DWG\Structures\RFC\SH01-U-5008\_SD\_PP-1.dgn

DRAWN BY: D.L.KEENER DATE: SEP. 2013  
CHECKED BY: J.D.FITZMORRIS DATE: SEP. 2013