

EASTWAY DRIVE AND N TRYON ST. INTERSECTION AFTER DETOUR IS REMOVED

PROJECT REFERENCE NO. U-5008	SHEET NO. 2B-4
RW SHEET NO.	
ROADWAY DESIGN ENGINEER 3/5/2015	PAVEMENT DESIGN ENGINEER 3/5/2015

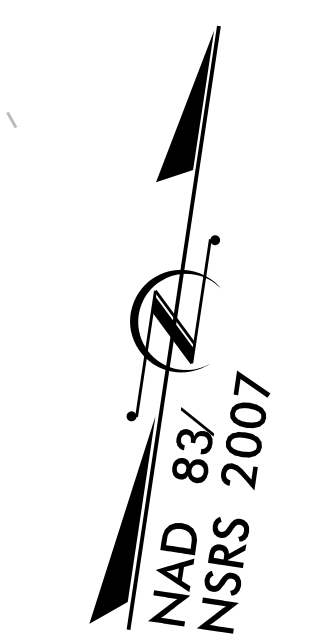
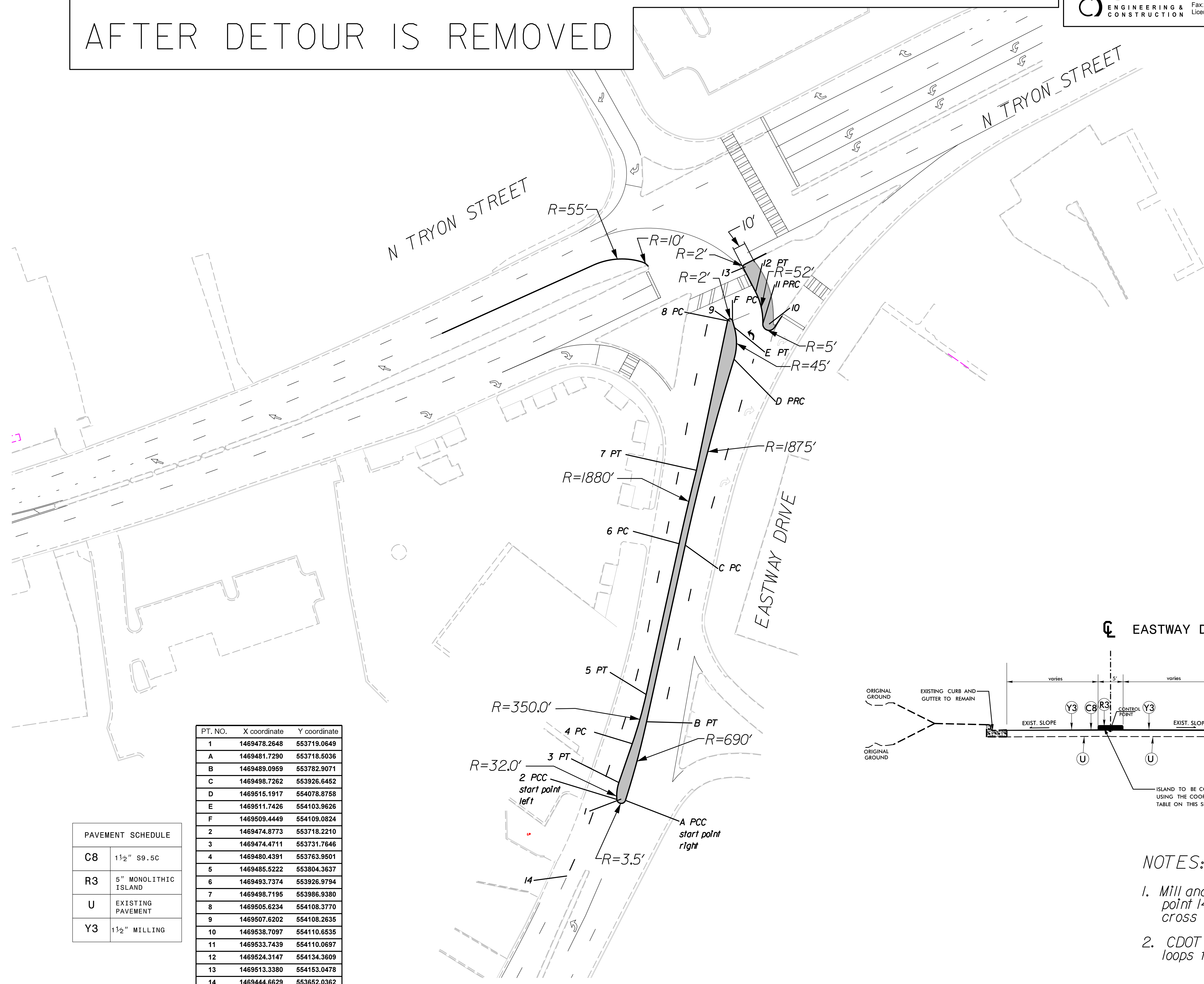

PT. NO.	X coordinate	Y coordinate
1	1469478.2648	553719.0649
A	1469481.7290	553718.5036
B	1469489.0959	553782.9071
C	1469498.7262	553926.6452
D	1469515.1917	554078.8758
E	1469511.7426	554103.9626
F	1469509.4449	554109.0824
2	1469474.8773	553718.2210
3	1469474.4711	553731.7646
4	1469480.4391	553763.9501
5	1469485.5222	553804.3637
6	1469493.7374	553926.9794
7	1469498.7195	553986.9380
8	1469505.6234	554108.3770
9	1469507.6202	554108.2635
10	1469538.7097	554110.6535
11	1469533.7439	554110.0697
12	1469524.3147	554134.3609
13	1469513.3380	554153.0478
14	1469444.6629	553652.0362

PAVEMENT SCHEDULE	
C8	1½" S9.5C
R3	5" MONOLITHIC ISLAND
U	EXISTING PAVEMENT
Y3	1½" MILLING

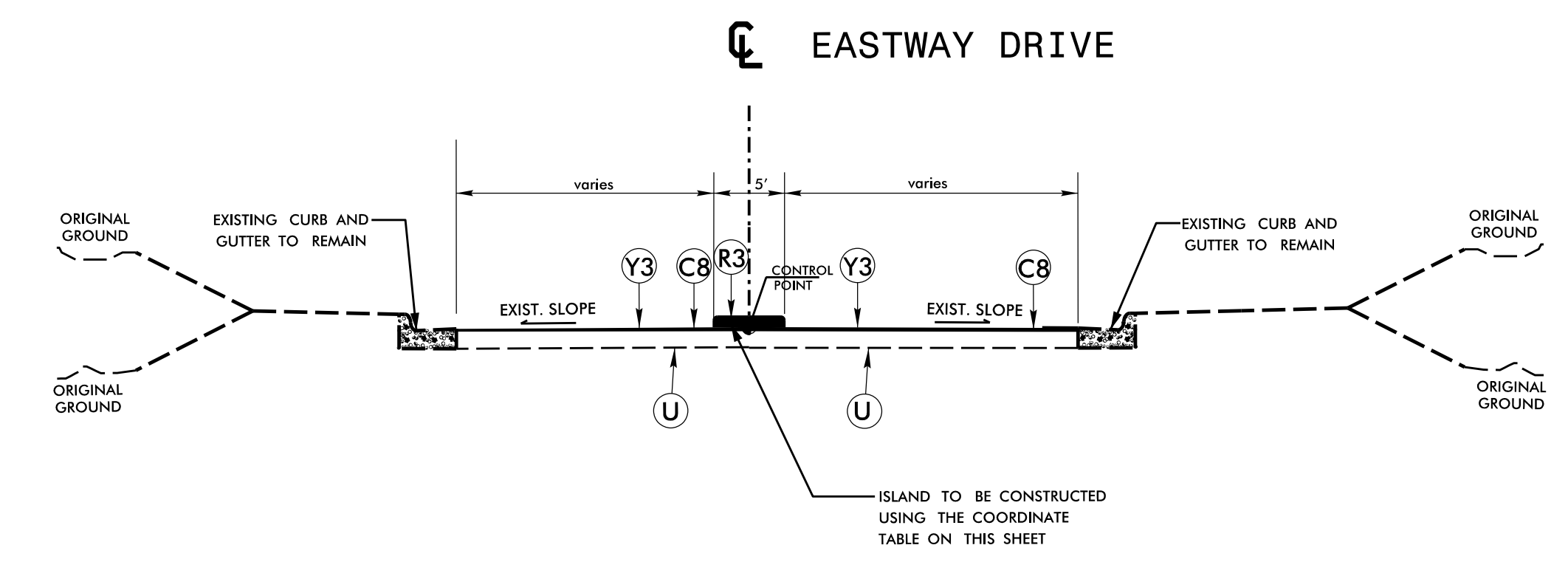

- NOTES:**
1. Mill and resurface 1.5" from point 14 on Eastway Drive to existing cross walk
 2. CDOT is to replace any signal loops that were destroyed by milling

SYSTEMS DESIGN CONSULTANTS
 10000 W. HARRIS AVE
 SUITE 100
 FORT WORTH, TX 76137
 TEL: 817-335-1100
 FAX: 817-335-1101
 WWW.SDCON.COM